

Dates of Revisions	
Jan. 29, 1909	
April 30, 1909	
Feb. 17, 1913	

Used on
Gasoline
Motor Cars
and Trailers

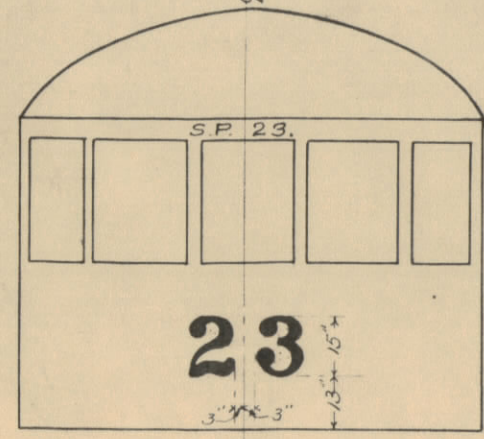

Rear End of Motor Car (Outside)
2 3/4 Roman Standard Letters and Numbers

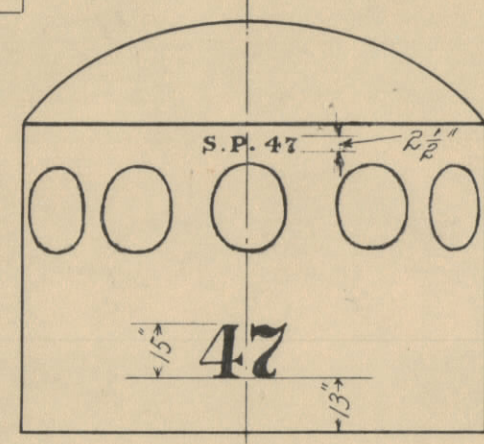
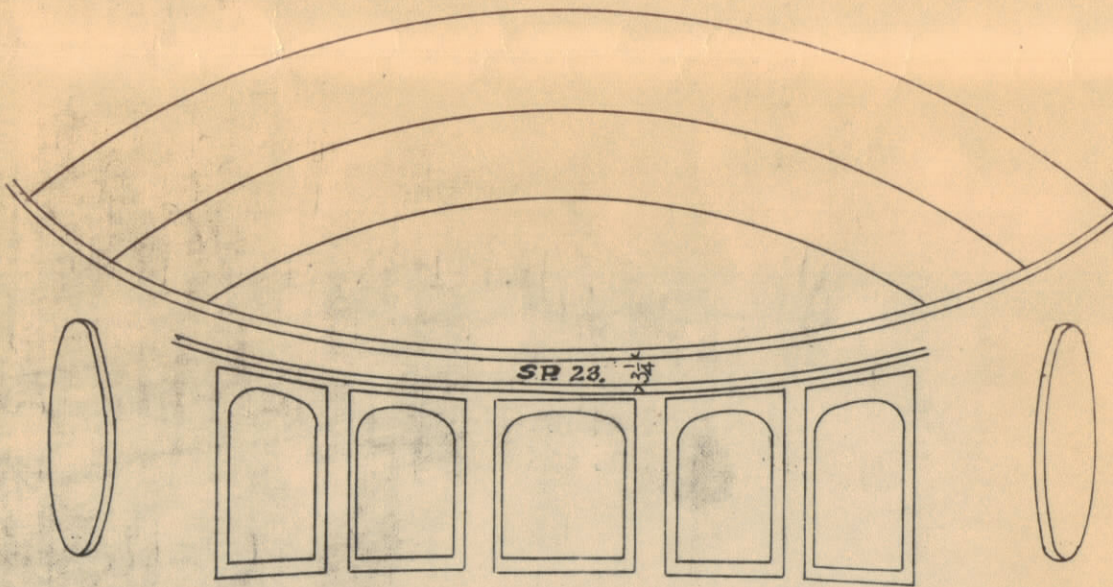

Rear End of Motor Car (Inside)
1 3/4 Roman Standard Letters and Numbers

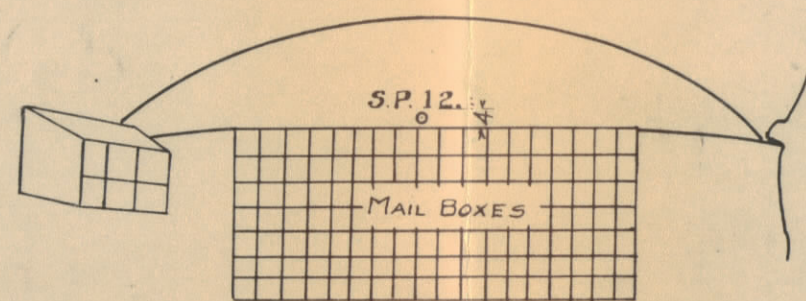
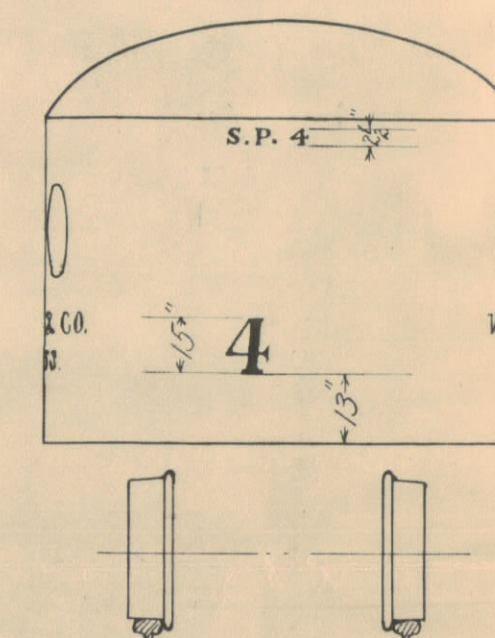
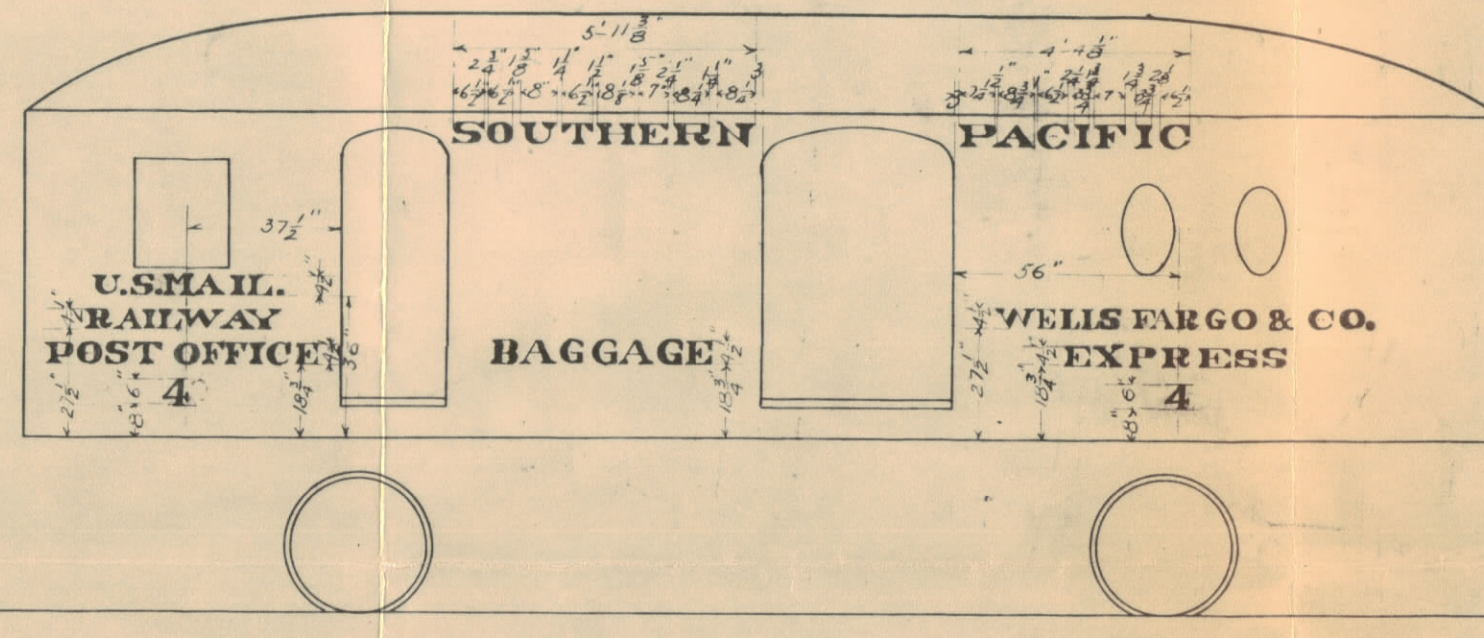
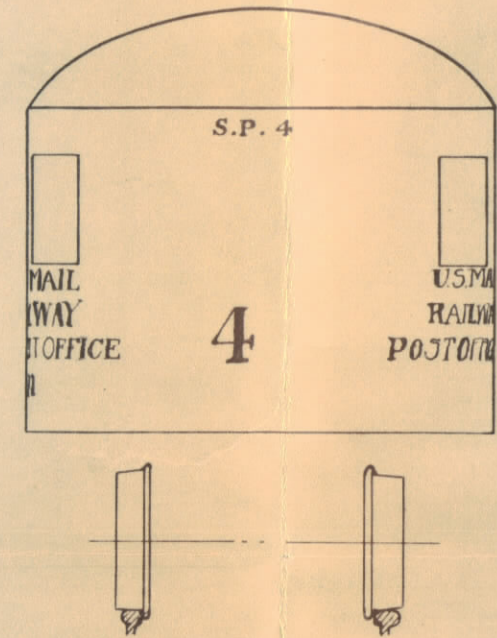

Mail End of Trailer (Inside)
1 3/4 Standard Letters and Numbers

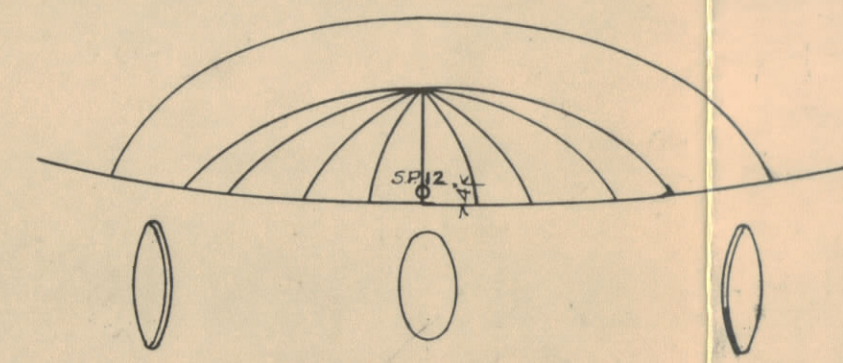

Express End of Trailer (Inside)
1 3/4 Standard Letters and Numbers

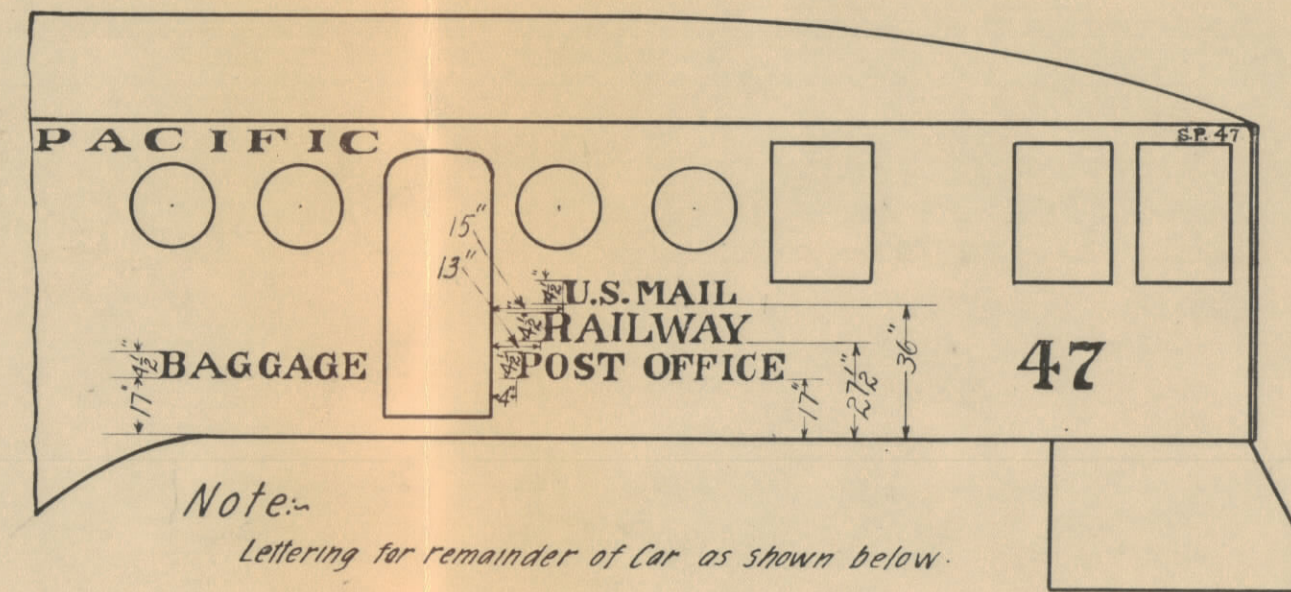

Note:-
Lettering for remainder of Car as shown below.

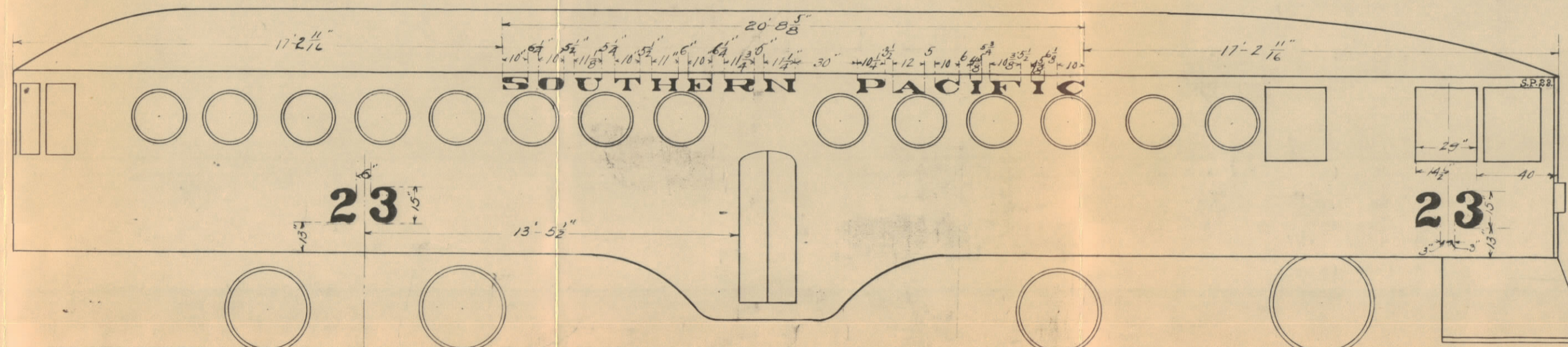

NOTE:- Southern Pacific - 5 Roman Letters
same as on Letterboard of S.P.Co's Narrow Gauge Cars
Numbers are 15 Standard Roman
Motor Car Drawings CA 3883 to 3890 Inclusive

Note:- 15 Figures to be made in Aluminum
other Letters and Figures made in Gold.

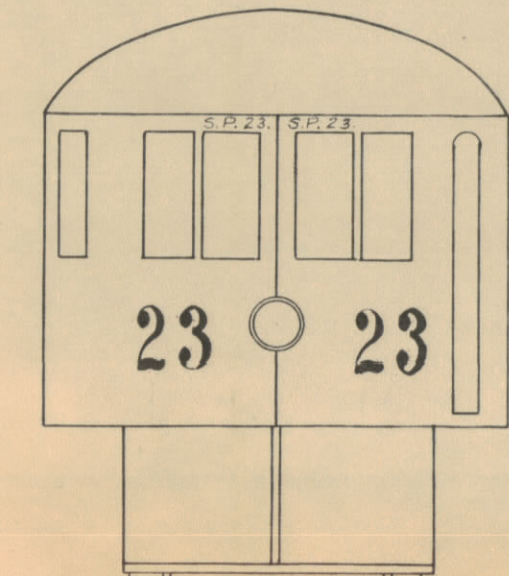

Front End of Motor Car (Outside)
2 3/4 Roman Standard Letters and Numbers

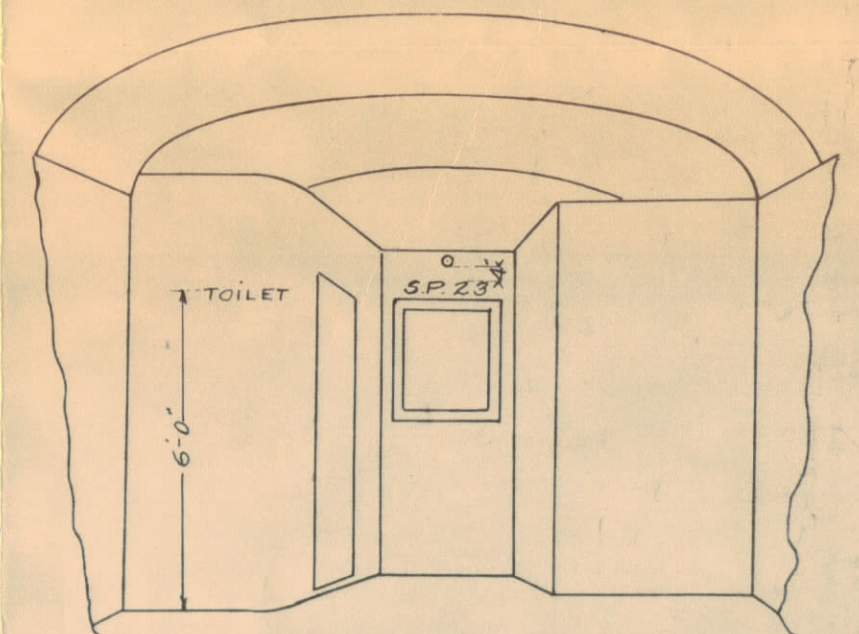

Front End of Motor Car (Inside)
1 3/4 Roman Standard Letters and Numbers

NOTE:- Southern Pacific - 5 Roman
Letters, same as on Letterboard
of So.Pac.Co's Narrow Gauge Cars
Numbers are 6 Standard Roman.
All other Letters are 4 1/2 Standard Roman.

Note:-
This Drawing supersedes
Drawing 7122, Book 607
of Nov. 14, 1908.

Lettering and Numbering
Motor Cars
Scale of 1/2" = 1'-0" Sacto Dec 17, 1908

Book 607
7160

JEN.