

ROMAN

995+02.3 P.O.T. = EQ.  
140+371 E.C.

139+651 E.C.-WB

SANTA CLARA  
MUNICIPAL  
WATER WORKS

PS (Sc)

137+91.0 Signal

Tool Ho.  
Tool Ho.

Interlocking  
Tower

STREET

8" Pipe

Tank

Tank

T.C. 6'18"

RAILROAD

Surfaced

Surfaced

AVENUE

Surfaced

Station

Platform

Pole

133+00.4 B.C. - 0°30' Lt.

132+28.4 B.C. - 0°30' Lt. - WB.

STREET

ROSENBI  
AI

Surface

18+93.6 - PS.

X-ing. P.U.C. # E-44.35-C (Sc)

X-ing P.U.C. # E-44.25-C (Sc)

14+40

REET

140

19

18

17

16

15

14

13

12

11

10

130

18+93.6 - P.S.

Grandstand

Parking

CAMPBELL AVENUE

AVENUE

133+00.4 B.C. - 0°30' Lt.

132+284 B.C. - 0°30' Lt. - W.B.

STREET

AVENUE

Station

Platform

Surfaced

Pole

PIC - SWEET

FOODS, INC.

ROSENBERG

AND

CO.

BROS.

T.C. 5° 10'

Surfaced

Area

128+67.5 Light Signal

128+70 Signal (Sc)

127+70.0 E.C. - W.B.

124+40.0 B.C. - 0°10' Lt. - W.B.

27+92.6 B.C. - 8°00'

28+17 X-ing (Sc.)

123+70 P.S. (Sc)

SANTA CLARA

PEAR ASS'N

29+32.8 E.C.

9  
20

2  
3  
4  
5  
6  
7  
8

18'

14  
3  
2  
18  
130  
19  
10  
18  
18  
17  
16  
15  
14  
13

124+40.0 BC-0°10' Lt.-WB.

27+92.6 B.C. - 8°00'

28+17 C X-ing (Sc.)

123+70 P.S. (Sc.)

SANTA CLARA  
PEAR ASS'N

29+32.8 EC

AVENUE

E-72 N 313,238.07  
E 1,583,902.08

SECURITY

Ice And Cold

COLD

121+08.1 PS  
120+89.4 PS

Dwarf Signal

STORAGE

WAREHOUSE

Storage Plant

DAY 8

Platform

32+78.7 BC 12°30'

YOUNG

CO.

AND

EC

117+80 PS (Sc.)

Surfaced

SANTA CLARA  
FROSTED FOODS CO

Platform

116+11.0 Light Signal

37+18.2 BC 12°30'  
37+04.1 PS

Opp. 114+51.4 PS

30+28

31+88

33+08

15  
14  
13  
12  
11  
10  
9  
8  
7  
6  
5

120.0

20'

25'

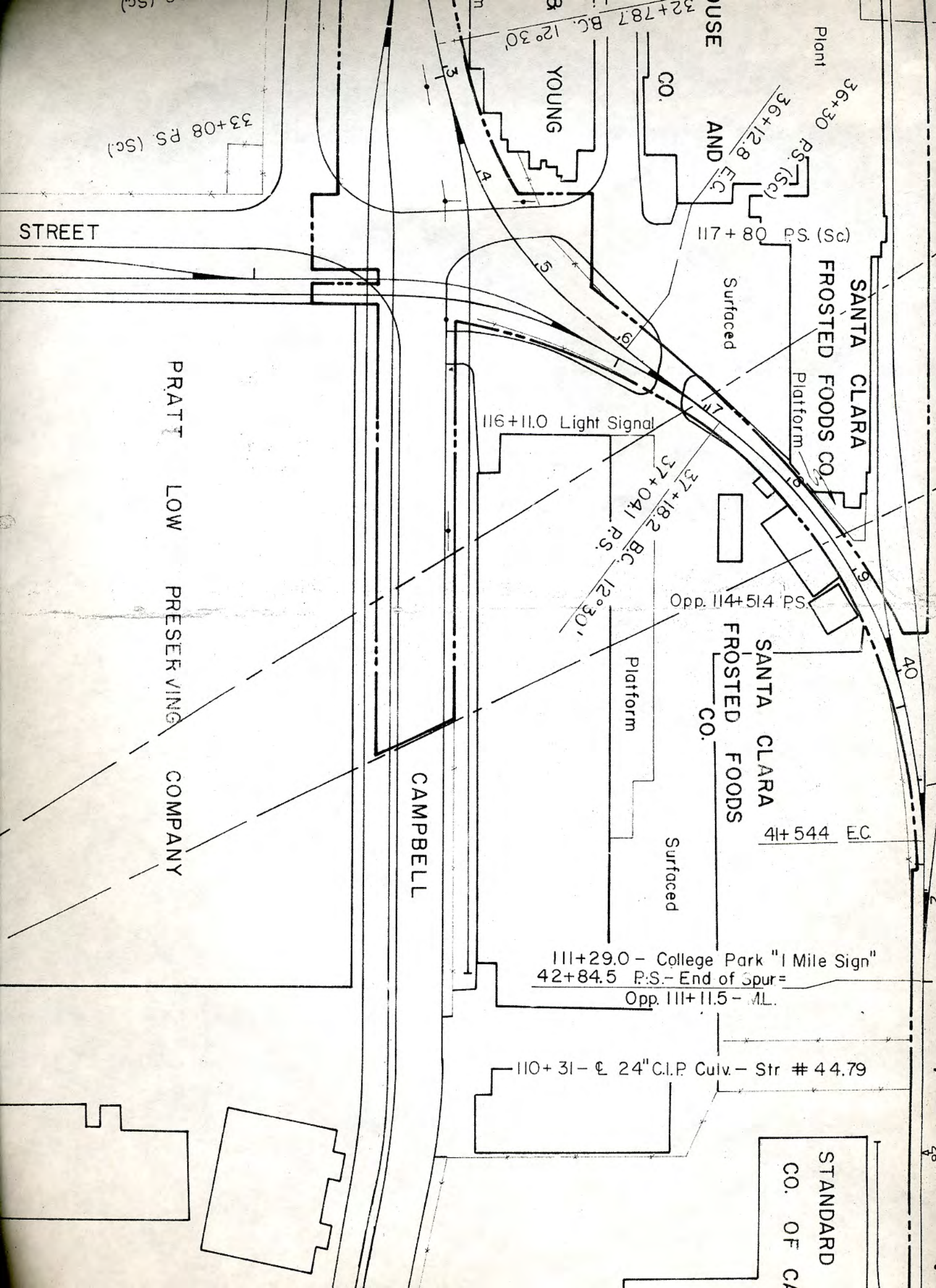

VING COMPANY

CAMPBELL

atform

TA CLARA  
TED FOODS  
CO.

41+544 EC

Surfaced

111+29.0 - College Park "1 Mile Sign"  
42+84.5 P.S. - End of Spur=  
Opp. 111+11.5 - ML.

110+31 -  $\phi$  24" C.I.P. Culv. - Str # 44.79

STANDARD OIL  
CO. OF CALIF

Opp. 106+35.0 P.S. # 9

SECURITY  
COLD  
WAREHOUSE  
STORAGE  
AND  
CO.

102+33.5 Whistle Post

S.P. Co.

S.P. Co. Signal Line

WAREHOUSE AND STORAGE CO.

102+33.5 Whistle Post

AVENUE

100+84.0 Whistle Post  
Opp. 100+66.6 P.S. # 7  
Opp. 100+54.0 P.S. # 7

45 □

TUXEDO CANDY COMPANY  
DIVISION OF  
SAFEWAY STORES, INC.

98+99.5

97+07  $\phi$  18" x 415' Conc. & Corr.  
Iron Pipe - Str. # 45.04

96+31.0 = Signal # 450  
Relay Case

13° Cv

E-71



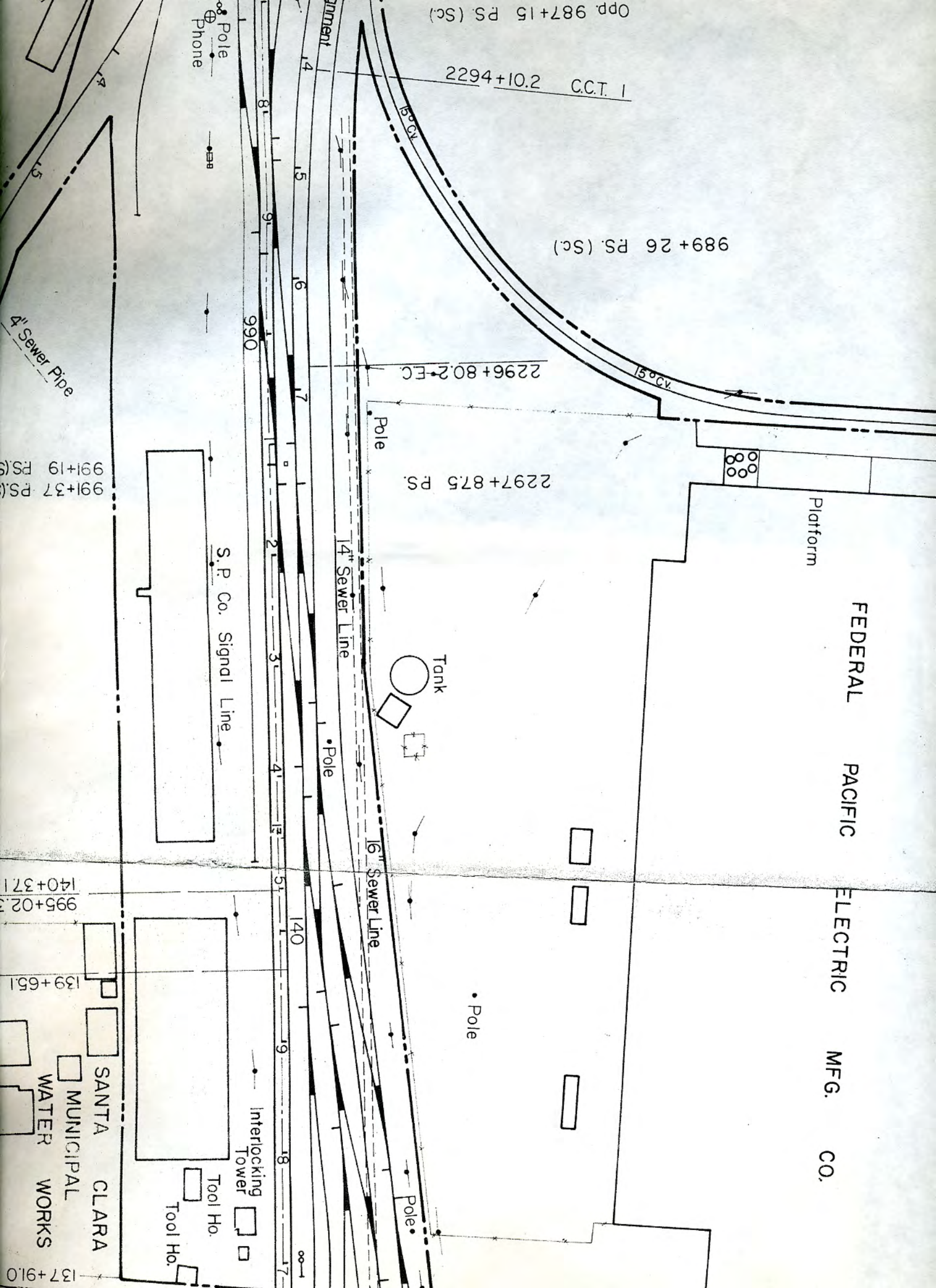

Opp. 987+15 PS. (Sc.)

2294+10.2 C.C.T. 1

989+26 PS. (Sc.)

2296+80.2 EC

2297+875 PS.

991+37 PS. (Sc.)  
991+19 PS. (Sc.)

995+02.3  
140+37.1

139+65.1

137+91.0

FEDERAL  
PACIFIC  
ELECTRIC  
MFG.  
CO.

Platform

Tank

S.P. Co. Signal Line

14" Sewer Line

16" Sewer Line

Interlocking Tower

Tool Ho.

Tool Ho.

SANTA CLARA

MUNICIPAL

WATER WORKS

Pole  
Phone

Pole

Pole

Pole

4" Sewer Pipe

ELECTRIC MFG. CO.

995+02.3 P.O.T. =  
140+371 E.C.

139+651 E.C.-W.E.

(S.C.)

137+91.0 Signal

T.C. 6°18'

B.C. - 0°30' Lt.

-0°30' Lt.-W.B.

STREET

Surfaced

P

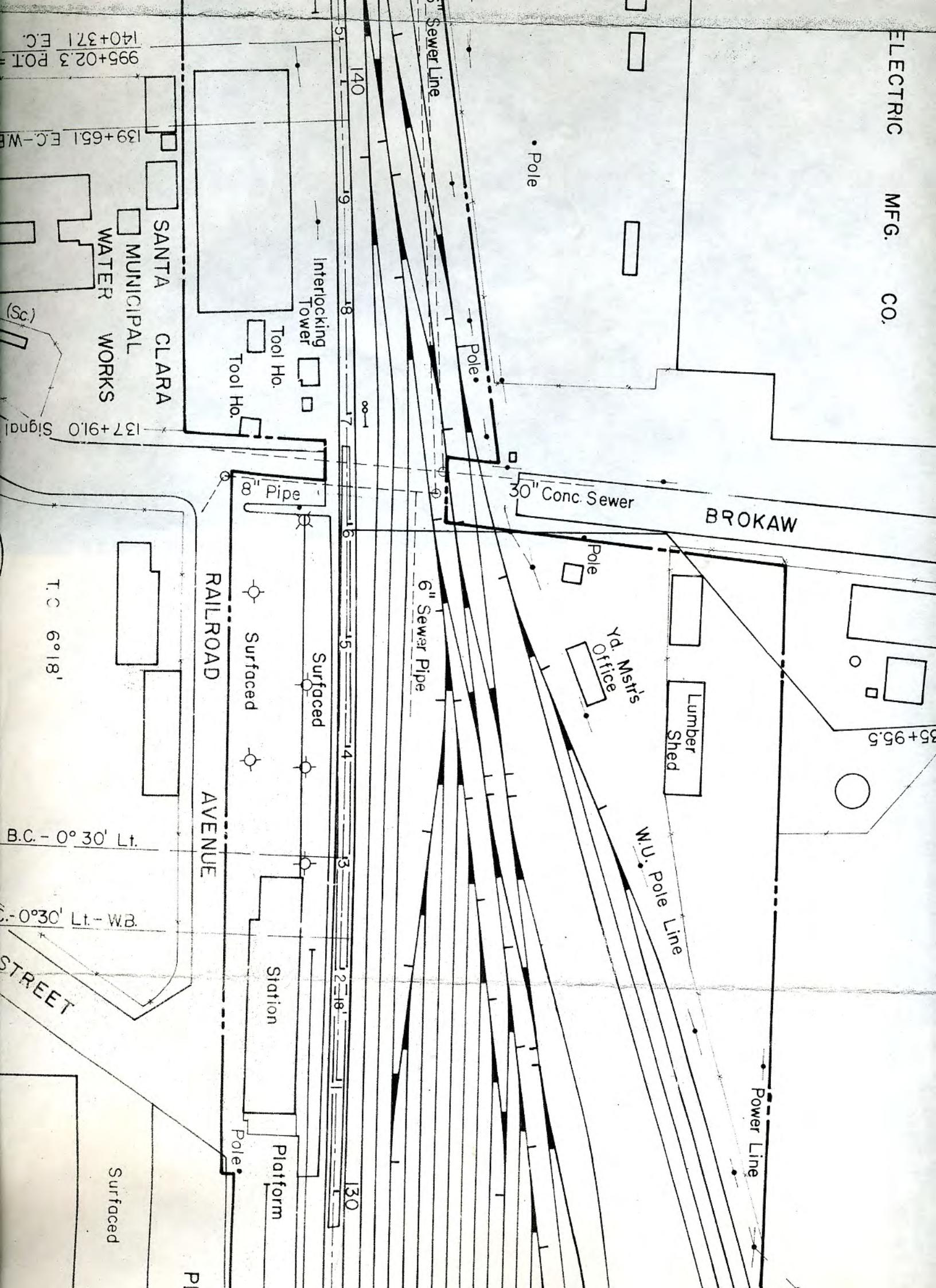

SANTA CLARA  
MUNICIPAL  
WORKS

RAILROAD AVENUE

Station

Platform

Surfaced

Surfaced

130

131

132

133

134

135

136

137

138

139

140

6" Sewer Pipe

30" Conc. Sewer

BROKAW

M.U. Pole Line

Power Line

Lumber Shed

Ypl. Mstr's Office

Interlocking Tower

Tool Ho.

Tool Ho.

Pole

Pole

Pole

Pole

35+95.5

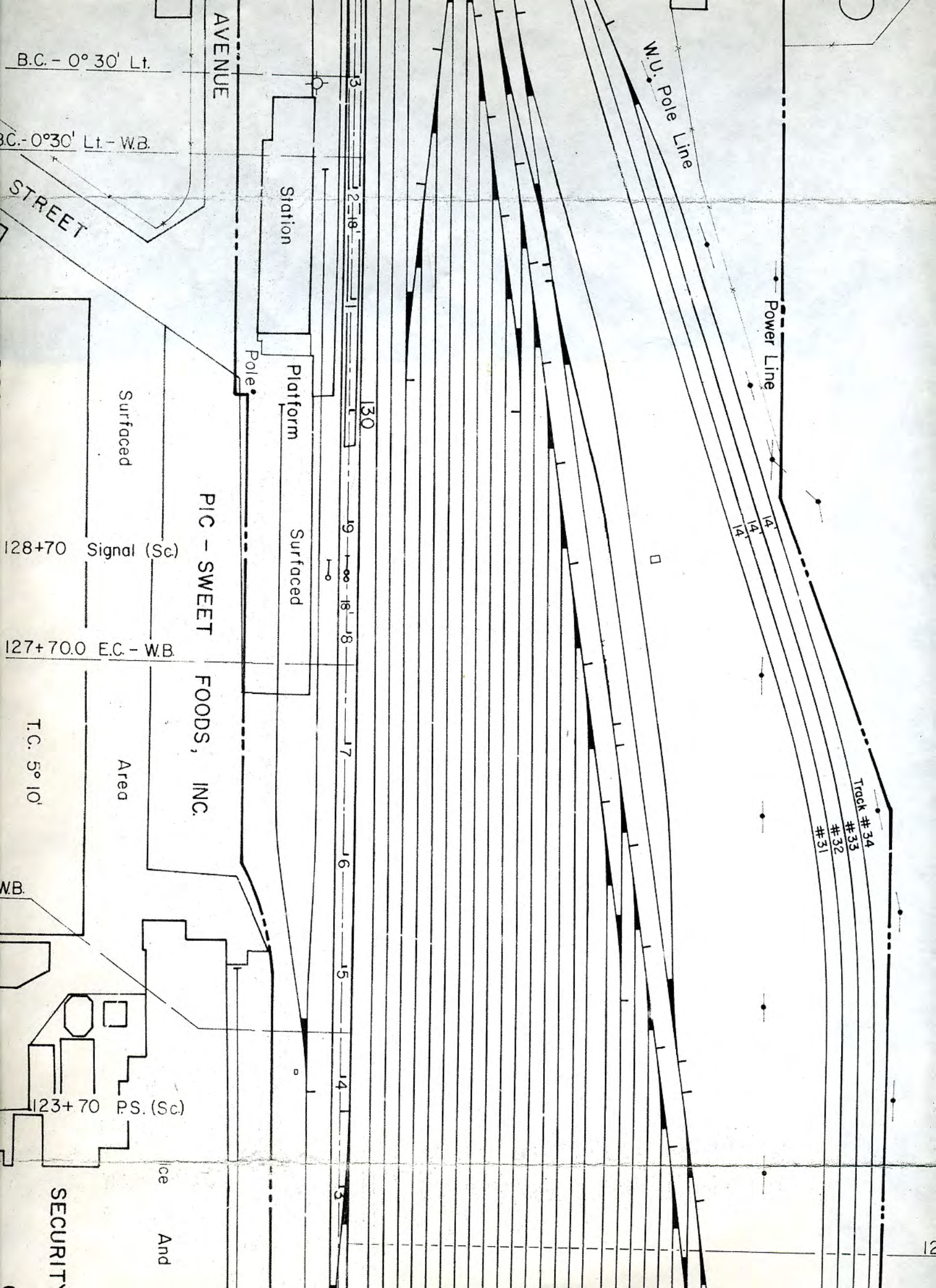

B.C. - 0° 30' Lt.

B.C. - 0° 30' Lt. - W.B.

STREET

AVENUE

Station

Platform

Surfaced

PIC - SWEET  
FOODS, INC.

Surfaced

Area

128+70 Signal (Sc)

127+70.0 E.C. - W.B.

T.C. 5° 10'

W.B.

123+70 PS. (Sc)

SECURITY

ice  
And

W.U. Pole Line

Power Line

Track # 34  
# 33  
# 32  
# 31

3  
2  
18'  
130  
19  
18  
18  
17  
6  
15  
14  
13

14'  
14'  
14'

+ 70 PS. (Sc)

SECURITY

WAREHOUSE

AND

PS. (Sc)

Surfaced

14 51.4 PS

SANTA CLARA  
FROSTED FOODS

Ice And Cold Storage Plant

E-72 N 313,238.07  
E 1,583,902.08

36+30  
36+12.8  
PS (Sc)

SANTA CLARA  
FROSTED FOODS CO.  
Platform

SANTA CLARA  
FROSTED FOODS

14  
13  
12  
11  
10  
9  
8  
7  
6  
5  
4  
3

120

20

0-1

25

40

13

122+480

119+19.1 B

M

Track # 16

• Sign

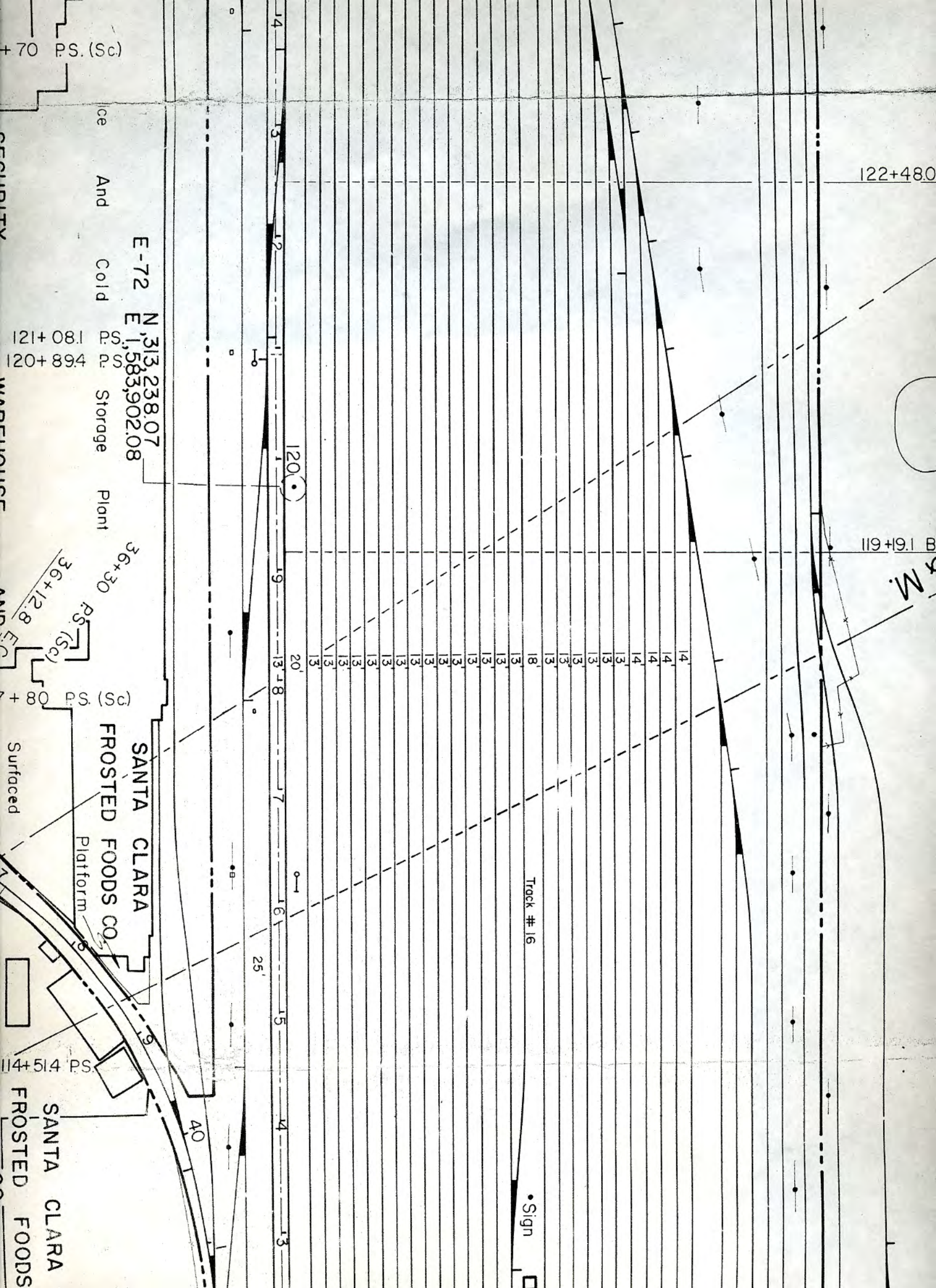

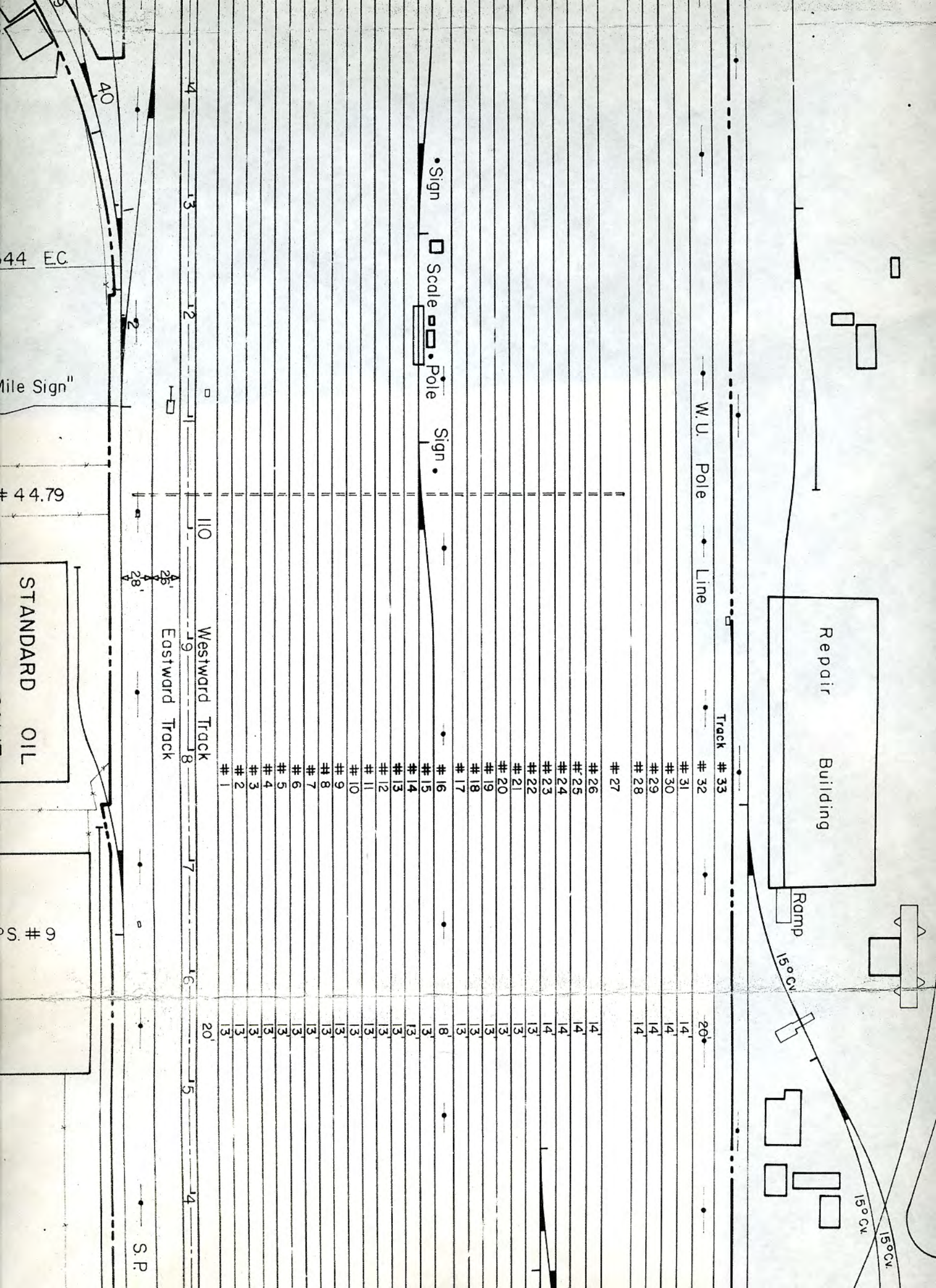

Repair Building

Ramp

W.U. Pole Line

Track # 33

- # 31 14'
- # 30 14'
- # 29 14'
- # 28 14'
- # 27
- # 26 14'
- # 25 14'
- # 24 14'
- # 23 14'
- # 22 13'
- # 21 13'
- # 20 13'
- # 19 13'
- # 18 13'
- # 17 13'
- # 16 18'
- # 15 13'
- # 14 13'
- # 13 13'
- # 12 13'
- # 11 13'
- # 10 13'
- # 9 13'
- # 8 13'
- # 7 13'
- # 6 13'
- # 5 13'
- # 4 13'
- # 3 13'
- # 2 13'
- # 1 13'

Westward Track

Eastward Track

S. R

STANDARD OIL

S. # 9

Mile Sign"

# 44.79

44 EC

40

110 8 7 6 5 4

28'

2

3

4

15° Cv

15° Cv

15° Cv

20'

P.S. # 9

Post

Post  
P.S. # 7  
P.S. # 7

& Corr.  
45.04

# 450  
y Case

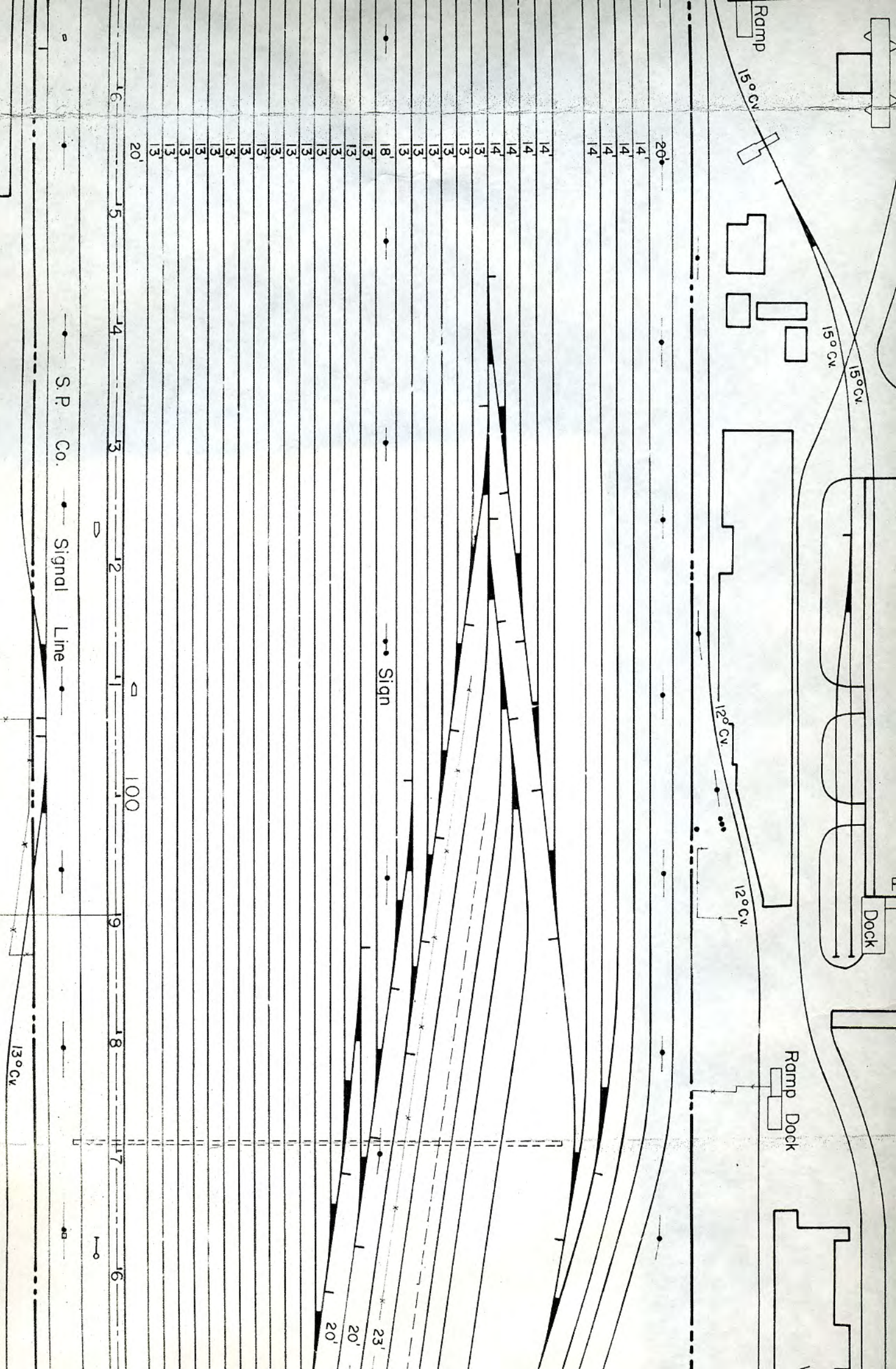

& Corr.  
45.04

# 450  
Case

E-71

N 311,382.35  
E 1,586,280.12

# 451  
Case

ary Sewer

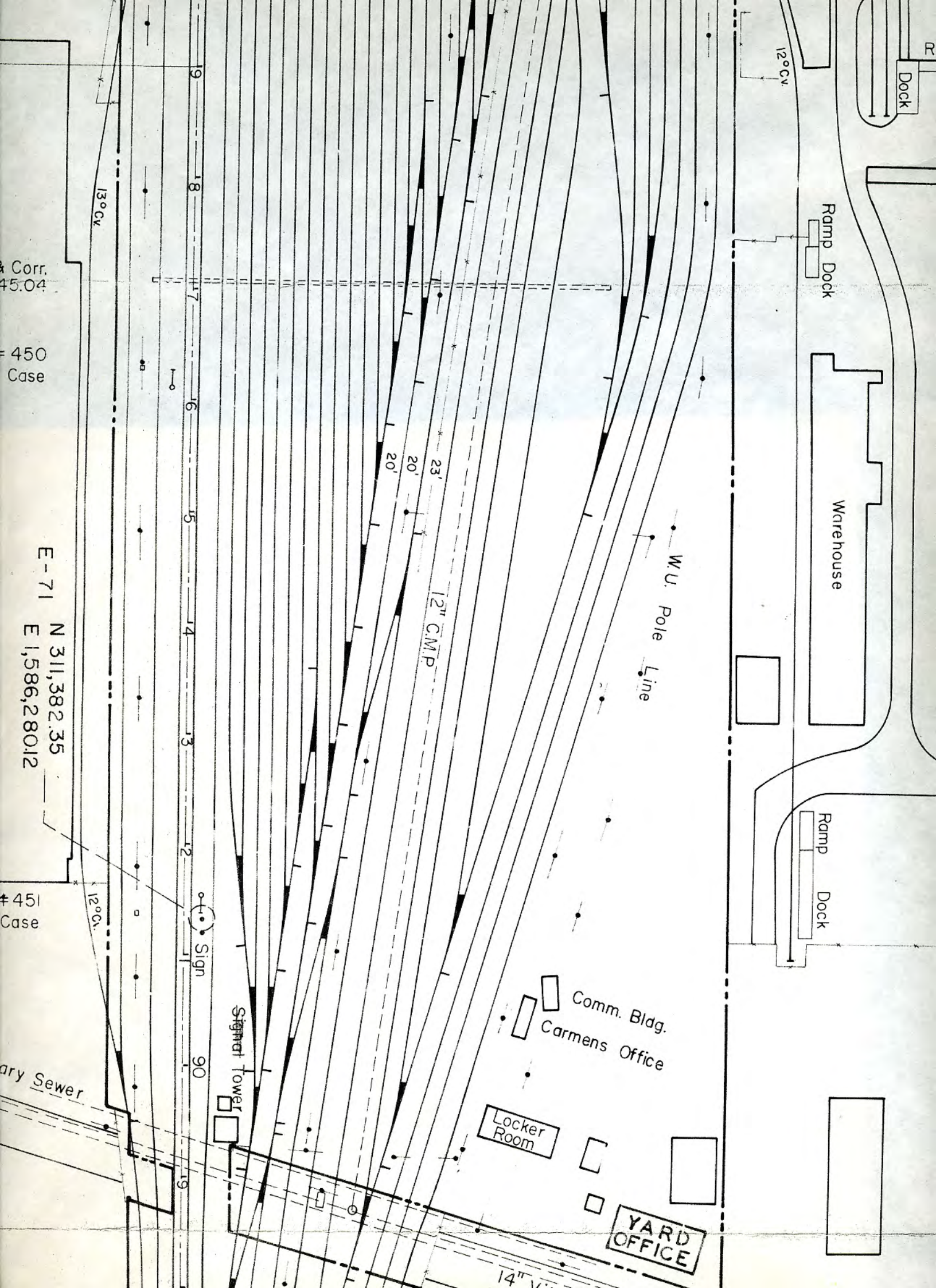

Dock

Ramp Dock

Warehouse

Ramp Dock

W.U. Pole Line

12" C.M.P.

20'

20'

23'

Sign

Signal Tower

90

Comm. Bldg.  
Carmens Office

Locker Room

YARD OFFICE

14" V.I.

13° Cv

12° Cv

12° Cv

19

18

17

16

15

14

13

12

11

10

9

8

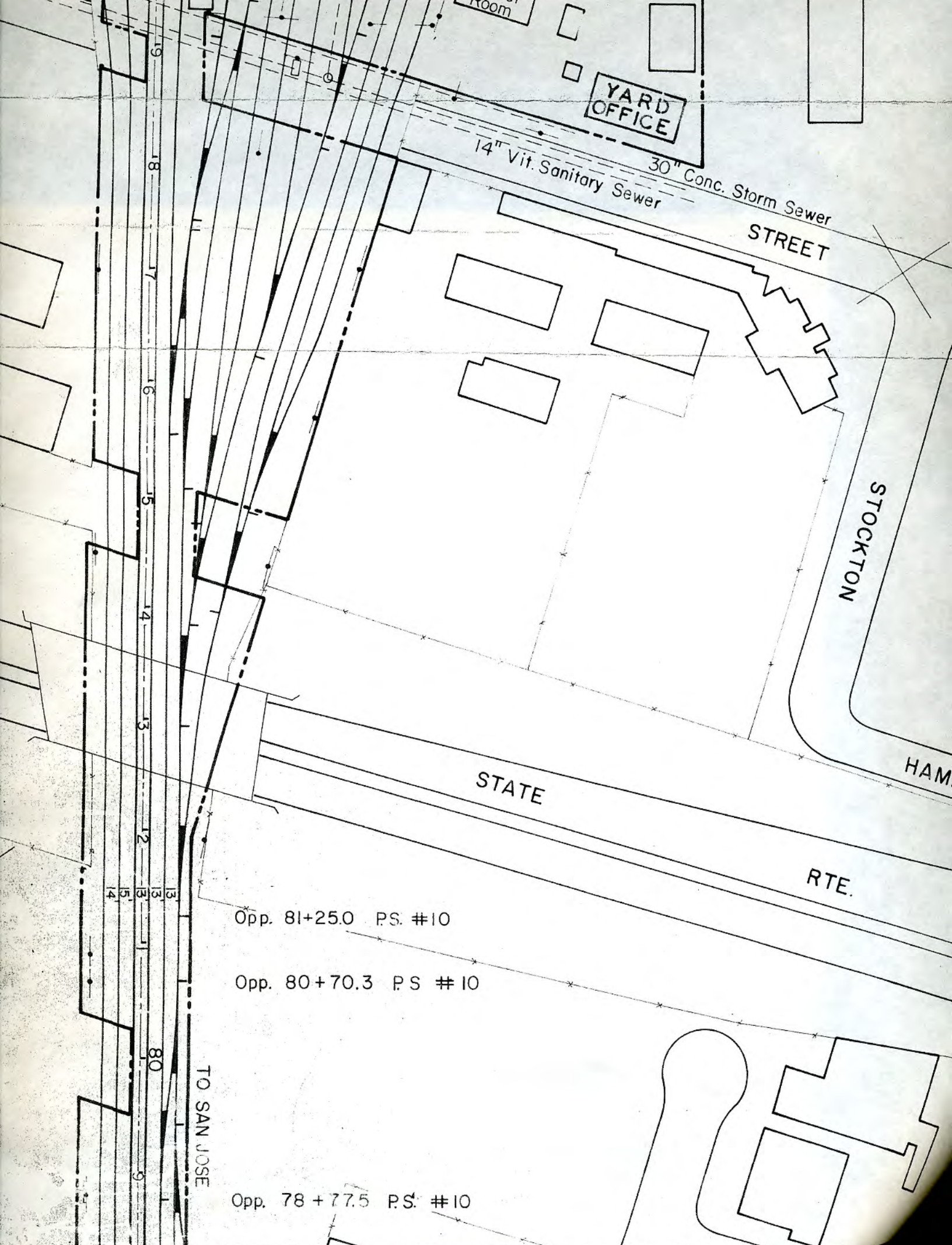

YARD OFFICE

14" Vit. Sanitary Sewer  
30" Conc. Storm Sewer

STREET

STOCKTON

HAM

STATE

RTE.

Opp. 81+25.0 P.S. #10

Opp. 80+70.3 P.S. #10

TO SAN JOSE

Opp. 78+77.5 P.S. #10