

Southern Pacific drawing of trackage from Santa Clara and College Park, 1958

contents

2. east of Newhall Yard throat
3. west of Stockton Ave.
4. Stockton Ave. / College Park station
5. College Park Tower & west leads to C.P. Yard & roundhouse
6. west end of College Park Yard & roundhouse
7. central College Park Yard & roundhouse
8. east College Park Yard & roundhouse
9. Lenzen Ave. Roundhouse & turntable
10. west leg, San Jose Wye
11. east leg, San Jose Wye
12. east end, College Park Yard
13. Guadalupe River
14. west Bassett Street Yard leads
15. Bassett Street freight station
16. pre-1935 passenger station site
17. east leads, Bassett Street yard
18. former Fourth Street Main Line
19. industrial trackage south of Bassett St.

STOCKTON

ST

(Formerly Morris St.)

Sign Santa Clara 1 Mile

Garage 49' x 27'

MUTUAL WHOLESALE GROCERY CO. WAREHOUSE

STREET

SHELL OIL CO

Office

Oil Tank Rock 6 Tanks

GMO#46567 T-3254

T-Platform

80' Ext. No GMD T-4303 7-29

GMO #17373 T-9433 Cl. Pt. to End - 302'

6" C.I. Water Line

13' 81' 12"

15'

14'

16' SOUTHERN

71 SOUTH

73 PACIFIC

74 PACIFIC

GMO#35023

GMO#35028

GMO#35028

T-12600 with T-10312
GMO#28837 Jan 1945

VERMONT

Prop. Post

(LAUREL ST. Closed

RICHMOND - CHASE CO.

Prop. Post

1 x 37.5' End S.P. Rock

Ind. Por 324'

CHASE CANDY CO.

Res No 3020 Oct. 2, 1944
(Ord. Audit No 1174) (165/322-2)

Dirt Bump

783.16

ROCKTON

UAL WHOLESALE
ROCERY CO.
AREHOUSE

STREET

SHELL OIL CO

Oil Tank Rack 6 Tanks

Office

GMO #46567
27' T-3254

104 T-7102

7' Platform

80' Ext. No GMO
T-4303 7-29

HEDDING

GMO #80200 & 80201 Mar. 1929

AVENUE

P.U.C. # E-45.65

SOUTHERN

71 SOUTH 72

73 PACIFIC 72

74 PACIFIC 71

76 RAIL ROAD 68

79 COAST

78 COMPANY 65

Ind Par 324'

GMO #35028

T-12600 with T-10312
GMO #28837 Jan 1945

CHASE CANDY CO.

Res No 3020 Oct. 2, 1944
(Ord. Audit No 1174)

(65/373-2)

70+0360
P.U.C. # E-45.6

Dirt Bump

234E

4593

67+243 PS 106

Rail Bridge #455

Slowboard 30.20

Prop. Post.

AVENUE

COLLEGE PARK
Mi. 45.7

CHEST

ASSOCIATED
Oil Co.

San Jose Spray Mfg. Co.

P.U.C. # E-45.65

EXP. P.U.C. # E-45.7

ROAD

66 COMPANY 65

RAILWAY

Gravel Platform

COAST

PACIFIC
AG

67+243 P.S. 106

Signal Bridge #455

Slowboard 30-20

College Park Shelves Sheds

59+9756

47630

1500

612

25035

200°

100°

50°

50°

1000

1100

90°

Sta P. 62+035

Office

Oil Tank

Warehouse

Covered Platform

Shop

Platform

T. 352

T. 770

Water Line

L=800

#10 L=780

#10 L=780

#10 L=780

#10 L=780

#10 L=780

#10 L=780

#10 L=780

#10 L=780

#10 L=780

#10 L=780

#10 L=780

#10 L=780

#10 L=780

#10 L=780

#10 L=780

#10 L=780

T. 5254

C.P. to end

406

610+67919

60+240 Dwarf Signal

60+240

60+240

60+240

60+240

60+240

60+240

60+240

60+240

60+240

60+240

60+240

CHESTNUT

STREET

End of Dbl. Track - Mile 45.9095

J. D. CHASE

ASSOCIATED OIL CO.

Shop

Low Ground

Log in Gravel

2394+54.83

Guard Rail 50+52.0 P.F. #9 MAIN

0+00.0 B.C. 59°30' Lt. LADDER

+53° B.C. 6° Lt.

50+19.6 Δ on Tang.

46+85.4

587.42

2295+73.24

L=802 #10

#10 L=782

#10 L=782

L=782 #10

#10 L=782

#14 L=1112

#9

365'

+456 P.S.

+2865 P.S.

#10 L=782

16' L=782

#10

2398

#9

#14 L=1112

L=782 #10

#9

#10 L=782

#10 L=782

#520

#510

#500

98+34.5 E.C.

PACIFIC COAST AGGREGATES, INC.

NEHI BOTTLING CO.

GEO. RAGGIO CONCRETE PIPE CO.

P.U.C. #E-45.9-B

SAN JOSE DOOR & PLYWOOD CO.

2325+71.61 C.C. 2'

95+912

B.C. 38

416

51+74.41 P.O.T. Signal #45C

2393+77.67 9.C.S. 1

City of San Jose

464.81

55+020.2

SBURY

ANN

STOCKTON

WESTERN Signal Bridge

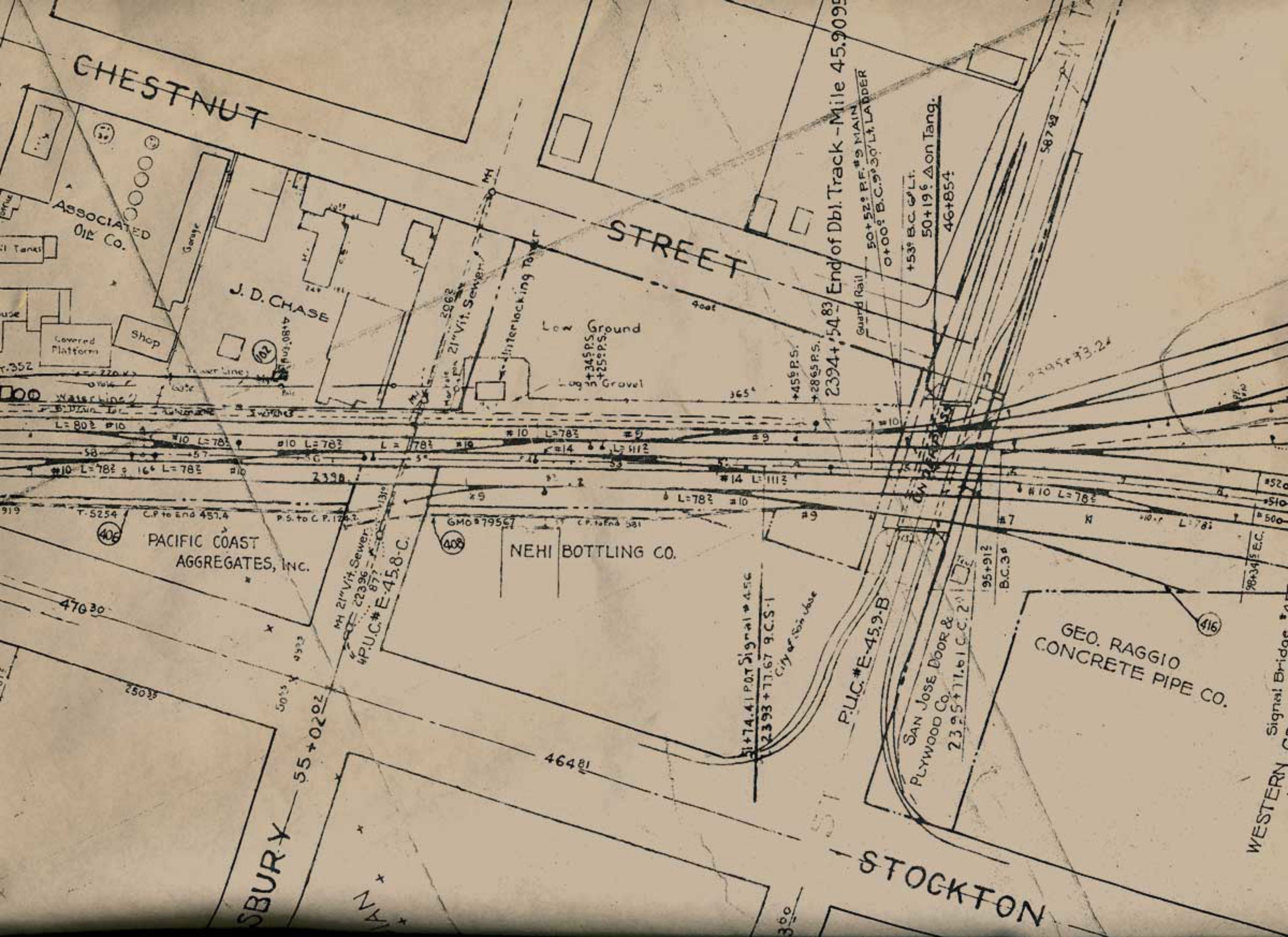

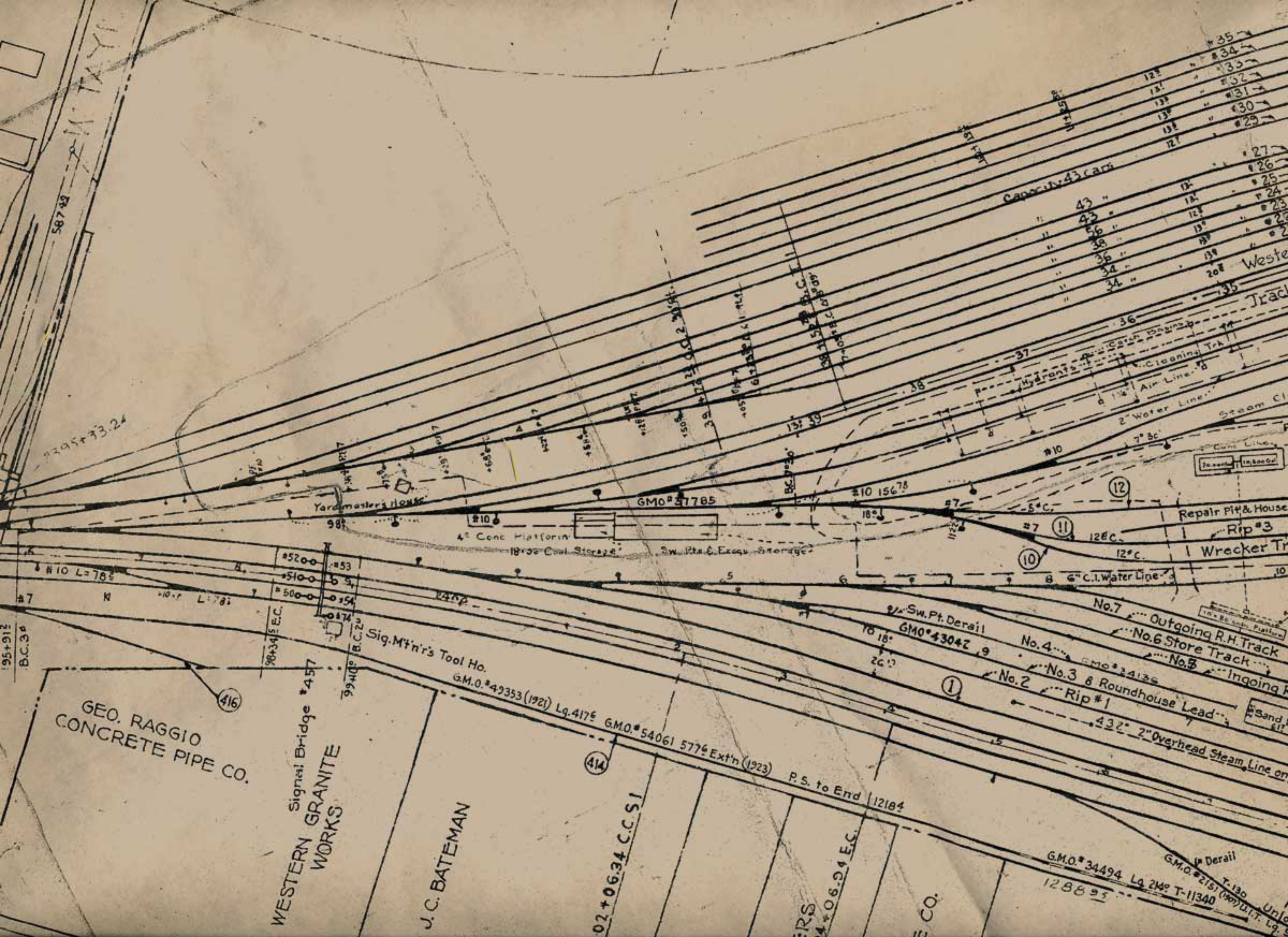

587 49

2395+33.24

Capacity: 43 cars

Wester
Track

Yardmaster's House

GM O # 37785

4' Conc Platform

18' x 30' Coal Storage

Sw. Pts. & Excess Storage

Repair Pit & House

Rip #3

Wrecker Tr

Outgoing R.H. Track

No. 6 Store Track

Ingoing R.H. Track

No. 3 8 Roundhouse Lead

Rip #1

Sw. Pt. Derail

No. 7

No. 6

No. 5

No. 4

No. 3

No. 2

No. 1

GEO. RAGGIO
CONCRETE PIPE CO.

Signal Bridge #457
WESTERN GRANITE
WORKS

J. C. BATEMAN

02+06.34 C.C.S.I

04+06.34 E.C.

GM O # 34494 Lq. 244' T-11340
1288 95

GM O # 2151 T-130
1288 95

95+912

B.C.36

416

414

1

10

11

12

#10 15678

13:39

13:39

13:39

13:39

13:39

13:39

13:39

13:39

13:39

13:39

13:39

13:39

13:39

13:39

13:39

Sw. Pt. Derail

Sw. Pt. Derail

Sw. Pt. Derail

Sw. Pt. Derail

Sw. Pt. Derail

Sw. Pt. Derail

Sw. Pt. Derail

Sw. Pt. Derail

Sw. Pt. Derail

Sw. Pt. Derail

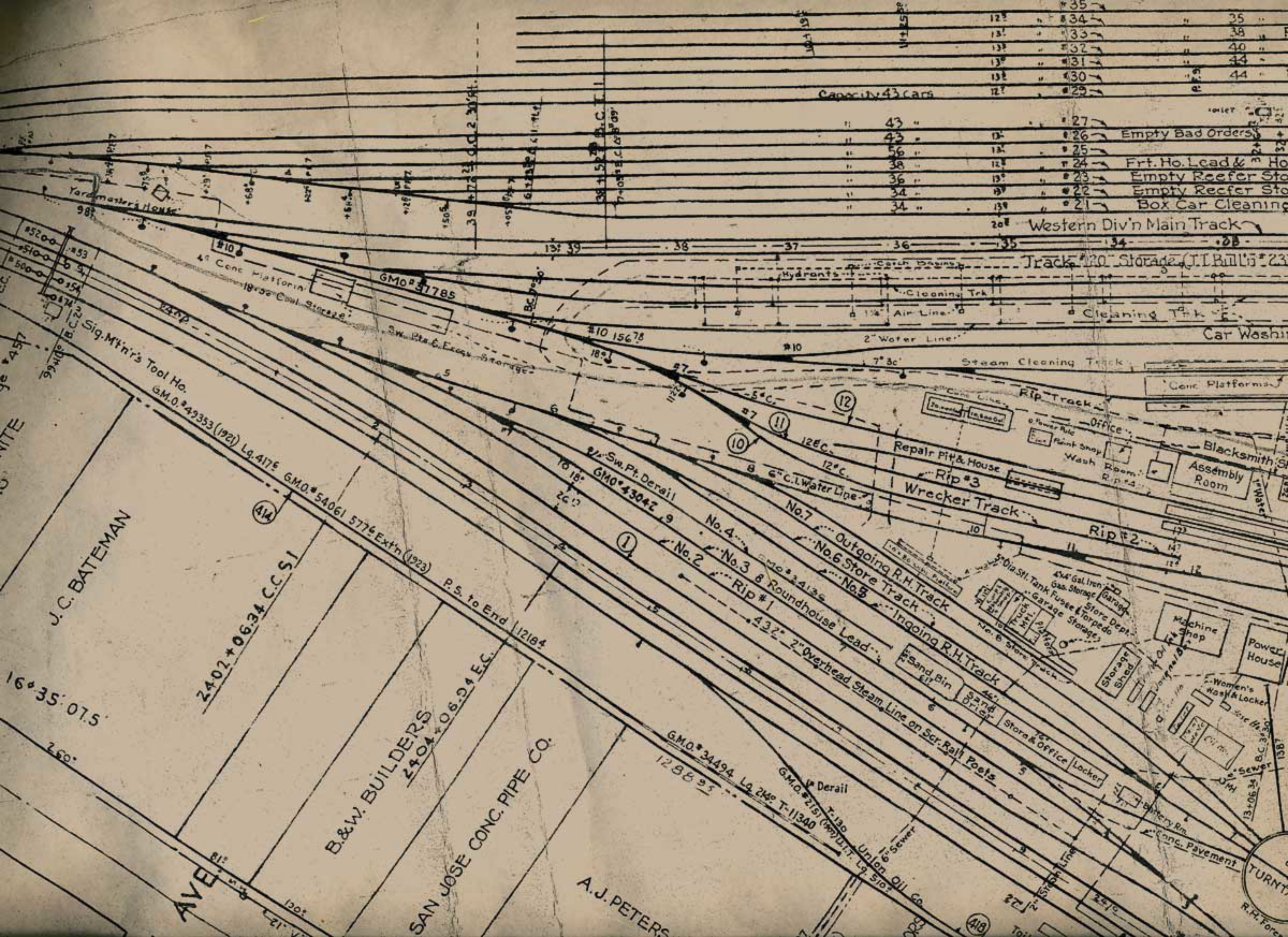

12	#34	35
13	#33	38
13	#32	40
13	#31	44
13	#30	44
12	#29	

Capacity 43 Cars

- #27
- #26 Empty Bad Orders
- #25
- #24 Frt. Ho. Lead & H
- #23 Empty Reefer Sto
- #22 Empty Reefer Sto
- #21 Box Car Cleaning
- Western Div'n Main Track

Track #20 Storage (J.L. Bullis #23)

#5200	#53
#5100	#54
#5000	#55
#4900	#56
#4800	#57
#4700	#58
#4600	#59
#4500	#60

J.C. BATEMAN

16° 35' 07.5

260'

AVE

B.&W. BUILDERS

SAN JOSE CONC. PIPE CO.

A.J. PETERS

Sig. Mfr's Tool Ho.

G.M.O. #42353 (1921) Lq. 417'

G.M.O. #54061 577' Ext'n (1923)

P.S. to End 12184

2402 + 06.34 C.C.S.I

2404 + 06.24 E.C.

G.M.O. #34494 Lq. 244' T-11340

G.M.O. #2151 T-130

Union Oil Co.

Battery Rm.

Conc. Pavement

TURN

R.R. For

12	#35	..	35	Local Cars
13	#34	..	38	Perishables & Icers
13	#33	..	40	Train Yard
13	#32	..	44	Train Yard
13	#31	..	44	Receiving Track
12	#30	..	44	Receiving Track
12	#29	..		

Box Car Cleaning Tracks

27	#27		30	Pole Shanty
12	#26	Empty Bad Orders		Washing & Cleaning Track
13	#25			Storage Track
12	#24	Frt. Ho. Lead & House Cars		
13	#23	Empty Reefer Storage		
13	#22	Empty Reefer Storage		
13	#21	Box Car Cleaning Track		
20	#20	Western Div'n Main Track		

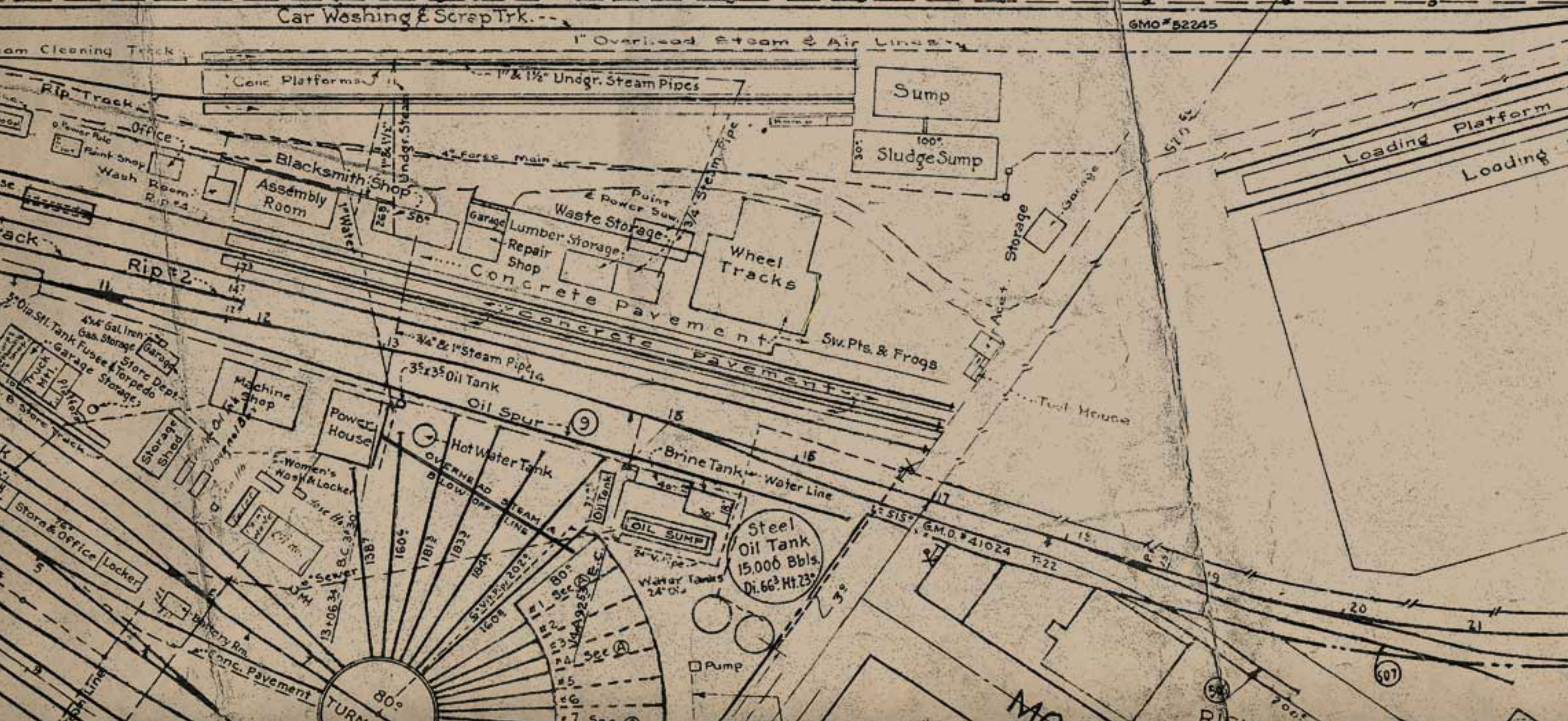

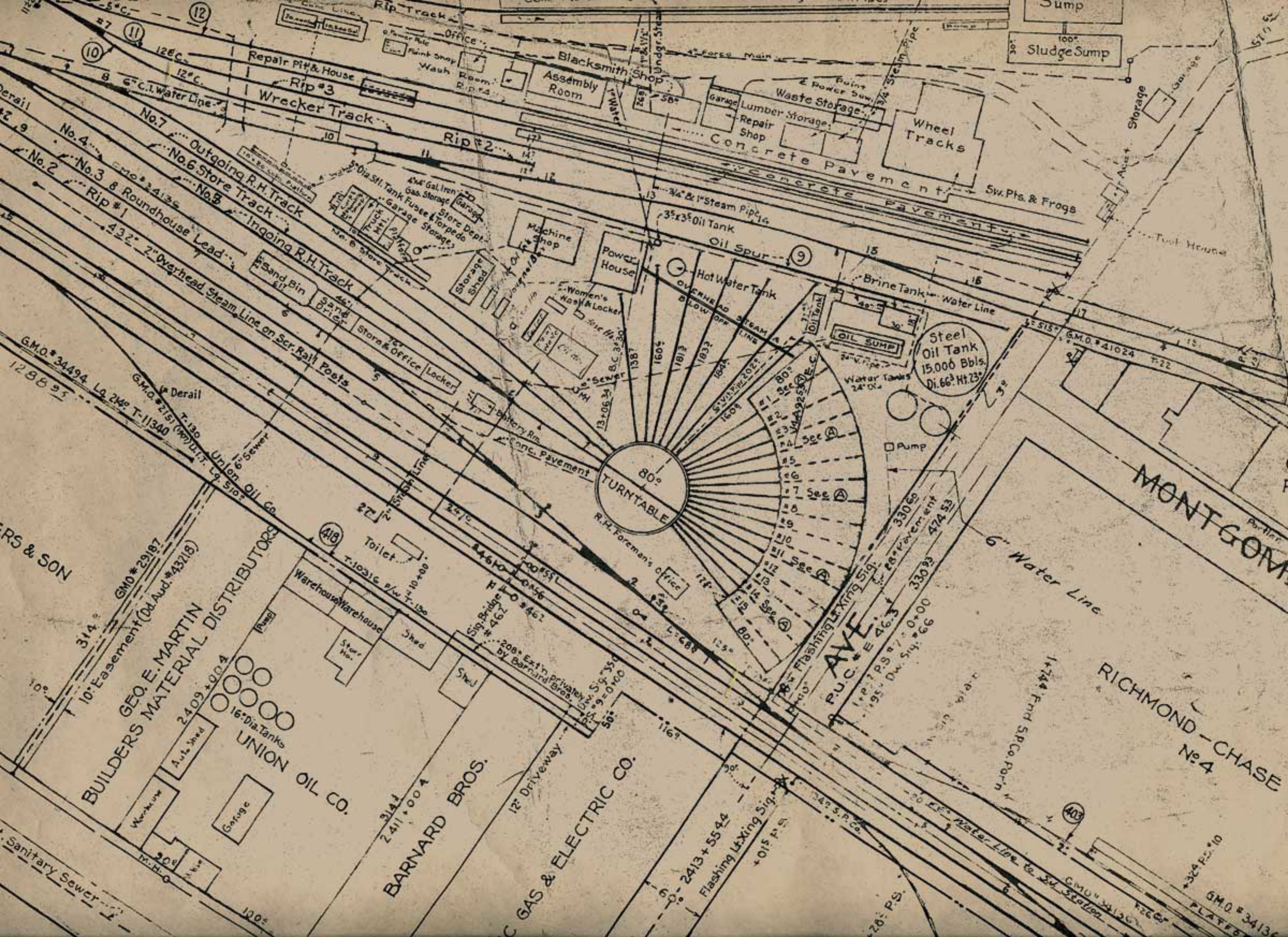

126° C. 12° C. 6" C.I. Water Line

Rip Track
Office
Paint Shop
Wash Room
Rip #4

Blacksmith Shop
Assembly Room
Garage
Lumber Storage
Waste Storage
Repair Shop
Concrete Pavement

Sump
Sludge Sump
Storage

Detail
No. 9
No. 4
No. 3
No. 2
Rip #1
No. 7
No. 6 Store Track
No. 5
No. 8 Roundhouse Lead
No. 10
Ingoing R.H. Track
Outgoing R.H. Track

Machine Shop
Power House
Hot Water Tank
Brine Tank
Water Line
Steel Oil Tank
15,000 Bbls.
Di. 66" Ht. 23'

Oil Spur
Hot Water Tank
Water Tanks
24" Dia.
Pump
Oil Tank
Water Line
3" x 3" Oil Tank
3/4" & 1" Steam Pipe

Oil Tank
Water Tanks
24" Dia.
Pump
Oil Tank
Water Line
3" x 3" Oil Tank
3/4" & 1" Steam Pipe

Storage
Tool House
G.M.O. # 41024
T-22

G.M.O. # 34494
L-4 24" T-11340
1288 95
G.M.O. # 2151
T-130
Union Oil Co.
6" Sewer
L-9 510'

Sand Bin
Sand Drier
Store & Office
Locker
Bakery Rm.
Conc. Pavement
R.H. Foreman's Office

80' TURNTABLE
R.H. Foreman's Office
Flashing Lt. Xing Sig.
33060
33093
33099
474 53

PUC AVE
Flashing Lt. Xing Sig.
33060
33093
33099
474 53
6" Water Line

MONTGOMERY ST
RICHMOND-CHASE No. 4

RS & SON
G.M.O. # 29187
10' Easement (Dd. Aud. # 43218)
GEO. E. MARTIN
BUILDERS MATERIAL DISTRIBUTORS
Warehouse
Auto Shed
16" Dia. Tanks
UNION OIL CO.
Garage

Warehouse
Warehouse
Shed
Toilet
T-10316
P/W T-130
Sig. Bridge # 462
208' Ex-1'n privately by Barnard Bros.
12" Driveway

12" Driveway
C. GAS & ELECTRIC CO.
Flashing Lt. Xing Sig.
2413 + 55 44
+ 015 P.S.

PUC AVE
Flashing Lt. Xing Sig.
33060
33093
33099
474 53
6" Water Line
1+74' Fnd S.P. Co. P-n

RICHMOND-CHASE No. 4
G.M.O. # 3413
PLATE

Sanitary Sewer
100'

BARNARD BROS.
C. GAS & ELECTRIC CO.

Flashing Lt. Xing Sig.
2413 + 55 44
+ 015 P.S.

6" Water Line
1+74' Fnd S.P. Co. P-n
G.M.O. # 3413
PLATE

RICHMOND-CHASE No. 4
G.M.O. # 3413
PLATE

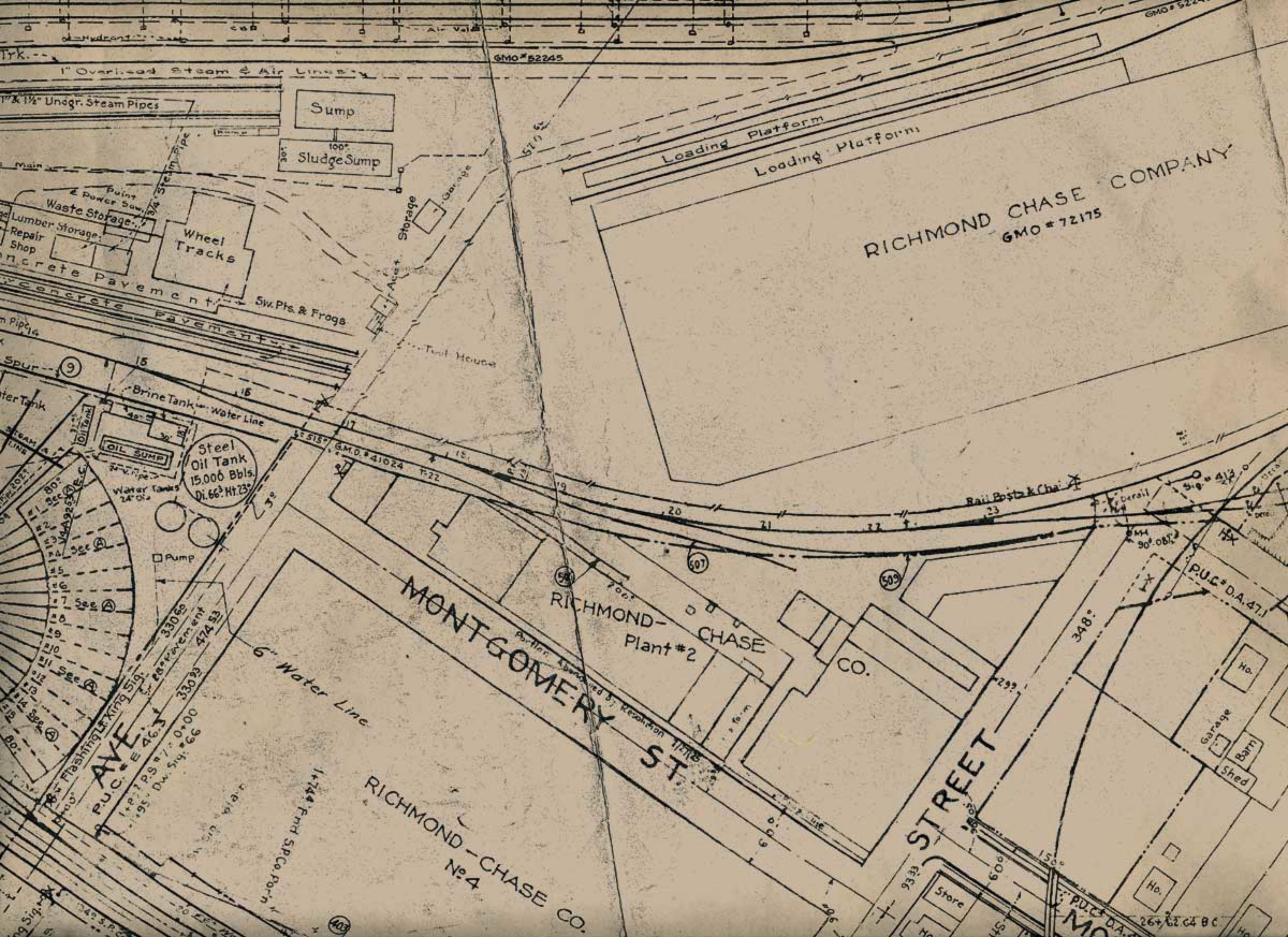

GMO # 52245

1" Overhead Steam & Air Lines

1" & 1 1/2" Undgr. Steam Pipes

Sump

100' Sludge Sump

Loading Platform

Loading Platform

RICHMOND CHASE COMPANY
GMO # 72175

Wheel Tracks

Waste Storage

Lumber Storage

Repair Shop

Concrete Pavement

Siv. Pts. & Frogs

Tool House

Spur 9

Brine Tank

Steel Oil Tank
15,000 Bbls.
Di. 66' Ht. 23'

OIL SUMP

Water Tank

Water Line

G.M.O. # 41024

Rail Posts & Chair

RICHMOND-CHASE
Plant #2

CO.

MONTGOMERY ST.

STREET

RICHMOND-CHASE CO.
No. 4

6" Water Line

AVE.

Ho.

Garage

Barn

Shed

Store

Ho.

P.U.C. D.A. 47.1

26+62.64 B.C.

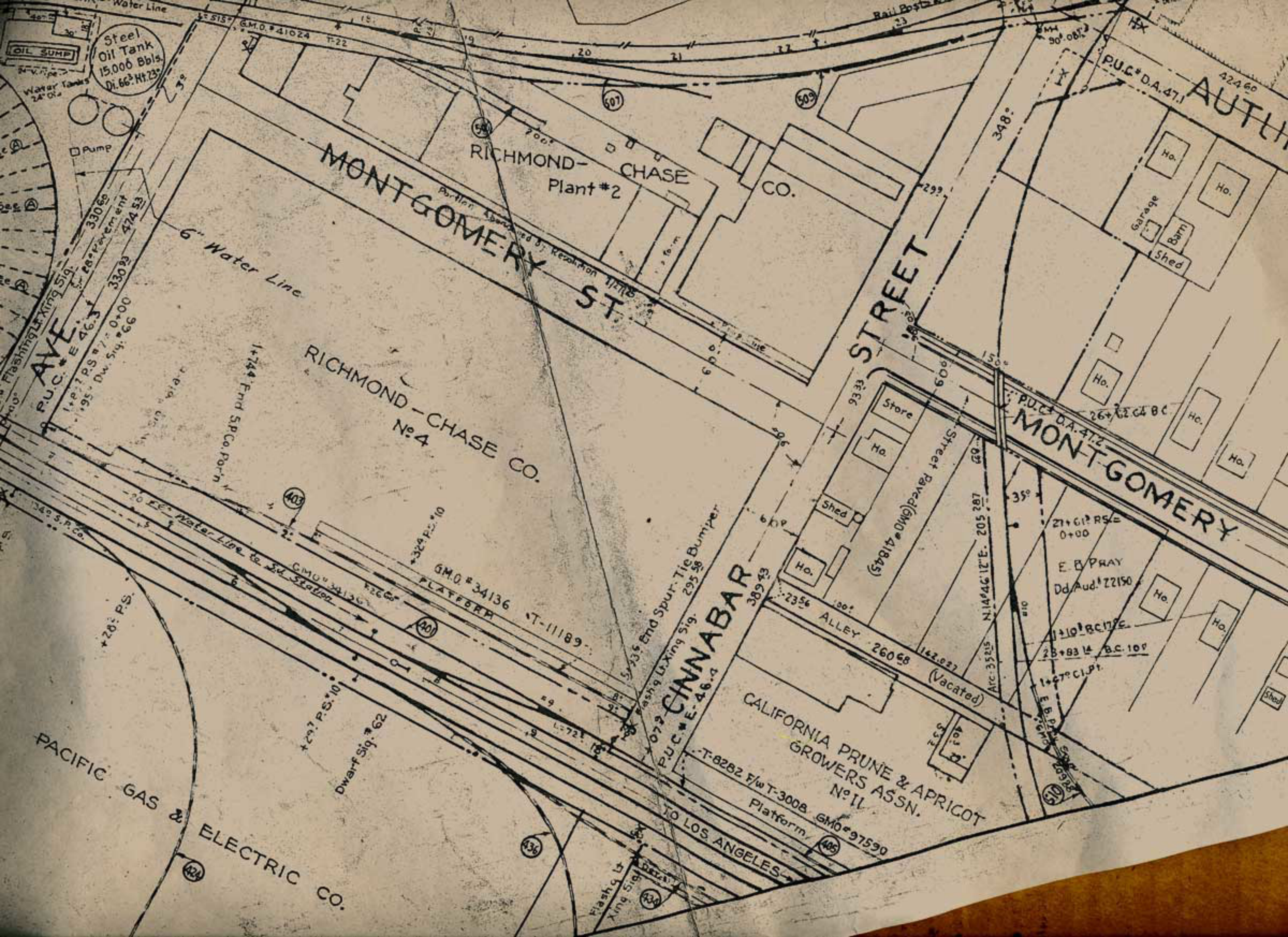

Steel Oil Tank 15,000 Bbls. Di. 66' Ht. 23'

OIL SUMP

Water Tanks 24' Dia.

Pump

RICHMOND-CHASE CO. Plant #2

MONTGOMERY ST

STREET

RICHMOND-CHASE CO. No. 4

6" Water Line

AVE

MONTGOMERY

CINNABAR

CALIFORNIA PRUNE & APRICOT GROWERS ASSN. No. 11

PACIFIC GAS & ELECTRIC CO.

AUTH

P.U.C. # 41024
1+P.7 PS # 7:0+00
1+95. D.W. Sig. # 66
33069
28' Pavement
33093
474.53

Water Line to S.V. Station
G.M.O. # 34136
T-11189
324 P.S. # 10
G.M.O. # 34136
PLATFORM

Store
Ho.
Shed
Ho.
Shed
ALLEY
26068
(Vacated)
142,027
T-8282 F/w T-3008
Platform G.M.O. # 97590
TO LOS ANGELES

21+61' RS = 0+00
E. B. PRAY
Dd. Aud. # 22150
Ho.
1+10' BC 17' C
23+83' 14' B.C. 10'
1+67' C.I. Pt.
E. B. PRAY
Dd. Aud. # 20525

+20' P.S.
+297 P.S. # 10
Dwarf Sig. # 62

Flashg. L. Xing Sig.

Ho.
Garage
Barn
Shed
Ho.
Ho.

Ho.

Ho.

School

140 S.P. Co.

Flashg. L. Xing Sig.

Flashg. L. Xing Sig.

Flashg. L. Xing Sig.

Flashg. L. Xing Sig.

Flashg. L. Xing Sig.

Flashg. L. Xing Sig.

Flashg. L. Xing Sig.

Flashg. L. Xing Sig.

Flashg. L. Xing Sig.

Flashg. L. Xing Sig.

Flashg. L. Xing Sig.

Flashg. L. Xing Sig.

Flashg. L. Xing Sig.

Flashg. L. Xing Sig.

Flashg. L. Xing Sig.

Flashg. L. Xing Sig.

Flashg. L. Xing Sig.

EMPIRE

Garage

P.M.T. Co.
Warehouse

Conc.
plat.

G.M.O. 85131

Cars
les & Icers
ard
ard
ing Track

Box Car Cleaning Tracks

g & Cleaning Track
Track

b

21 22 23 24 25 26 27 28 29 30 31

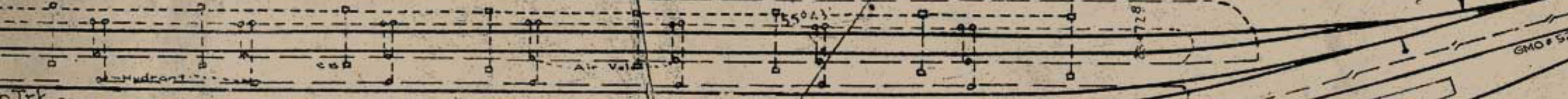

oTrk...

G.M.O. 52245

1" Overhead Steam & Air Lines

1" & 1 1/2" Undgr. Steam Pipes

Sump

100' Sludge Sump

Waste Storage
Lumber Storage
Repair Shop
Concrete Pavement

Wheel Tracks

Concrete
Sw. Pts. & Frogs

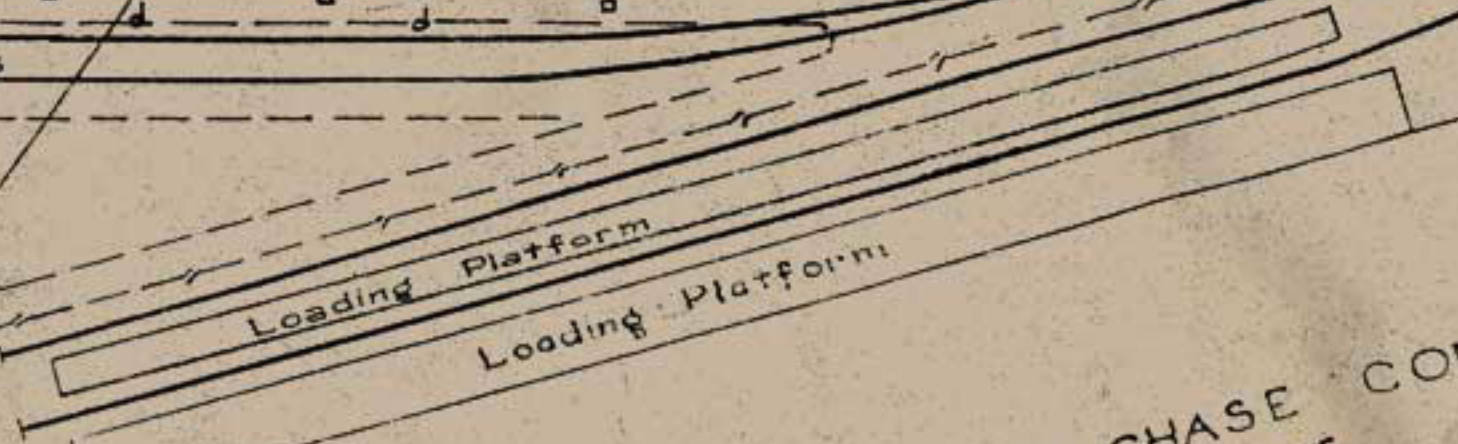

Loading Platform

Loading Platform

RICHMOND CHASE COMPANY
G.M.O. 72175

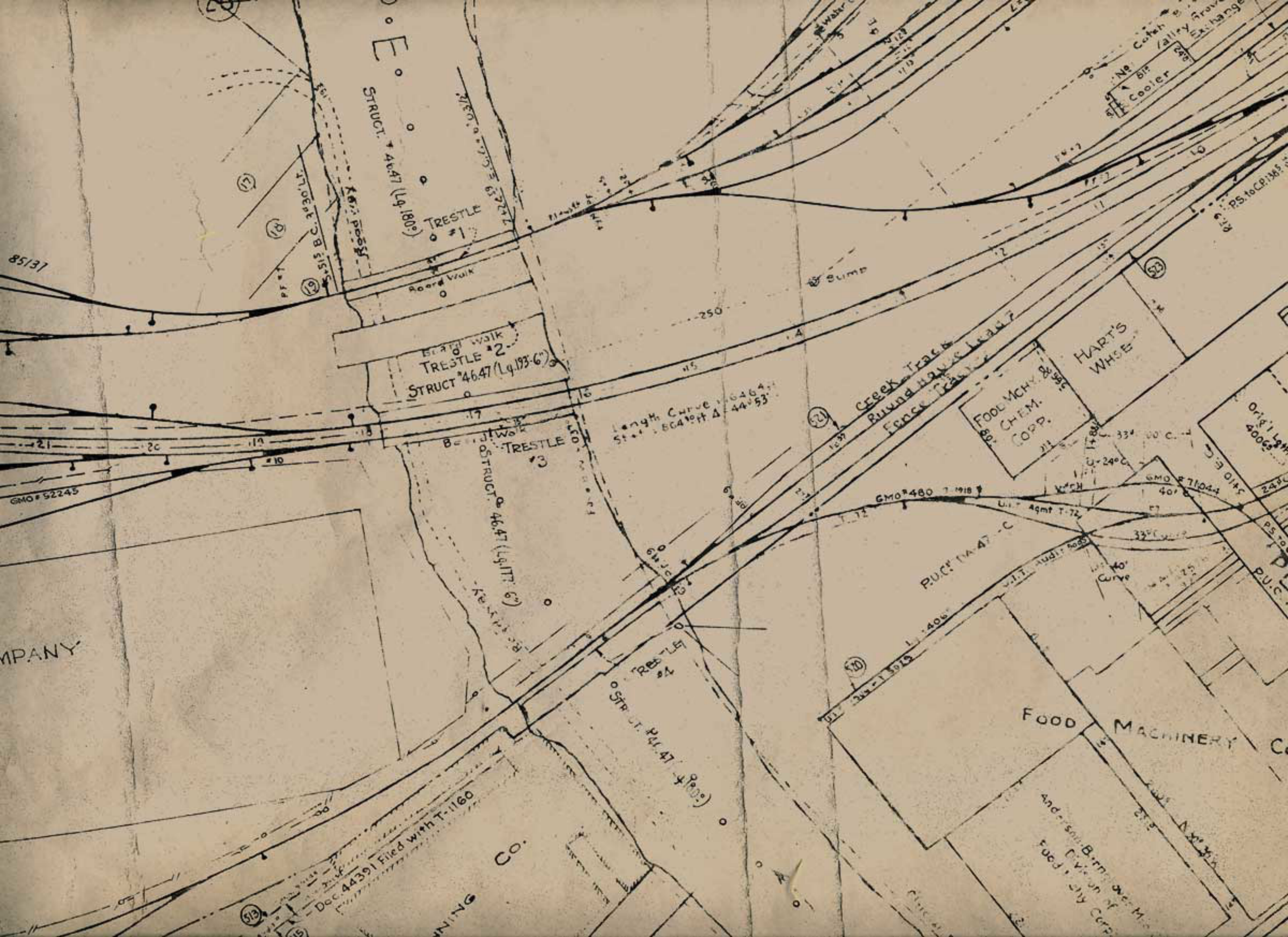

E

STRUCT. #4647 (Lq. 180')

TRESTLE #1

Board Walk
TRESTLE #2
STRUCT. #4647 (Lq. 193'-6")

TRESTLE #3

STRUCT. #4647 (Lq. 177'-6")

Length Curve 6464.1
Stat. 8041+00 to 44+53

TRESTLE #4

STRUCT. #4647 (Lq. 180')

Creek Track
Round House
Fence Track

HART'S WHSE

FOOD MCHY. & CHEM. COOP.

FOOD MACHINERY CO.

Doc. 4439 Filed with T-1160

Co.

Div. of Food & Sls. Bern. over M.
Div. of Food & Sls. Corp.

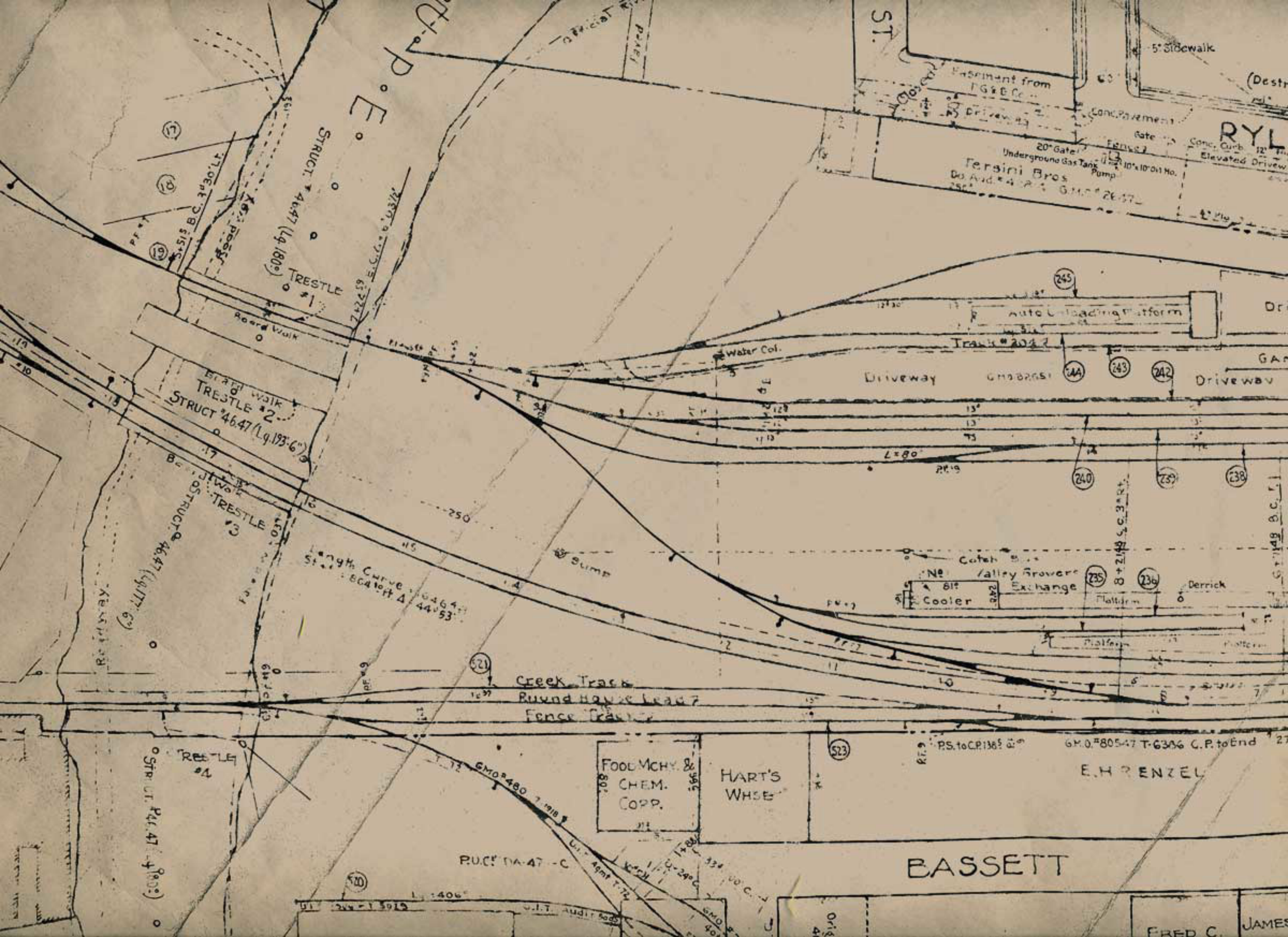

P. E.

ST.

RYL

STRUCT #4647 (Lg. 180')
TRESTLE #1
Road Walk

STRUCT #4647 (Lg. 193'-6")
TRESTLE #2
Board Walk

STRUCT #4647 (Lg. 177'-6")
TRESTLE #3
Board Walk

STRUCT #4647 (Lg. 180')
TRESTLE #4

Fersini Bros
Do. Avd. #4225 G.M.O. #2647

Auto Unloading Platform

Truck #2042

Driveway

Driveway

Water Col.

Cooler
Exchange

Derrick

Creek Track
Round House Lead
Fence Track

FOOD MCH.
CHEM.
COPP.

HART'S
WHSE

BASSETT

E. H. RENZEL

FRED C.

JAMES

RYLAND

Conc. Pavement ST

Fergini Bros
Dd. Aud. # 4222 G.M.O. # 2847

VACANT
Dd. Aud. # 4222 G.M.O. # 27840

WARREN
Dried Fruit Platform
ACME POTATO
Shed No. 101 Platform

Auto Loading Platform
Driveway

GANTRY CRANE

BRUCE STERN
Shed # 103
LOBUE

RUSHTON
Shed # 109
G.M.O. # 2971

Cooler
Valley Growers Exchange
Derrick

FREIGHT
FREIGHT
FREIGHT

E.H. RENZEL
G.M.O. # 80547 T-6306 C.P. to End 2775

INDEPENDENT
PAPER STOCK
Co.

DOYLE HOME
FURNISHINGS

JAMES
TRANSFER

BASSETT

C. D. HERSEY
Casualty to Bettencourt Markets
T-12945 with T-907

FRED C.
JAMES

JAMES TRANS.
&
STORAGE Co.

JOHN BEAN
MFG. Co.

BETTENCOURT MARKETS
FOOD MCHY. & CHEM. CORP.
(NIAGARA CHEM. DIVN)

WIELAND'S

G.M.O. # 3546 June 1915 T-907
G.M.O. # 48885 T-127

G.M.O. # 3577 June 1908 T-241 & 392
G.M.O. # 3577 June 1908 T-241

G.M.O. # 22355 T-1264
G.M.O. # 22355 Jan. 1915 T-1264

TERRAINE

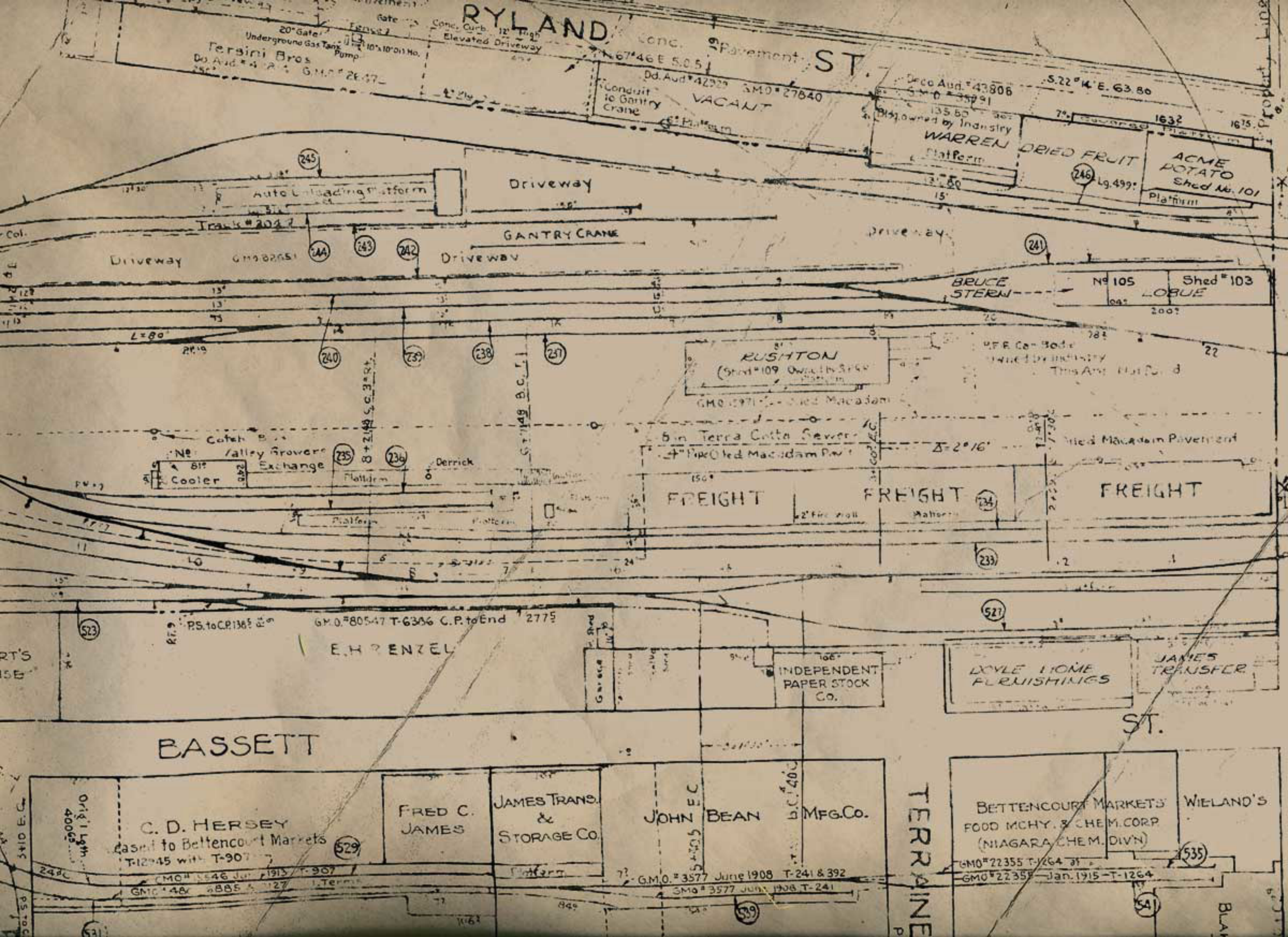

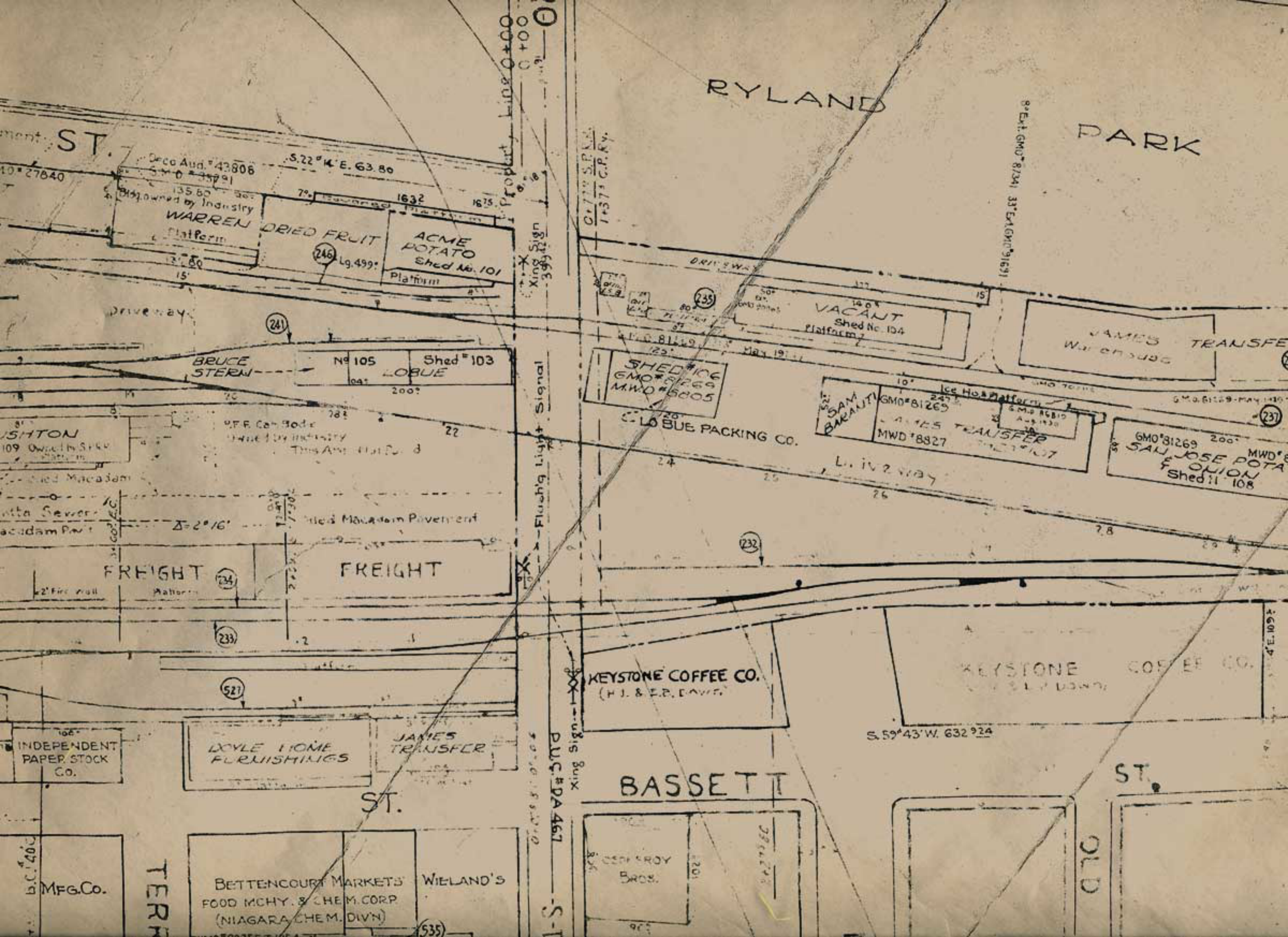

RYLAND

PARK

ST.

Deco Aud. # 43806
S. 22° 4' E. 63.80

WARREN DRIED FRUIT
Platform
ACME POTATO
Shed No. 101
Platform

C.P.R. Ry.
1+37

8° Ext. G.M.O. # 87341 33° Ext. G.M.O. # 91691

DRIVEWAY

VACANT
Shed No. 104
Platform

JAMES TRANSFER

BRUCE STERN
No. 105
Shed # 103
LOBUE

SHED # 106
G.M.O. # 81269
M.W.D. # 8805

SAN JOSE POTATO UNION
G.M.O. # 81269
M.W.D. # 8827

G.M.O. # 81269
SAN JOSE POTATO UNION
Shed # 108

C. LOBUE PACKING CO.

WILSON
109

PER. Car. Road
MAINT. BY INDUSTRY
THIS AREA HAS PAVED

FREIGHT

FREIGHT

KEYSTONE COFFEE CO.
(H. & E. DAVIS)

KEYSTONE COFFEE CO.
(H. & E. DAVIS)

INDEPENDENT
PAPER STOCK
Co.

LOYLE HOME
FURNISHINGS

JAMES
TRANSFER

BASSETT

ST.

MFG. Co.

BETTENCOURT MARKETS
FOOD MCHY. & CHEM. CORP.
(NIAGARA CHEM. DIVN)

WIELAND'S

ROY
BROS.

OLD

b.c. 400

TER

(535)

PUC # DA 467

S-1

K

NORTH

NORTH

NORTH

TRANSFER

31269 200' MWD # 8816
JOSE POTATO
ONION
Shed # 108

Flashing Light Xing Sig.



17616

BORCHERS BROS.

U.I. Terms 1907 T-4995 9-10-25
18° Ext. G.M.O. # 69904
T-5505 9-20-26

MAYFLOWER WAREHOUSE

Platform
G.M.O. # 5076 T-489
C.P. to End 370

Flashing Light Xing Sig.

Signal # 467

Engine & Trolley

CHASE CO.
Trackage No. 14

6" W.I. Water Line
3" x 6" Watchman's Sign
C.P. to End 271
C.P. to End 272
C.P. to P.S. 1418
C.P. to P.S. 1418

Well & Pump

EF. CO.

G.M.O. # 99840
T-2677 3-8-37

SECURITY WAREHOUSE
& COLD STORAGE CO.

G.M.O. # 32811 T-10915
S.P. Co. 162' Ind. 254'
Total Lg. 416'
BORCHER BROS.

RICHMOND

P.U.C. # DA-464

P.U.C. # DA-465

SECOND

Westward Track
12+00 B.C. 9' 20"

12+5143 C.C. 9' 09" C.

P.U.C. # DA-464

F1

47

91916

BORCHERS BROS.

U.I. Terms 1907 T-4995 9-10-25
18° Ext. G.M.O. # 69904
T-5505 9-20-26

240

6" W.I. Water Line
3x6 Watchman's Sentry
C.P. to End 2715
C.P. to End 2725

246

G.M.O. # 99840
T-2677 3-8-37

248

SECURITY WAREHOUSE
& COLD STORAGE CO.

Wideway

NORTH

SECOND

12+00± B.C. 9° 20'

Westward Track
12+51± C.C. 9° 09' C.
P.S. 12+55±
G.M.O. # 32811 T-10915
S.P. Co. 162' Ind. 254'
Total Lq. 4162'
BORCHER BROS.

250

P.U.C. # DA-465

MAYFLOWER WAREHOUSE

Platform
C.P. to End 3792

Warehouse

Well & Pump

NORTH

Flashy Light Xing Sig.

P.U.C. # DA-464

THIR

13+67± B.C. 12° 15' C.

15+37± C.C. 6° 30' C.
P.S. 20±46

16+35±

17+56± P.S.

Signal # 467

Engine & Coal Siding

CHASE CO.

CHASE CO. No 14

RICHMOND

P.U.C. # DA-463

NORTH - FOURTH

2° Ext. P. T. 728-45
G.M.O. 65152 Audit T-4908

End of Track 19+80

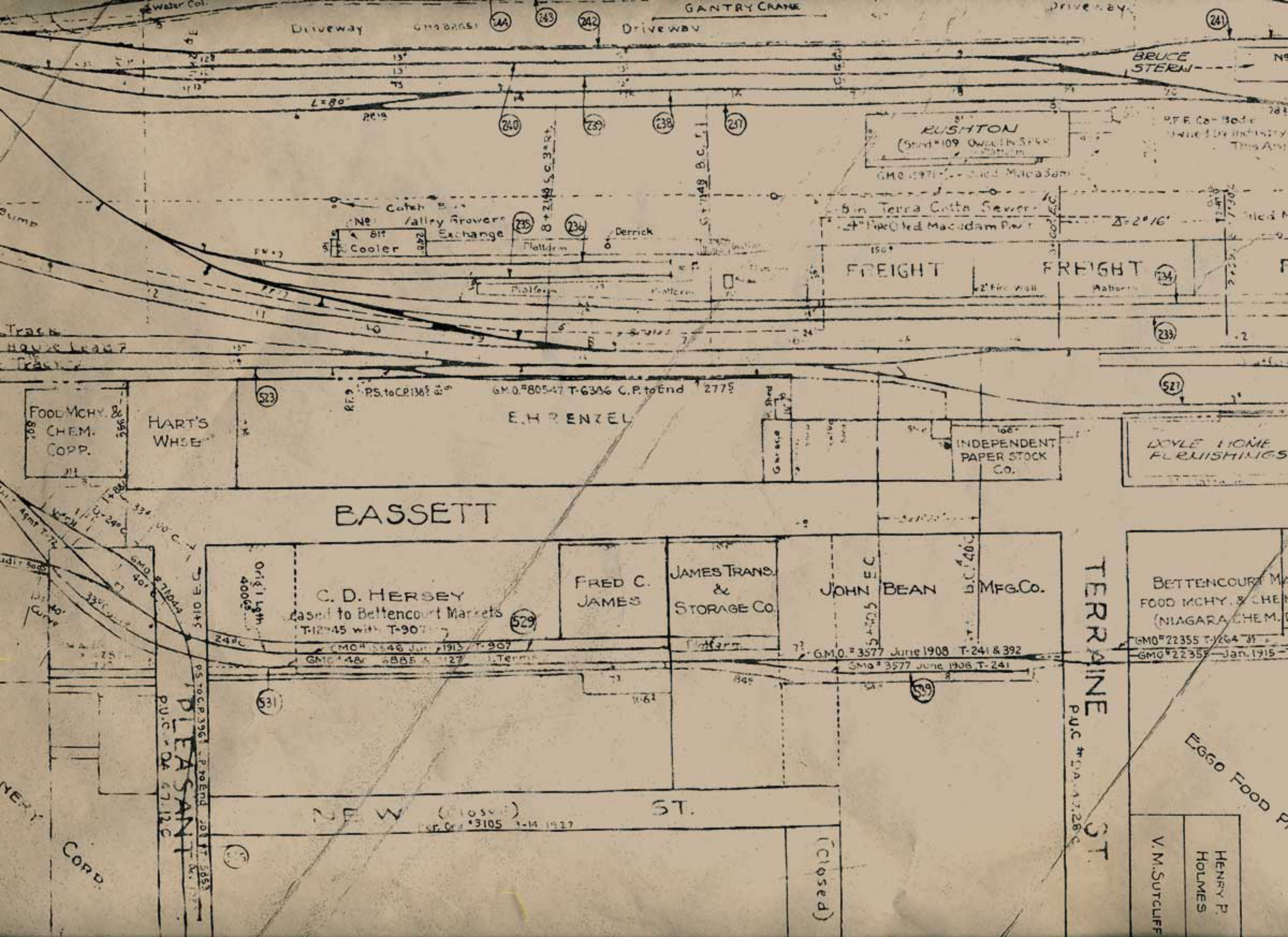

Driveway G.M.O. 244 243 242 Driveway

BRUCE STERN

RUSHTON
(Shed #109 Owned by S.P.K.)
Platform
G.M.O. #971 - 2nd Macadam

Catch Basin
No. 81
Cooler
Valley Growers Exchange

Bin Terra Cotta Sewer
4" Pipe Red Macadam Pavt

FREIGHT

FREIGHT

FOOD MCHY. & CHEM. COPP.

HART'S WHSE

E.H. RENZEL

INDEPENDENT PAPER STOCK Co.

LOYLE HOME FURNISHINGS

BASSETT

C. D. HERSEY
Casht to Bettencourt Markets
T-12745 with T-907

FRED C. JAMES

JAMES TRANS. & STORAGE CO.

JOHN BEAN

MFG. CO.

BETTENCOURT M. FOOD MCHY. & CHEM. (NIAGARA CHEM.)

DIEASANT
P.U.C. - DA 67.12C

NEW ST.

TERRAZINE ST.

V.M. SUTCLIFF
HENRY P. HOLMES

(Closed)

(1050)
P.C. #3105 1-14-1917

G.M.O. #3577 June 1908 T-241 & 392
G.M.O. #3577 June 1908 T-241

G.M.O. #546 July 1913 T-907
G.M.O. #481 8885 & 127 T-907

G.M.O. #22355 T-264 35
G.M.O. #22355 Jan. 1915

EGGO FOOD P.

NERX
CORP.

Water Col.
122
112
111
110
109
108
107
106
105
104
103
102
101
100
99
98
97
96
95
94
93
92
91
90
89
88
87
86
85
84
83
82
81
80
79
78
77
76
75
74
73
72
71
70
69
68
67
66
65
64
63
62
61
60
59
58
57
56
55
54
53
52
51
50
49
48
47
46
45
44
43
42
41
40
39
38
37
36
35
34
33
32
31
30
29
28
27
26
25
24
23
22
21
20
19
18
17
16
15
14
13
12
11
10
9
8
7
6
5
4
3
2
1