

For Your Enjoyment

Burlington presents
THE Vista Dome

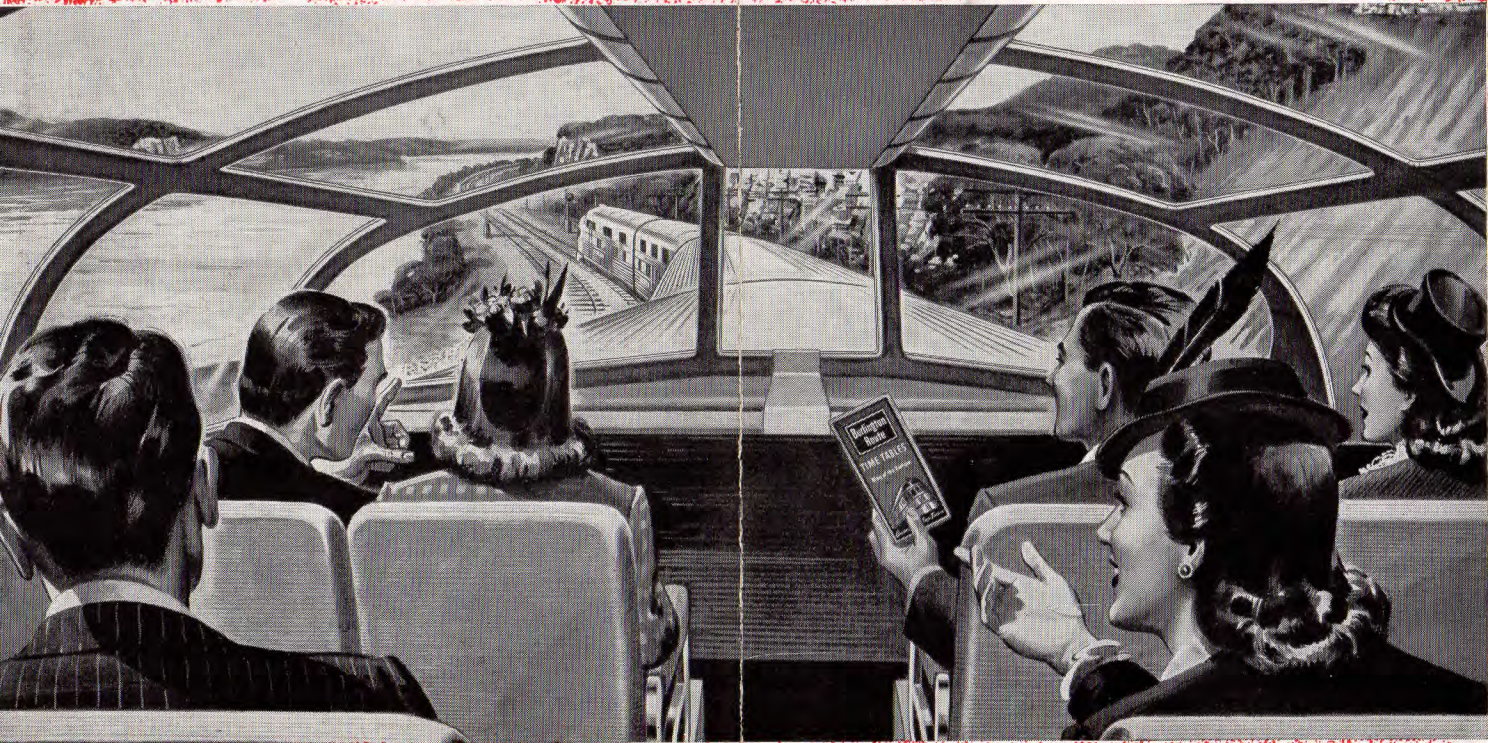

**A THRILLING INNOVATION
IN TRAVEL ENJOYMENT!**

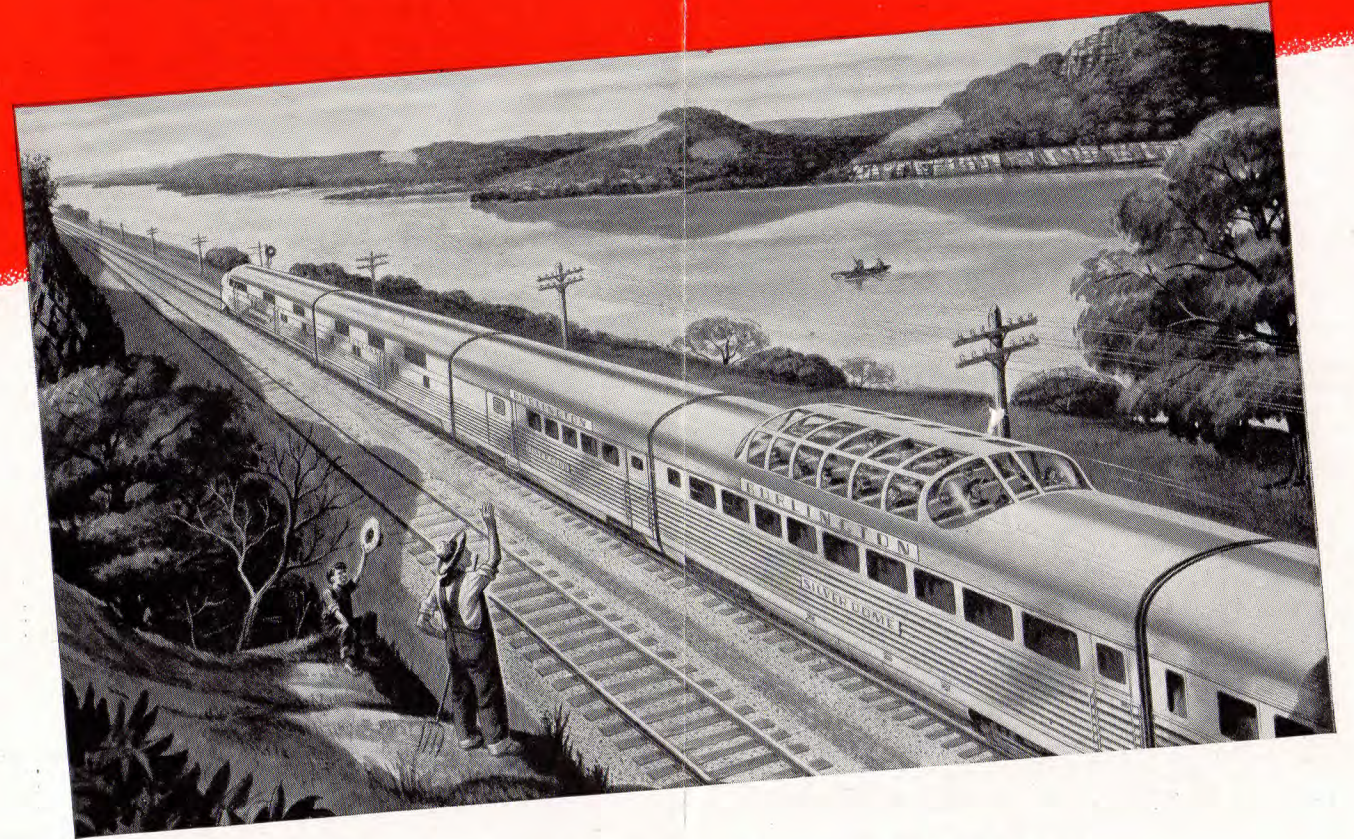

The Burlington introduced America's first Vista Dome car in July, 1945. The name, obviously, was derived from the spacious dome which is built into the roof. Here, enclosed in non-glare, heat-resisting safety glass, are twenty-four deep-cushioned seats where passengers, with heads and shoulders well above the train's roof line, may ride in air-conditioned comfort, enjoying an unobstructed panorama of American countryside.

This first Vista Dome car, created by the Burlington, embodies the most outstanding feature of General Motors' sensational "Astra-Liner" designs. When it was presented to the public, the Burlington made this promise—"if you like it, there will be more of them." It didn't take long to find out that the public *did* like the idea of riding in "a penthouse on wheels."

AN ENTIRELY NEW IDEA IN TRAIN TRAVEL...

*Offers You a
Penthouse View*



and so ⇨ ⇨

THE UNIQUE "Vista Dome" CAR

They're On the Way...

**THE WORLD'S MOST
THRILLING TRAINS**



America is to enjoy another "first" in modern transportation—a fleet of new diesel-powered, stainless steel Zephyrs, each of which will feature five *Vista-Dome* cars!

Two of these new trains will replace the Twin Zephyrs now running between Chicago and St. Paul-Minneapolis; the others, to be known as the California Zephyrs, will be operated between Chicago, Denver, Salt Lake City and San Francisco, replacing the Exposition Flyer. In design, construction and appointments, they will

symbolize "the last word" in modernity. In terms of spaciousness, conveniences and luxurious comfort, they will surpass even the fine, modern trains they will replace.

So, look forward to an utterly new travel thrill—to the day when you can enjoy a penthouse view as you glide alongside the beautiful upper Mississippi River between Chicago and the Twin Cities, or travel the scenic way across America through the heart of the Colorado Rockies and the magnificent Feather River Canyon, enroute to or from San Francisco.

**HERE'S A PREVIEW OF "Vista Dome" CARS
TO BE FEATURED IN COMING Zephyrs**

Forty of these unique Vista Dome cars are now under construction. Plans provide for multiple-level coaches and parlor-observation cars, each affording full head room on all levels, thus giving new roominess and added comfort . . . plus thrilling penthouse perspective.

On each of the new Twin Zephyrs, which will be placed in service later this year, there will be five cars with Vista Domes . . . 4 coaches and a parlor-observation car. Each Vista Dome will accommodate 24 passengers and access to the dome will be by means of a short, well-lighted stairway. Dome seats will be cushioned with soft, foam type rubber and will have adjustable foot rests for added comfort.

The "main floor" of three or the new Twin Zephyr coaches will have reclining seats for 54 passengers, while the fourth will accommodate 50. The parlor-observation cars will feature restful, deep-cushioned lounge chairs for 29 passengers. In addition, there will be a drawing-room, for daytime occupancy, with comfortable chairs and a sofa-type seat which can be made into a berth. All coaches and parlor-observation cars will provide modern, spacious washroom facilities.

Thirty of these Vista Dome cars, now under construction, are for use in the coming California Zephyrs, which are to provide streamlined train service via the scenic route between the Great Lakes and the Golden Gate.

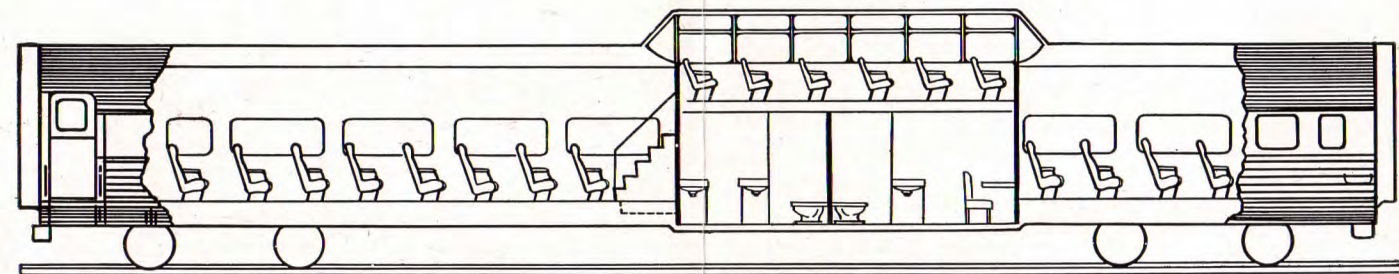

Above is a sketch of one of the Vista Dome chair cars now under construction, featuring the "penthouse view." Note how the central portion will be lowered to give ample ceiling height under the dome section. There will be seats for fifty-four passengers on the "main floor" and twenty-four in the Vista Dome. The washrooms will be located off a side aisle directly beneath the dome.

THERE ARE GREAT DAYS AHEAD FOR TRAVELING AMERICA ★ ★ ★