

UNION PACIFIC RAILROAD CONDENSED PROFILE CONTENTS

16 - FT. WORTH DIVISION SERVICE UNIT

SEPTEMBER 12, 1988

PAGES

DALLAS SUBDIVISION-----	MESQUITE TO CENTENNIAL YARD (FT. WORTH)---	1 TO 5
BAIRD SUBDIVISION-----	CENTENNIAL YARD (FT. WORTH) TO BIG SPRING	5 TO 20
TOYAH SUBDIVISION-----	BIG SPRING TO EL PASO-----	20 TO 38
MKT DALLAS SUBDIVISION---	GREENVILLE TO DALLAS-----	39 TO 42
MKT HILLSBORO SUBDIV.---	DALLAS TO WAXAHACHE-----	42 TO 44
MKT DFW SUBDIVISION-----	TOWER 55 TO DALLAS-----	45 TO 46
WHITESBORO SUBDIVISION---	HODGE TO TOWER 55-----	47 TO 48
EVERMAN BRANCH-----	FT. WORTH TO EVERMAN-----	48
MKT WESTERN SUBDIVISION---	HICKS TO BN JCT.-----	49
MKT DUNCAN SUBDIVISION---	CHICO TO TOWER 55-----	50 TO 53
MKT FT. WORTH SUBDIVISION---	TOWER 55 TO WREN--	54
WMWGNW BRANCH-----	WEATHERFORD TO MINERAL WELLS (WMWGNW RY)	56 TO 57
BAIRD SUBDIVISION-----	GENERAL DYNAMICS SPUR-----	57
BAIRD SUBDIVISION-----	CARSWELL AIR FORCE BASE SPUR-----	57
ABS BRANCH-----	ABILENE TO WINTERS-----	58 TO 59
T-NM BRANCH-----	MONAHANS TO LOVINGTON-----	60 TO 65
SWEETWATER BRANCH-----	TECIFIC TO SWEETWATER VIA ATBSF Rwy-----	65
DALLAS SUBDIVISION-----	TRINITY INDUSTRIAL LEAD (AT DALLAS)-----	66
DALLAS SUBDIVISION-----	OLD MAIN LINE (AT DALLAS)-----	66
MKT DENTON SUBDIVISION---	DENTON TO DALLAS-----	67 TO 68

TERMINAL DIAGRAMS

DALLAS, TX-----	2
FT. WORTH, TX-----	4
CENTENNIAL YARD (FT. WORTH), TX-----	6
SWEETWATER, TX-----	17
EL PASO, TX-----	38

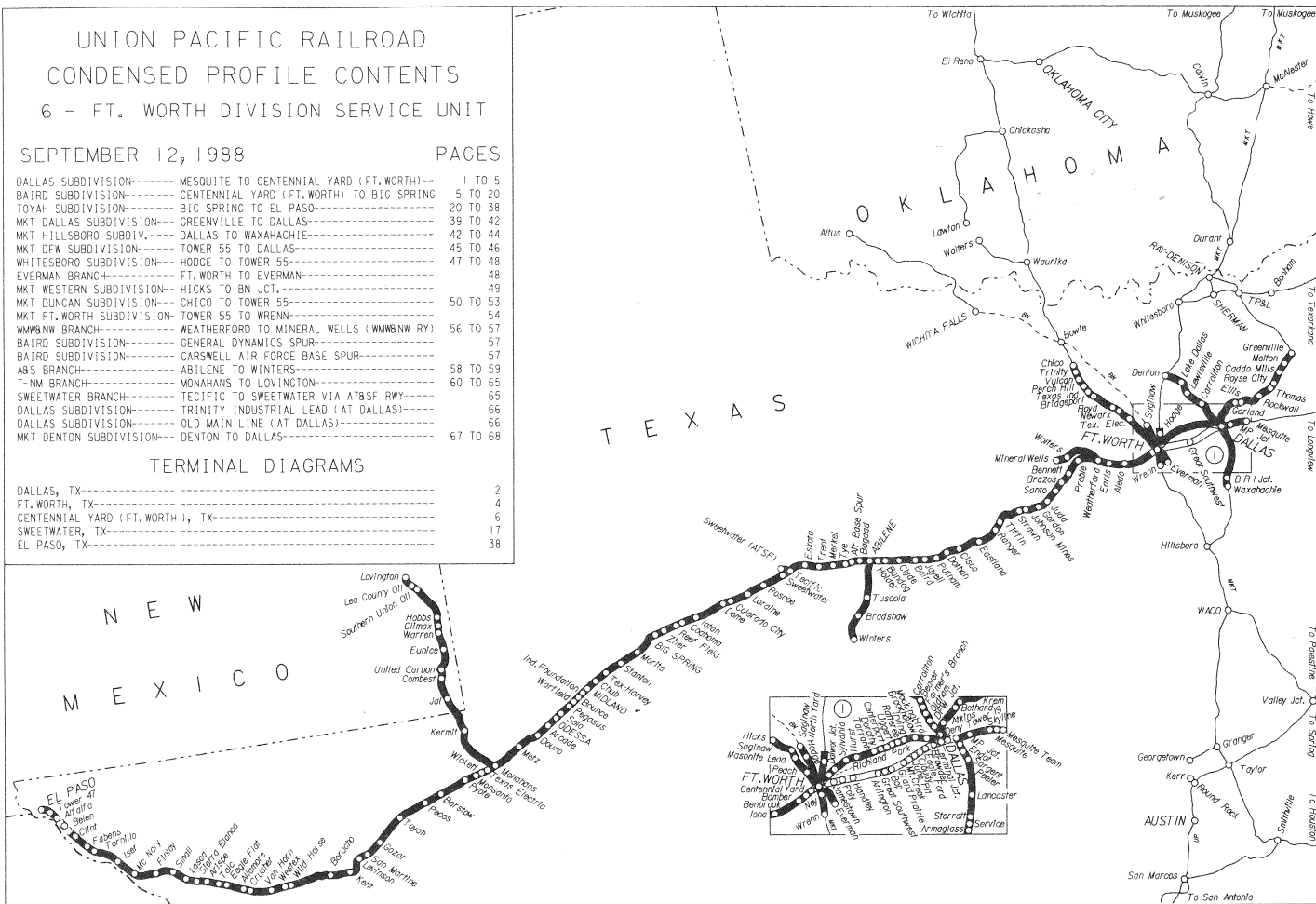

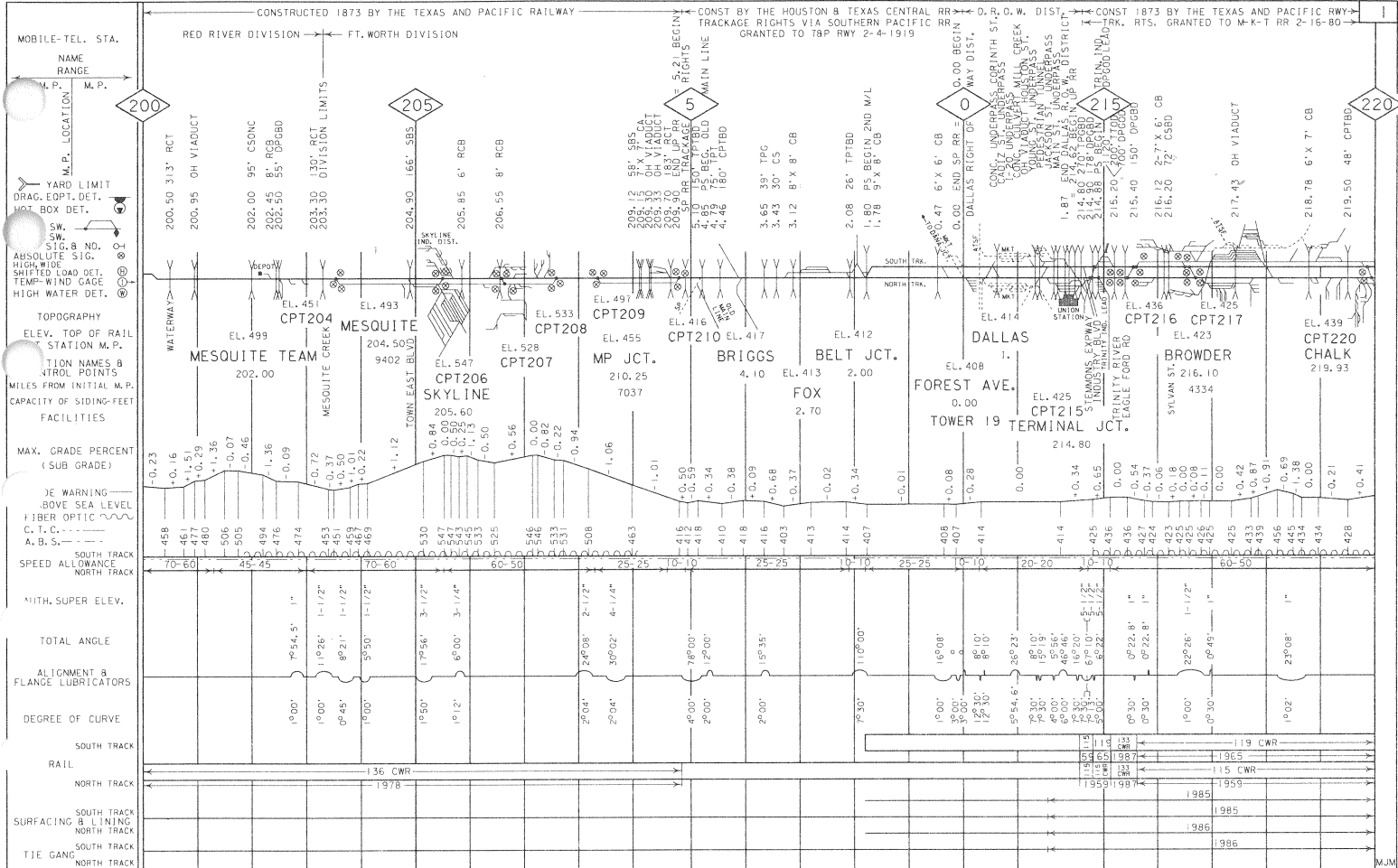

RAIL, SURFACING B L I N I N G AND TIE GANG CORRECTED FOR JANUARY 6, 1988

ALIGNMENT B PROFILE CORRECTED FOR SEPTEMBER 12, 1988

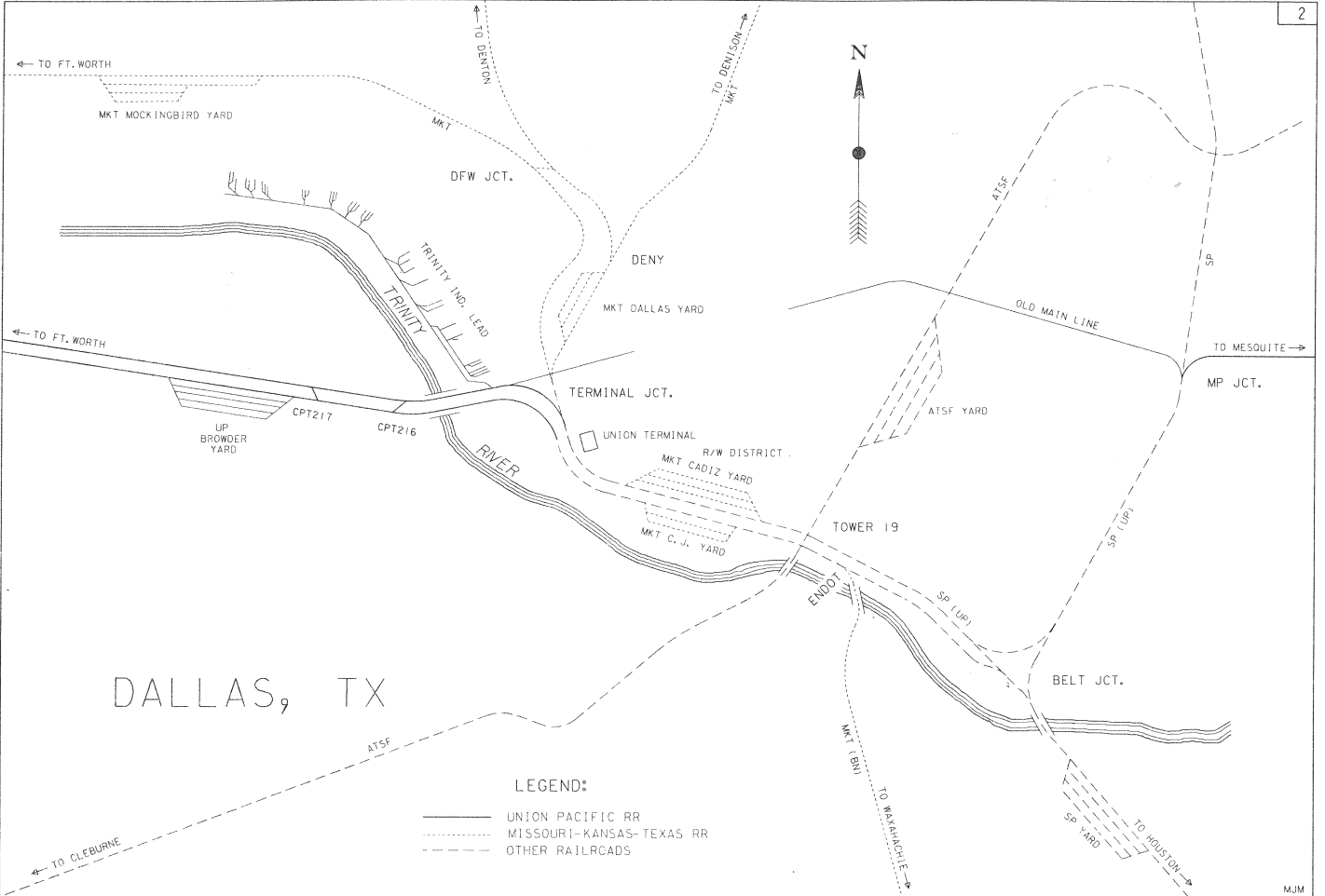

DALLAS, TX

LEGEND:

- UNION PACIFIC RR
- MISSOURI-KANSAS-TEXAS RR
- - - - OTHER RAILROADS

CONSTRUCTED 1873 BY THE TEXAS AND PACIFIC RAILWAY
TRACKAGE RIGHTS GRANTED TO MISSOURI-KANSAS-TEXAS RR 2-16-80

MOBILE-TEL. STA.

NAME RANGE

M. P. M. P.

M.P. LOCATION

YARD LIMIT

DRAG, EXPT. DET.

HOT BOX DET.

PWR. SW.

INT. SIG. B NO.

ABSOLUTE SIG.

HIGH WIDE

SHIFTED LOAD DET.

TEMP. WIND GAGE

HIGH WATER DET.

TOPOGRAPHY

ELEV. TOP OF RAIL

AT STATION M.P.

STATION NAMES &

CONTROL POINTS

MILES FROM INITIAL M.P.

CAPACITY OF SIDING- FEET

FACILITIES

MAX. GRADE PERCENT

(SUB GRADE)

SLIDE WARNING

EL. ABOVE SEA LEVEL

FIBER OPTIC

C. T. C.

A. B. S.

SOUTH TRACK

SPEED ALLOWANCE

NORTH TRACK

220

225

230

235

240

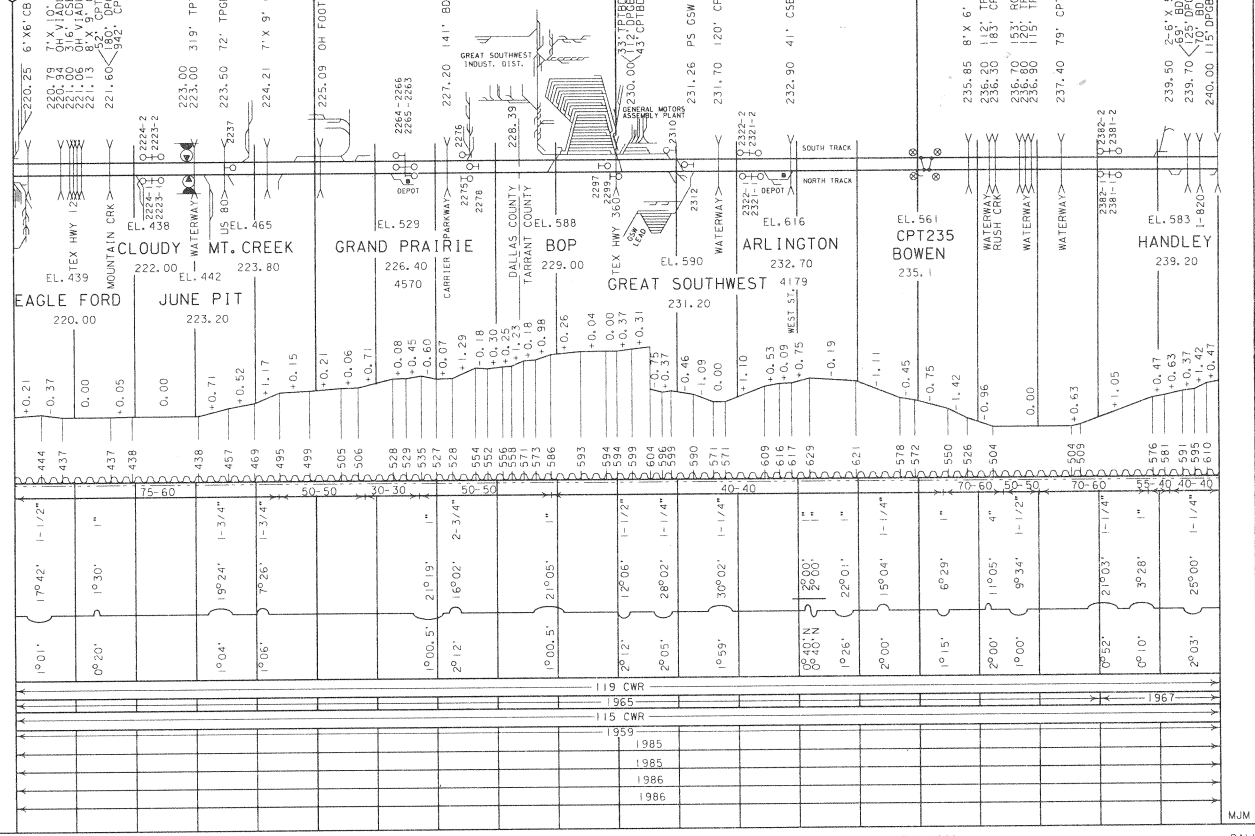

RAIL, SURFACING & LINING AND TIE GANG CORRECTED FOR FEBRUARY 12, 1987

ALIGNMENT & PROFILE CORRECTED FOR AUGUST 8, 1988

MJM

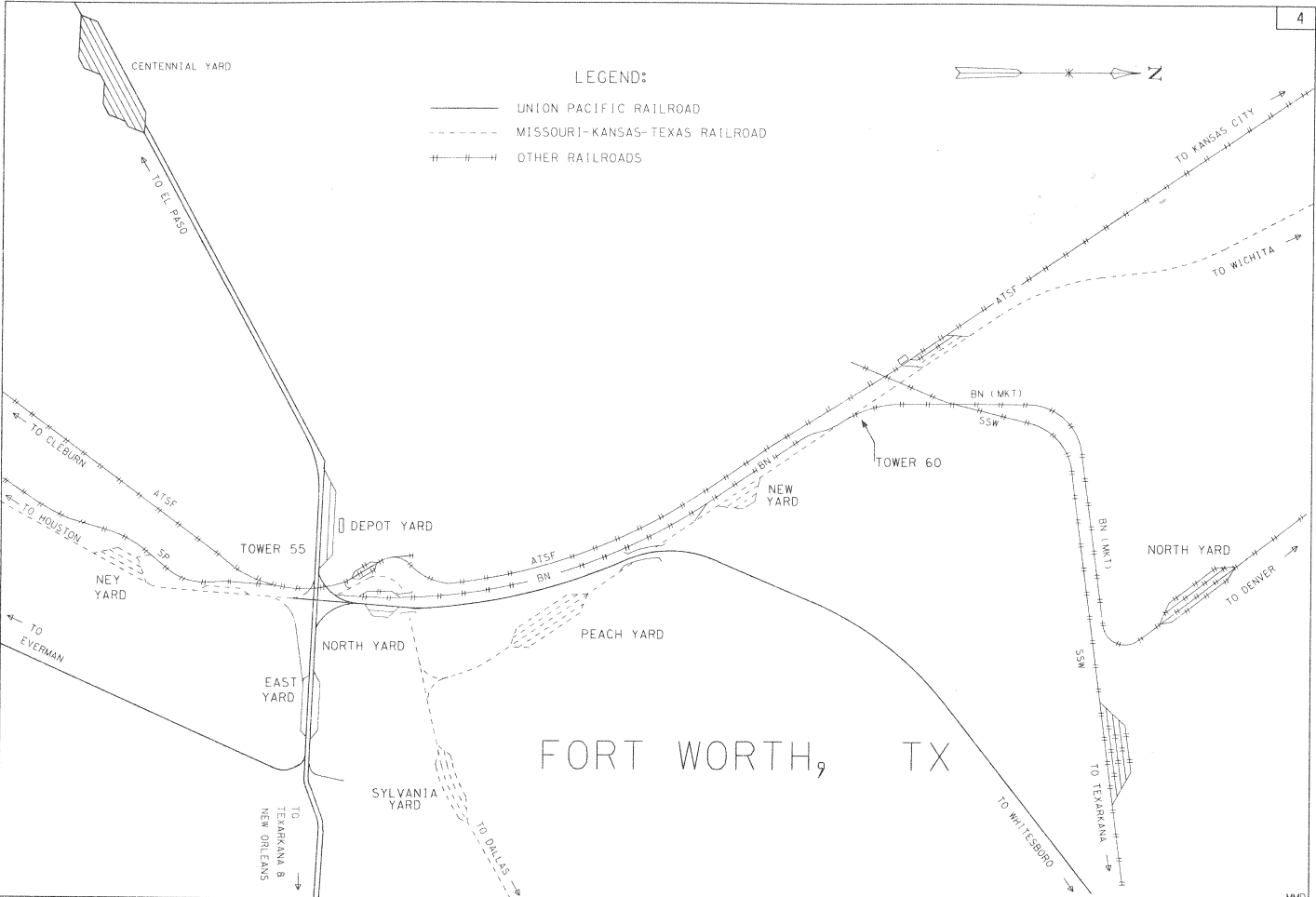

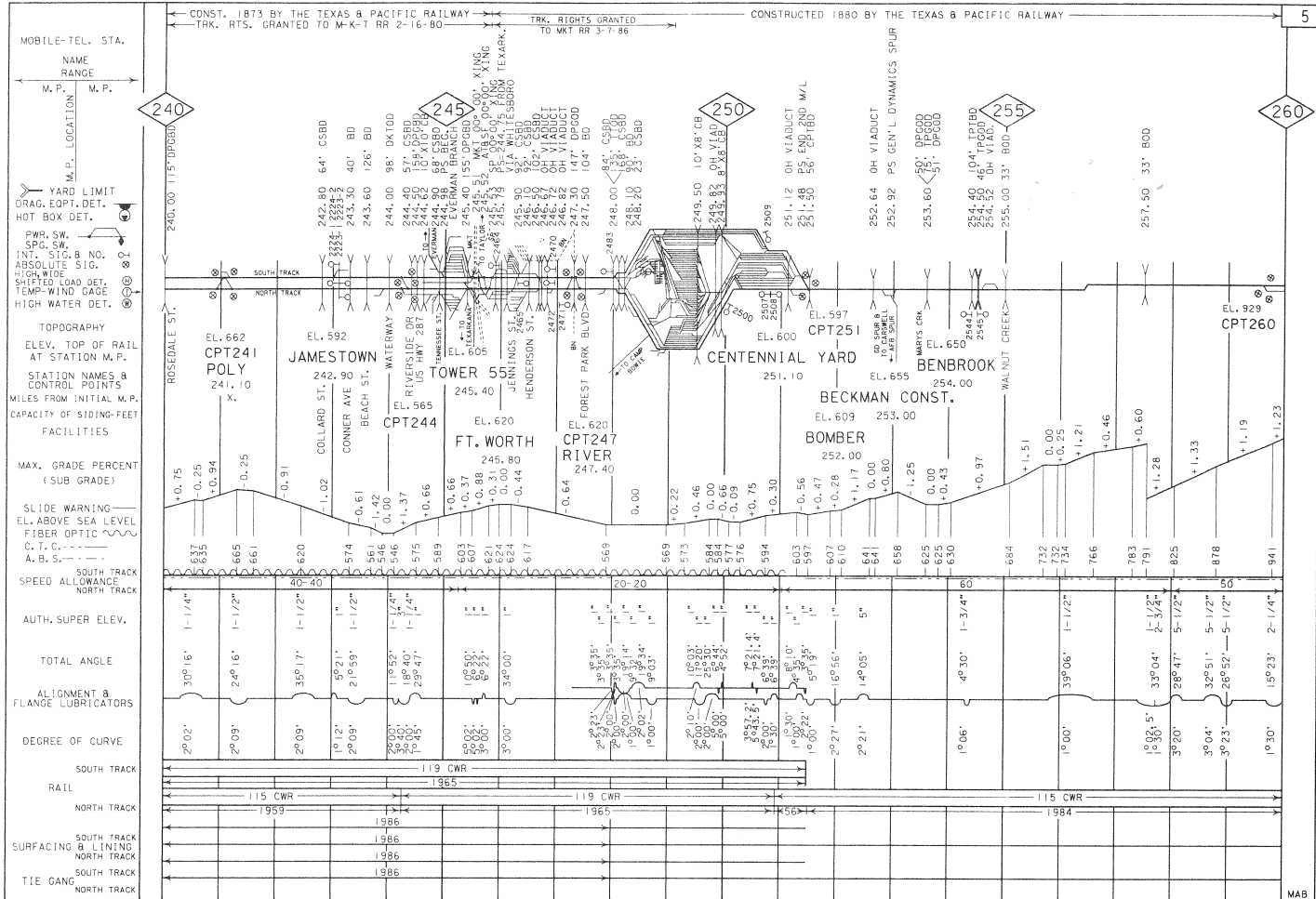

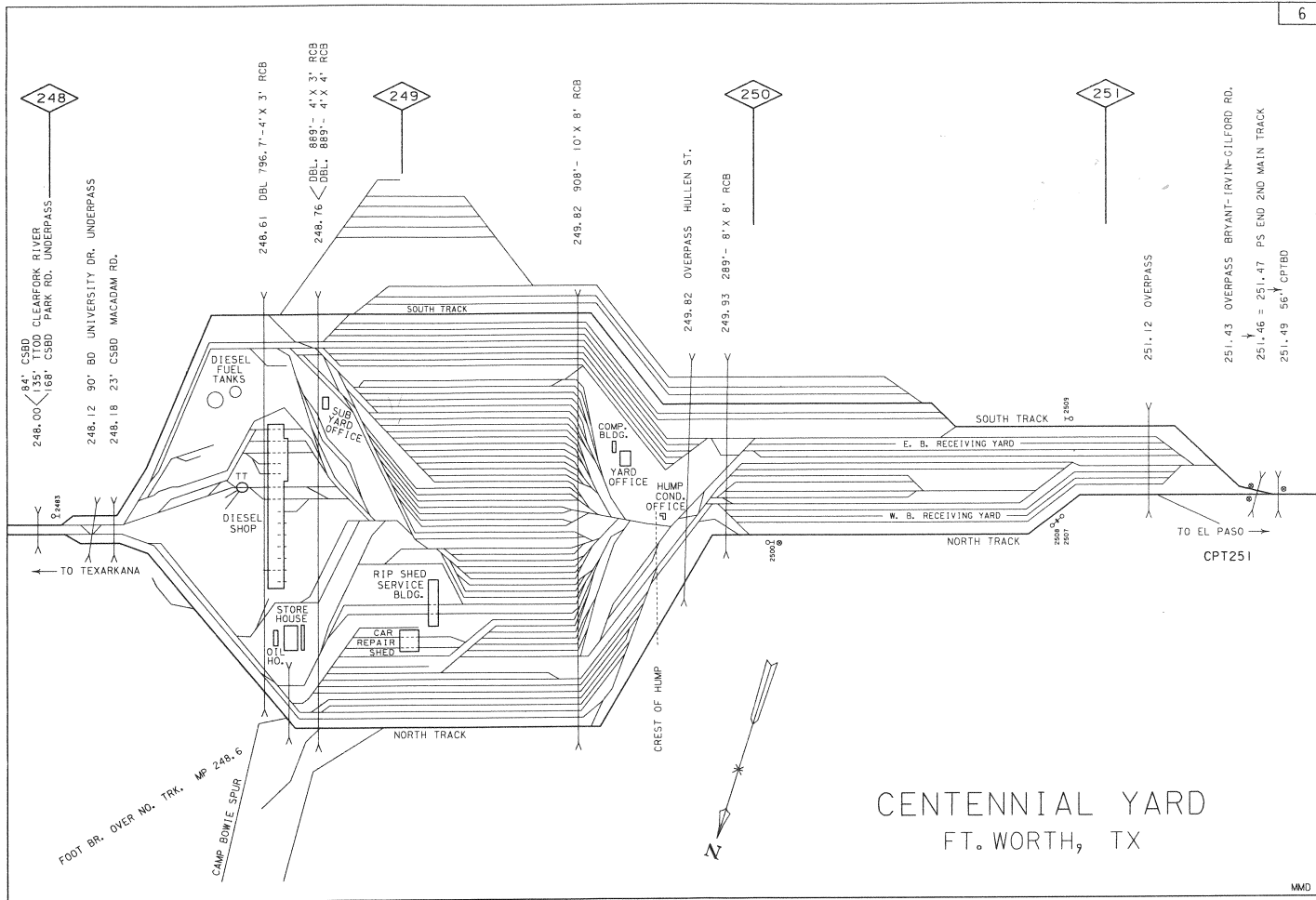

CENTENNIAL YARD
FT. WORTH, TX

CONSTRUCTED 1880 BY THE TEXAS & PACIFIC RAILWAY

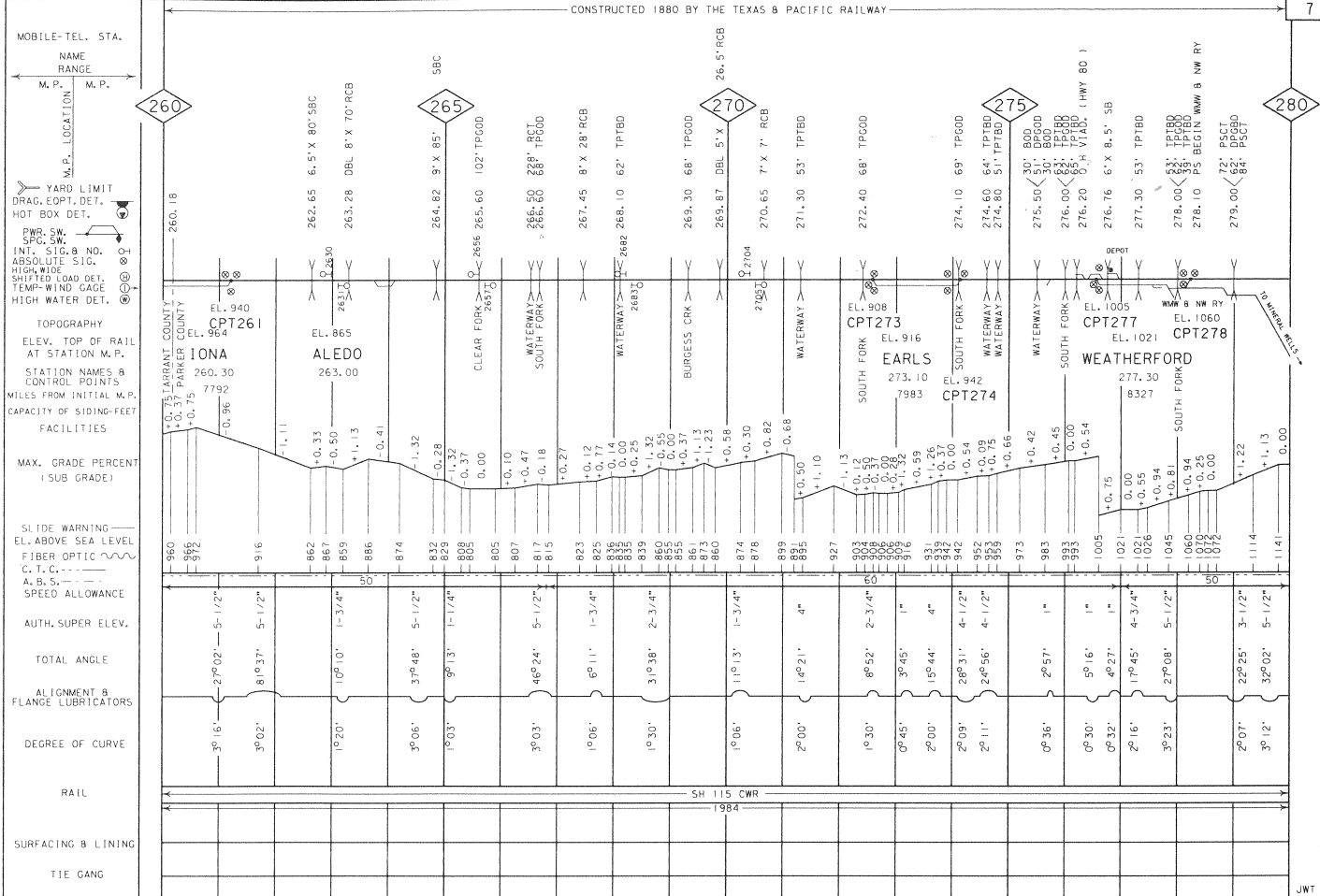

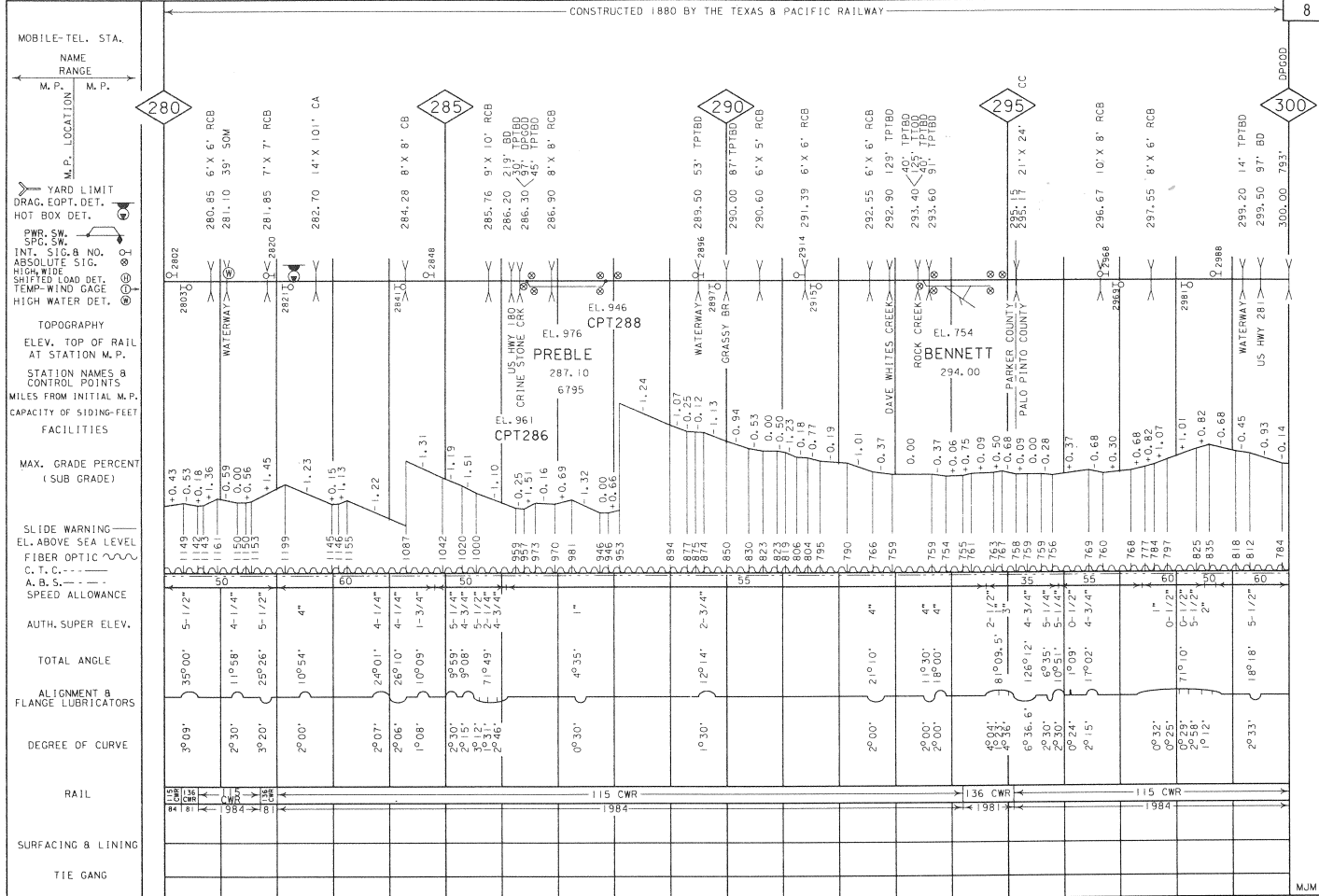

CONSTRUCTED 1880 BY THE TEXAS AND PACIFIC RAILWAY

9

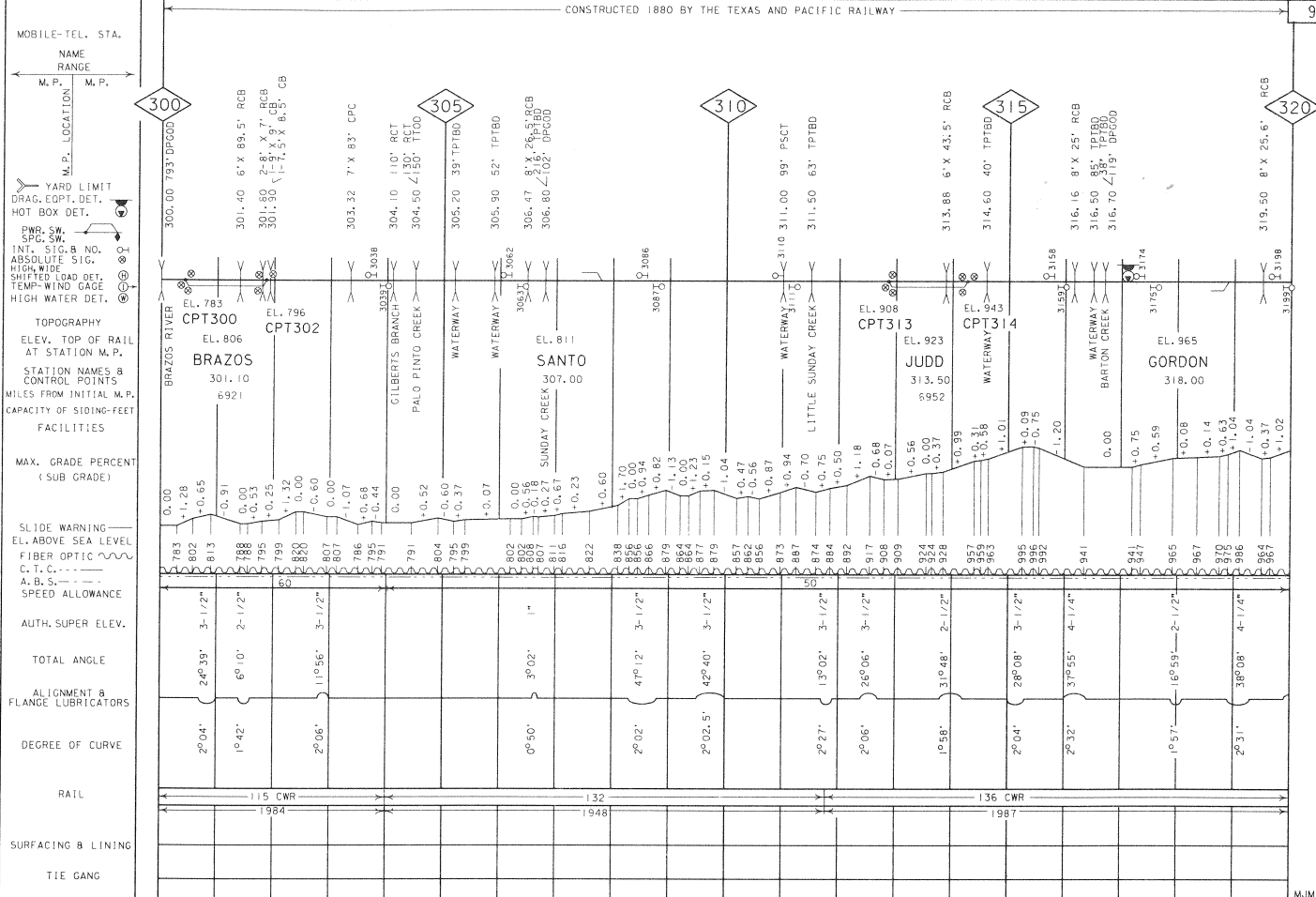

RAIL SURFACING & LINING AND TIE GANG CORRECTED FOR JANUARY 7, 1988

ALIGNMENT & PROFILE CORRECTED FOR SEPTEMBER 13, 1988

MJM

EAST

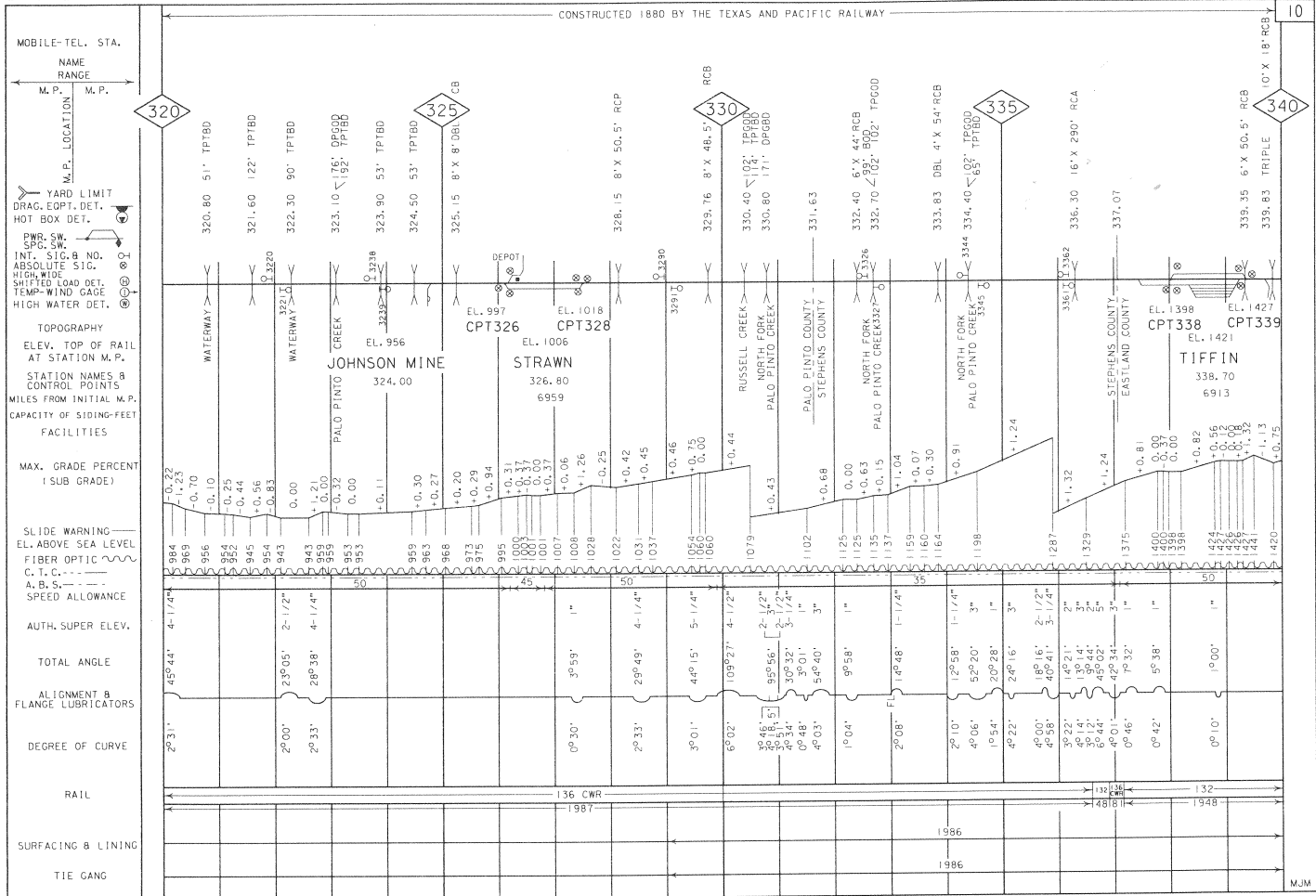

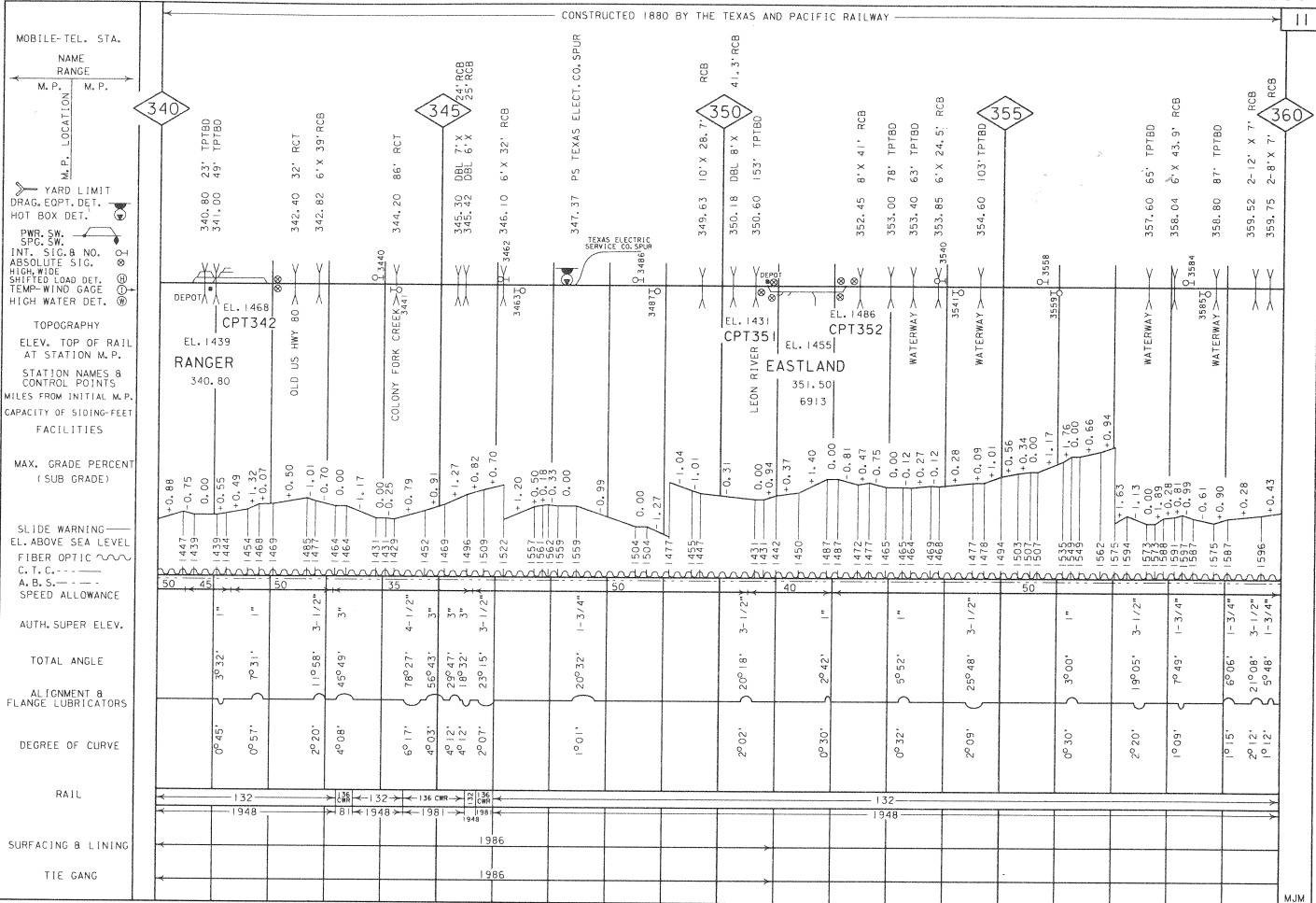

CONSTRUCTED 1880 BY THE TEXAS AND PACIFIC RAILWAY

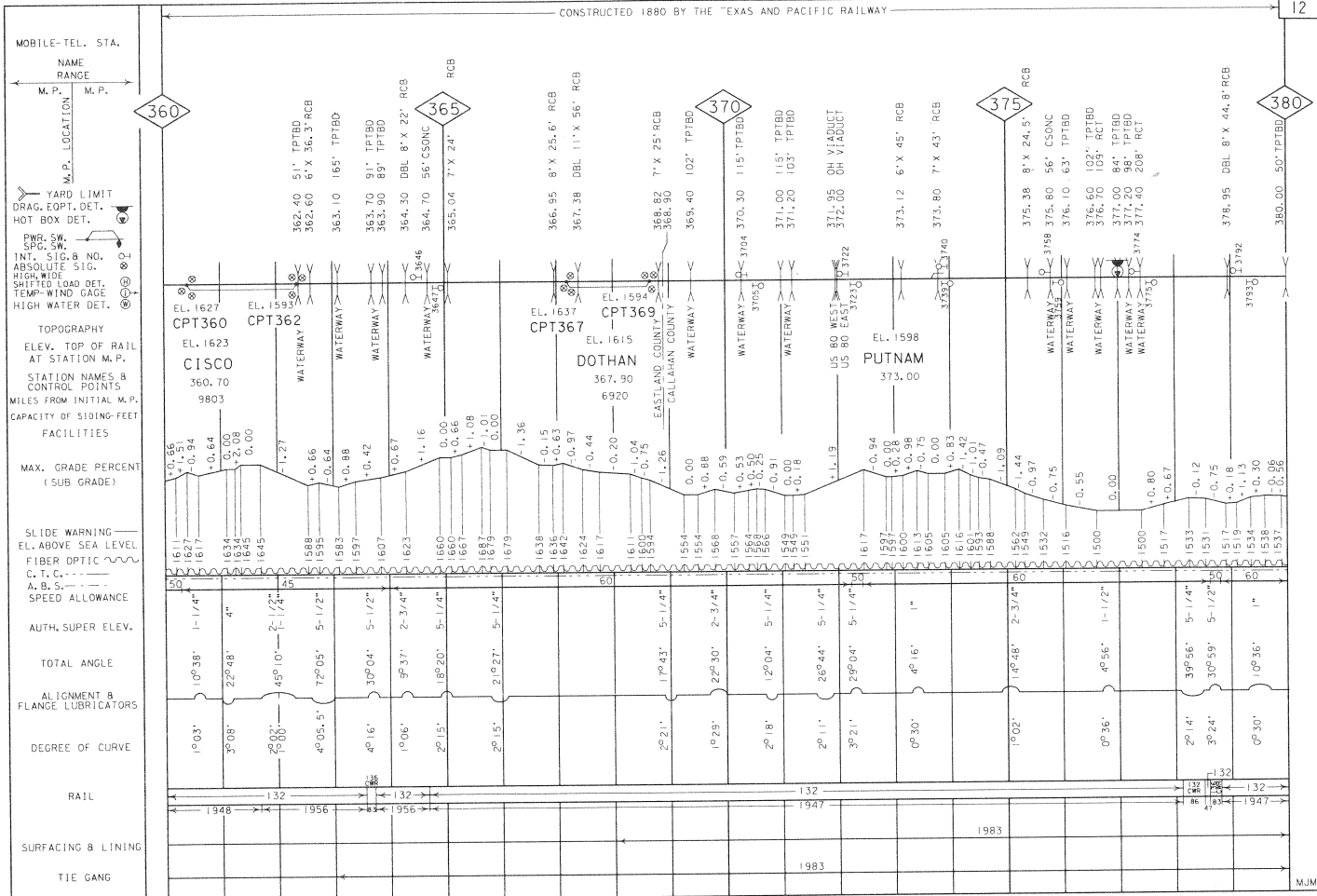

CONSTRUCTED 1880 BY THE TEXAS AND PACIFIC RAILWAY

MOBILE-TEL. STA.
 NAME RANGE
 M. P. M. P.
 M. P. LOCATION
 YARD LIMIT
 DRAG, EQPT. DET.
 HOT BOX DET.
 PWR. SW.
 SPC. SW.
 INT. SIG. & NO.
 ABSOLUTE SIG.
 HIGH WIDE
 SWITCHED LOAD DET.
 TEMP-WIND GAGE
 HIGH WATER DET.
 TOPOGRAPHY
 ELEV. TOP OF RAIL
 AT STATION M. P.
 STATION NAMES &
 CONTROL POINTS
 MILES FROM INITIAL M. P.
 CAPACITY OF SIDING-FEET
 FACILITIES
 MAX. GRADE PERCENT
 (SUB GRADE)
 SLIDE WARNING
 EL. ABOVE SEA LEVEL
 FIBER OPTIC
 C. T. C.
 A. B. S.
 SPEED ALLOWANCE
 AUTH. SUPER ELEV.
 TOTAL ANGLE
 ALIGNMENT &
 FLANGE LUBRICATORS
 DEGREE OF CURVE
 RAIL
 SURFACING & LINING
 TIE GANG

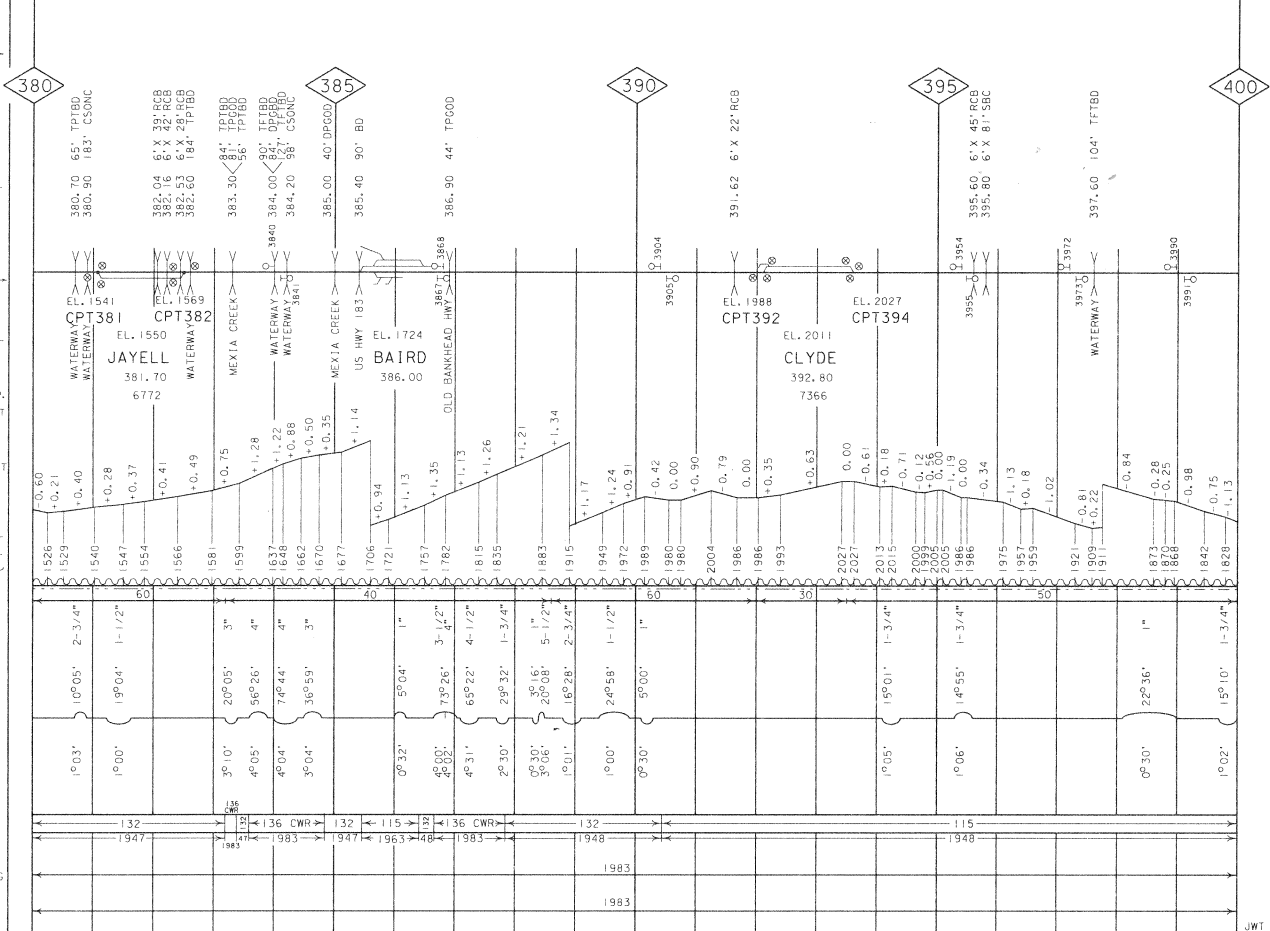

RAIL, SURFACING & LINING AND TIE GANG CORRECTED FOR FEBRUARY 12, 1987

ALIGNMENT & PROFILE CORRECTED FOR JUNE 22, 1988

CONSTRUCTED 1880 BY THE TEXAS AND PACIFIC RAILWAY

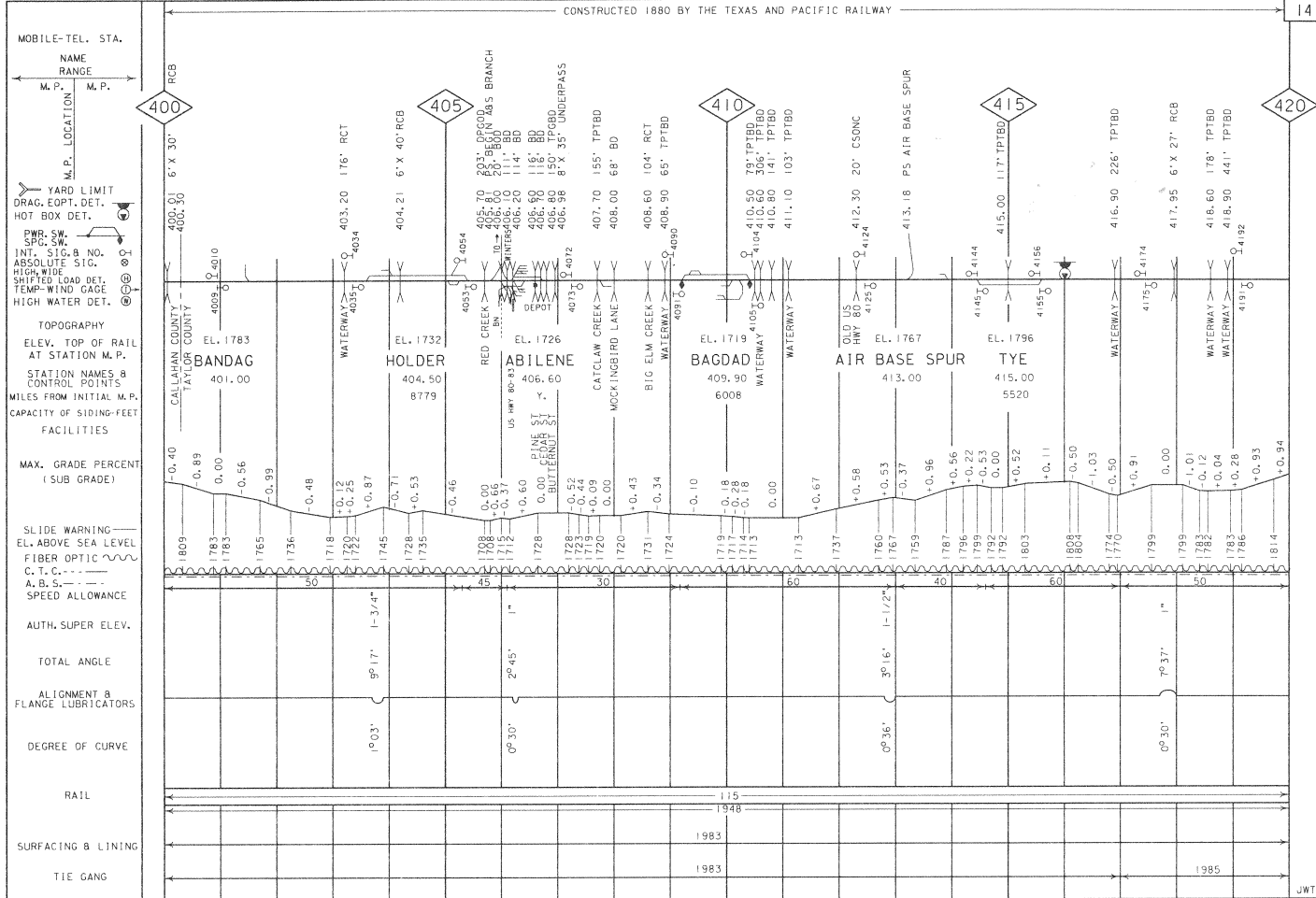

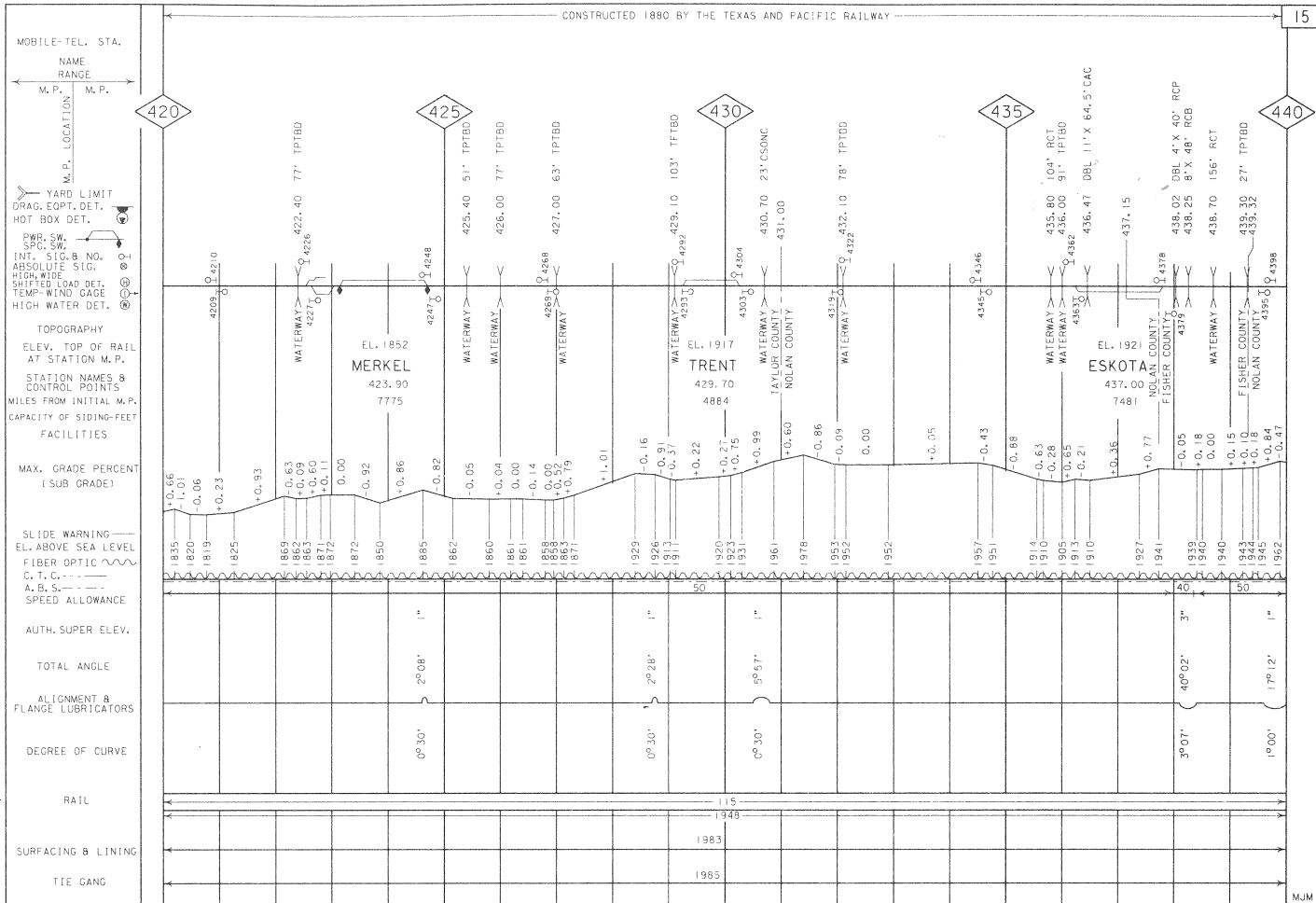

CONSTRUCTED 1880 BY THE TEXAS AND PACIFIC RAILWAY

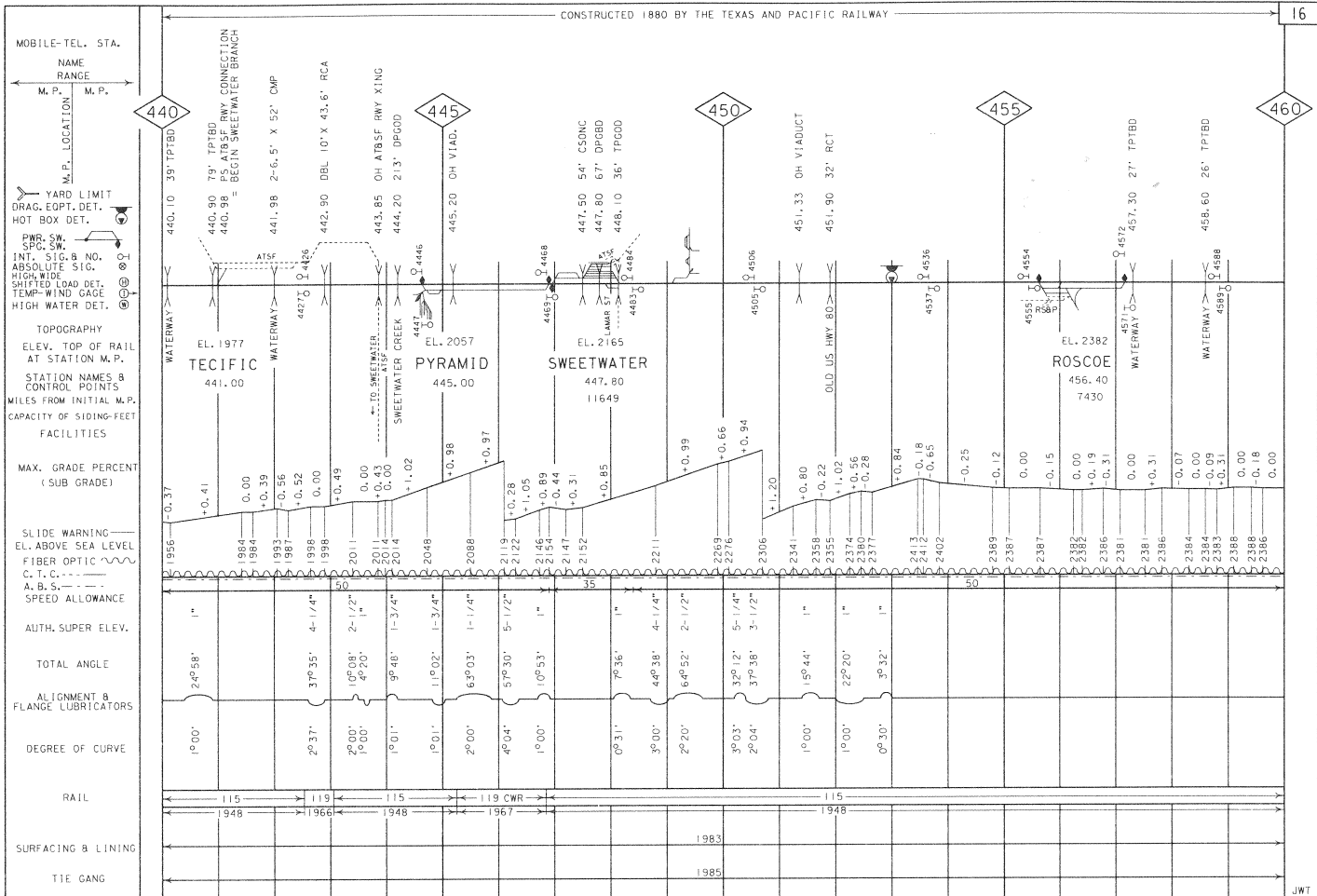

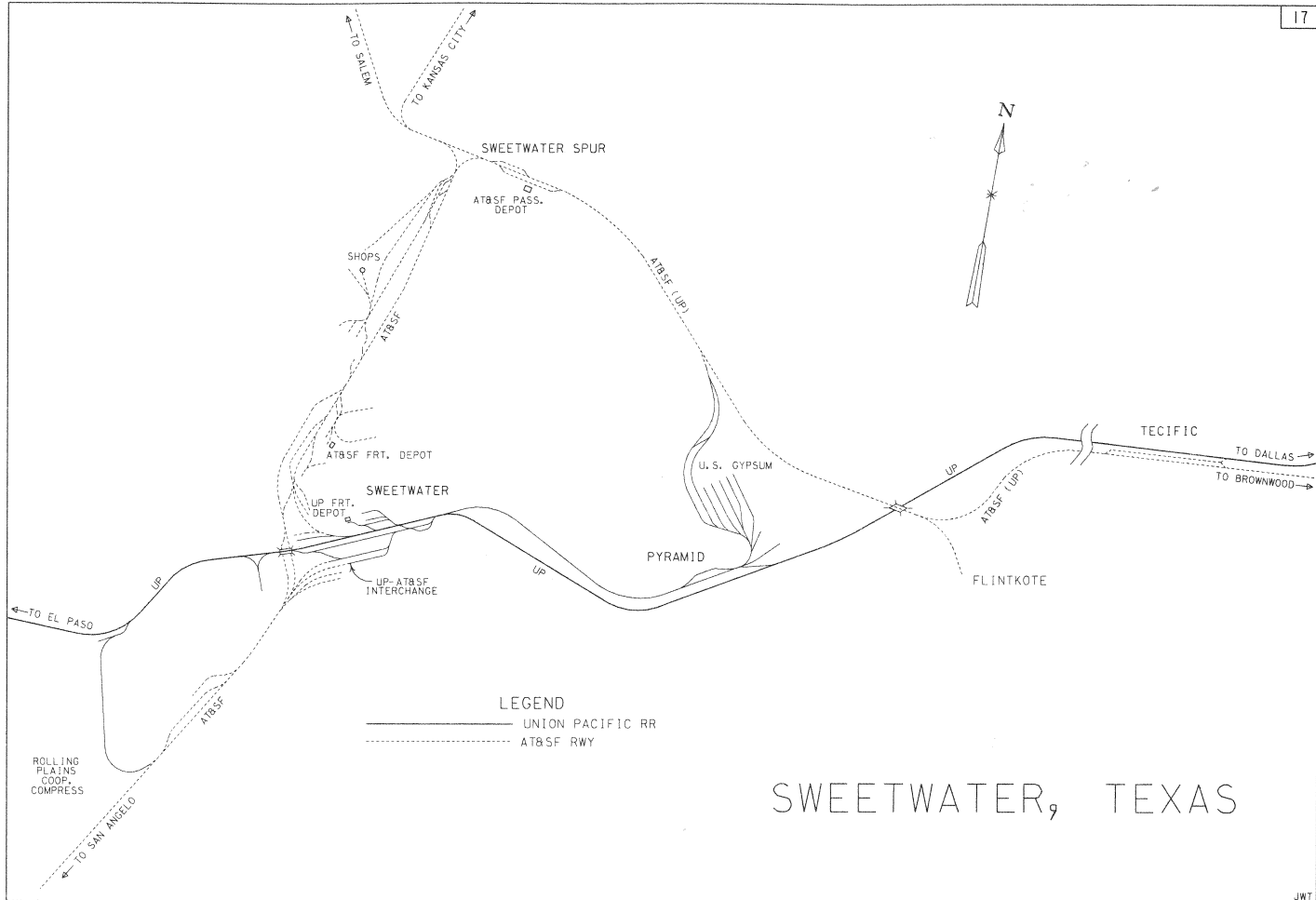

SWEETWATER, TEXAS

CONSTRUCTED 1880 BY THE TEXAS AND PACIFIC RAILWAY

18

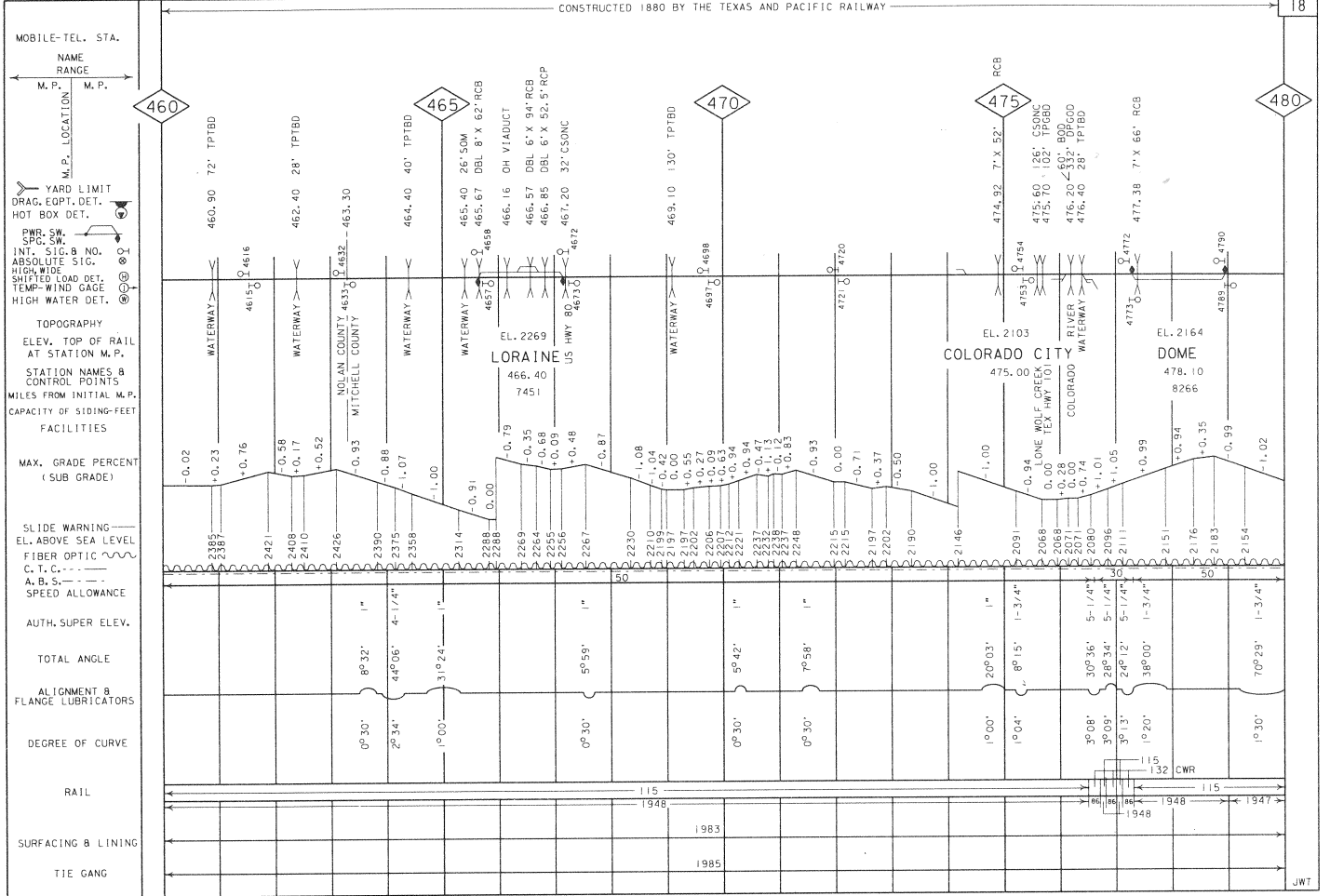

RAIL, SURFACING & LINING AND TIE GANG CORRECTED FOR FEBRUARY 4, 1988

ALIGNMENT & PROFILE CORRECTED FOR SEPTEMBER 15, 1988

ABIL

CONSTRUCTED 1880 BY THE TEXAS AND PACIFIC RAILWAY

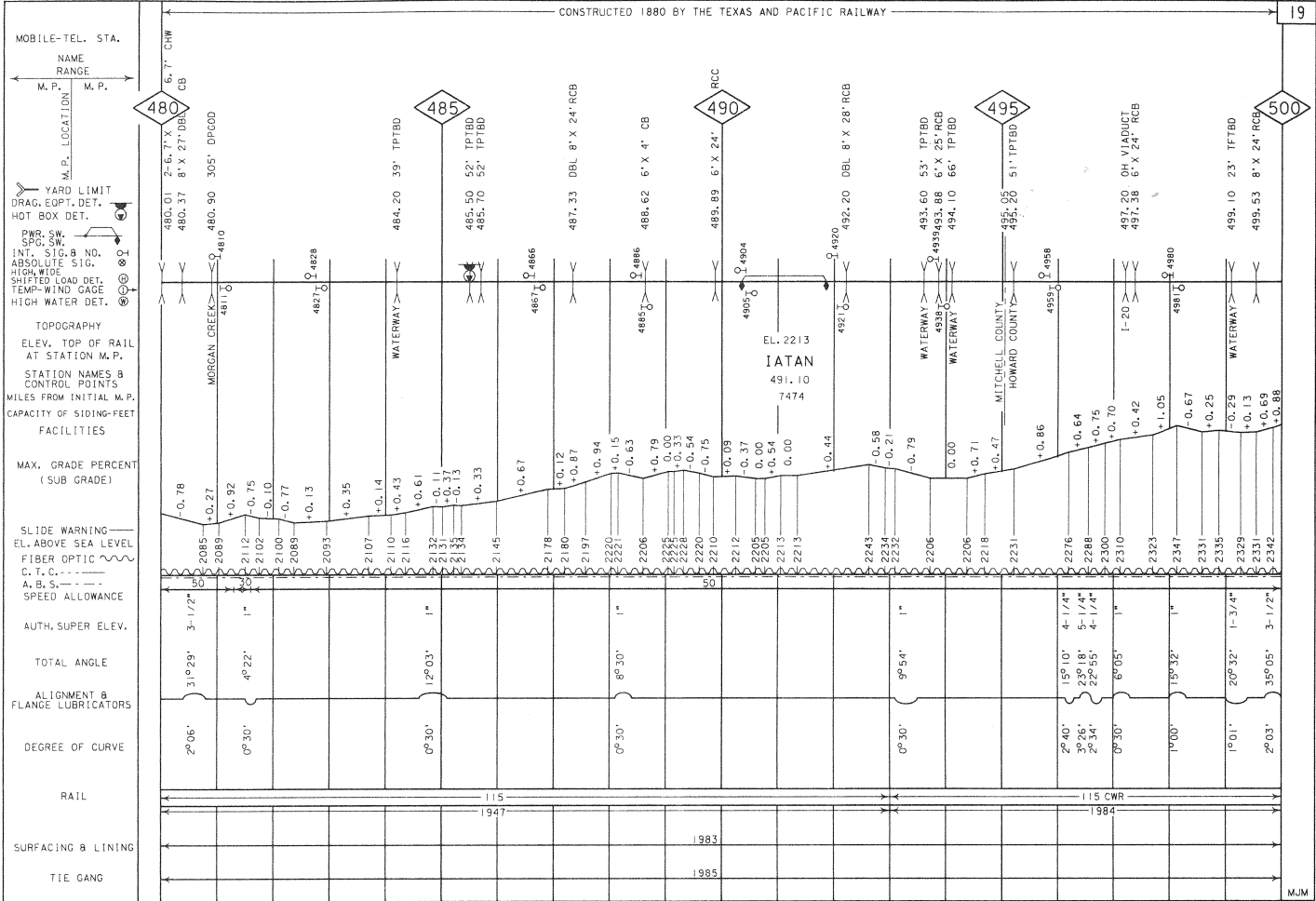

RAIL, SURFACING & LINING AND TIE GANG CORRECTED FOR FEBRUARY 2, 1987

ALIGNMENT & PROFILE CORRECTED FOR SEPTEMBER 8, 1988

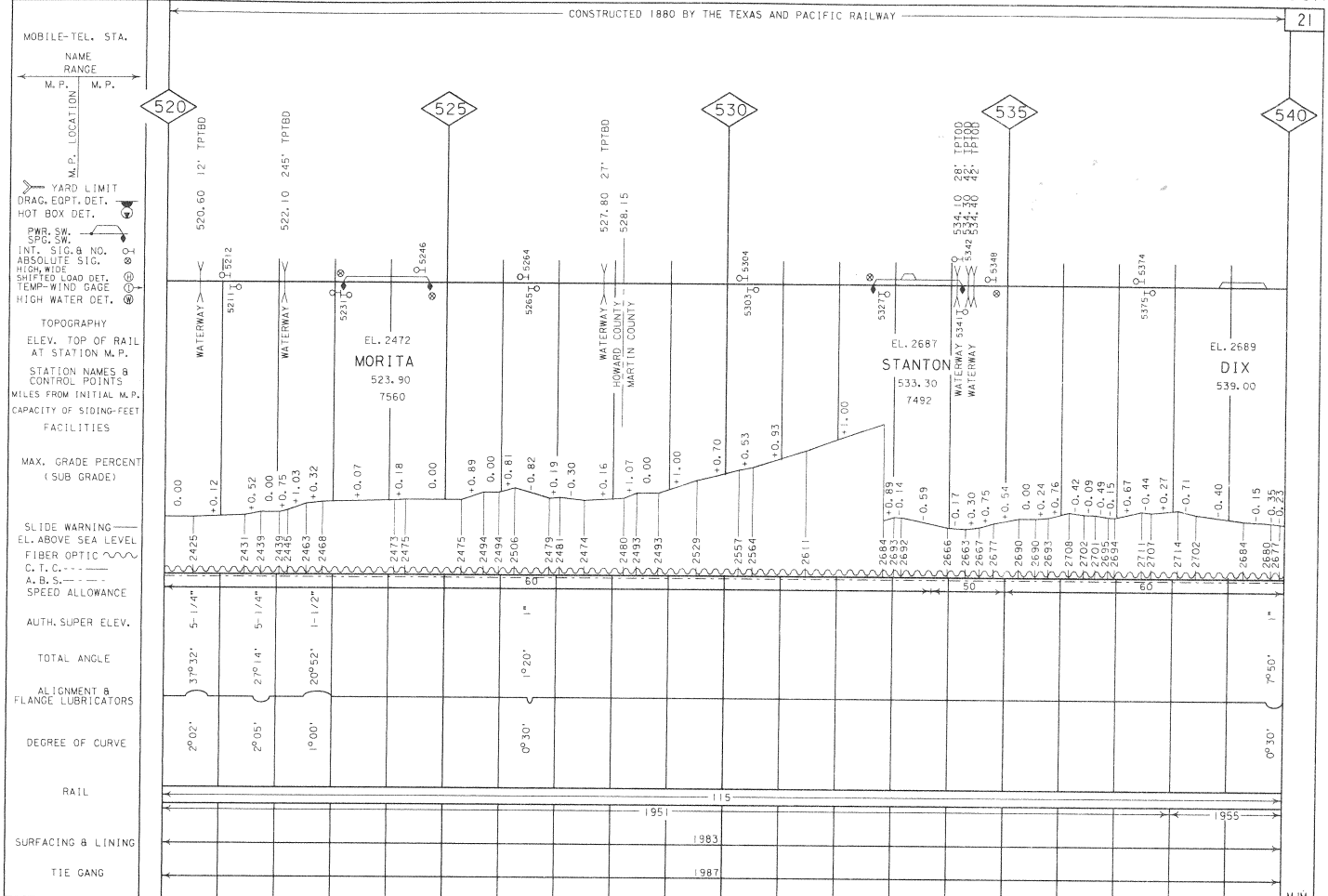

RAIL, SURFACING & LINING AND TIE GANG CORRECTED FOR DECEMBER 10, 1987

ALIGNMENT & PROFILE CORRECTED FOR SEPTEMBER 8, 1988

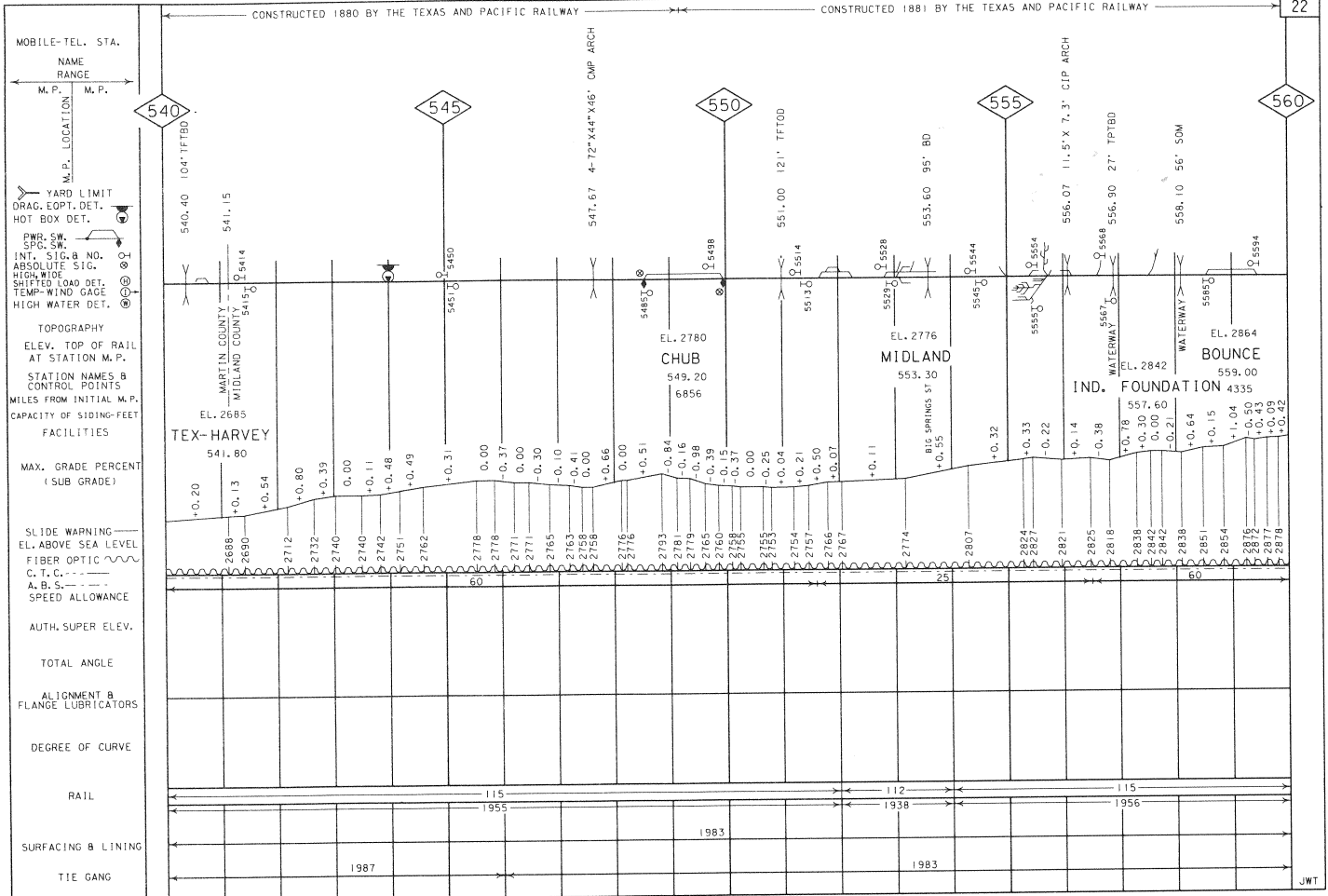

CONSTRUCTED 1881 BY THE TEXAS AND PACIFIC RAILWAY

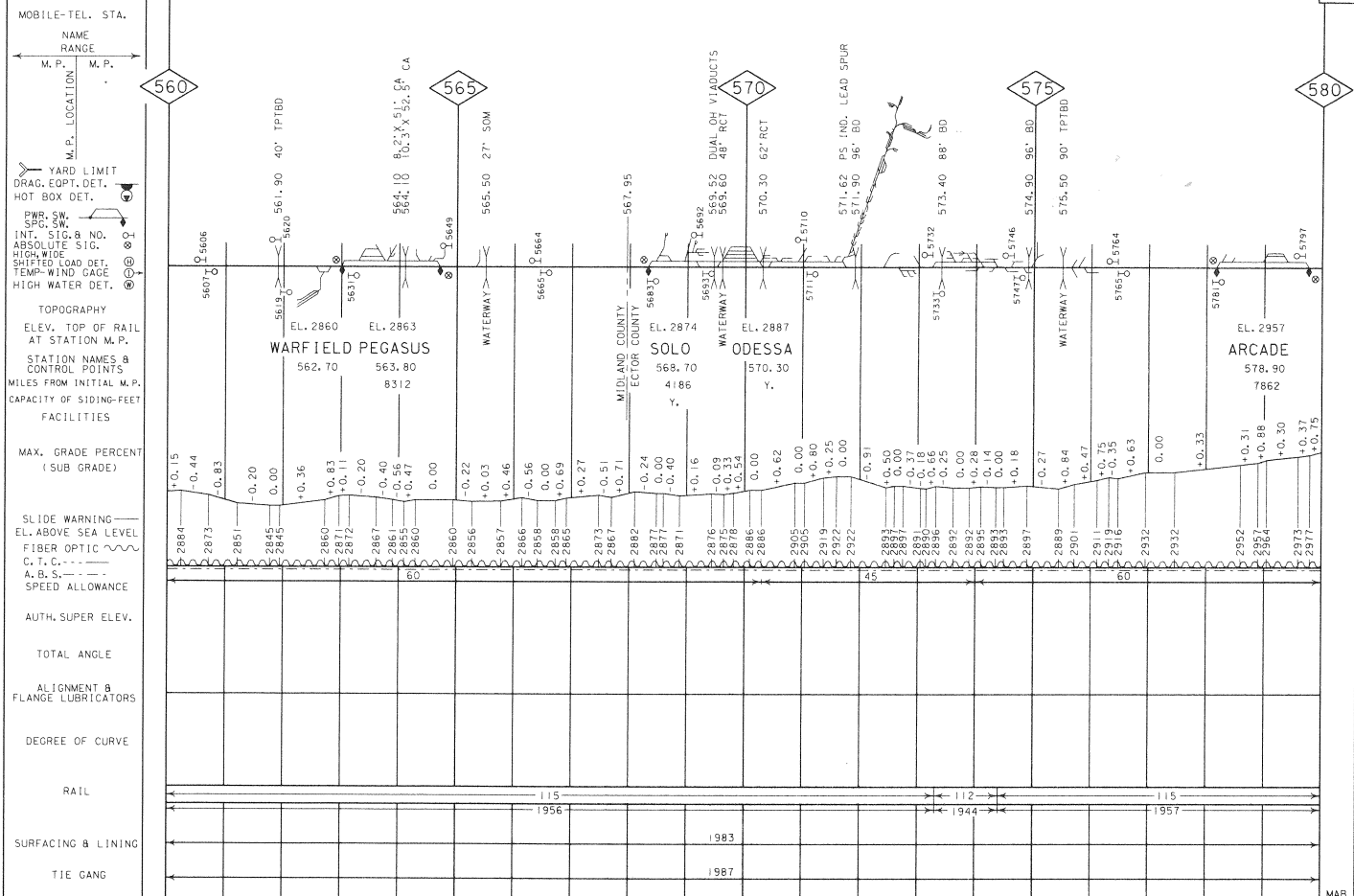

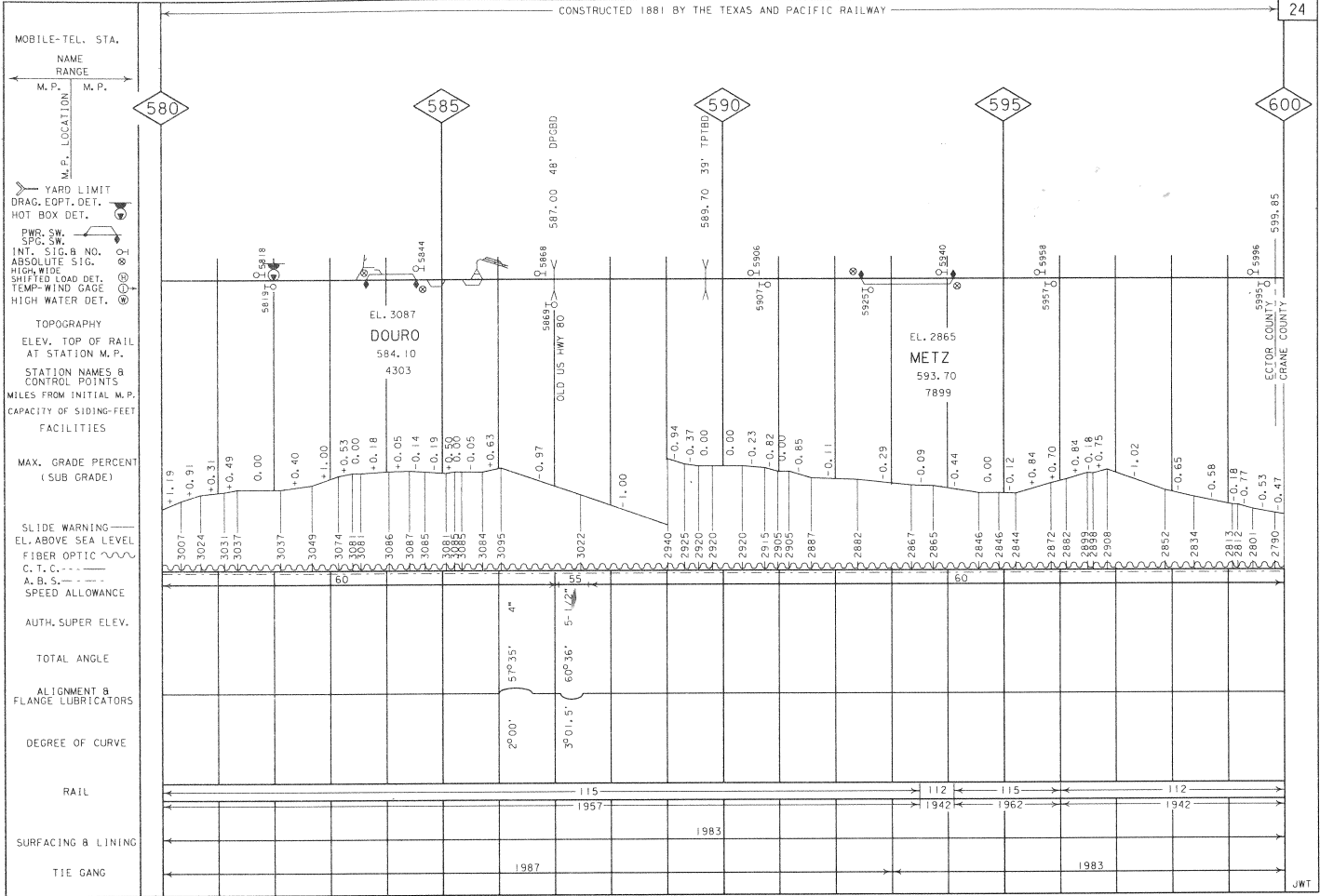

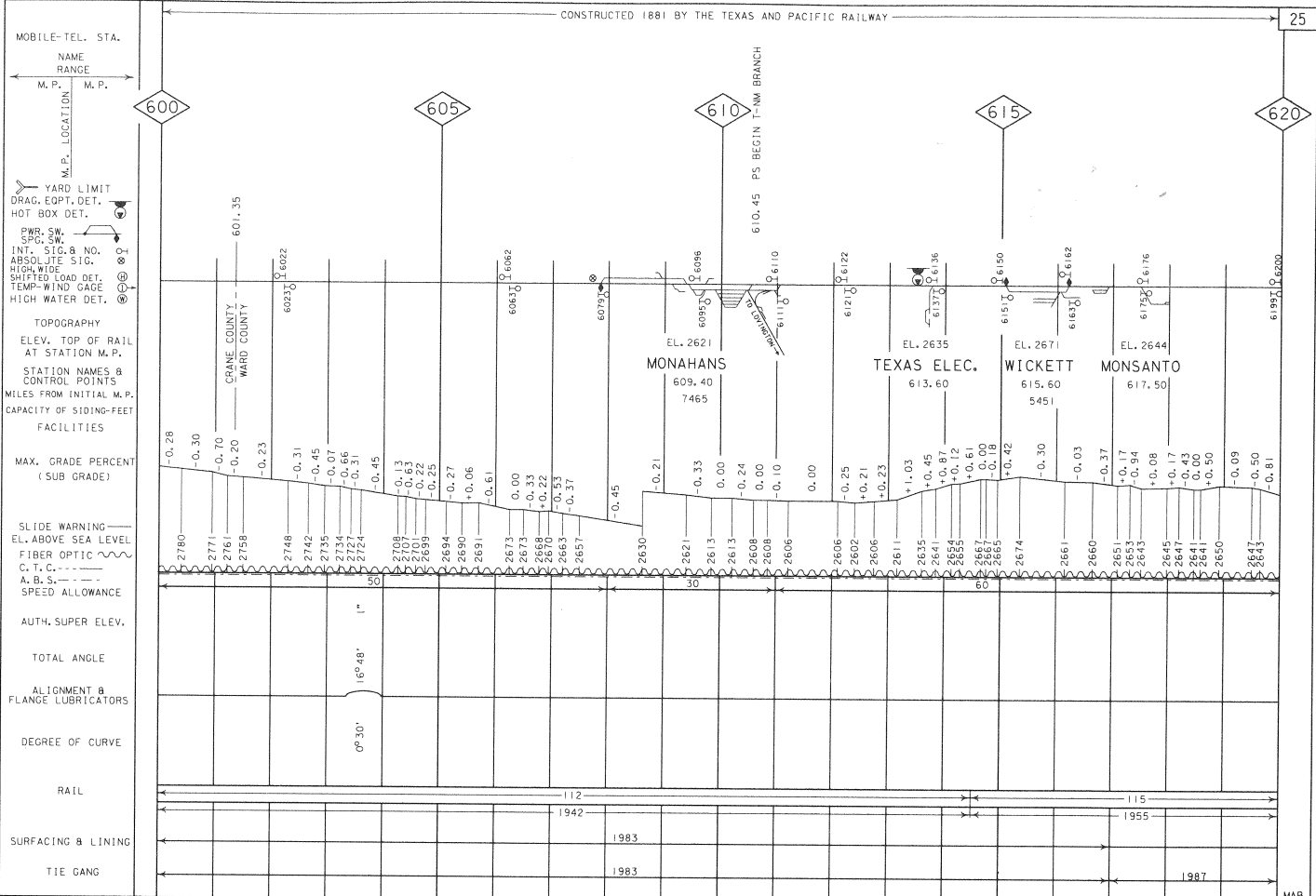

RAIL, SURFACING & LINING AND TIE GANG CORRECTED FOR DECEMBER 10, 1987

ALIGNMENT & PROFILE CORRECTED FOR JUNE 23, 1988

CONSTRUCTED 1881 BY THE TEXAS AND PACIFIC RAILWAY

MOBILE-TEL. STA.
NAME
RANGE
M. P. LOCATION M. P.

620

625

630

635

640

YARD LIMIT
DRAG, EOPT, DET.
HOT BOX DET.
PWR. SW. SPG. SW.
INT. SIG. B NO.
ABSOLUTE SIG. 6-4
HIGH WIDE
SHIFTED LOAD DET.
TEMP-WIND GAGE
HIGH WATER DET.

TOPOGRAPHY
ELEV. TOP OF RAIL
AT STATION M. P.
STATION NAMES &
CONTROL POINTS
MILES FROM INITIAL M. P.
CAPACITY OF SIDING-FEET
FACILITIES

MAX. GRADE PERCENT
(SUB GRADE)

SLIDE WARNING
EL. ABOVE SEA LEVEL
FIBER OPTIC
C. T. C. ---
A. B. S. ---
SPEED ALLOWANCE

AUTH. SUPER ELEV.

TOTAL ANGLE

ALIGNMENT &
FLANGE LUBRICATORS

DEGREE OF CURVE

RAIL

SURFACING & LINING

TIE GANG

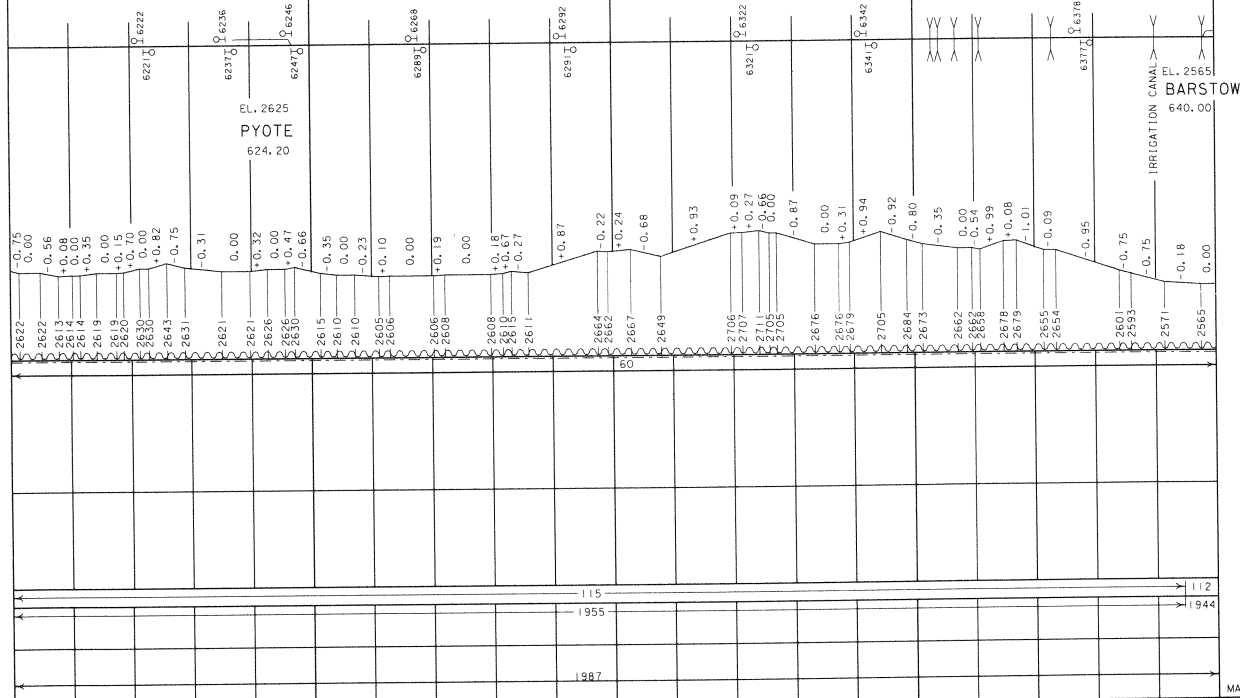

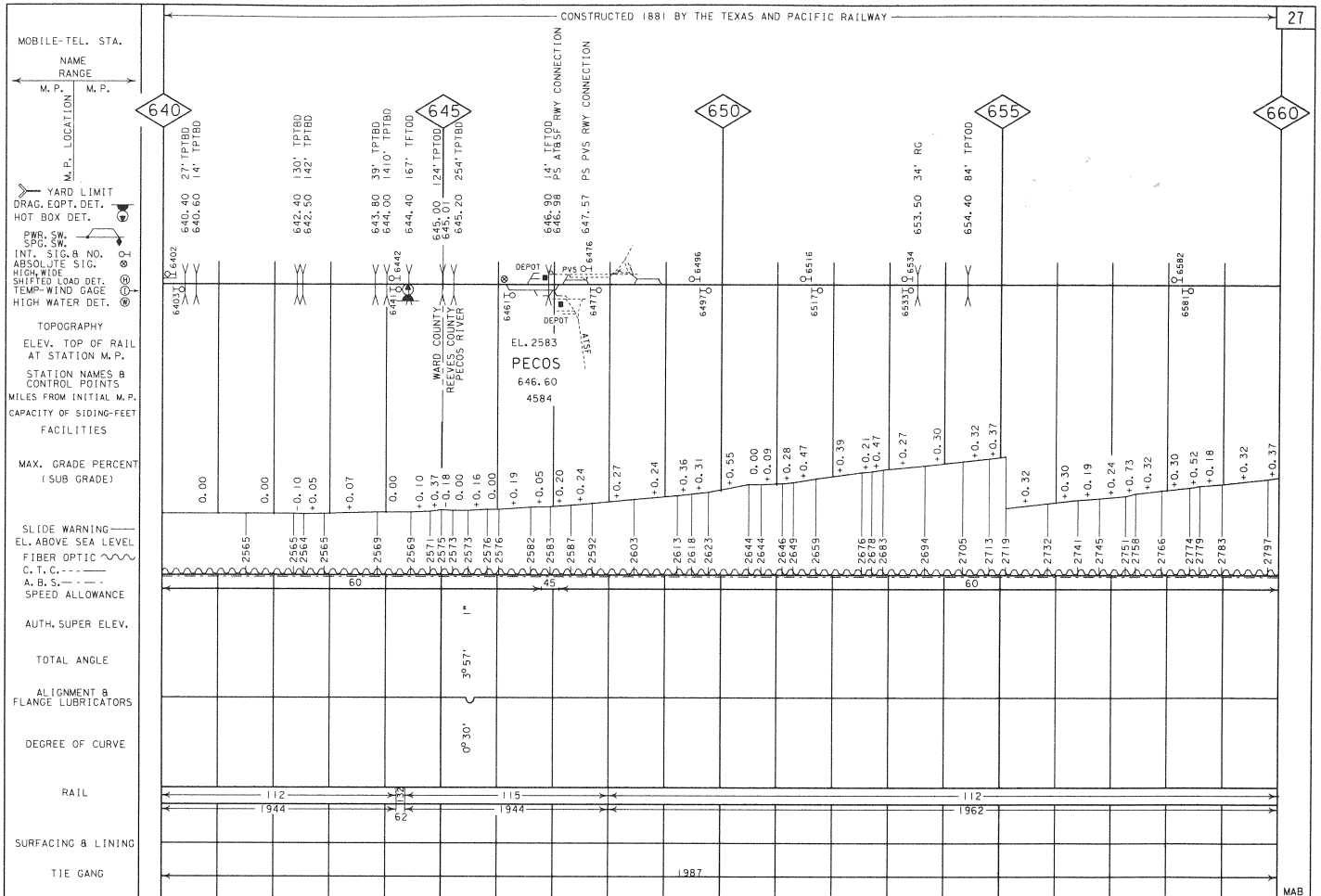

CONSTRUCTED 1881 BY THE TEXAS AND PACIFIC RAILWAY

MOBILE-TEL. STA.

NAME RANGE

M.P. LOCATION M.P.

M.P. LOCATION M.P.

M.P. LOCATION M.P.

M.P. LOCATION M.P.

M.P. LOCATION M.P.

M.P. LOCATION M.P.

M.P. LOCATION M.P.

M.P. LOCATION M.P.

M.P. LOCATION M.P.

M.P. LOCATION M.P.

M.P. LOCATION M.P.

M.P. LOCATION M.P.

M.P. LOCATION M.P.

M.P. LOCATION M.P.

M.P. LOCATION M.P.

M.P. LOCATION M.P.

M.P. LOCATION M.P.

M.P. LOCATION M.P.

M.P. LOCATION M.P.

M.P. LOCATION M.P.

M.P. LOCATION M.P.

M.P. LOCATION M.P.

M.P. LOCATION M.P.

M.P. LOCATION M.P.

M.P. LOCATION M.P.

M.P. LOCATION M.P.

M.P. LOCATION M.P.

M.P. LOCATION M.P.

M.P. LOCATION M.P.

M.P. LOCATION M.P.

M.P. LOCATION M.P.

M.P. LOCATION M.P.

M.P. LOCATION M.P.

M.P. LOCATION M.P.

M.P. LOCATION M.P.

M.P. LOCATION M.P.

M.P. LOCATION M.P.

M.P. LOCATION M.P.

M.P. LOCATION M.P.

M.P. LOCATION M.P.

M.P. LOCATION M.P.

M.P. LOCATION M.P.

M.P. LOCATION M.P.

M.P. LOCATION M.P.

M.P. LOCATION M.P.

M.P. LOCATION M.P.

M.P. LOCATION M.P.

M.P. LOCATION M.P.

M.P. LOCATION M.P.

M.P. LOCATION M.P.

M.P. LOCATION M.P.

M.P. LOCATION M.P.

M.P. LOCATION M.P.

M.P. LOCATION M.P.

M.P. LOCATION M.P.

M.P. LOCATION M.P.

M.P. LOCATION M.P.

M.P. LOCATION M.P.

M.P. LOCATION M.P.

660

665

670

675

680

- YARD LIMIT
- DRAG. EOPT. DET.
- HOT BOX DET.
- PWR. SW. 50' SW.
- INT. SIG. NO.
- ABSOLUTE SIG.
- HIGH WIDE
- SHIFTED LOAD DET.
- TEMP-WIND GAGE
- HIGH WATER DET.

TOPOGRAPHY
ELEV. TOP OF RAIL AT STATION M.P.
STATION NAMES & CONTROL POINTS
MILES FROM INITIAL M.P.
CAPACITY OF SIDING- FEET FACILITIES

MAX. GRADE PERCENT (SUB GRADE)

SLIDE WARNING
EL. ABOVE SEA LEVEL
FIBER OPTIC
C. T. C.
A. B. S.
SPEED ALLOWANCE

AUTH. SUPER ELEV.

TOTAL ANGLE

ALIGNMENT & FLANGE LUBRICATORS

DEGREE OF CURVE

RAIL

SURFACING & LINING

TIE GANG

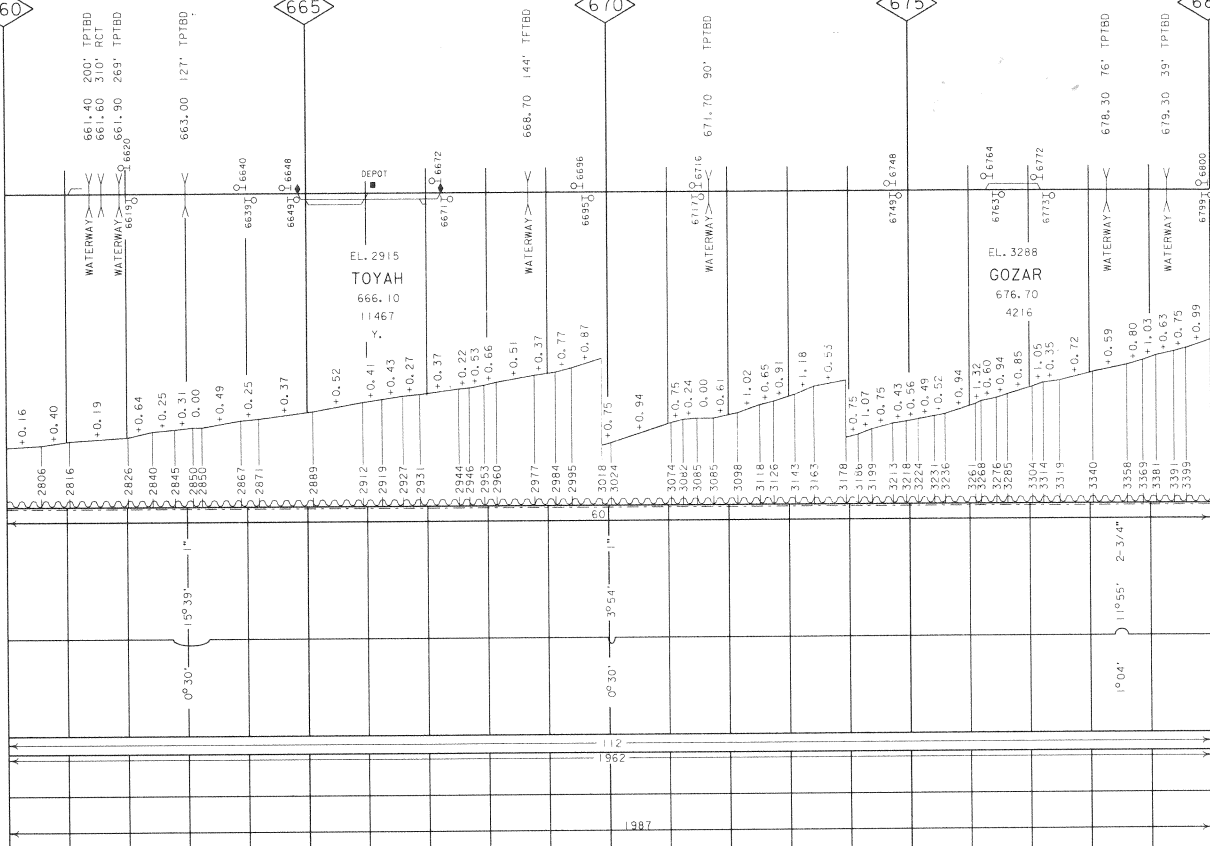

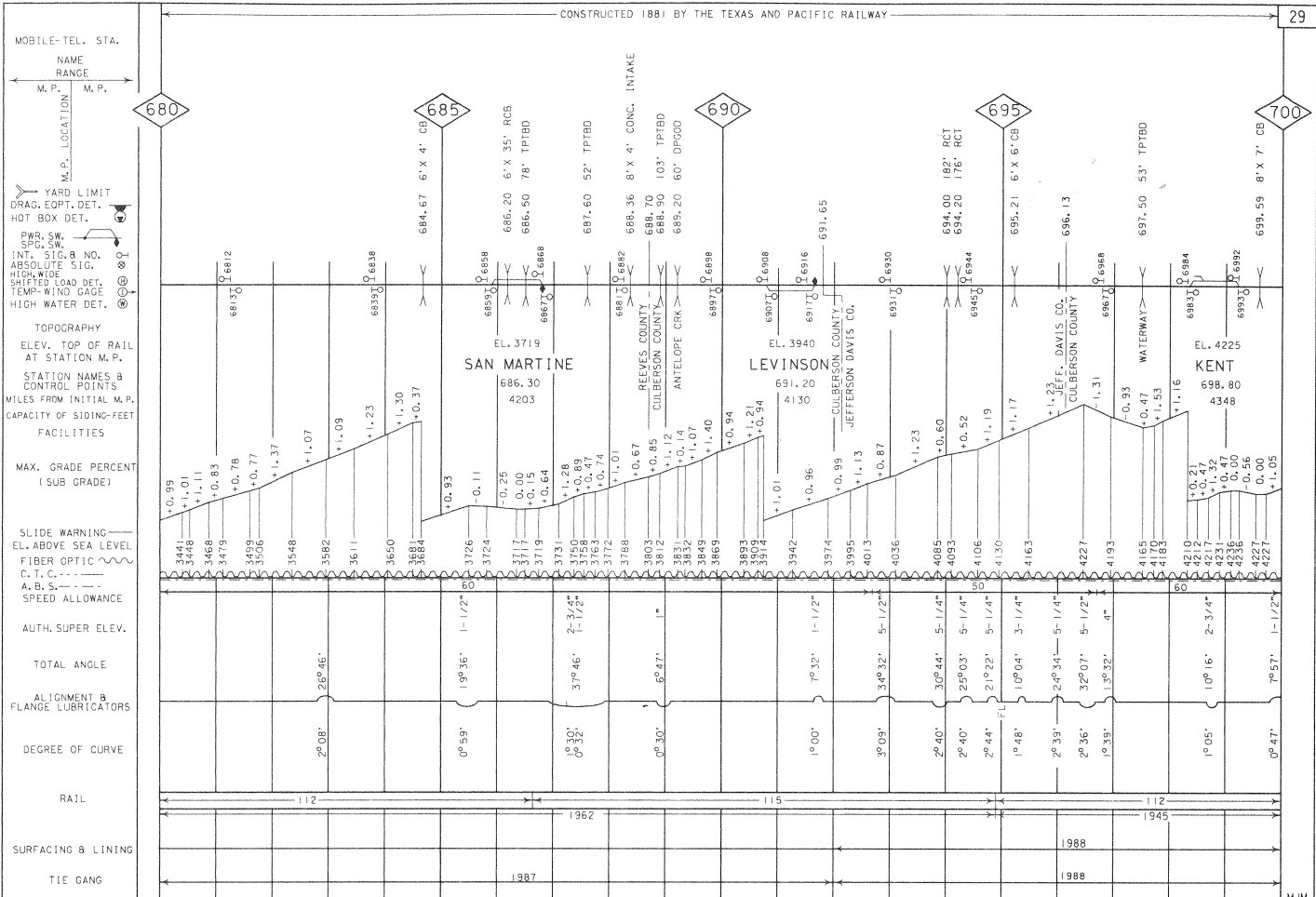

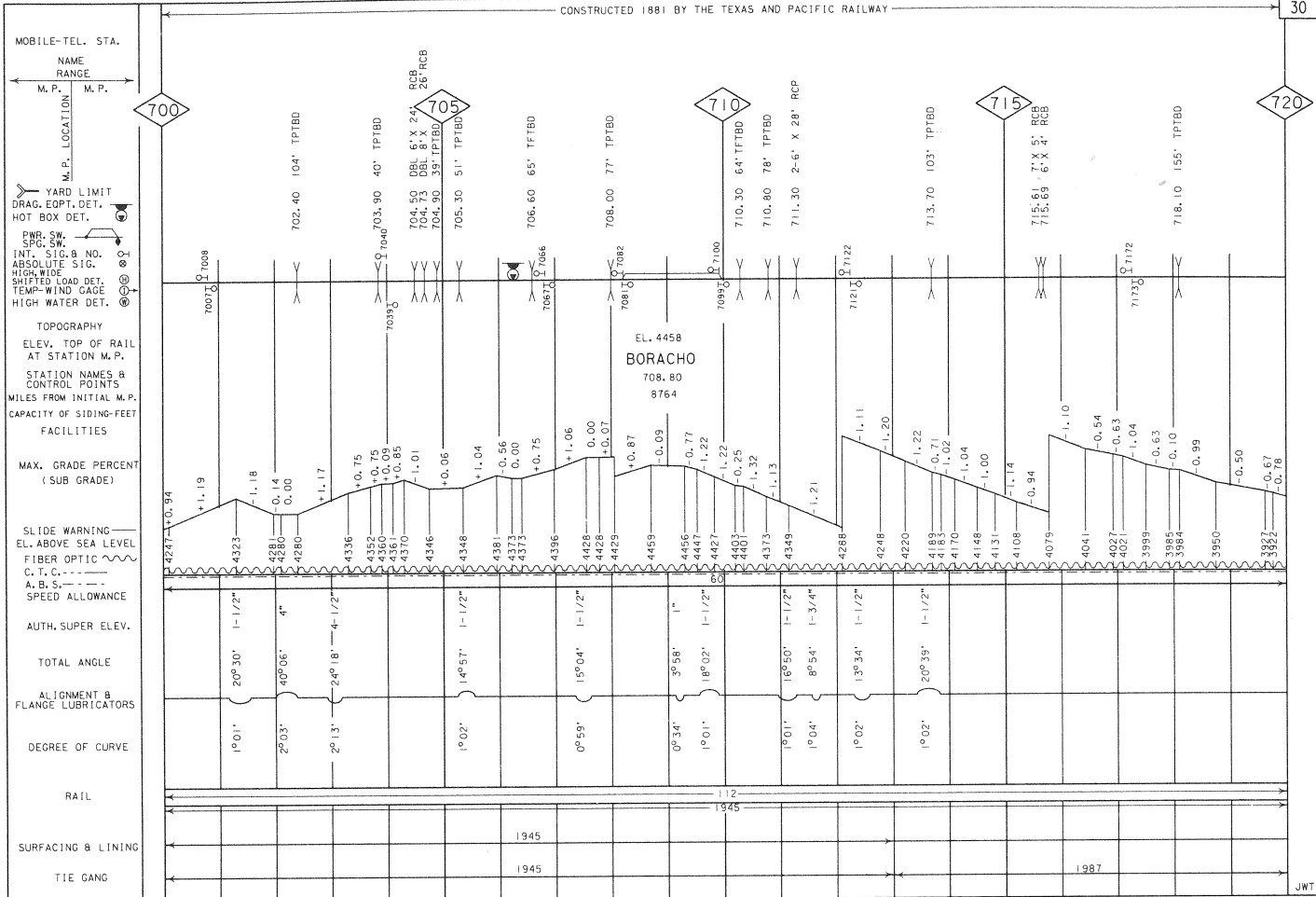

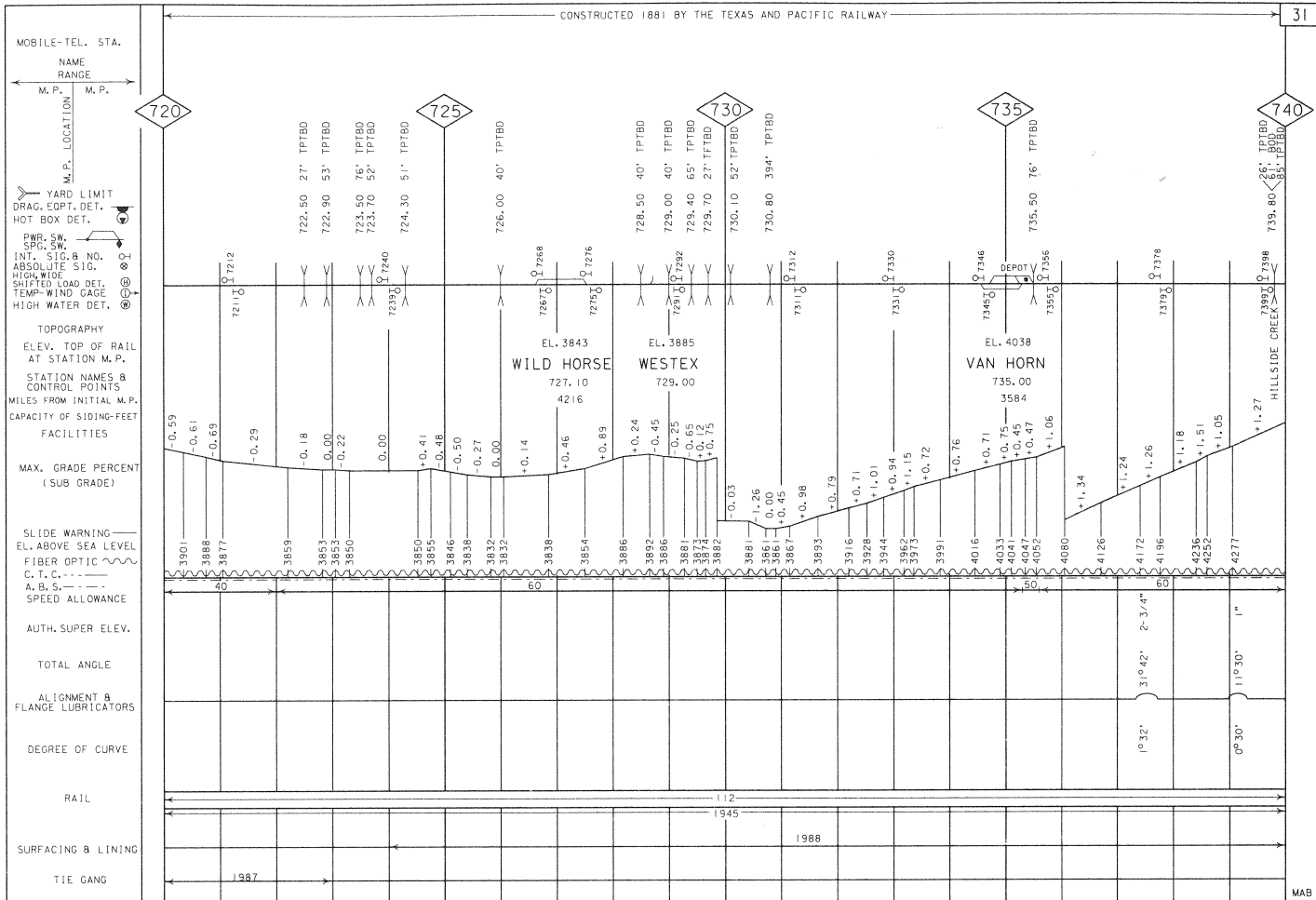

CONSTRUCTED 1881 BY THE GALVESTON, HARRISBURG & SAN ANTONIO RAILWAY
 TRACKAGE RIGHTS GRANTED TO MISSOURI PACIFIC RR (T&P Rwy) VIA SOUTHERN PACIFIC RR (G&SA Rwy) 1881

MOBILE-TEL. STA.
 NAME RANGE
 M. P. M. P.
 M.P. LOCATION
 YARD LIMIT
 DRAG, EXPT. DET.
 HOT STOP DET.
 SW. SW.
 INT. SIG. B NO.
 ABSOLUTE SIG.
 HIGH WIDE
 SHIFTED LOAD DET.
 TEMP. WIND GAGE
 HIGH WATER DET.
 TOPOGRAPHY
 ELEV. TOP OF RAIL AT STATION M.P.
 STATION NAMES & CONTROL POINTS
 MILES FROM INITIAL M.P.
 CAPACITY OF SIDING-FEET FACILITIES
 MAX. GRADE PERCENT (SUB GRADE)
 SLIDE WARNING
 EL. ABOVE SEA LEVEL
 FIBER OPTIC
 C.T.C.
 A. B. S.
 SPEED ALLOWANCE
 AUTH. SUPER ELEV.
 TOTAL ANGLE
 ALIGNMENT & FLANGE LUBRICATORS
 DEGREE OF CURVE
 RAIL
 SURFACING & LINING
 TIE GANG

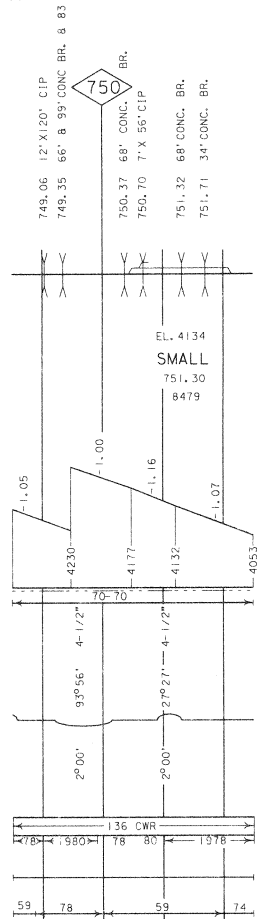

EQUATION
 M.P. 752.57
 M.P. 755.49

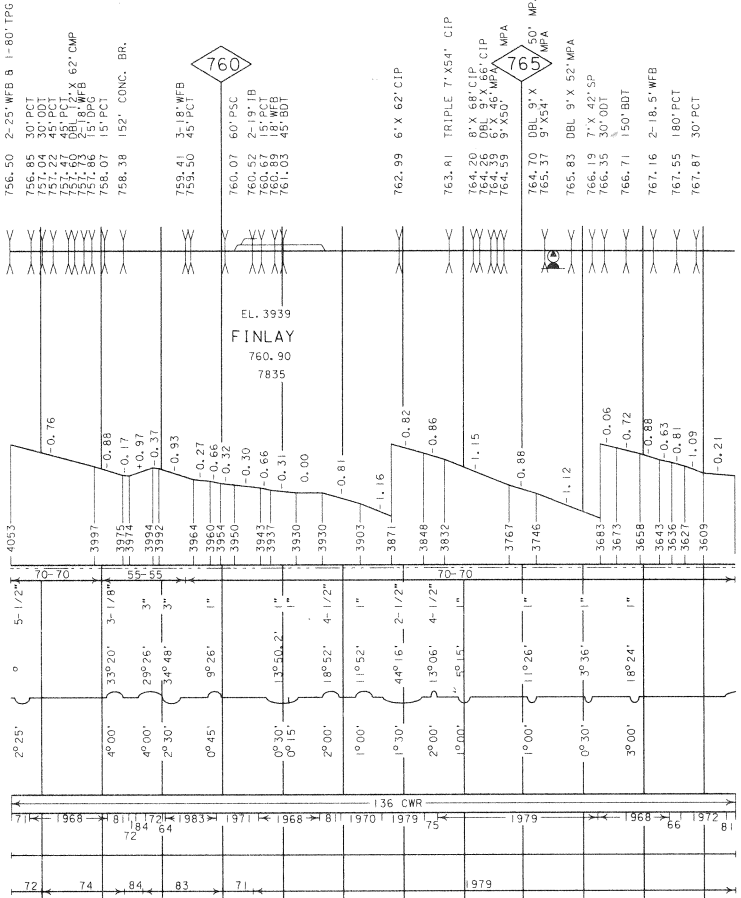

CONSTRUCTED 1881 BY THE GALVESTON, HARRISBURG & SAN ANTONIO RAILWAY
 TRackage RIGHTS GRANTED TO MISSOURI PACIFIC RR (T&P Rwy) VIA SOUTHERN PACIFIC RR (G&H&A Rwy) 1881

MOBILE-TEL. STA.
 NAME RANGE
 M. P. LOCATION M. P.
 M. P. LOCATION
 YARD LIMIT
 DRAG. EQPT. DET.
 HOT BOX DET.
 PWR. SW. SPG. SW.
 INT. SIG. & NO. ABSOLUTE SIG.
 HIGH WIDE SWIFTED LOAD DET.
 TEMP-WIND GAGE
 HIGH WATER DET.
 TOPOGRAPHY
 ELEV. TOP OF RAIL AT STATION M. P.
 STATION NAMES & CONTROL POINTS.
 MILES FROM INITIAL M. P.
 CAPACITY OF SIDING- FEET FACILITIES
 MAX. GRADE PERCENT (SUB GRADE)
 SLIDE WARNING
 EL. ABOVE SEA LEVEL
 FIBER OPTIC
 C. T. C.
 A. B. S.
 SPEED ALLOWANCE
 AUTH. SUPER ELEV.
 TOTAL ANGLE
 ALIGNMENT & FLANGE LUBRICATORS
 DEGREE OF CURVE
 RAIL
 SURFACING & LINING
 TIE GANG

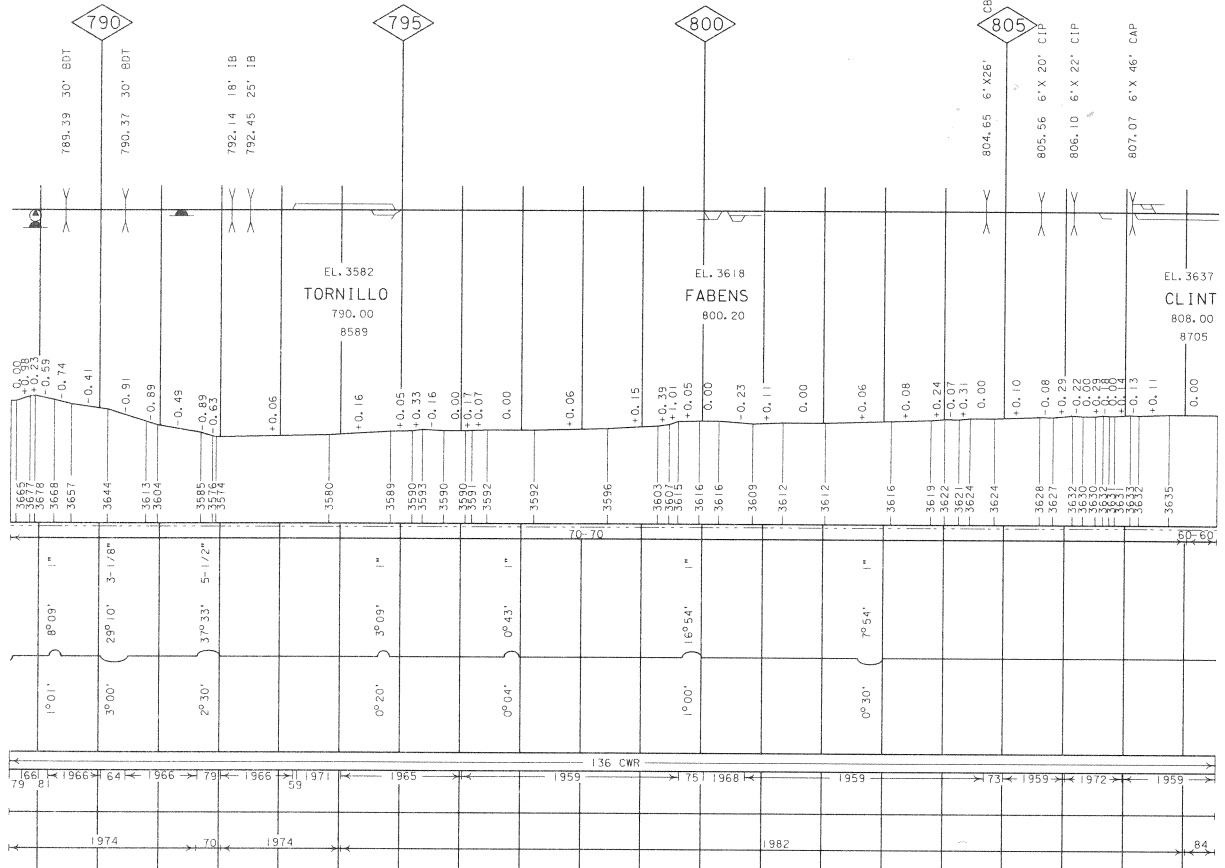

RAIL, SURFACING & LINING AND TIE GANG CORRECTED FOR JANUARY 1, 1986

ALIGNMENT & PROFILE CORRECTED FOR JUNE 27, 1988

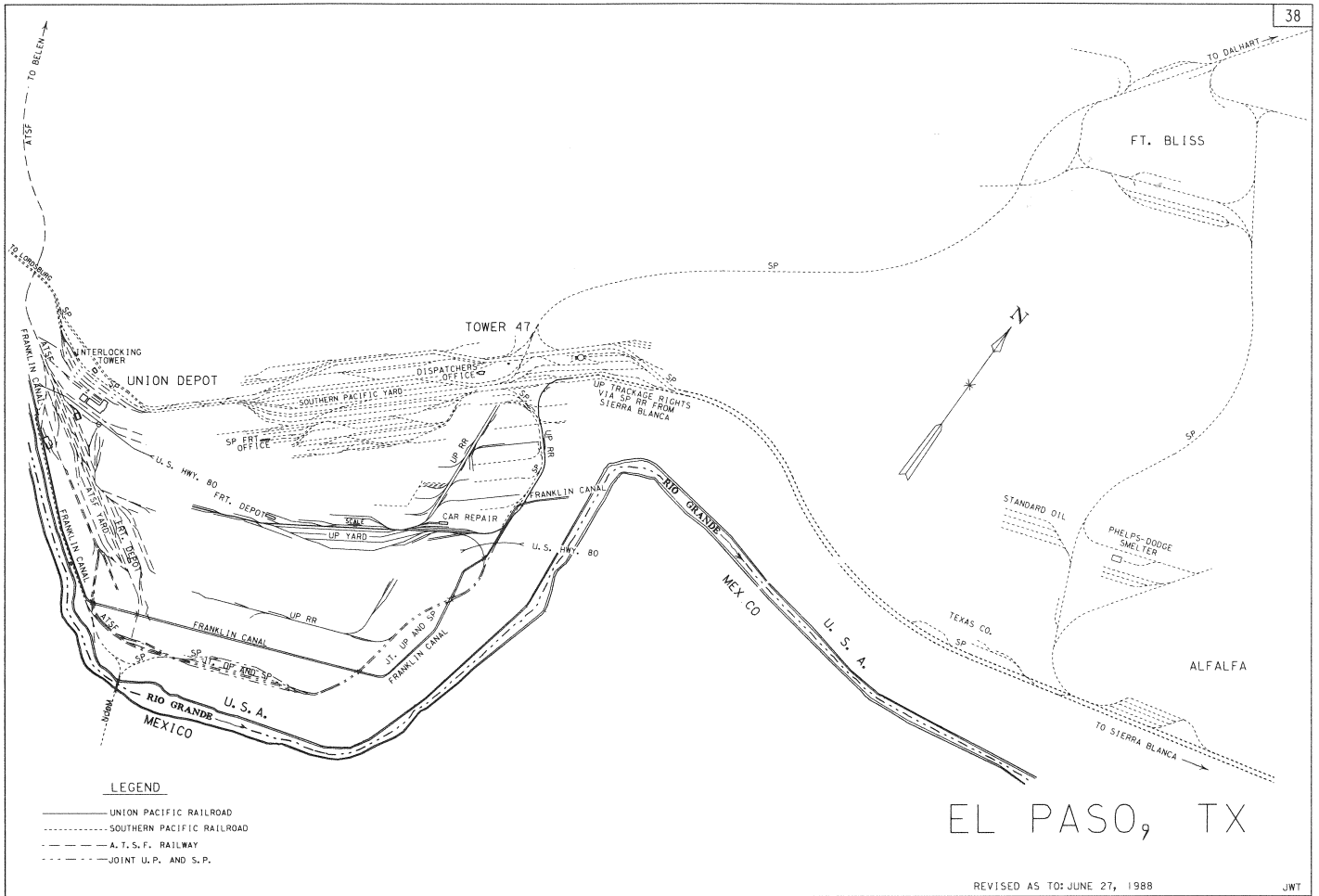

LEGEND

- UNION PACIFIC RAILROAD
- SOUTHERN PACIFIC RAILROAD
- - - - A. T. S. F. RAILWAY
- · · · · JOINT U. P. AND S. P.

EL PASO, TX