

KEEP THE SAFETY HABIT



**CAR  
LOCATION  
INVENTORY  
CONTROL**

INSTRUCTIONS - MAPS  
INDUSTRIAL ZONE TRACK,  
SPOT NUMBERS

DEMING DISTRICT  
SANTA RITA DISTRICT

NEW MEXICO DIVISION  
BOOK NO.

5

ISSUED JULY 1, 1980

INSTRUCTIONS SET FORTH BELOW GOVERN THE OPERATION OF CAR LOCATION INVENTORY CONTROL (CLIC). THIS DIVISION IS DIVIDED INTO ZONES WITH EACH ZONE HAVING DESIGNATED TRACKS AND/OR INDUSTRIES WITHIN ITS BOUNDRIES. TRACKS ARE ASSIGNED SPECIFIC NUMBERS WITHIN THE ZONES AND SPOTS ON THE TRACKS ARE GIVEN INDIVIDUAL NUMBERS. BY USING ZONE, TRACK AND SPOT NUMBERS, WE ARE ABLE TO PRINT SWITCH LISTS WHICH WILL REFLECT THE LOCATION TO WHICH A CAR SHOULD BE SPOTTED.

A CLIC SPOT NUMBER WILL CONSIST OF SIX DIGITS; THE FIRST TWO DIGITS DESIGNATE THE ZONE TO WHICH A CAR IS DESTINED; THE SECOND TWO DIGITS INDICATE THE TRACK NUMBER WITHIN THE ZONE; THE LAST TWO DIGITS REPRESENT THE ACTUAL SPOT ALONG THE TRACK.

EXAMPLE OF CLIC SPOT NUMBER  
=====

67 25 04 LANCASTER WHOLESALE  
' ' '----- SPOT NUMBER  
' '-----TRACK NUMBER  
'-----ZONE NUMBER

ALL INDUSTRIES WILL BE REFERRED TO BY CLIC SPOT NUMBER RATHER THAN BY NAME.

SWITCHES ARE PAINTED WITH ZONE AND TRACK NUMBER SHOWN ON EITHER TARGET OR STAND. SPOT NUMBERS HAVE BEEN PAINTED ON DOORS, DOCKS, BUILDINGS, GATES, ETC. WHERE POSSIBLE; OTHERWISE, THE PROPER SPOT CAN BE DETERMINED BY NOTING SPOT DESCRIPTIONS THAT ARE FOUND JUST OPPOSITE ZONE MAPS ON THE FOLLOWING PAGES OF THIS BOOK.

THE MAPS ARE NOT DRAWN TO SCALE, BUT MERELY SERVE AS A GUIDE IN LOCATING PROPER TRACKS OR SPOTS.

THE FOLLOWING INSTRUCTIONS PERTAIN SPECIFICALLY TO THE PHYSICAL SWITCHING, SPOTTING AND PULLING OF CARS ARE CALLED PARTICULARLY TO THE ATTENTION OF ALL TRAINMEN FOR THEIR COMPLIANCE:

(1) ALL SWITCHING WILL BE PERFORMED BY USE OF SWITCHLIST UNLESS OTHERWISE INSTRUCTED.

(2) DISPOSITION TO BE MADE OF CAR WILL BE SHOWN ON SWITCH LIST UNDER CLIC NO. INDUSTRY TO.

(3) CONDUCTOR/ENGINE FOREMAN WILL SWITCH CARS ACCORDING TO LIST. SHOULD IT BE NECESSARY FOR CONDUCTOR ENGINE FOREMAN TO SWITCH OR PLACE TO SOME LOCATION OTHER THAN DESTINATION SHOWN ON SWITCH LIST, HE MUST SO INDICATE ON SWITCH LIST.

(4) IF CAR IS NOT ACTUALLY SPOTTED, BUT LEFT ON THAT INDUSTRY'S TRACK, THE CONDUCTOR WILL INDICATE (ON TRACK NOT PLACED) IN THE FOLLOWING MANNER, (OTNP). IF CAR IS PLACED ON TRACK OR SOME OTHER TRACK, FOR SWITCHING CONVENIENCE, CONDUCTOR WILL INDICATE ON LIST (ON TRACK CARRIERS CONVENIENCE) IN THE FOLLOWING MANNER, (OTCC)

(5) CONDUCTOR MUST MAKE NOTATION ON SWITCH LIST OF ANY EXCEPTIONS TAKEN TO SWITCH LIST, SUCH AS NO CAR, CAR NOT ON LIST, CAR OUT OF LINE, CAR IS HAZARDOUS, EXCESS DIMENSION (WHEN THE INFORMATION IS NOT SO INDICATED ON SWITCH LIST), CAR IS CARDED REAR OR HEAD END MOVEMENT ONLY, OR ANY OTHER EXCEPTIONS NOTED.

(6) NOTATION MUST BE MADE INDICATING ANY EXTRA SWITCHING MOVES MADE WHICH ARE NOT SHOWN ON SWITCH LIST.

(7) IF A CAR OTHER THAN ONE ORDERED TO AN INDUSTRY IS SPOTTED, CONDUCTOR ENGINE FOREMAN MUST INDICATE ON LIST CAR NUMBER ACTUALLY SPOTTED.

(8) CONDUCTOR/ENGINE FOREMAN MUST SHOW ON SWITCH LIST ACTUAL TIME CAR ARE PLACED OR PULLED AT AN INDUSTRY.

(9) CONDUCTOR/ENGINE FOREMAN WILL INDICATE ON SWITCH LIST ANY WORK NOT COMPLETED, SHOWING TIME AND DATE ALL SWITCHING ON LIST IS COMPLETED, SIGN HIS NAME IN FULL AND RETURN SWITCH LIST TO ISSUING AGENCY FOR PROCESSING.

ICC SERVICE DIRECTIVE EX-PARTE 285 REQUIRES A LIST OF CARS SPOTTED OR PULLED FROM AN INDUSTRY INDICATING:  
(A) CAR INITIAL AND NUMBER  
(B) WHETHER LOADED OR EMPTY  
(C) WHETHER SPOTTED OR PULLED  
(D) TIME, DATE, ENGINE OR TRAIN NUMBER, AND-  
(E) SIGNATURE OF CONDUCTOR/ENGINE FOREMAN PERFORMING THE SWITCHING.  
EACH CONDUCTOR/ENGINE FOREMAN MUST FURNISH THE SIGNED LIST TO AGENCY THAT MAINTAINS RECORDS OF SUCH CARS.

(10) IF AN INDUSTRY REQUESTS SERVICE NOT SHOWN ON SWITCH LIST, CONDUCTOR/ENGINE FOREMAN SHOULD OBTAIN SUCH REQUEST IN WRITING. THIS REQUEST IS TO BE TURNED IN WITH SWITCH LIST FOR PROCESSING. IF UNABLE TO OBTAIN REQUEST IN WRITING, CONDUCTOR/ENGINE FOREMAN SHOULD RECORD ON SWITCH LIST THE NAME OF PERSON MAKING REQUEST, THE SERVICE REQUESTED AND PERFORMED.

FOR OBSERVATION AND GUIDANCE, THE FOLLOWING CODES MAY BE SHOWN ON SWITCH LIST PRECEDING THE CAR INITIAL.

B1 - BAD ORDER  
C1 - CONDEMNED CAR  
CB - COMBUSTIBLE <HAZARDOUS>  
CL - CHLORINE <HAZARDOUS>  
CM - CORROSIVE <HAZARDOUS>  
CU - COMPLETELY UNLOADS  
DG - DANGEROUS <HAZARDOUS>  
EP - EMPTY PLACED OR TO PLACE LOADING  
FG - FLAMMABLE GAS <HAZARDOUS>  
FH - FLAMMABLE GAS <HAZARDOUS>  
FL - FLAMMABLE <HAZARDOUS>  
FS - FLAMMABLE SOLID <HAZARDOUS>  
HB - HOLD FOR BILLING  
HC - HOLD FOR CHARGES OR PERMIT  
HD - HOLD FOR DISPOSITION  
HE - HEAD END MOVEMENT  
HS - HOLD SHIPPERS ORDER NOTIFY CAR  
IPSW INTERPLANT SWITCH

SWITCHING CODES CONTINUED FROM PRE-  
VIOUS PAGE (C)

NG - NONFLAMMABLE GAS (HAZARDOUS)  
OM - OXIDIZER (HAZARDOUS)  
OP - ORGANIC PEROXIDE (HAZARDOUS)  
OTCC ON TRACK CARRIERS CONVENIENCE  
OTNP ON TRACK NOT PLACED  
OX - OXYGEN (HAZARDOUS)  
PA - POISON GAS (HAZARDOUS)  
PB - POISON (HAZARDOUS)  
PU - CAR PARTIALLY UNLOADS  
RE - REAR END MOVEMENT ONLY  
REJT CAR REJECTED BY SHIPPER  
RELD UNLOADED AND BEING RELOADED  
RSPT RESPOT DUE TO RAILROAD ERROR  
TT - TEAM TRACK LOAD  
TURN TURN CAR AND RESPOT  
WH - WEIGH HEAVY  
WL - WEIGH LIGHT  
XA - EXPLOSIVES A (HAZARDOUS)  
XB - EXPLOSIVES B (HAZARDOUS)  
XX - DO NOT MOVE THIS CAR

GOOD COMMUNICATION AND COMPLIANCE  
WITH INSTRUCTIONS IS ESSENTIAL FOR  
A COMPLETE AND SUCCESSFUL CLIC  
OPERATION. YOUR REPORTINGS ARE  
THE KEY TO ACCURATE RECORDS.

THE COMPLETE COOPERATION OF EVERY  
EMPLOYEE IS SOLICITED.

I N D E X

\*\*\*\*\*

\*=====,=====,=====\*

STATION NAME	STA. NUMBER	PAGE
--------------	-------------	------

\*=====,=====,=====\*

ASARCO MILL	4155	18
BAYARD	4197	36
BURRO MOUNTAIN	7529	26
COBRE	4200	42
COBRE (OLD HANOVER)	4199	40
DEMING	4154	10
FIERRO INDUSTRIAL	7656	38
HATCH	4105	2
HOCKETT	4114	4
HURLEY	4194	32
MIRAGE	4146	8
NUTT	4126	6
PERUHILL	4157	20
SANTA RITA	4202	46
SILVER CITY	7541	30
SPALDING	4171	22
STAR SHAFT	4201	44
TYRONE INDUSTRIAL	7613	28
WHITEWATER	4185	24

ZONE 50 (HATCH 4105) DEMING DISTRICT

- 509900 HATCH MAIN TRACK
- 500100 HATCH HOUSE TRACK (1078 FT)
- 01 HATCH HOUSE DOCK
- 500200 HATCH SIDING (2118 FT)
- 500300 HATCH TEAM TRACK (1222 FT)
- 500400 HATCH HOUSE SPUR

DOCK

PAGE ONE

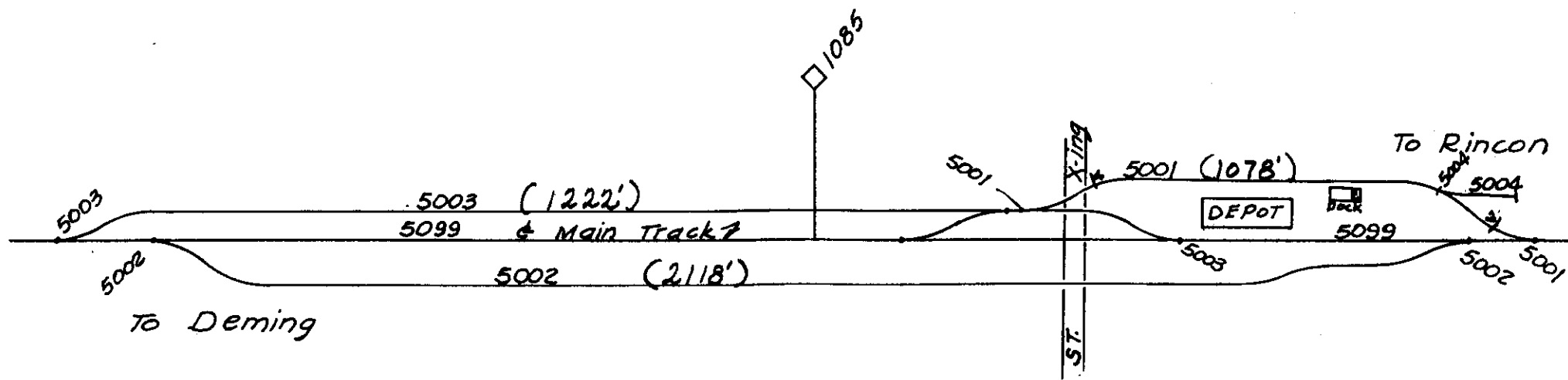

HATCH  
ZONE 50 PAGE 2

509900 HOCKETT MAIN TRACK  
500600 HOCKETT SIDING (2997 FT)

PAGE 3

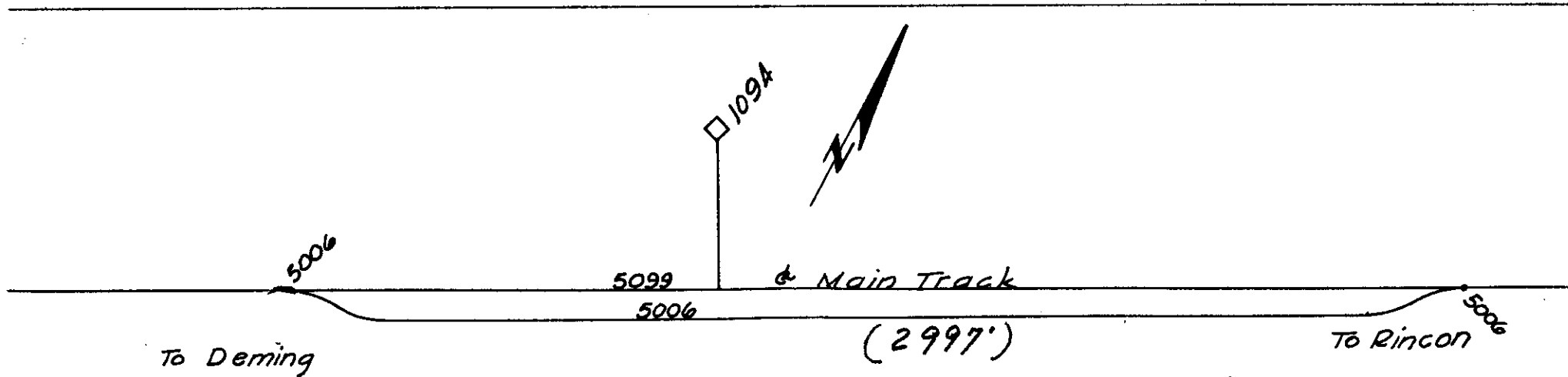

HOCKETT  
ZONE 50 PAGE 4



ZONE 50 (NUTT 4126) DEMING DISTRICT

509900 NUTT MAIN TRACK  
500800 NUTT EAST LEG WYE (1313 FT)  
500900 NUTT SIDING (1919 FT)  
501000 NUTT WEST LEG WYE (616 FT)

PAGE 5

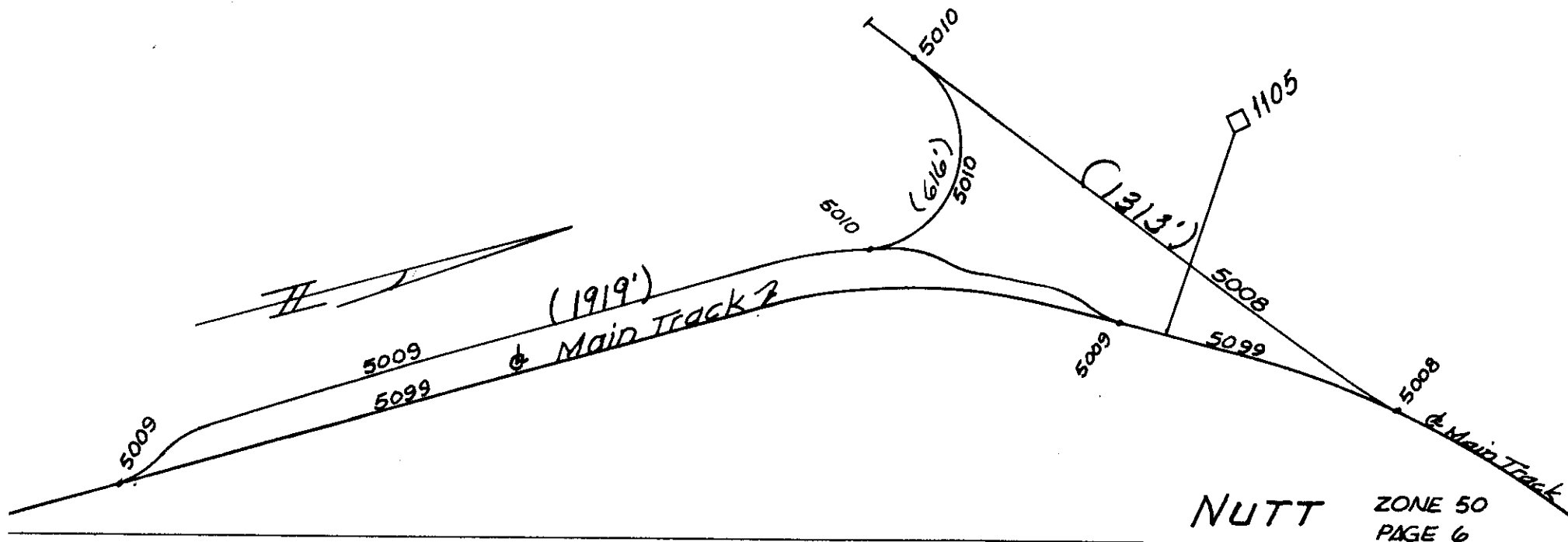

ZONE 50 (MIRAGE 4146) DEMING DISTRICT

509900 MIRAGE MAIN TRACK  
501200 MIRAGE SIDNG (3115 FT)

PAGE 7

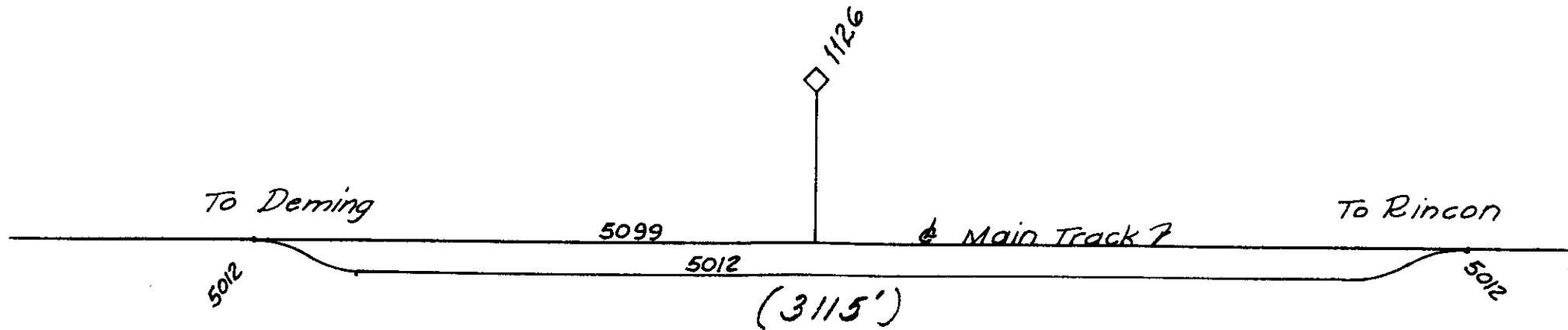

MIRAGE  
ZONE 50 PAGE 8

ZONE 50 (DEMING 4154) DEMING DISTRICT

509900 DEMING MAIN TRACK  
501400 DEMING MILITARY SPUR

PAGE 9

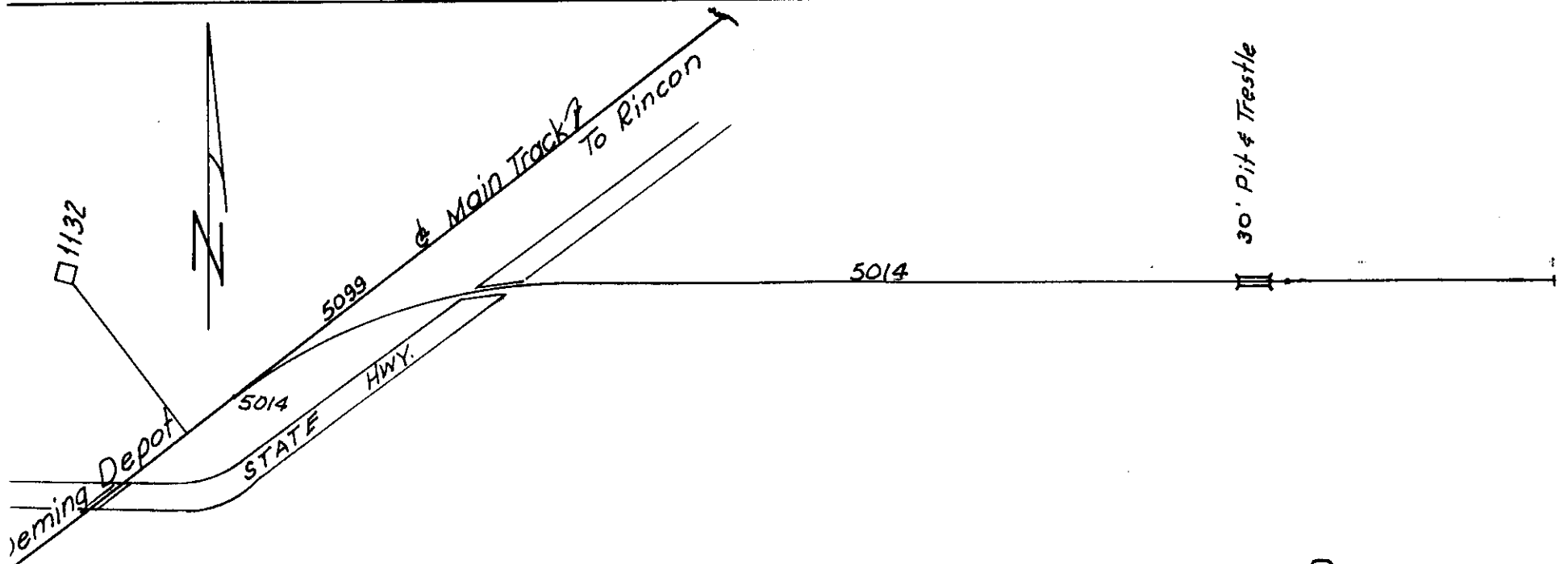

Identical Point "A"

ZONE 50 (DEMING 4154) DEMING DISTRICT

- 509900 DEMING MAIN TRACK
- 501500 DEMING STOCK TRACK (1733 FT)
- 501600 DEMING TEAM TRACK (2116 FT)
- 501700 DEMING ICE DOCK TRACK
- 501800 DEMING EAST NO. 4 TRACK (3197 FT)

PAGE 11

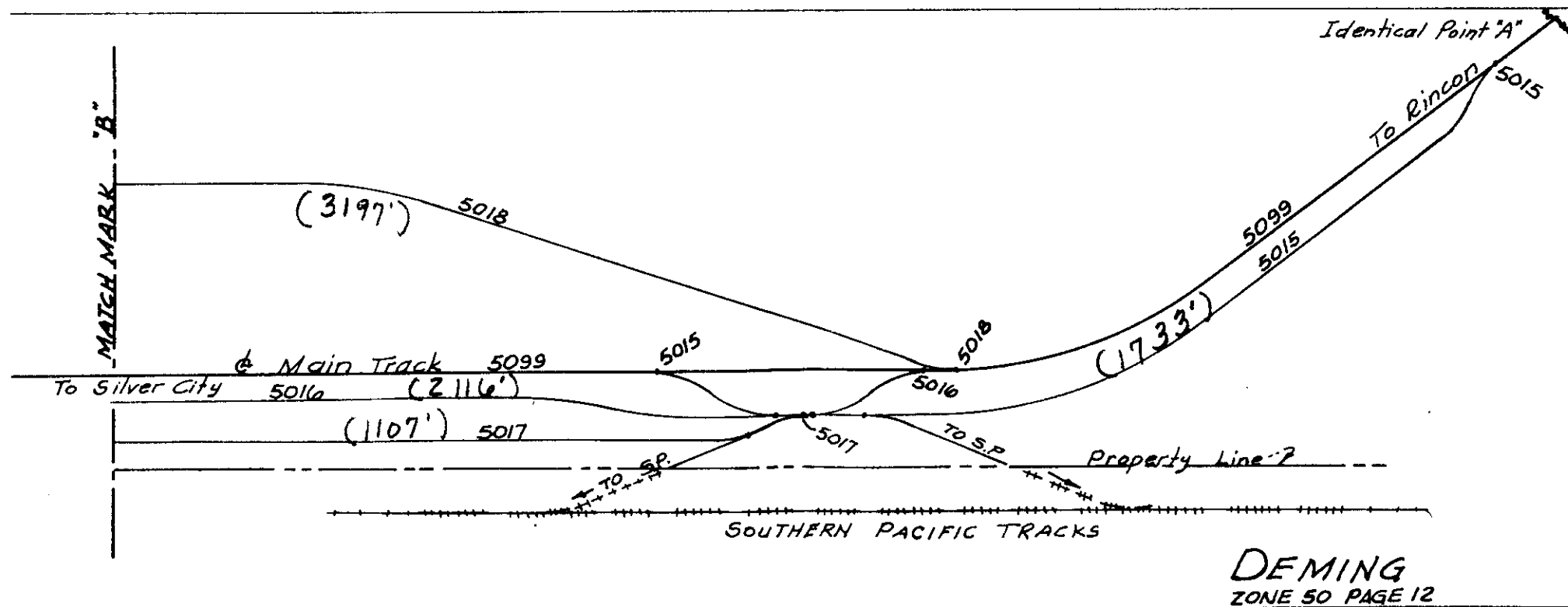

DEMING  
ZONE 50 PAGE 12

ZONE 50 <DEMING 4154> DEMING DISTRICT

- 509900 DEMING MAIN TRACK
- 501600 DEMING TEAM TRACK (2116 FT)
- 504700 DEMING ICE DOCK TRACK (1107 FT)
- 504800 DEMING EAST NO. 4 TRACK (3197 FT)
- 01 DEMING END DOCK DOCK
- 501900 DEMING EAST NO. 5 TRACK (1015 FT)
- 01 DEMING MANGANESE LOADING RAMP
- 502000 DEMING HOTEL TRACK
- 502100 DEMING NO. 1 TRACK (3659 FT)
- 502200 DEMING NO. 2 TRACK (3433 FT)

PAGE 13

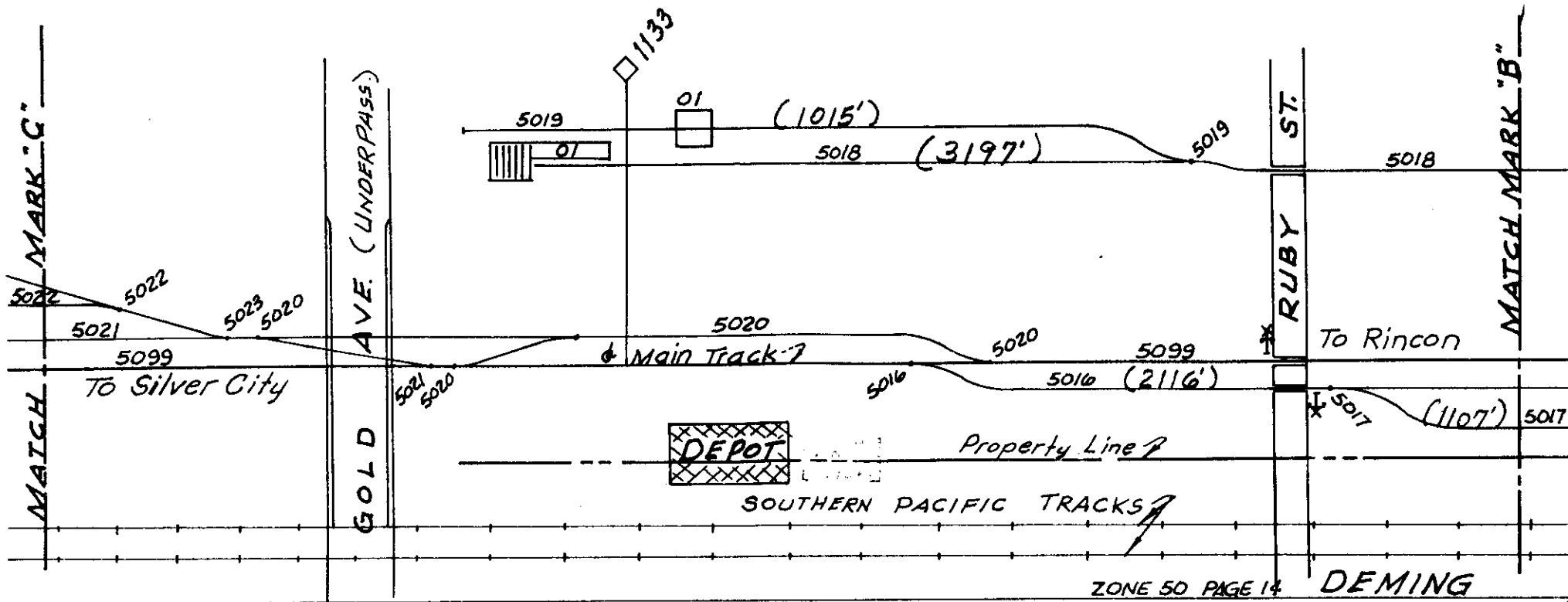

ZONE 50 (DEMING 4154) DEMING DISTRICT

509900	DEMING MAIN TRACK	
502100	DEMING NO. 1 TRACK (3659 FT)	
502200	DEMING NO. 2 TRACK (3133 FT)	
502300	DEMING EAST LEAD TO 5 & 6 (500 FT)	
502400	DEMING SCALE TRACK (651 FT)	
502500	DEMING NO. 5 TRACK (1824 FT)	
502600	DEMING NO. 6 TRACK (1824 FT)	
502700	DEMING SEVEN UP SPUR	
01	DEMING SERVICE COMPANY	DOOR
02	DEMING SEVEN UP BLDG	DOOR
503000	DEMING NEW SP CROSSOVER	

PAGE 15

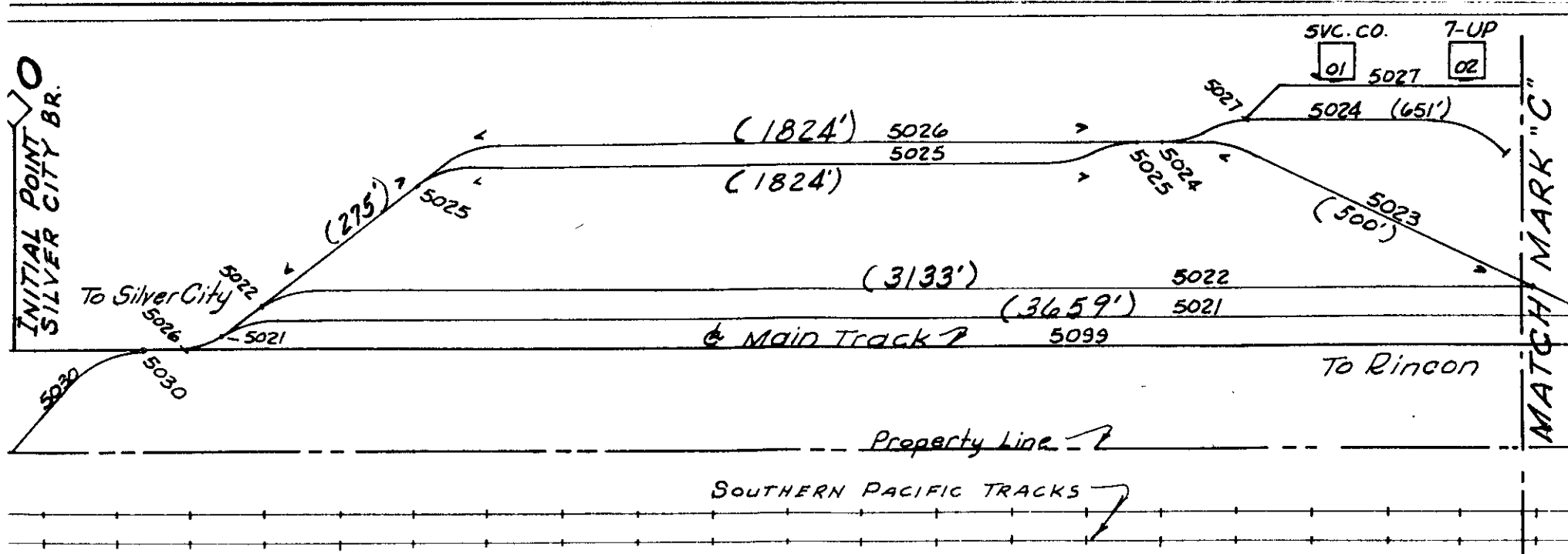

ZONE 54 (ASARCO MILL 4155) DEMING DISTRICT

- 549900 ASARCO MILL MAIN TRACK
- 540400 ASARCO MILL INBOUND TRACK (1974 FT)
- 01 ASARCO MILL LOADING HOPPER HOPPER
- 540200 ASARCO MILL TIPPLE TRACK
- 540400 ASARCO MILL LOADING TRACK (1379 FT)
- 01 ASARCO MILL SCALES SCALES
- 540500 ASARCO MILL RUN-A-ROUND TRACK (255 FT)

PAGE 17

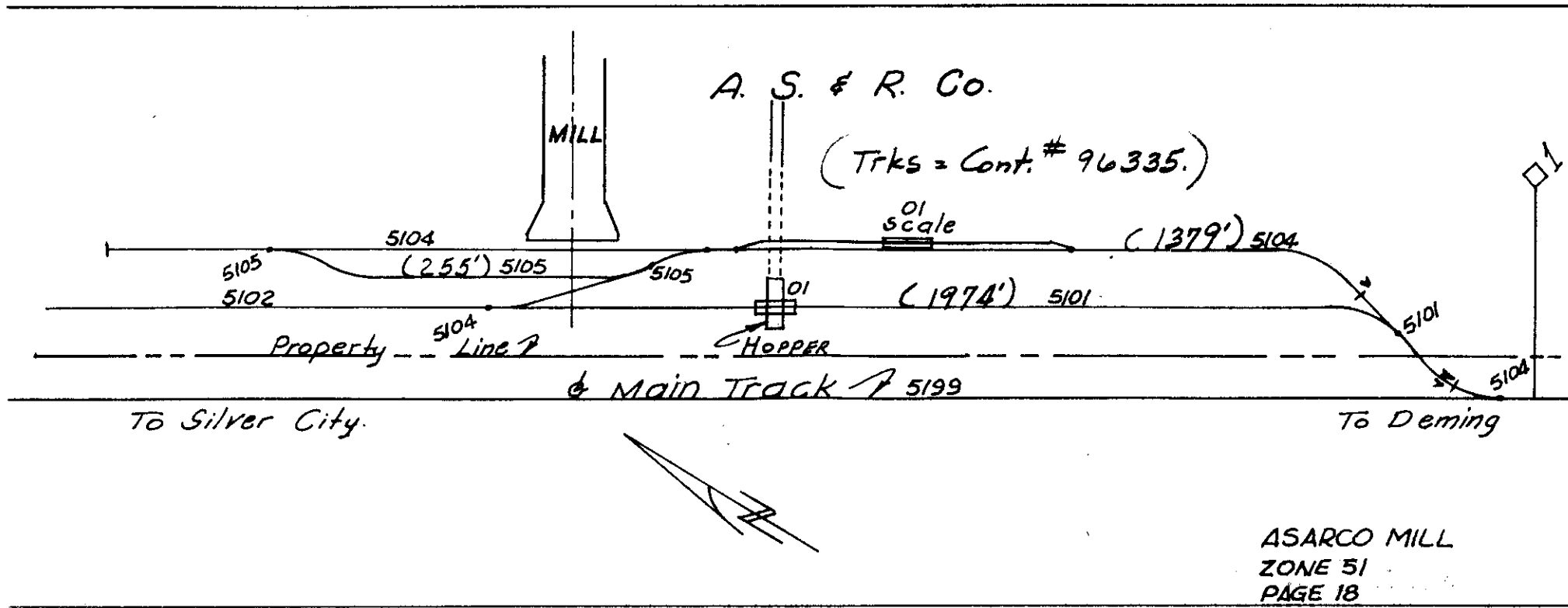

ZONE 51 (PERUHILL 4157) DEMING DISTRICT

519900 PERUHILL MAIN TRACK  
510800 PERUHILL SIDING (2119 FT)  
510900 PERUHILL BARITE OF AMERICA TRACK NO. 1 (1050 FT)  
511000 PERUHILL BARITE OF AMERICA TRACK NO. 2 (840 FT)

PAGE 19

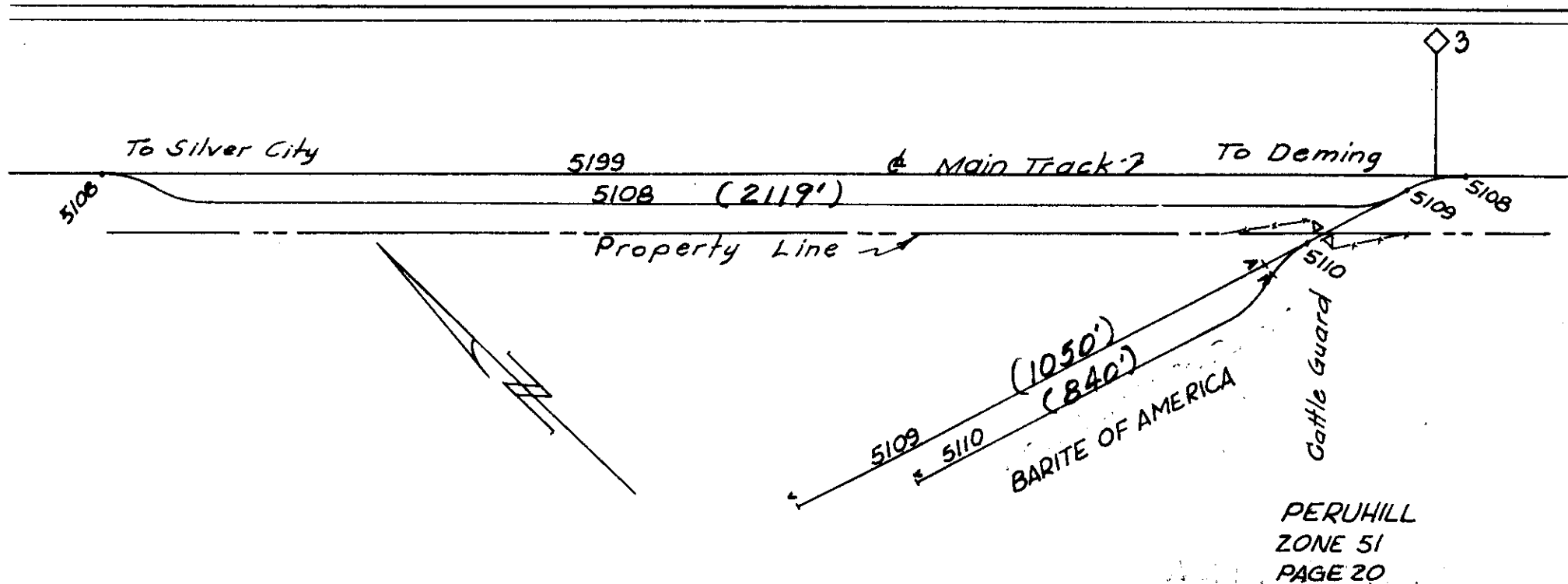



ZONE 51 (SPALDING 4171) DEMING DISTRICT

519900 SPALDING MAIN TRACK  
511200 SPALDING SIDING (2757 FT)

PAGE 21

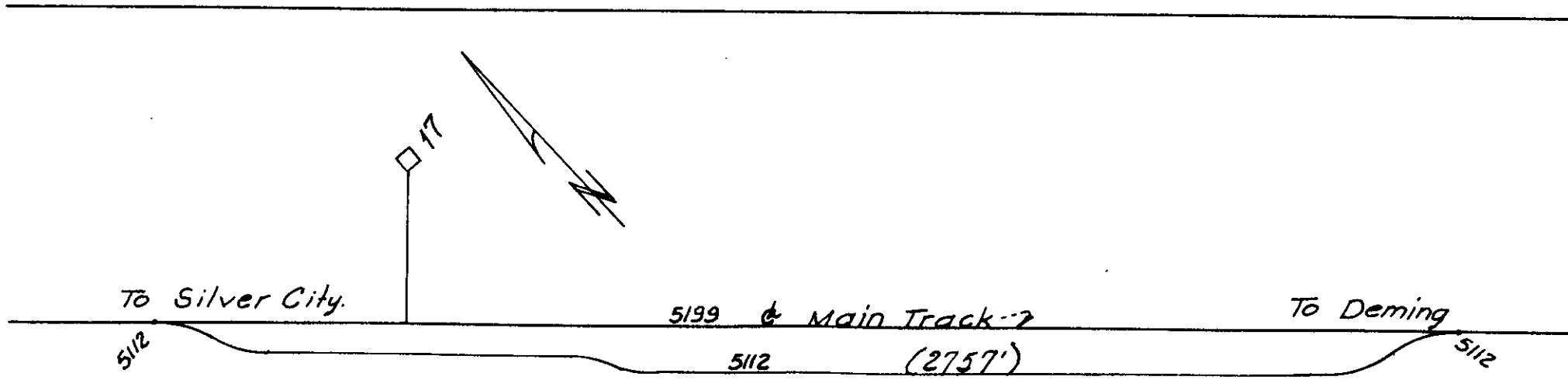

ZONE 51 (WHITEWATER 4185) DEMING DISTRICT

- 519900 WHITEWATER MAIN TRACK
- 511400 WHITEWATER SIDING (2654 FT)
- 511500 WHITEWATER HOUSE TRACK (2266 FT)
- 511600 WHITEWATER BACK TRACK (1451 FT)
- 511700 WHITEWATER EAST LEG WYE
- 511800 WHITEWATER WEST LEG WYE (619 FT)

PAGE 23

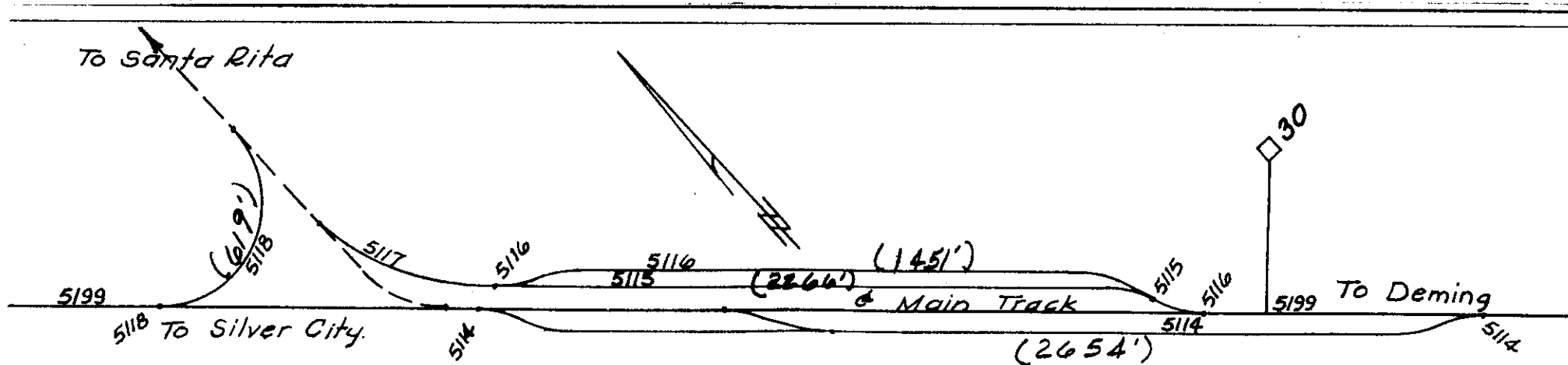

ZONE 51 < BURRO MT. JCT 7529 > DEMING DISTRICT

- 519900 BURRO MT. JCT MAIN TRACK
- 512100 BURRO MT. JCT EAST LEG WYE
- 512200 BURRO MT. JCT WEST LEG WYE (905 FT)
- 512300 BURRO MT. JCT PASSING TRACK (1248 FT)

PAGE 25

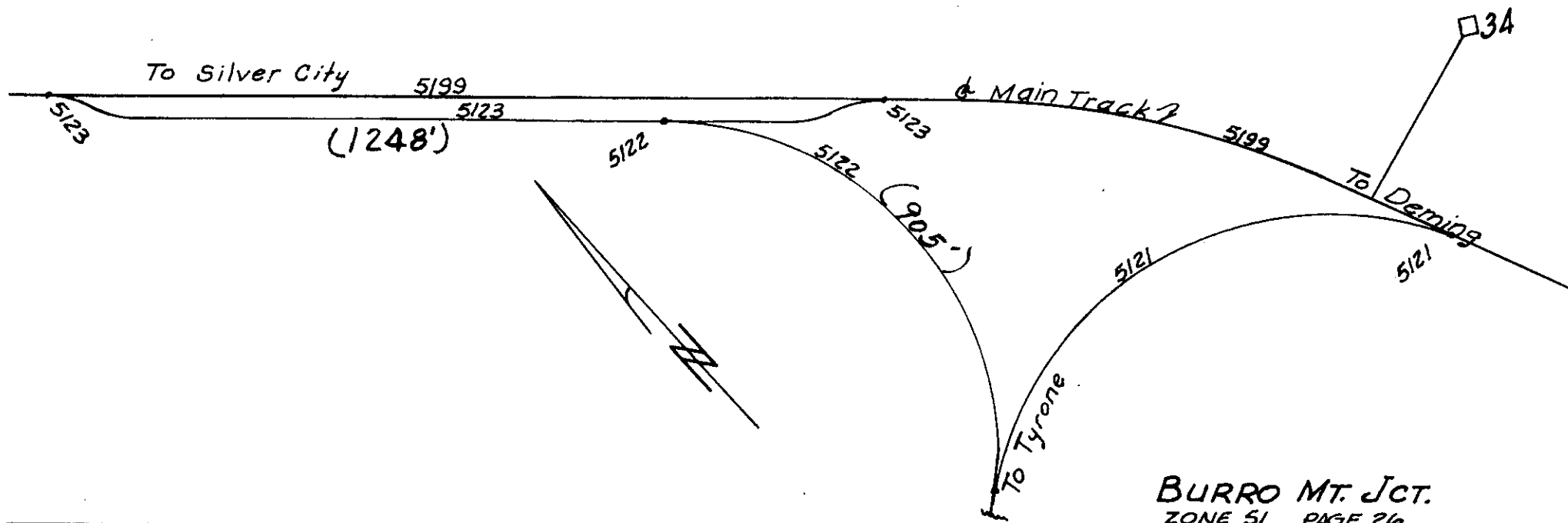

ZONE 51 (TYRONE INDUSTRIAL SPUR 7643) DEMING DISTRICT

- 519900 BURRO MT. JCT MAIN TRACK
- 512100 BURRO MT. JCT EAST LEG WYE
- 512200 BURRO MT. JCT WEST LEG WYE
- 512600 TYRONE INDUSTRIAL SPUR
- 512700 TYRONE HOLDING TRACK 1. (1133 FT)
- 512800 TYRONE HOLDING TRACK 2. (1356 FT)

PAGE 27

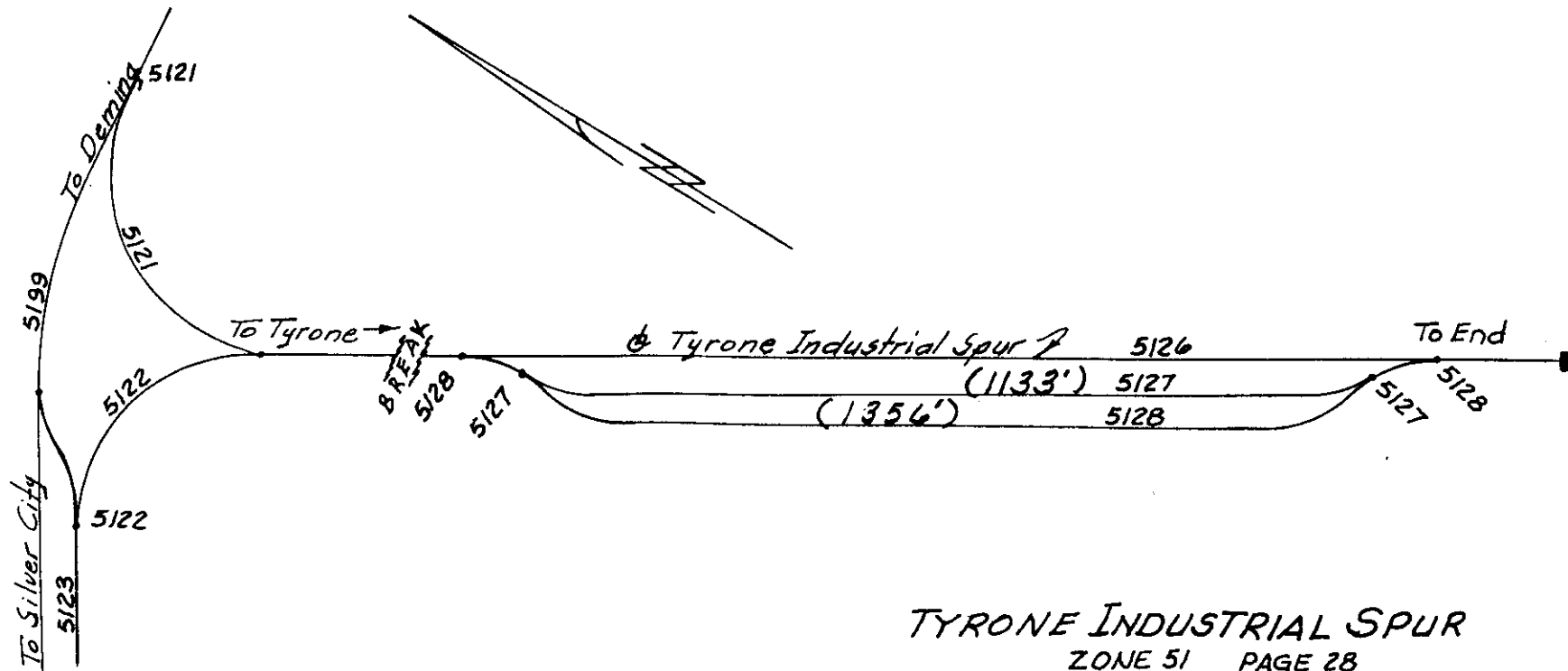

TYRONE INDUSTRIAL SPUR  
 ZONE 51 PAGE 28

ZONE 51 (SILVER CITY 7541) DEMING DISTRICT

519900	SILVER CITY MAIN TRACK	
513000	SILVER CITY COSLIN SPUR	
513100	SILVER CITY SHORT TRACK (352 FT)	
513200	SILVER CITY PASSING TRACK (1325 FT)	
513300	SILVER CITY LUCK SPUR	
01	SILVER CITY LUCK MINE LOADING RAMP	RAMP
513500	SILVER CITY ROUND HOUSE SPUR (220 FT)	
513600	SILVER CITY LEWIS WHSE LEAD (545 FT)	
513700	SILVER CITY A.M. LEWIS SPUR	
01	SILVER CITY A.M. LEWIS WHSE	DOOR
513800	SILVER CITY TEAM TRACK	
01	SILVER CITY TEAM TRACK PATRONS	OPEN

PAGE 29

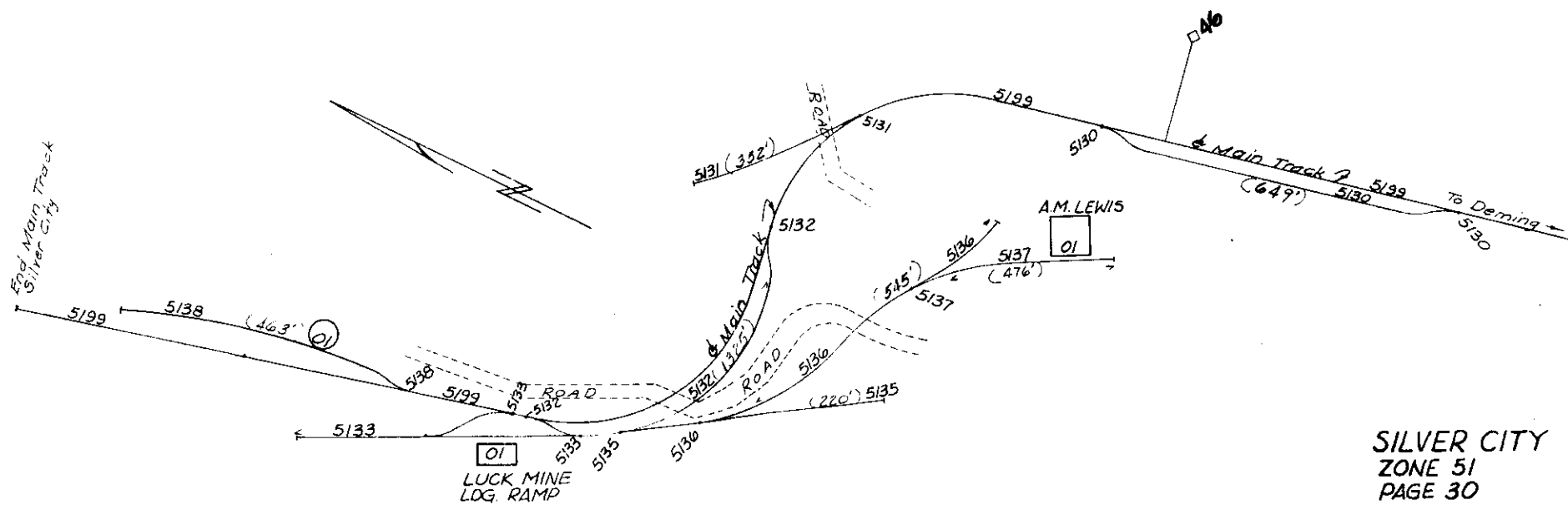

ZONE 52 (HURLEY 4194) SANTA RITA DISTRICT

- 529900 HURLEY MAIN TRACK
- 520400 HURLEY TRACK NO. 1 (1400 FT)
- 520200 HURLEY TRACK NO. 2 (900 FT)
- 520300 HURLEY TRACK NO. 3 (2380 FT)
- 520400 HURLEY TRACK NO. 4 (2078 FT)
- 520500 HURLEY TRACK NO. 5 (2078 FT)
- 520600 HURLEY HOUSE TRACK (465 FT)
- 520700 HURLEY WEST LEG WYE
- 520800 HURLEY ENGINE TRACK (202 FT)
- 520900 HURLEY SERVICE TRACK (280 FT)
- 521000 HURLEY LEAD TRACK (2090 FT)
- 521100 HURLEY RIP TRACK 1 (290 FT)
- 521200 HURLEY RIP TRACK 2 (219 FT)
- 521300 HURLEY RIP TRACK 3 (219 FT)
- 521500 HURLEY RIP TRACK 5 (838 FT)
- 521600 HURLEY NO. 36 TRACK (3417 FT)
- 521700 HURLEY NO. 37 TRACK (2281 FT)

PAGE 34

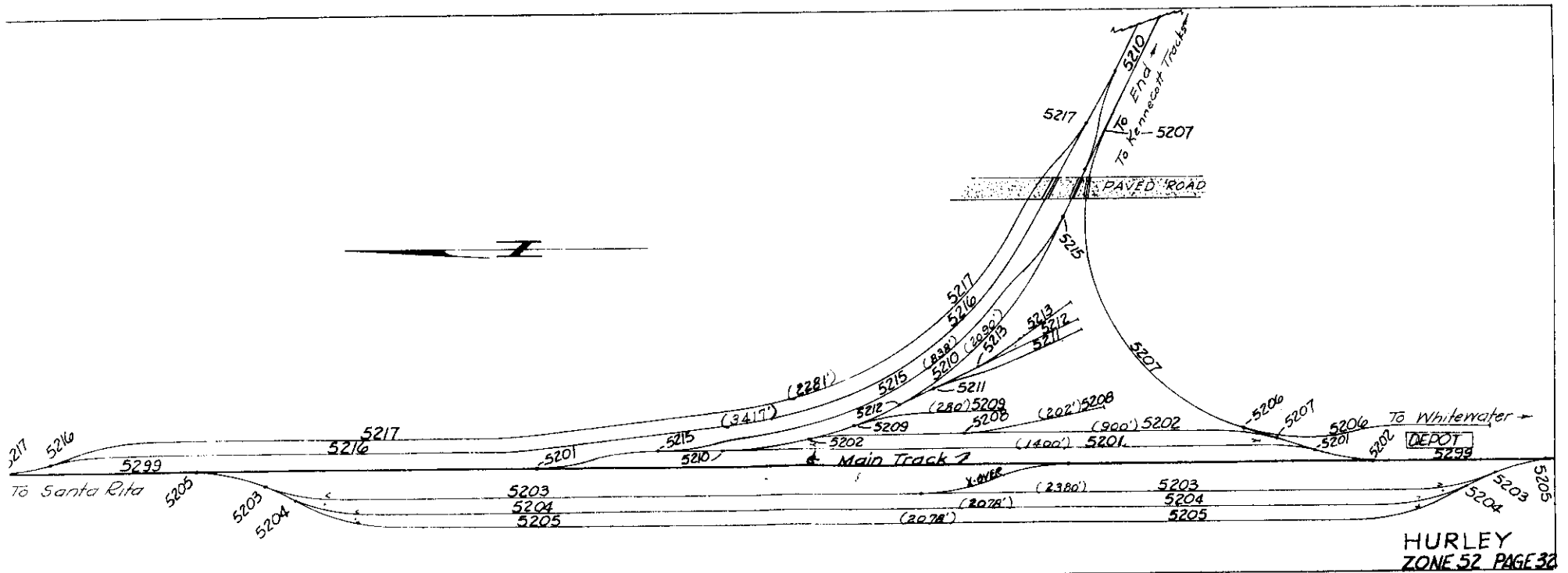

ZONE 51 (HURLEY 4194) SANTA RITA DISTRICT  
 (KENNECOTT AREA)

- 520700 HURLEY WEST LEG WYE (860 FT)
- 521000 KENNECOTT OUTSIDE LEAD TRACK (2100 FT)
- 521600 KENNECOTT INSIDE LEAD TRACK
- 521800 KENNECOTT INSIDE EMPTY TRACK (720 FT)
- 521900 KENNECOTT OUTSIDE EMPTY TRACK (780 FT)
- 522000 KENNECOTT FLUX TRACK LEAD (736 FT)
- 522100 KENNECOTT LEAD TRACK (550 FT)

PAGE 33

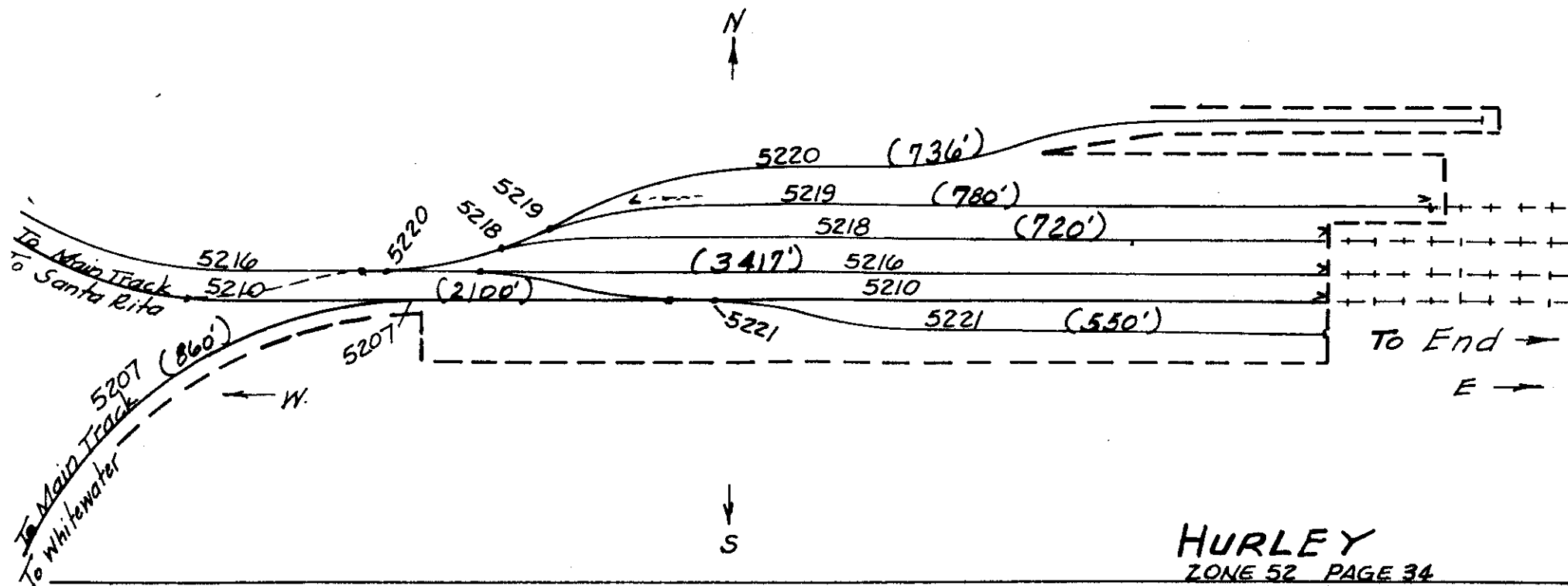

HURLEY  
 ZONE 52 PAGE 34

ZONE 52 (BAYARD 4197) SANTA RITA DISTRICT

529900 BAYARD MAIN TRACK  
522600 BAYARD PASSING TRACK (1516 FT)  
522700 BAYARD HOUSE TRACK (970 FT)  
01 BAYARD PORTER OIL CO DOOR

PAGE 35

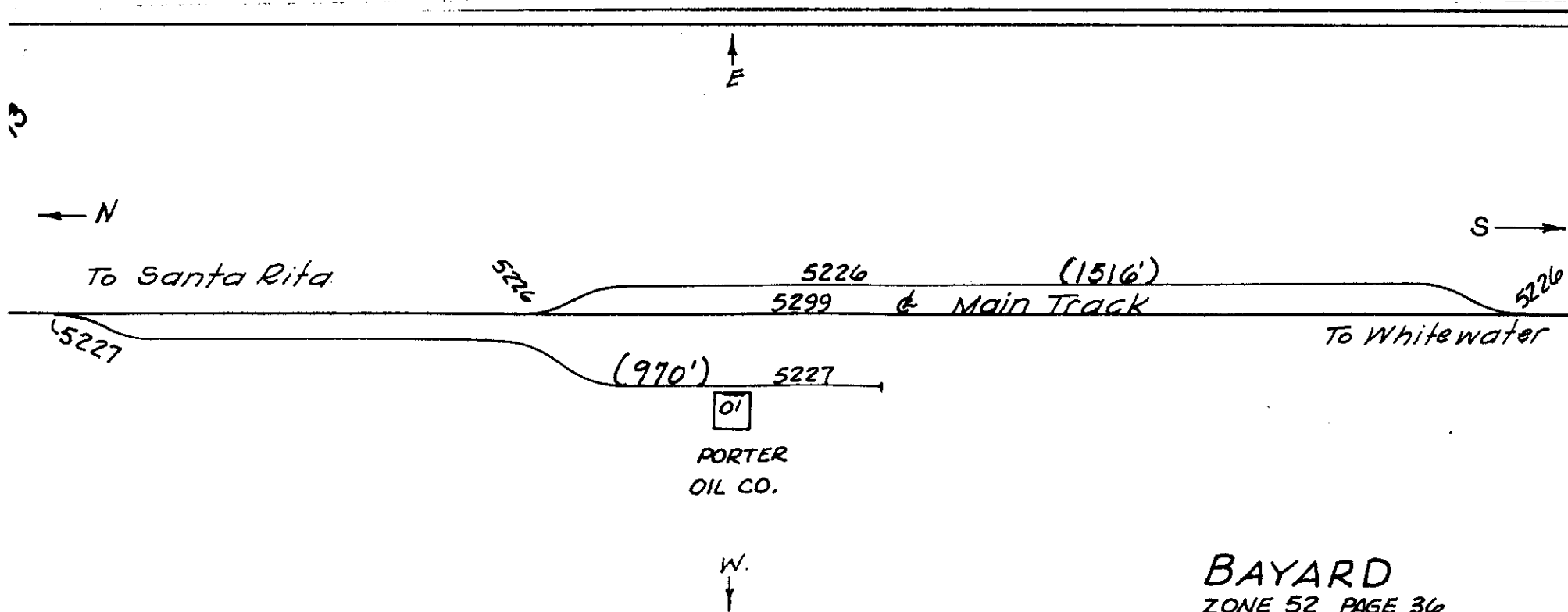



ZONE 52 (FIERRO INDUSTRIAL SPUR 7656) SANTA RITA DISTRICT

- 523100 FIERRO INDUSTRIAL SPUR
- 523200 FIERRO STORAGE TRACK (510 FT)
- 523300 FIERRO RUN-A-ROUND TRACK (1120 FT)
- 01 FIERRO EARTH DOCK DOCK

PAGE 37

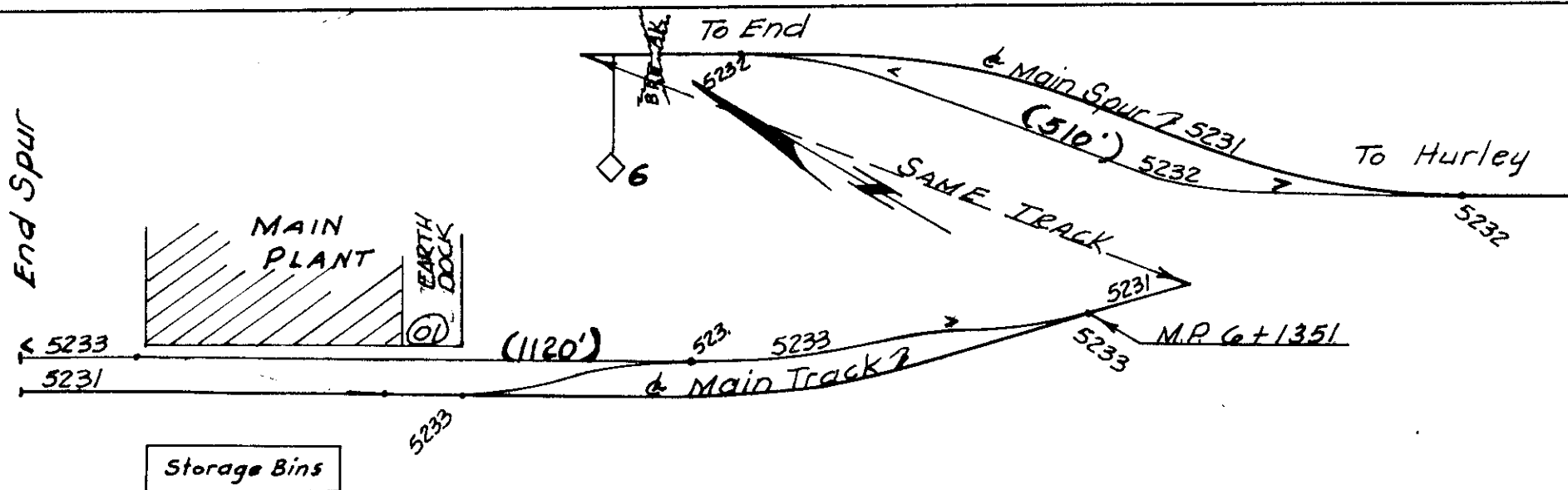

ZONE 52 (COBRE 4199) SANTA RITA DISTRICT  
(OLD HANOVER AREA)

529900 COBRE MAIN TRACK (FIERRO INDUSTRY SPUR)  
523600 COBRE PASSING TRACK (1547 FT)  
523700 COBRE HOUSE TRACK (422 FT)  
523800 COBRE TIPPLE SPUR

PAGE 39

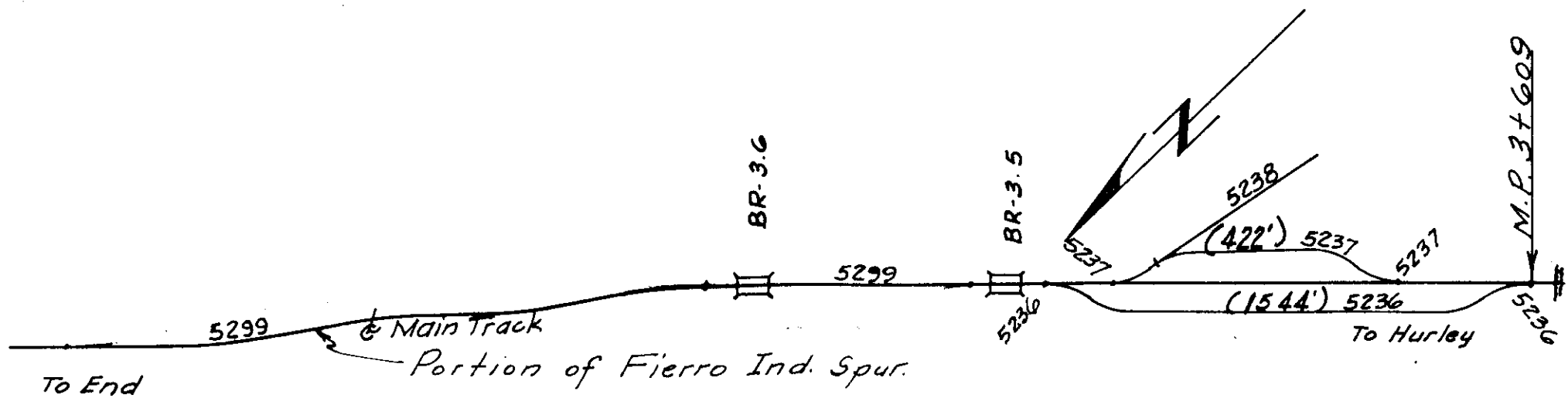

Part of ZONE 52  
COBRE PAGE 40  
(old Hanover.)

ZONE 52 (COBRE 4200) SANTA RITA DISTRICT

529900 COBRE MAIN TRACK  
 524000 COBRE (FIERRO SPUR)  
 524100 COBRE PASSING TRACK (1132 FT)  
 524200 COBRE TAIL TRACK (619 FT)  
 524400 COBRE BULL FROG TRACK (596 FT)

PAGE 41

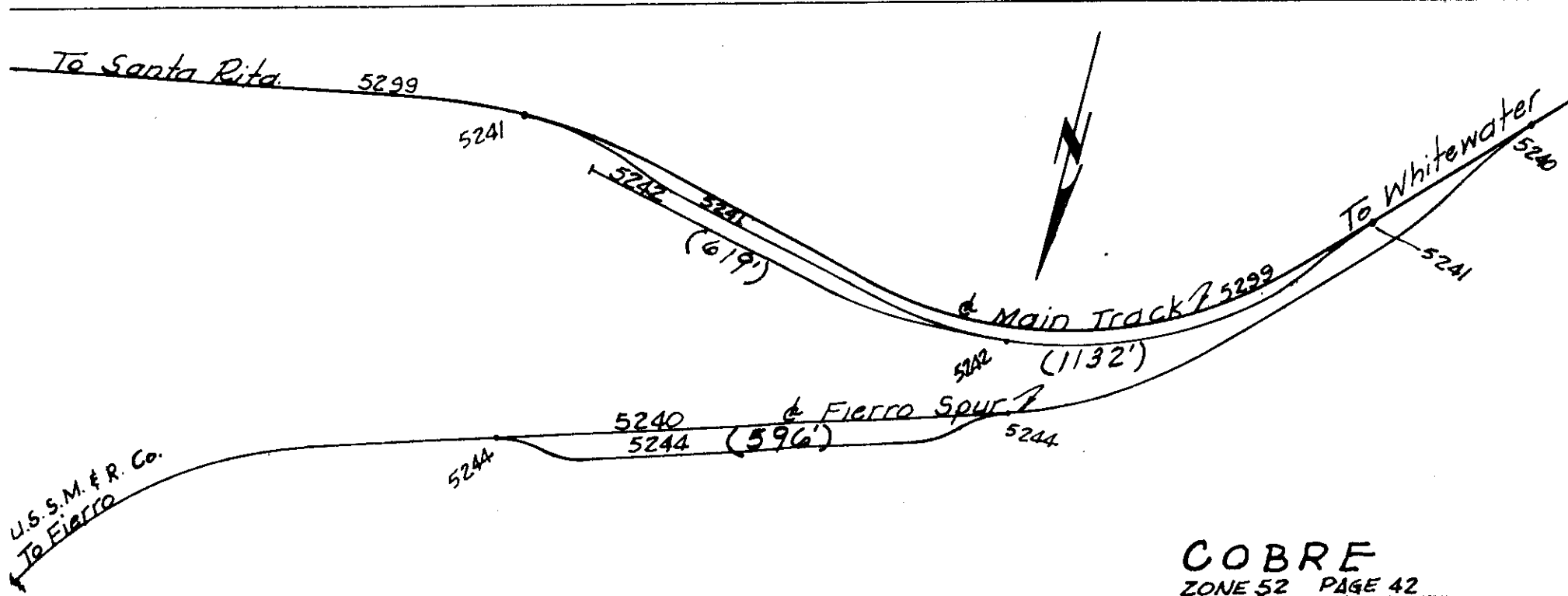

COBRE  
 ZONE 52 PAGE 42

ZONE 52 ( STAR SHAFT 4201) SANTA RITA DISTRICT

529900	STAR SHAFT MAIN TRACK	
524600	STAR SHAFT TRACK NO. 1	(783 FT)
524700	STAR SHAFT TRACK NO. 2	(1115 FT)
524800	STAR SHAFT MUD TRACK	(1087 FT)
524900	STAR SHAFT CAN TRACK	(1500 FT)

PAGE 43

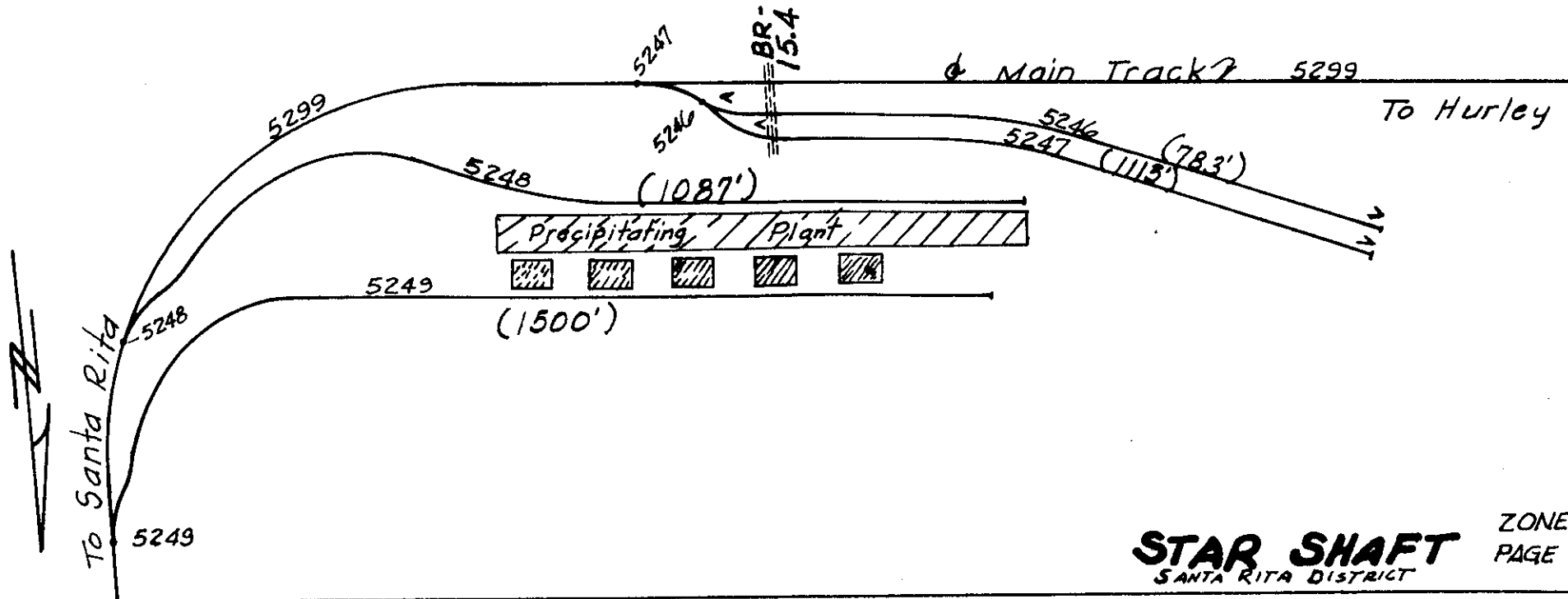

ZONE 52 (SANTA RITA 4202) SANTA RITA DISTRICT

529900	SANTA RITA MAIN TRACK
525000	SANTA RITA HOUSE TRACK (931 FT)
525100	SANTA RITA NO. 1 TRACK (675 FT)
525200	SANTA RITA NO. 2 TRACK (1100 FT)
525300	SANTA RITA NO. 3 TRACK (2278 FT)
525400	SANTA RITA NO. 4 TRACK (2395 FT)
525500	SANTA RITA NO. 5 ORE TRACK (INDUSTRY OWNED)
525600	SANTA RITA NO. 6 ORE TRACK (INDUSTRY OWNED)

PAGE 45

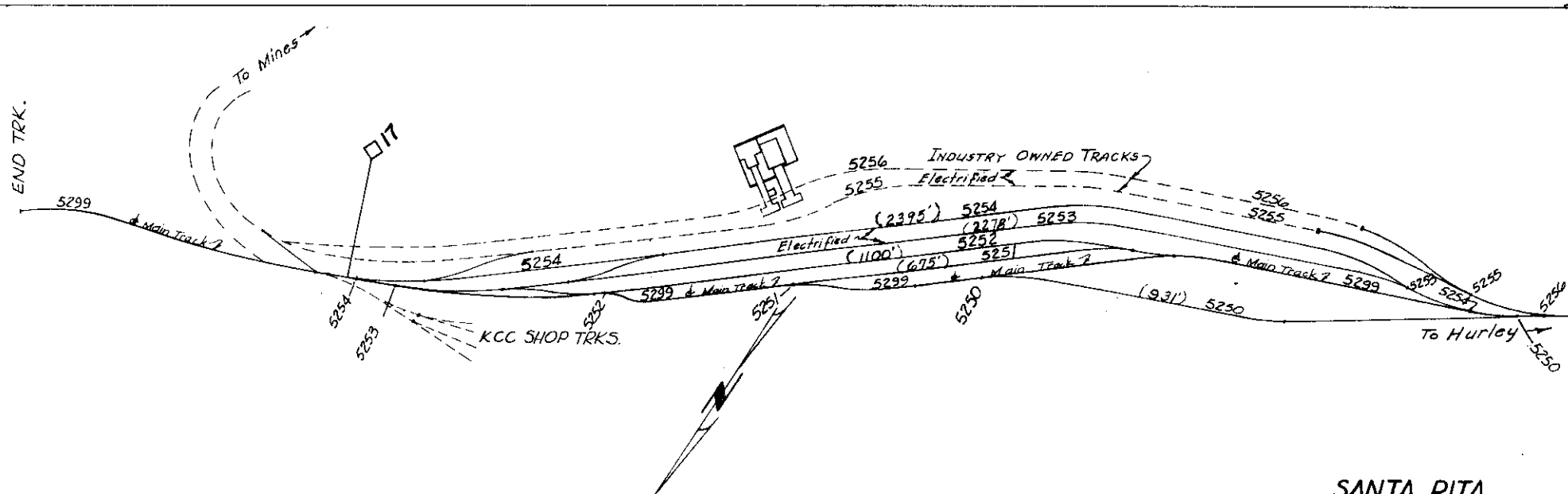

SANTA RITA  
 ZONE 52  
 PAGE 46

