

KEEP THE SAFETY HABIT



CAR LOCATION INVENTORY CONTROL

INSTRUCTIONS - MAPS
INDUSTRIAL ZONE, TRACK,
SPOT NUMBERS

ALBUQUERQUE

**NEW MEXICO DIVISION
NUMBER 3 ISSUE
APRIL 22, 1975**

Instructions set forth below govern the operation of Car Location Inventory Control (CLIC) throughout the terminal of Albuquerque. The terminal is divided into nine zones with each zone having designated tracks and/or industries within its boundaries. Tracks are assigned specific numbers within the zones and spots on the tracks are given individual numbers. By using zone, track and spot numbers, we are able to print switch list which will reflect the exact location to which a car should be spotted.

A CLIC Spot number will consist of six digits, the first two digits designate the zone to which the car is destined; the second two digits indicates the track number within the zone; the last two digits represent the actual spot along the track. Zone numbers will be preceded by a zero as there are less than ten zones.

EXAMPLE OF CLIC SPOT NUMBER

041227 American Furniture
| | |
| | | Spot Number
| | | Track Number
| | | Zone Number

All industries will be referred to by CLIC Spot Number rather than by name.

Switches have been painted with zone and track number shown on either target or stand. Spot numbers have been painted on doors, docks, bldgs., gates etc., where possible; otherwise, the proper spot can be determined by noting spot descriptions that are found just opposite zone maps on the following pages in this book.

These maps are not drawn to scale but merely serve as a guide in locating proper tracks or spots.

Instructions below specifically pertain to the physical switching, spotting and pulling of cars and are called particularly to the attention of all yardmen for their compliance:

THE YARDMASTER WILL HAVE COMPLETE CONTROL AND KNOWLEDGE OF ALL SWITCHING OF CARS.

SWITCHING IN TRAIN YARD

(1) All switching in train yard will be performed by use of a switch list unless otherwise instructed by yardmaster.

(2) Disposition of car will be shown on list by yardmaster just opposite car initial. This disposition will be indicated by means of track and/or spot number.

(3) Yardmaster will indicate on switch list at which end of yards switching is to be performed.

(4) Yardmaster will indicate on switch list where cuts, if any, are to be made, as follows:

1st. Cut _____
2nd. Cut _____
Etc.

(5) Engine Foreman will switch cars according to list marked by yardmaster. Should engine foreman switch or place car to some location other than that marked on list, or makes a cut different than marked \times by yardmaster, he must indicate so on switch list and advise yardmaster of this promptly.

(6) Engine Foreman will advise yardmaster of any car not shown on list and any disposition made of it.

(7) Engine Foreman must notify yardmaster of any exceptions taken to list such as no car, car not on list or car out of line.

(B)

(8) Yardmaster should be aware of all switching moves made in the yard and engine foreman must advise yardmaster of any extra moves.

SWITCHING AT INDUSTRIES

(1) All switching at industries will be performed by use of switch list unless otherwise instructed by yardmaster.

(2) Disposition to be made of car will be shown on list by yardmaster just opposite car initial. This disposition will be indicated by track and/or spot number.

(3) Engine Foreman will switch cars according to list marked by yardmaster. Should engine foreman switch or place car to some location other than that marked on list, he must indicate so on list and advise yardmaster of change.

(4) If car is not actually spotted but left on that industry's track, foreman will indicate "On Track Not Placed" in the following manner O T N P. If car is placed on some other track foreman will indicate on list "Not Placed left on Track (Number)" in the following manner N P Track Number. (Example: AT&F 620510 N P 0535.)

(5) Engine Foreman will advise yardmaster of disposition made of car or cars not shown on list.

(6) Engine Foreman must notify yardmaster of any exceptions taken to list, such as no car, car not on list, etc.

(7) If an industry request service not shown on foreman's list, engine foreman should obtain such request in writing and deliver to yardmaster after switching completed. If unable to obtain written request from industry, the foreman should record name of person requesting service on his switch list showing service requested and performed.

(C)

(8) If a car or cars other than ones ordered into industry by the yardmaster is spotted, engine foreman must indicate on switch list car number spotted and notify yardmaster of substitution.

(9) Engine Foreman will show on switch list time switching is completed at each industry.

(10) Yardmaster should be aware of all switching moves made at industries and engine foreman must advise yardmaster of any extra moves.

(11) After switching is completed engine foreman will indicate on switch list any work not completed, show time all switching on that list is completed, sign his name and return switch list to yardmaster.

For observation and guidance, the following codes may be shown on switch list preceding car initials:

B1 Bad Order
CL Condemned Car
CU Car Completely unloads
DN Dangerous
EP Empty to be placed, or placed for loading.
EX Explosive
HB Hold for billing.
HC Hold for charges or permit
HD Hold for disposition
HE Head end movement only
PU Car partially unloads
RE Rear end movement only
TU Turn car and respot
WH Weigh
XX Do not move this car.

Good communication is essential for a successful CLIC operation. The complete cooperation is solicited of every employee.

0101	Yard Track	1
0102	Yard Track	2
0103	Yard Track	3
0104	Yard Track	4
0105	Yard Track	5
0106	Yard Track	6
0107	Yard Track	7
0108	Yard Track	8
0109	Yard Track	9
0110	Yard Track	10
0111	Yard Track	11
0112	Yard Track	12
0113	Coen Rip	1
0114	Coen Rip	2
0115	Yard Track	13
0116	Coen Spur	
0117	Old Cab	
0125	Rail Yard East Track	
0126	Rail Yard West Track	

0130	Scale Track	
0151	01 Hydro Conduit	
0152	01 Hydro Conduit	
0152	02 Otto Spur Open Area	
0153	01 Linde Air South Spot	
0153	02 Linde Air Middle Spot	
0153	03 Linde Air North Spot	
0154	01 Albuquerque Waste Dock	
0154	02 Albuquerque Waste Gate	
0154	03 Maloof Recycling Plant	
0154	04 Faraone's Masonry Dock	
0154	05 Southwest Ceramics Open Area	
0154	06 Southwest Ceramics North Door	
0154	07 Cooks Bldg. Specialties So. Door	
0154	08 Burr Oil, Open Area North of Bldg.	
0154	09 Burr Oil, Door	
0198	Main Track	
0199	Main Old Main Track	

(1)

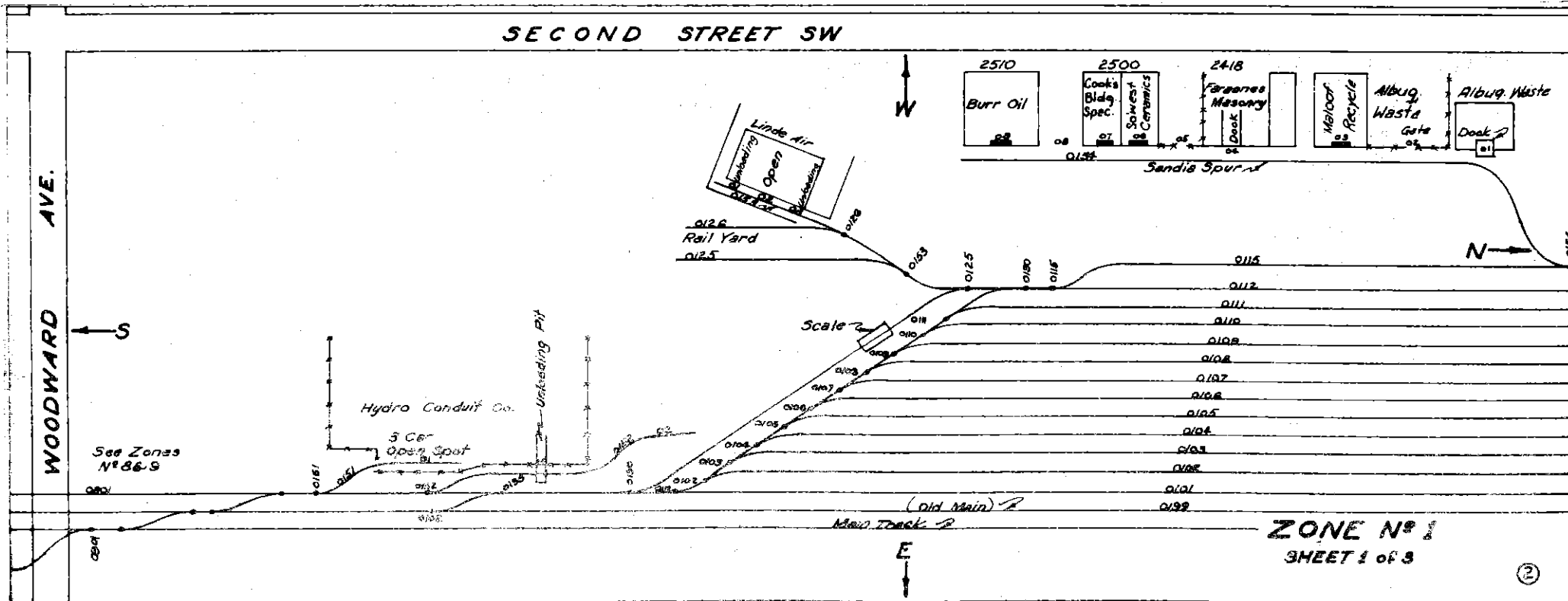

ZONE N° 1
SHEET 1 of 3

0101	Yard Track 1 (Middle)	0122	Shoo Fly	0162 01	Chevron Asphalt Nor spot
0102	Yard Track 2 (Middle)	0123	Dismantle Trk East Trk.	0162 02	Chevron Asphalt Tank Spot
0103	Yard Track 3	0124	Dismantle Trk West Trk.	0162 03	Chevron Asphalt Tank Spot
0104	Yard Track 4	0161 01	Open Area	0162 04	Chevron Asphalt Tank Spot
0105	Yard Track 5	0161 02	Open Area	0162 05	Chevron Asphalt So. Spot
0106	Yard Track 6	0161 03	Open Area	0162 99	Nu Mex Forms Dock
0107	Yard Track 7	0161 04	N.M. Beverage Door 4	0163 01	Rio Grand Conservancy
0108	Yard Track 8	0161 05	N.M. Beverage Door 5	0182 01	Allied Roofing No. Gate
0109	Yard Track 9	0161 06	N.M. Beverage Door 6	0182 02	Allied Roofing So. Gate
0110	Yard Track 10	0161 07	N.M. Beverage Door 7	0183 01	Sun Ray Paper Gate
0111	Yard Track 11	0161 08	N.M. Beverage Door 8	0183 02	Sun Ray Paper Warehouse
0112	Yard Track 12	0161 09	N.M. Beverage Door 9	0184 01	Quick Container
0113	Coen Rip 1	0161 10	N.M. Beverage Door 10	0184 02	United Grocers H&R Whse
0114	Coen Rip 2	0161 11	N.M. Beverage Door 11	0185 01	EverReady Oil No. Door
0115	Yard Track 13	0161 12	N.M. Beverage Door 12	0185 02	EverReady Oil Dock
0116	Coen Spur	0161 21	Conservancy Oil Spot 1	0185 03	EverReady Oil So Door
0117	Old Caboose Track	0161 22	Conservancy Oil Spot 2	0197	Eastbound Main
0118	Caboose Track	0161 23	Conservancy Oil Spot 3	0198	West Bound Main
0119	Old Lumber Track	0161 24	Conservancy Oil Spot 4	0199	Old Main Track
0120	Old Rail Saw 1	0161 25	Conservancy Oil Spot 5	0211	Lead to rip & storehouse
0121	Old Rail Saw 2	0161 26	Conservancy Oil Spot 6		

(3)

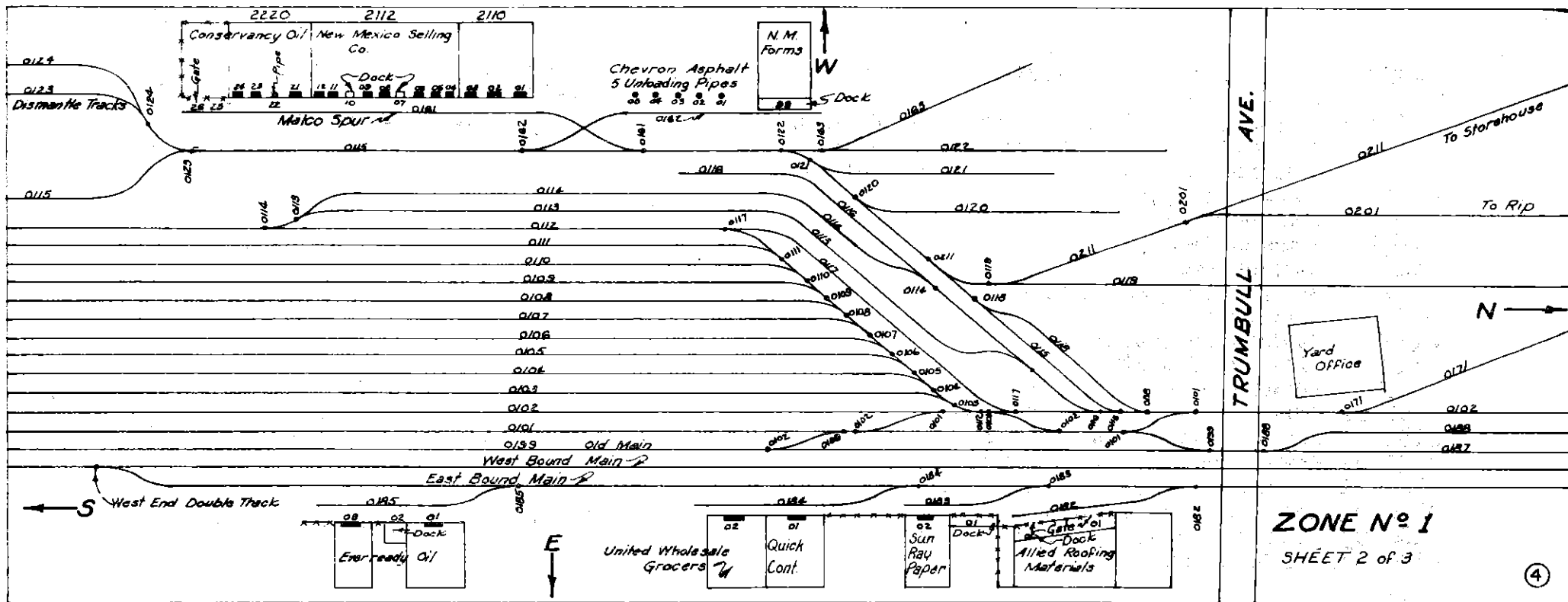

- 0102 Yard Track 2 (middle 2)
- 0171 Oak Spur
- 0172/05 Clover Club Steam Outlet Cooking Oil
- 0172 06 Peniwick & Ford Steam Outlet Syrup
- 0172 06 Standard Brands Steam Outlet Syrup
- 0172 Coal Storage
- 0173 Roundhouse 1
- 0174 Roundhouse 2
- 0175 Roundhouse 3
- 0176 Roundhouse Sand Track
- 0177 Roundhouse 4
- 0178 Roundhouse Stall 26
- 0179 Slipping Track
- 0180 Power House, West Track
- 0180 01 Power House, Tank Unloading
- 0181 Power House, East Track
- 0181 01 Power House Tank Unloading
- 0186 01 Welfare Dept., Dock No. Bldg.
- 0186 02 Welfare Dept., North Spot
- 0186 03 Welfare Dept., Middle Spot
- 0186 04 Welfare Dept., South Spot

- 0187 Old Main by Shops
- 0188 Middle One by Shops
- 0197 East Bound Main
- 0198 West Bound Main

(5)

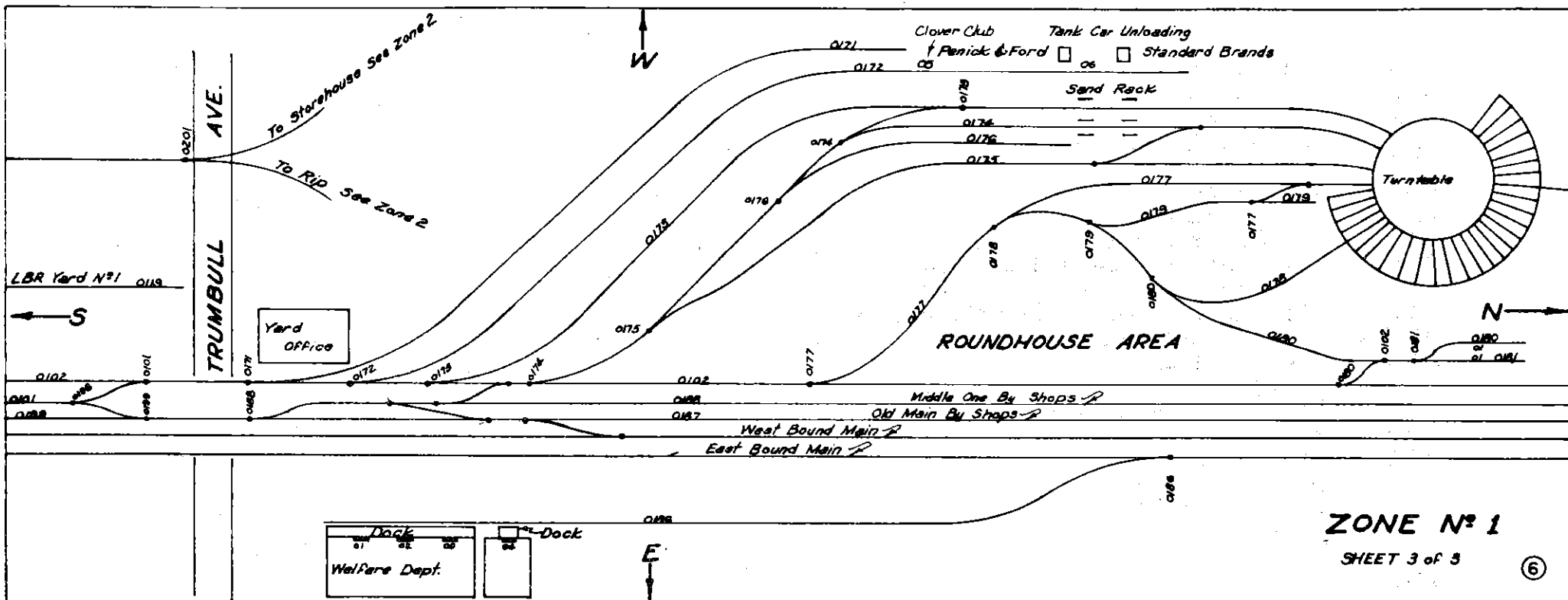

- 0201 Rip Track 1
- 0202 Rip Track 2
- 0203 Rip Track 3
- 0204 Rip Track 4 & 1/2
- 0205 Rip Track 5
- 0206 Rip Track 6 & 1/2
- 0207 Rip Track 7
- 0208 Rip Track 8 & 1/2
- 0209 DSK Track 9 Materials Dept.
- 0210 DSK Track 10 Materials Dept.
- 0210 10 DSK Diesel & Gaso Tank Unloading
- 0210 15 DSK Kerosene Tank Unldg.
- 0211 DSK Track 11
- 0221 Scrap Bin East Track
- 0222 Scrap Bin West Track
- 0231 Steel Shed Track 1
- 0232 Steel Shed Track 2
- 0233 Steel Shed Track 3
- 0234 Steel Shed Track 4
- 0235 Steel Shed Track 11, West Side of Bldg.

(7)

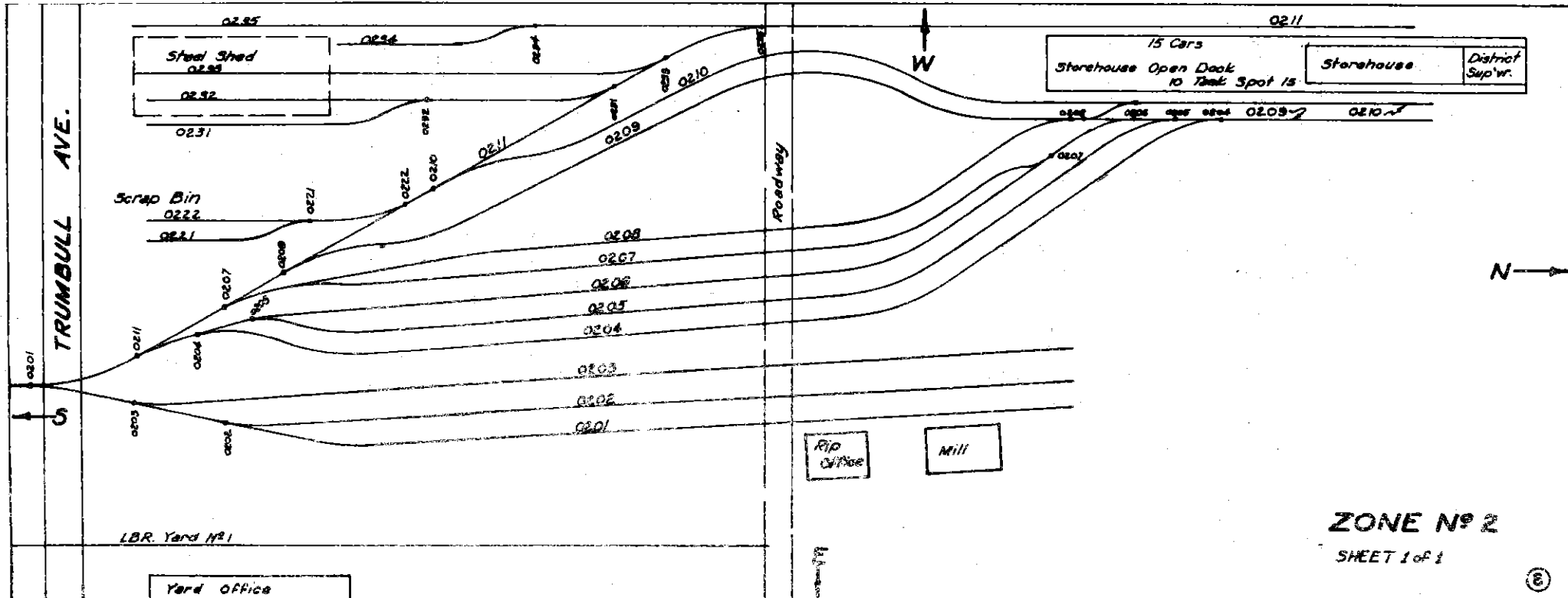

ZONE No 2

SHEET 1 of 1

(8)

0102 Yard Track 2 (Middle 2)
 0187 Old Main by Shop
 0188 Middle 2 by Shops
 0311 Lead to Long Team
 0311 01 Long Team Auto Unldg.
 0311 02 Long Team Auto Unloading
 0311 03 Bunhy Bread-Bakery Hopper Unldg.
 0311 04 Baldrige Lumber Open Spot
 0311 05 Baldrige Lumber Open Spot
 0311 98 Creamland Syrup Steam
 0311 98 Corn Sweetner Syrup Steam
 0312 Coal Ave. Team, Storage 1
 0313 Coal Ave. Team, Storage 2
 0314 C. W. E. Blacksmith Shops
 0315 Auto Dock, East Side
 0316 Auto Dock, Rankin Spur
 0317 Freight House, East Track
 0318 Freight House, West Track
 0319 C. W. E. Iron Track
 0320 Auto Dock, Short Team
 0321 Auto Dock, Middle Track

0321 Albuquerque Publishing Co.
 0322 C. W. E., Lead to
 0322 08 United Wholesale Liquor
 0323 01 Vacant
 0324 C. W. E. Sand Blast Track
 0325 C. W. E. Flue Rattler Track
 0326 C. W. E. Sheet Track
 0327 C. W. E. Short Track of 0326
 0328 C. W. E. Grand Canyon Track
 0329 C. W. E. Tank Shop Track
 0330 Welding Plant Track, Shop Extension
 0331 C. W. E. Canopy Track # 3
 0332 C. W. E. Canopy Track # 4
 0336 Yardmaster's Spur

(9)

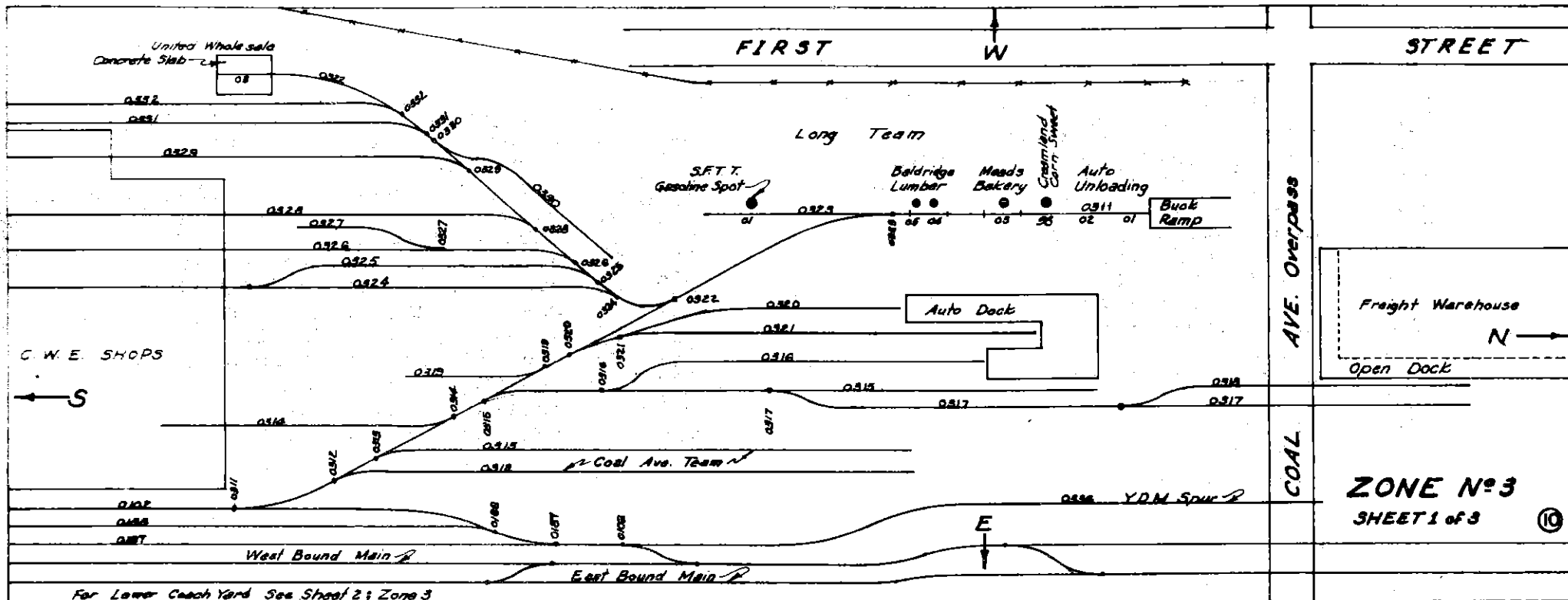

0351 Lower Coach Yard, Lead to
 0352 Long Wash, Lower Coach Yard
 0353 No. 9, Lower Coach Yard Pocket
 0360 Freight Run a round
 0361 Lower Coach Yard 1
 0362 Lower Coach Yard 2
 0363 Lower Coach Yard 3
 0364 Lower Coach Yard 4
 0365 Lower Coach Yard 5
 0366 Lower Coach Yard 6
 0367 Wheel Pit, Coach Yd.
 0368 Short Wash, Coach Yd.
 0369 Long Wash, Passenger Yd
 0370 01 Vacant
 0371 Old Foundry Spur
 0372 Old Mitchum Spur

0373 01 Albuquerque Gravel, Sand Unldg. Pit
 0373 02 Albuq. Gravel, Gate South End.
 0374 Fence Track
 0375 01 Albuq. Gravel, Door NE Bldg Warehouse.
 0375 02 Albuq. Gravel, Cement Unldg Pit
 0375 03 Albuq. Gravel, Gate
 0375 04 Albuq. Gravel, Door SE Bldg.
 0376 01 Diesel Spur, North Unldg Pipe
 0376 02 Diesel Spur, Unldg Pipe
 0376 03 Diesel Spur, Unldg Pipe
 0376 04 Diesel Spur, South Unldg Pipe
 0383 Passenger Yd. Track 3
 0384 Passenger Yd. Track 4
 0385 Passenger Yd. Track 5
 0386 Passenger Yd Track 6

(11)

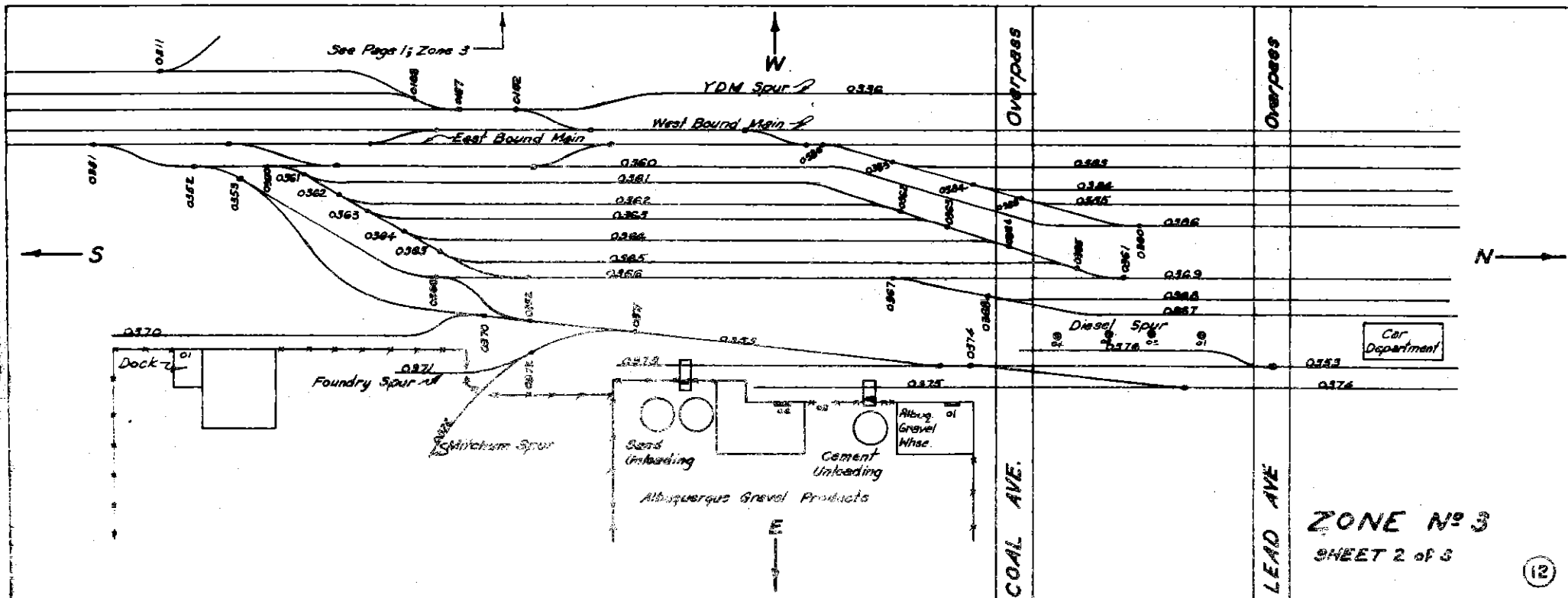

- 0367 Wheel Pit, Passenger Coach Yd.
- 0368 Short Wash, Passenger Coach Yd.
- 0369 Long Wash, Passenger Coach Yd.
- 0375 Albuq. Gravel Co.
- 0374 Fence Track
- 0376 Diesel Spur
- 0377 Gross Kelly Spur, Old
- 0378 01 Old Warehouse vacant
- 0383 Passenger Yard Track 3
- 0384 Passenger Yard Track 4
- 0385 Passenger Yard Track 5
- 0386 Passenger Yard Track 6
- 0397 East Bound Main
- 0398 West Bound Main

(13)

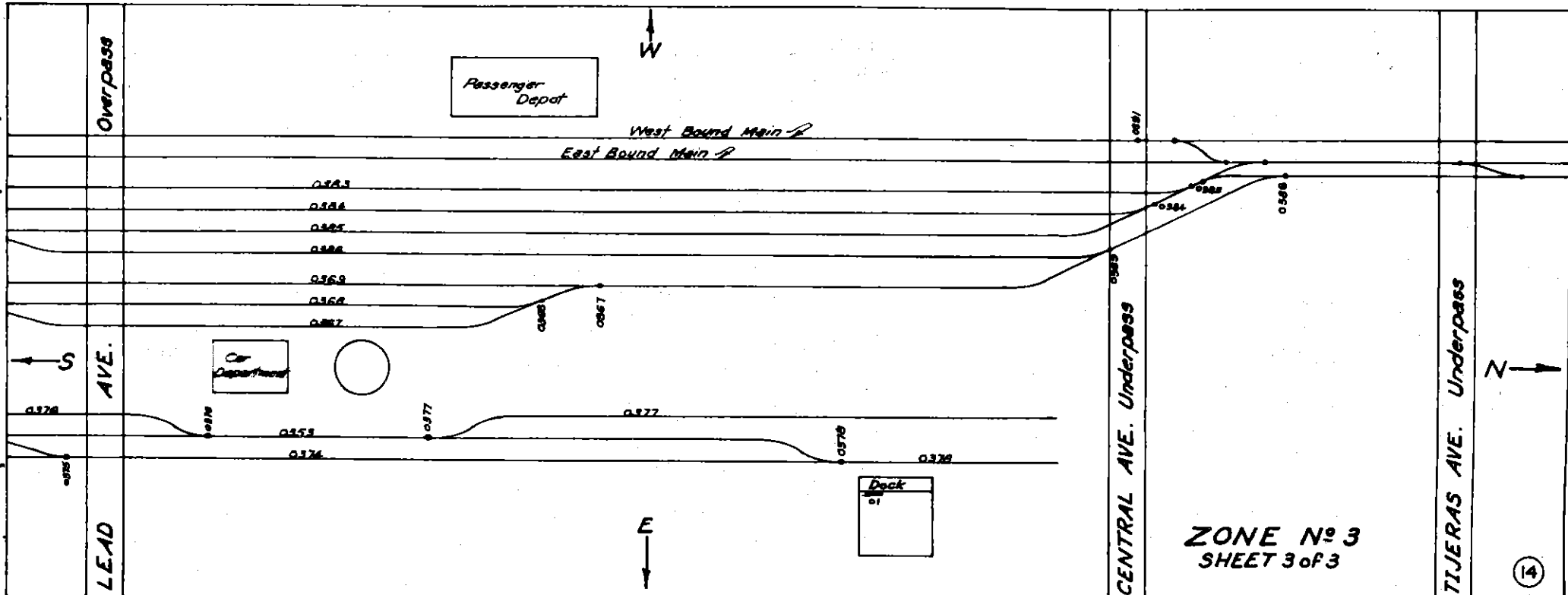

0401 Railway Ice, Spur
 0401 01 Railway Ice, Gate
 0401 02 Railway Ice, Open Dock
 0401 03 Railway Ice, South Door
 0401 04 Railway Ice, North Door
 0401 05 Dixon Paper, So. Door
 0401 06 Dixon Paper No. Door
 0401 07 Dixon Paper, Open Area North
 0401 08 N. M. Tire & Battery So. Dr.
 0401 09 N. M. Tire & Battery No. Dr.

0404 01 Dillard's, No. Door
 0404 02 Dillard's, Middle door
 0404 03 Dillard's, So. Door
 0404 04 Cox Hide, No. Door
 0404 05 Cox Hide
 0404 06 Cox Hide
 0404 07 Cox Hide
 0404 08 Mesa Metal, No. Door
 0404 09 Mesa Metal, So. Door
 0404 10 Crane Supply Fruit St.
 0404 11 Crane Supply, Door
 0404 12 Crane Supply, Gate
 0404 13 N.M. Produce Door
 0404 14 N.M. Produce Dock
 0404 15 N.M. Produce Roma Ave.
 0404 16 Wool Whse, Dock
 0404 17 Wool Whse, No. Door
 0404 18 Wool Whse, Door
 0404 19 Wool Whse, Door
 0404 20 Wool Whse, So Door
 0404 21 N.M. School Supply Dock

0404 22 N.M. Schl Sply
 0404 23 Ange Lbr. Dock
 0404 24 Cultured Marble
 0405 01 Maloof So. Door
 0405 02 Maloof No. Door
 0405 03 Ntnwide paper
 0405 04 Ntnwide paper

0488 Old Main by Ice House
 0497 East Bound Main
 0498 West Bound Main

0403 01 Springer Whse, Spot 1
 0403 02 Springer Whse, Spot 2
 0403 03 Springer Whse, Spot 3
 0403 04 Springer Whse, Spot 4
 0403 05 Morey Whse So. Dock Vacant
 0403 06 Morey Whse No Dock Vacant
 0403 07 Morey Whse Open Area
 0403 08 Open Area Vacant
 0403 09 Open Area Vacant
 0403 10 Open Area Vacant

(15))

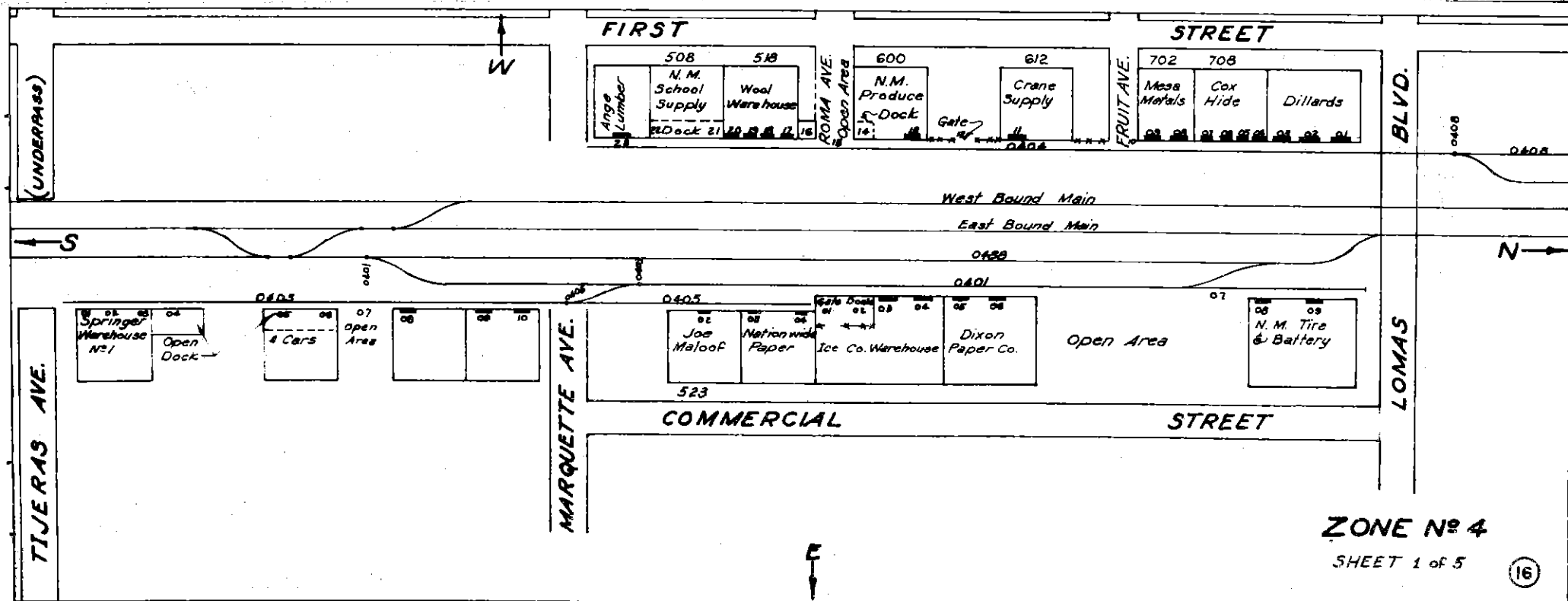

ZONE No 4

SHEET 1 of 5

(16)

0407 U. S. Post Office (Out of Service)

0408 01 Westinghouse, So. Door
0408 02 Westinghouse, Middle Door
0408 03 Westinghouse, North Door
0408 04 California Tire, Open Dock
0408 05 Slate Street, Open Area
0408 06 CBM Open Spot
0408 07 CBM Open Spot
0408 08 CBM Door
0408 09 CBM Door
0408 10 CBM Door
0408 11 CBM Door
0408 12 CBM Door
0409 01 Southwest Dist., Tank Unloading
0409 02 Southwest Dist., Open Spot
0409 03 Southwest Dist., Open Spot
0409 04 Southwest Dist., Open Spot
0410 01 Old Cox Iron Spur

0411 01 United Iron, Old Spur
0412 01 Cooks Sporting Goods So. Door
0412 02 Cooks Sporting Goods Door
0412 03 Cooks Sporting Goods No. Door
0412 04 Dow Supply, Door
0412 05 All Field Insulation, Door
0412 06 07 08 Out of Service
0412 09 Aztec Spur, Open Area
0412 10 Aztec Spur, Open Area
0412 11 M. & W. Sporting Goods Gate Spot
0412 12 Super Oil Co., Dock
0413 01 Old Wood Pecker Spur
0414 01 Eppsco Spur Open Spot
0414 02 Open Spot
0415 Lead to Springer Complex

0417 01 Out of Service
0419 Springer Complex

(17)

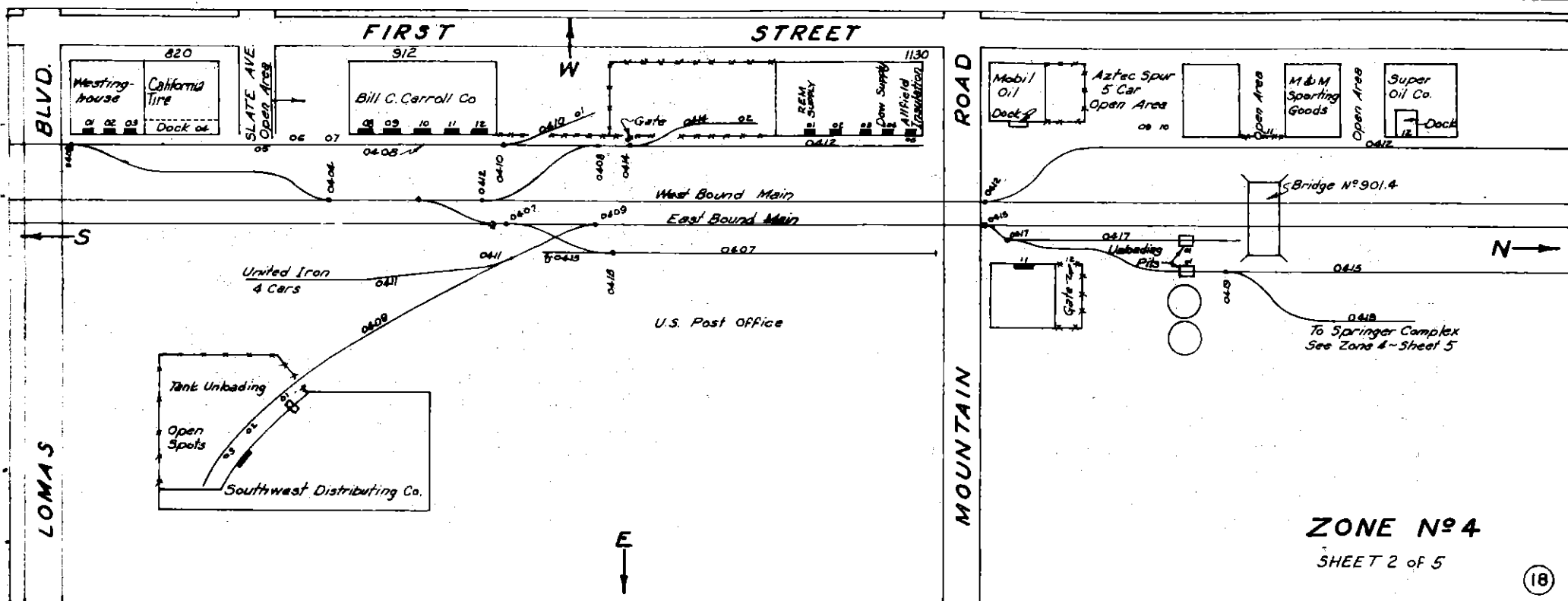

0412 12 Super Oil Co. Dock
 0412 13 Summer Street Open Spot
 0412 14 Vacant Old Pucci Dist Warehouse
 0412 15 Vacant
 0412 16 Vacant
 0412 17 Nationwide Paper, South Door
 0412 18 Nationwide Paper, North Door
 0412 19 American Furniture South Door 1
 0412 20 American Furniture Door 2
 0412 21 American Furniture Door 4
 0412 22 American Furniture Door
 0412 23 American Furniture Door
 0412 24 American Furniture Door
 0412 25 American Furniture Door
 0412 26 American Furniture Door
 0412 27 American Furniture Door
 0412 28 American Furniture Open Area
 0412 29 American Furniture Open Area
 0412 30 American Furniture Open Area
 0412 31 American Furniture Door

0412 32 American Furniture
 0420 Mountain Road Number 2 Track
 0422 Mountain Road Number 1 Track
 0430 01 Vacant Old Richard Dist Whse.
 0430 02 Vacant
 0431 01 Builders Material
 0431 02 Builders Material
 0431 03 Richard Dist. New Whse (Liquor)
 0431 04 Richard Dist. New Whse (Beer)
 0431 05 Richard Dist. New Whse (Keg Beer)
 0433 99 Hunter Lumber Dock
 0433 01 Board of Education Open Dock Spot 1
 0433 02 Board of Education Open Dock
 0433 04 McIntock Paper South Door
 0433 05 Albuq. Pub. Shcool Spot 2 at dock
 0433 06 Heath Furniture Spot 3 at Dock
 0497 East Bound Main
 0498 West Bound Main
 0501 Lead to Sawmill Area
 0502 Sutherland Lumber Co.

(19)

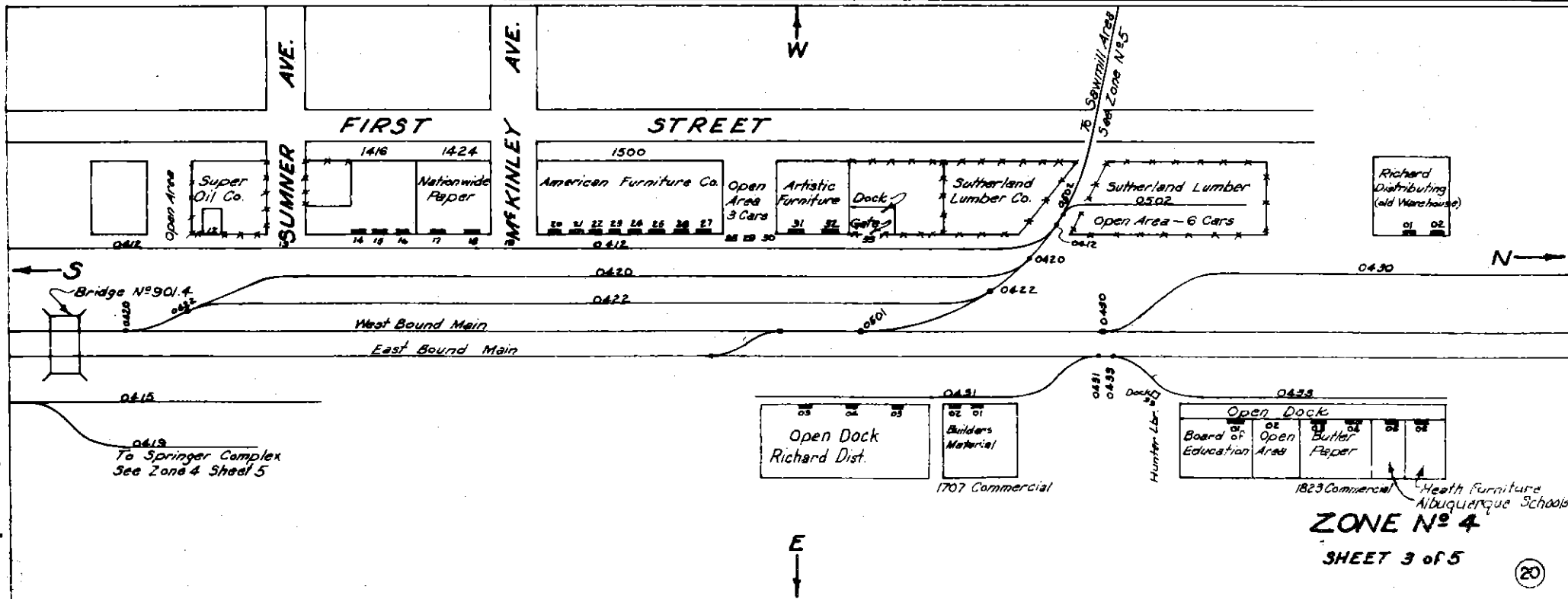

0430 01 Vacant Old Richard Dist Whse
 0430 02 Vacant
 0430 03 Street Open Spot
 0430 04 Summit Brick Open Dock
 0430 05 Vacant Old Richard Whse
 0430 06 Vacant " " " Dock
 0430 07 Gamble Rents
 0435 01 Thunderbird Steel, South Door
 0435 02 " " " North Door
 0435 03 " " " South Gate
 0435 04 Thunderbird Steel Middle Gate
 0435 05 " " " North Gate
 0435 06 " " " Open Spot North End.
 0436 Kohlhass Spur
 0436 01 Kohlhass Tank, Gate at Crane
 0436 02 Diamond Transfer, Gate
 0436 04 Duddy's Tire, South Door # 4
 0436 05 Duddy's Tire, North Door

0436 06 Duddy's Tire, Gate North Side
 0436 07 Hausman Corp. Open Spot
 0436 08 Hausman Corp Gate at Crane
 0436 09 Hausman Corp Gate
 0436 10 Jiffy Delivery
 0437 01 Commercial Whse. Open Dock North End.
 0437 02 " " Spot # 2
 0437 03 " " Spot # 3
 0437 04 " " Spot # 4
 0437 05 Commercial Whse Spot # 5
 0437 06 Commercial Whse Spot # 6
 0437 07 Commercial Whse Spot # 7
 0437 08 " " Spot # 8 South of bldg.
 0437 98 Diamond Transfer, Door North Bldg
 0437 99 Diamond Transfer, Open Dock
 0439 01 Open Area Between Bldgs
 0439 02 Masterweave Cpt. Door 2501 Commercial

(21)

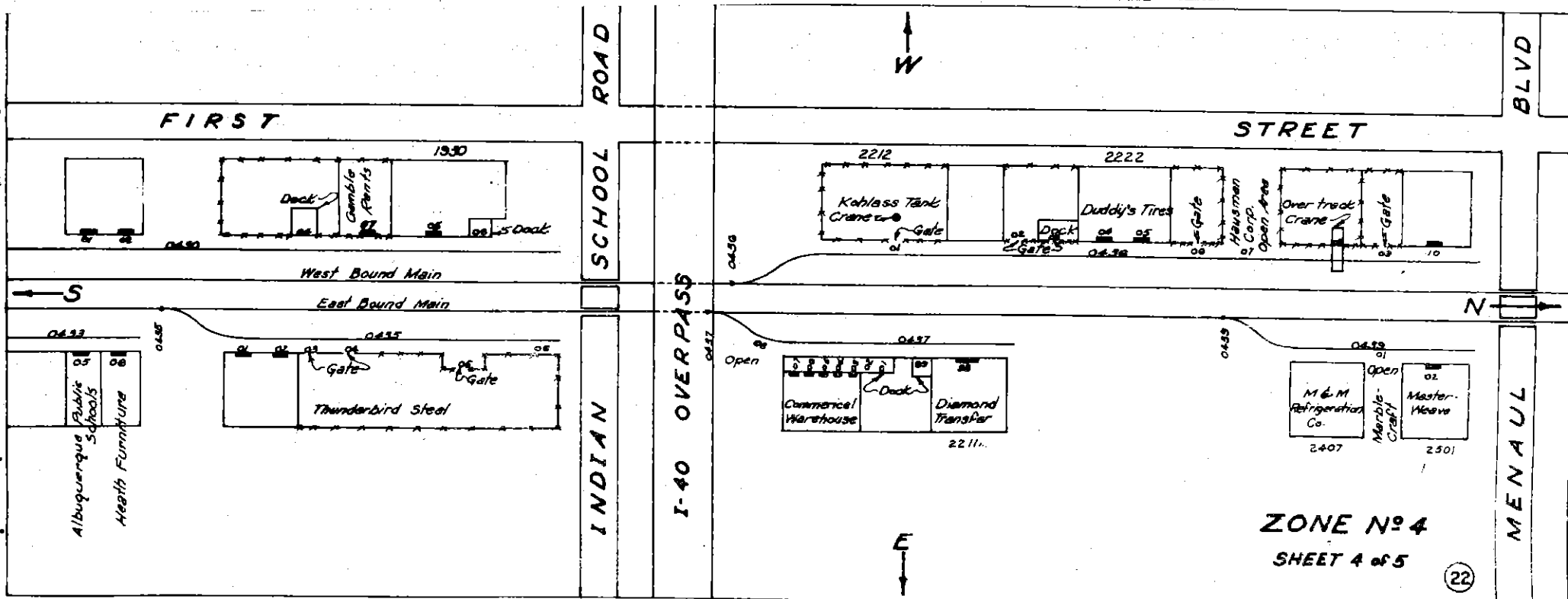

ZONE No 4

SHEET 4 of 5

22

0421 01 Springer Plant 2 Dock
 0423 01 Springer Warehouse 8 Door # 1
 0423 02 Springer Warehouse 8 Door # 2
 0423 03 Nobel Foods Whse. 8 Door # 3
 0423 04 Springer Warehouse 8 Door 4
 0423 05 Springer Warehouse 8 Door # 5
 0423 06 Shell Oil Co. Warehouse 8 Door # 6
 0423 07 Sunshine Biscuit Co. Whse 8 Door 7
 0423 08, 09, 10, 11, 12, 13, Open Track
 0425 01 Sears Roebuck Co. Door # 1
 0425 02 " " " " # 2
 0425 03 " " " " # 3
 0425 04 " " " " # 4
 0425 05 " " " " # 5
 0425 06 Tramwell Crow Whirlpool Door # 6
 0425 07 " " " " " # 7
 0425 08 " " " " " # 8
 0425 09 PBSW Paper Supply Door # 9
 0425 10 PBSW Paper Supply Door # 10

0427 01 Springer Warehouse 3 Door 1 S.W. Forest
 0427 02 Southwest Forest Industries Door # 2
 0427 03 Southwest Forest Industries Door # 3
 0427 04 Southwest Forest Industries Door # 4
 0427 05 Montgomery Ward Warehouse 3 Door # 5
 0427 06 Ponca Wholesale Door # 6
 0427 07 Ward Terry Whse 3 Door # 7
 0427 08 " " " 3 " # 8
 0427 09 Wicker Inc. Whse. 3 Door # 9
 0429 01 Sun City 2 Whse. 2 Spot # 1
 0429 02 " " 2 " 2 " # 2
 0429 03 " " 2 " 2 " # 3
 0429 04 " " 2 " 2 " # 4
 0429 05 " " 2 " 2 " # 5
 0429 06 " " 2 " 2 " # 6
 0429 07 " " 2 " 2 " # 7
 0429 08 J. C. Penney Whse 2 Spot # 8
 0429 09 " " " " 2 " # 9
 0415 Lead to Warehouse # 2
 0419 Lead to Warehouse # 1 # 8 and # 3

(23)

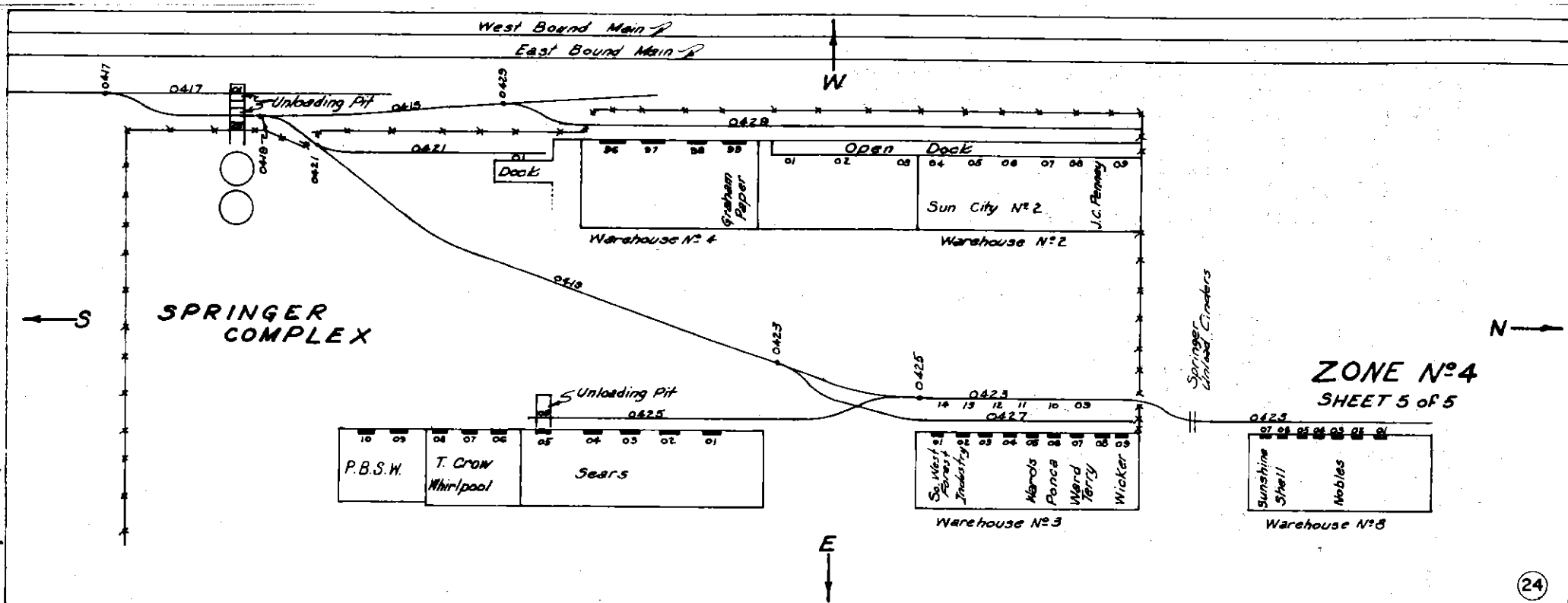

- 0501 Saw Mill Lead
- 0502 01 Sutherland Lumber Co. North Tra ck
- 0503 01 Sutherland Lumber Co. South Track
- 0504 01 T & P Pipe Open Area
- 0505 01 Gillette Tire Door
- 0506 01 Ralston Oil Co. East Door
- 0506 02 Ralston Oil Co. West Door
- 0507 01 Valley Gold Dairy East Door
- 0507 02 " " " ~~WEST~~ Door
- 0507 03 " " " Door
- 0507 04 " " " West Door
- 0508 01 Bell Tire Co. Dock
- 0508 02 Rust Tractor, Gate
- 0508 03 Rust Tractor, Door
- 0510 Santa Fe Builders Spur
- 0511 01 Rust Tractor Open Spot
- 0511 02 Rust Tractor Open Spot
- 0511 03 Rust Tractor Open Dock
- 0511 04 Bell Tire, West Door
- 0511 05 Bell Tire Door
- 0511 06 Bell Tire, Gate East End

(25)

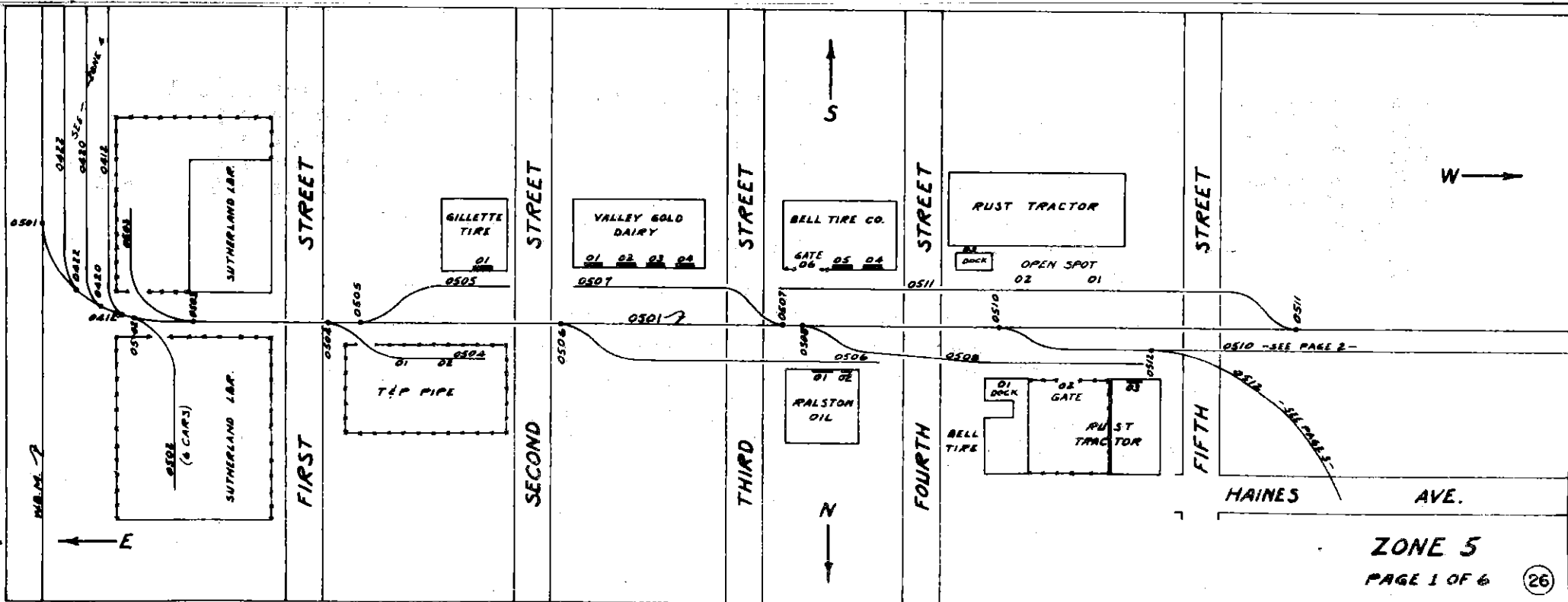

0510 01 Wilger Tire East Door
 0510 02 Architectural Systems, East Door
 0510 03 Aardal Distr. Middle Door
 0510 04 Aardal Distr. West Door
 0510 05 Sanbusco, East Door # 1
 0510 06 " Middle Door # 2
 0510 07 " West Door # 3
 0510 08 " East Gate # 4
 0510 09 " Middle Gate # 5
 0510 10 " West Gate # 6 at Dock
 0513 01 N. M. Tank & Culvert, Open Spot
 0513 02 N. M. Tank & Culvert, Open Spot
 0513 03 Lembke Const. West Gate
 0513 04 Lembke Const. Door
 0513 05 Lembke Const. East Gate

0515 01 Commercial Warehouse # 2 East Door 1
 0515 02 " " " # 2 Door # 2
 0515 03 " " " # 2 Door # 3
 0515 04 " " " # 2 Door # 4
 0515 05 " " " # 2 Door # 5 at Dock
 0516 05 National Transfer Dock
 0516 06 " " "
 0516 07 " " "
 0516 04 " " "
 0517 01 Norva Corp. (Big O) Door
 0517 02 Vacant Warehouse
 0517 03 " "
 0517 04 " "
 0517 05 " ""
 0517 06 " "

(27)

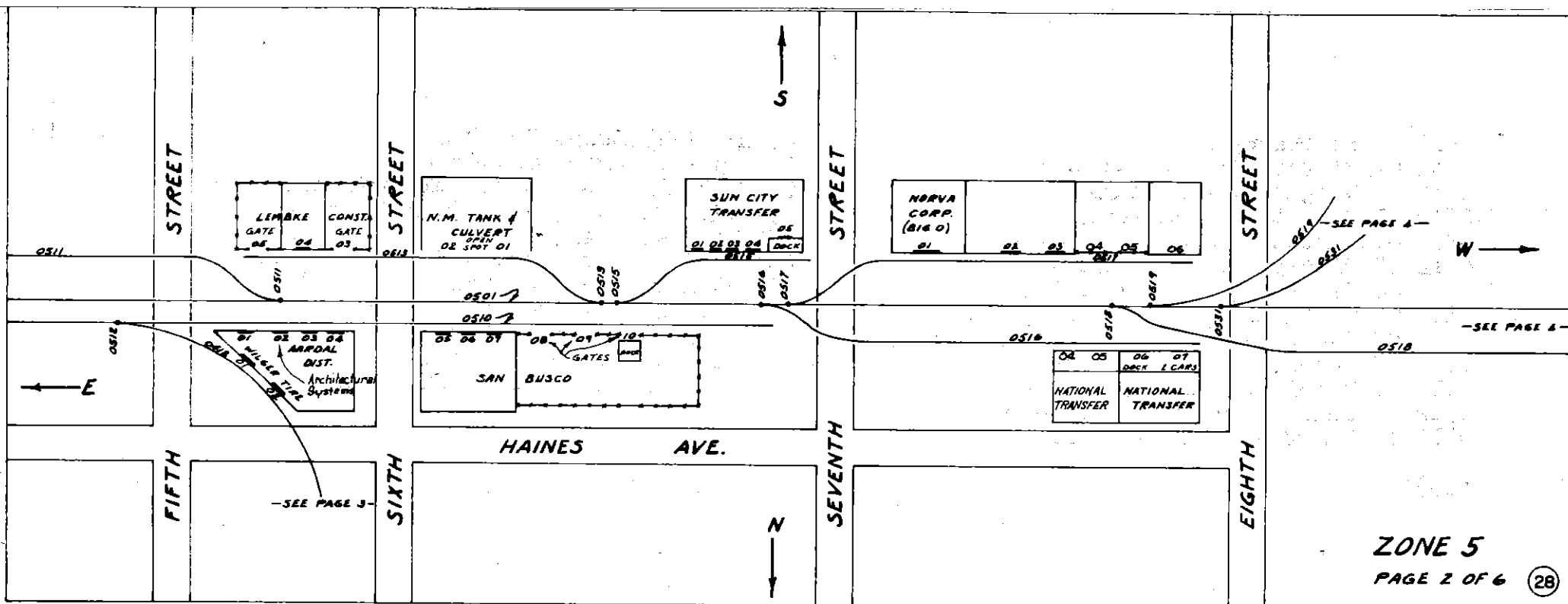

- 0512 Slaton Spur
- 0512 01 Wilger Tire, South Door
- 0512 02 Wilger Tire, North Door
- 0512 03 Desert Industries, Dock
- 0512 04 Sanbusco Open Spot at Gate
- 0512 05 Pittsburgh Plate Glass, Crane
- 0512 06 Pittsburgh Plate Glass, Door
- 0512 07 Pittsburgh Plate Glass, Door
- 0512 08 Sanbusco Open Spot Gate & Door
- 0512 09 Cunningham Dist. East Door
- 0512 10 Cunningham Dist. Middle Door
- 0512 11 Cunningham Dist West Door
- 0512 12 M & W Appliances Door

- 0512 13 Burns Co. Door
- 0512 14 Burns Co. Door
- 0512 15 Albuquerque Chemical East Door
- 0512 16 Albuquerque Chemical West Door
- 0512 98 Albuquerque Chemical Gate
- 0512 99 Albuquerque Chemical Gate
- 0512 17 American Excelsor
- 0512 18 American Excelsor
- 0512 19 National Biscuit Co.
- 0512 20 National Biscuit Co.
- 0512 21 National Biscuit Co.

(29)

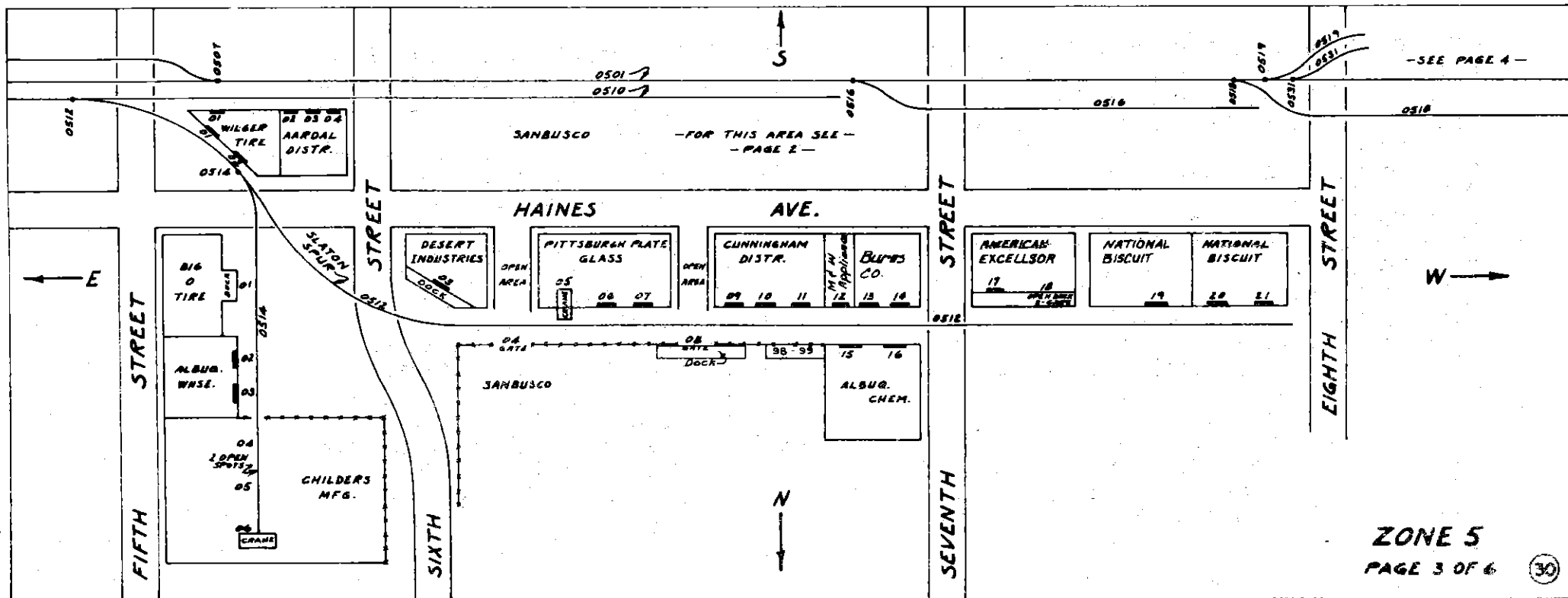

0518 01 Bureau of Indian Affairs, Dock
 0518 02 G. S. A. Open Area East End
 0518 03 G. S. A. Open Area East End
 0518 04 G. S. A. Open Dock East End
 0518 05 G. S. A. Open Dock by Door # 9
 0518 06 G. S. A. Open Dock
 0518 07 G. S. A. Open Dock by Door # 7
 0518 08 G. S. A. Open Dock
 0518 09 G. S. A. Open Dock by Door # 5
 0518 10 G. S. A. Open Dock
 0518 11 G. S. A. Open Dock by Door # 3
 0518 12 G. S. A. Open Dock by Door # 1
 0519 01 Sawmill Pocket Track O'Malley Lumber
 0521 01 Gate City Steel Open Area
 0521 02 Gate City Steel Open Area
 0521 03 Gate City Steel inside Bldg.
 0521 04 Gate City Steel Open Area
 0523 01 Nat'l Transfer (Oakley) North Door
 0523 02 Nat'l Transfer (Oakley) Middle Door
 0523 03 Nat'l Transfer (Oakley) South Door

0525 01 Universal Carloading Door
 0525 02 Universal Carloading Dock
 0527 01 Gorman Appliance North Open Dock
 0527 02 Gorman Appliance South Open Dock
 0527 02 House of Carpet South Open Dock
 0531 01 Zork Hardware, Open Area
 0531 02 Zork Hardware, Door
 0531 03 Zork Hardware, Door
 0531 04 Zork Hardware, Door
 0533 01 O'Malley Glass Door
 0533 02 O'Malley Glass, Crane
 0535 Sawmill Run-a-round
 0537 01 Acme Fast Frt. East Door
 0537 02 Acme Fast Frt. Middle Door
 0537 03 Acme Fast Frt. West Door
 0537 04 Acme Fast Frt. West Door
 0539 Lead to N.M. Co. East Warehouse
 0541 Lead to Laun-Dry Supply
 0549 N.M. Cold Storage
 0551 Duke City Lumber Co.

(31)

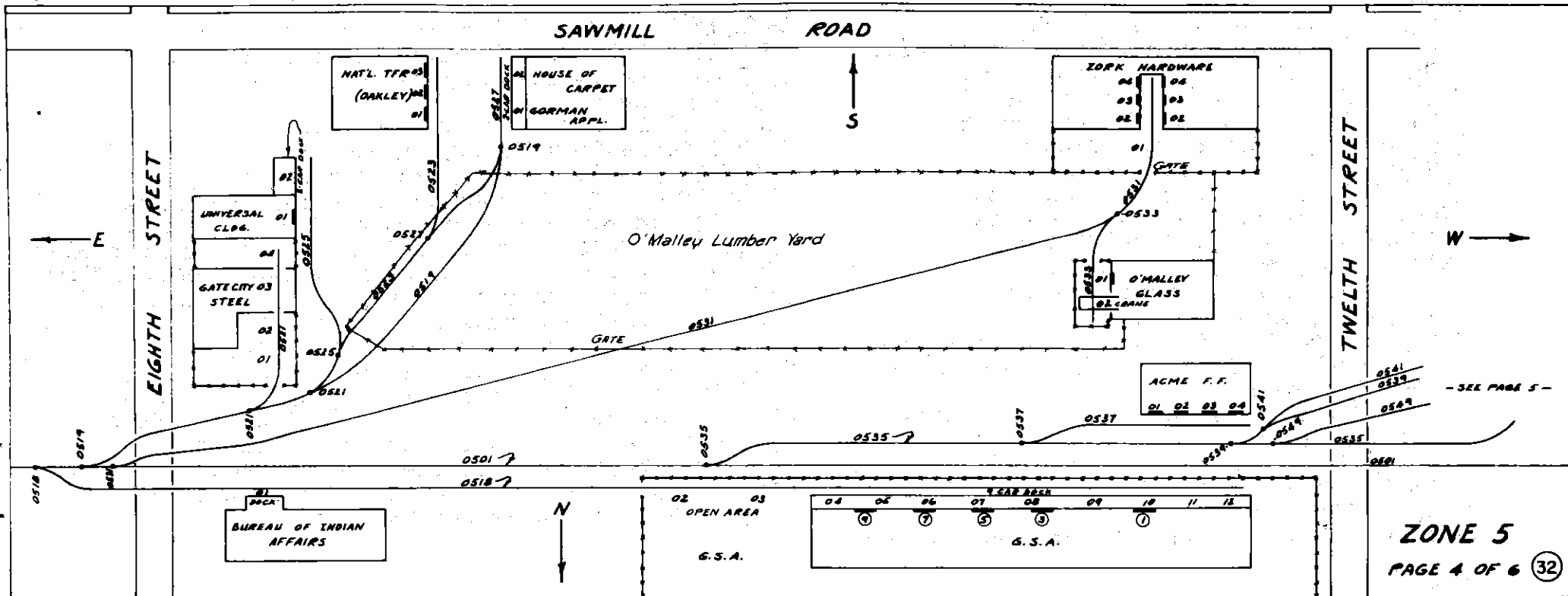

0539 N. M. Co. East Track
 0539 01 N.M. Co. East Track North Door 1
 0539 02 N.M. Co. East Track Door 2
 0539 03 N.M. Co. East Track Door 3
 0539 04 N.M. Co. East Track Door 4
 0539 05 N.M. Co. East Track Door 5
 0539 06 N.M. Co. East Track Door
 0539 07 N.M. Co. East Track Door
 0541 01 Laundry Supply, Op en Dock
 0541 02 A. Mathias, North Door
 0541 03 A. Mathias, Middle Door
 0541 04 A. Mathias, South Door
 0541 45 A. Mathias, Open Dock
 0541 05 Hale Sanitary Supply, North Door
 0541 06 Hale Sanitary Supply, South Door
 0543 01 Through
 0543 07 N.M.Grocery Co Open Dock 7 cars
 0545 01 Through
 0545 05 Kimbell 5 cars inside
 0549 01-02-03 N.M. Cold Storage 3 doors
 0551 Through
 0551 13 Duke City Lbr New Horn Open Area

0551 15 Duke City Lbr Bldg Spot Open Area
 0551 06 Duke City Lbr Mldg Spot Open Area
 0553 01 Duke City Mldg Whse. North Door 1
 0553 02 Duke City Mldg Whse Door # 2
 0553 03 Duke City Mldg Whse Door # 3
 0553 04 Duke City Mldg Whse Door # 4
 0553 05 Duke City Mldg Whse Door # 5
 0555 01 Ponderosa Products Dock Inside Bldg.
 0555 02 Ponderosa Products Dock Inside Bldg.
 0555 03 Ponderosa Products Dock Outside South Side
 0557 01 New Track to Blueher Lbr. Open Area 2 Cars
 0559 01 Forest Products Open Spot Ldg. East End
 0559 02 Forest Products Open Spot Ldg.
 0559 03 Forest Products Open Spot Ldg.
 0559 04 Forest Products Open Spot Ldg.
 0559 06 Forest Products Sawdust Ldg East Spot
 0559 07 Forest Products Sawdust Ldg West Spot
 0559 08 Forest Products Open Spot Unldg.
 0559 09 Forest Products Open Spot Unldg.
 0560 Public Svc NM. Short Track inside
 0562 01 Public Svc Prager Station

(33)

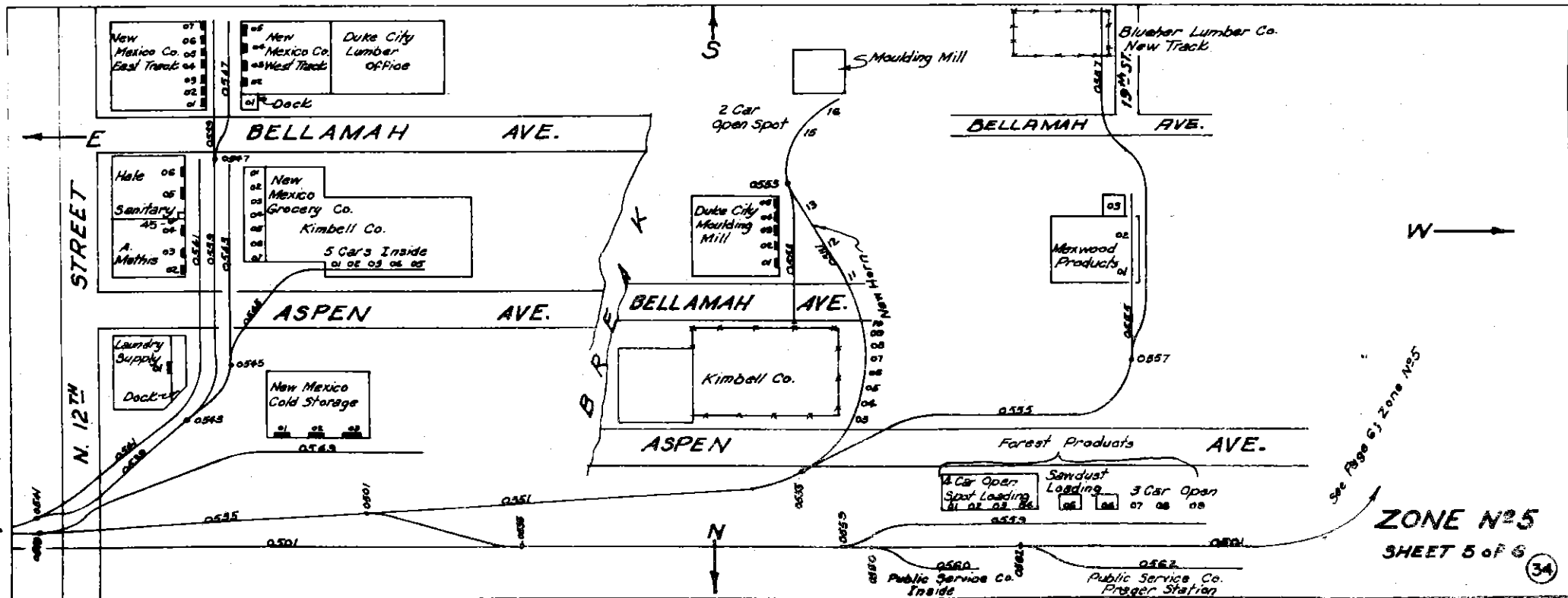

0563 01 Duke City Trk 45-1 thru 5.
 0564 01 Run-a-Rount Track Open
 0564 11 Paxton Lbr Open Spt Gate
 0565 01 Geo. Pacific Open Spot
 0565 02 Geo. Pacific Open Spot
 0565 03 Through North to South
 0565 08 Geo Pacific Spot at Dock
 0565 09 Thru (North to South)
 0565 12 Geo Pacific Open Spot
 0567 01 Geo Pac Open Spot
 0567 Open Area Through
 0569 98 Paxton Lbr Open Spot
 0569 99 Paxton Lbr Open Spot
 0569 01 Paxton Lbr East Door 1
 0569 02 Paxton Lbr Door 2
 0569 03 Paxton Lbr Door 3
 0569 04 Paxton Lbr Door 4
 0571 01 Paint Pot Tank Unldg
 0573 01 Paint Pot North Door
 0573 02 Paint Pot South Door
 0575 01 02 Geo Pac Open Area Short Track

0577 01 Keebler Co. North Door
 0577 02 Keebler Co. South Door
 0585 01-02-03 Mtn Sta tes Insulation
 0585 04-05 United Parcel
 0586 01 Wm. Volker Door
 0588 01 Swift Co. East Door # 1
 0588 02 Swift Co. Door 2
 0588 03 Swift Co. Door 3
 0588 04 Swift Co. West Door # 4
 0588 05 Wm. Volker Co. West Door
 0588 06 Wm. Volker Co. West Door
 0589 03 State Dist. Co. East Door 3
 0589 04 State Dist. Co. Door 4
 0589 05 State Dist Co. Door 5
 0589 06 State Dist. Co. Door 6

Tracks 0579 spiked. 581 and 0583 dis mantled
 Blueher Warehouse torn down and business moved
 to 0557

(35)

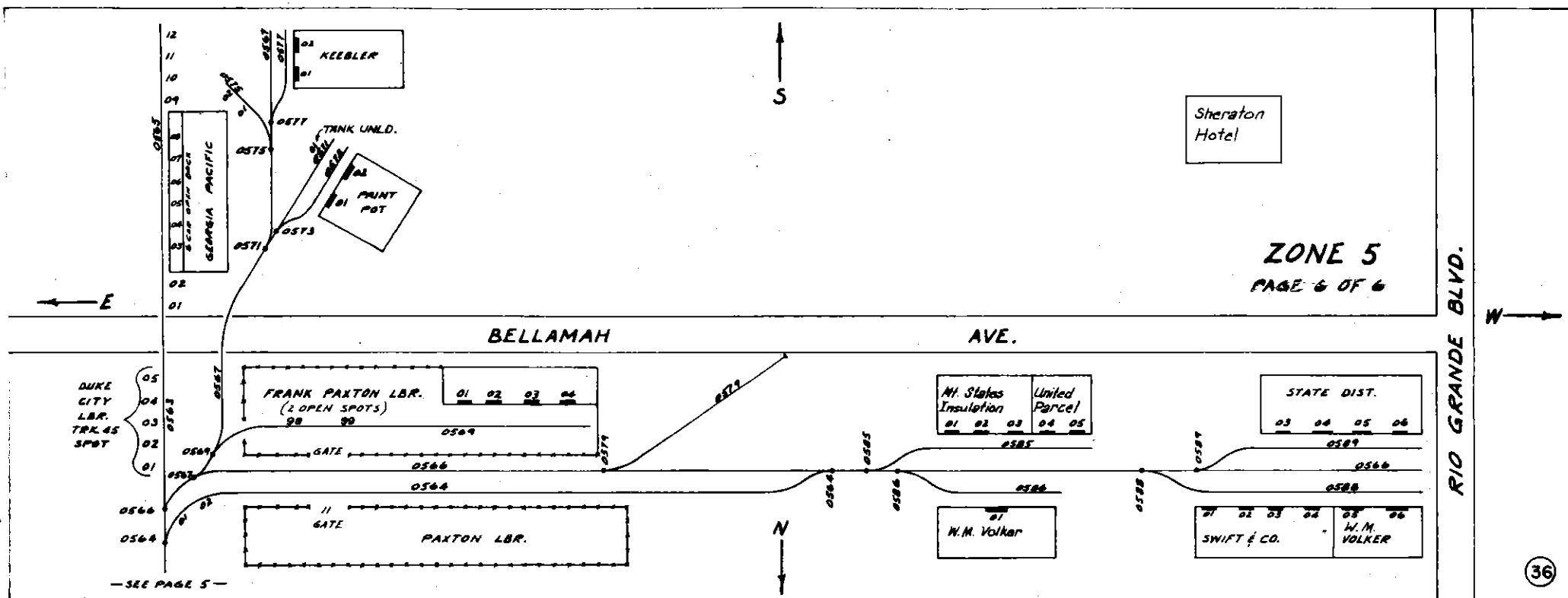

0601 Claremont Spur
 0601 01 American Forest Products
 0601 05 American Forest Products
 0601 06 American Forest Products
 0601 08 American Forest Products
 0601 09 American Forest Products
 0601 10 American Forest Products
 0603 01 Vacant
 0603 02 Vacant
 0603 04 Vacant
 0605 Killebrew Spur
 0607 Stadler Spur
 0608 Gibson Spur

0610 01 Big 3 Gas East Bldg Open Dock
 0610 02 Banas Co. Open Area
 0610 03 Garrett Freight Door
 0610 04 Big 3 Gas West Bldg. Open Dock
 0610 05 Big 3 Gas West Bldg Open Dock
 0611 01 Public Svc Co N. M. Open Area
 0611 03 Public Svc Co. N.M. Open Dock West End
 0611 07 Public Svc Co N.M. Open Dock East End
 0611 08 Public Svc Co N.M. Open Dock East End
 0612 01 Eppsco, Open Area
 0612 02 Eppsco Dock West End Track
 0613 01 Southern Union Gas Co Open Area
 0613 11 Southern Union Gas Co Door at Bldg.

(37)

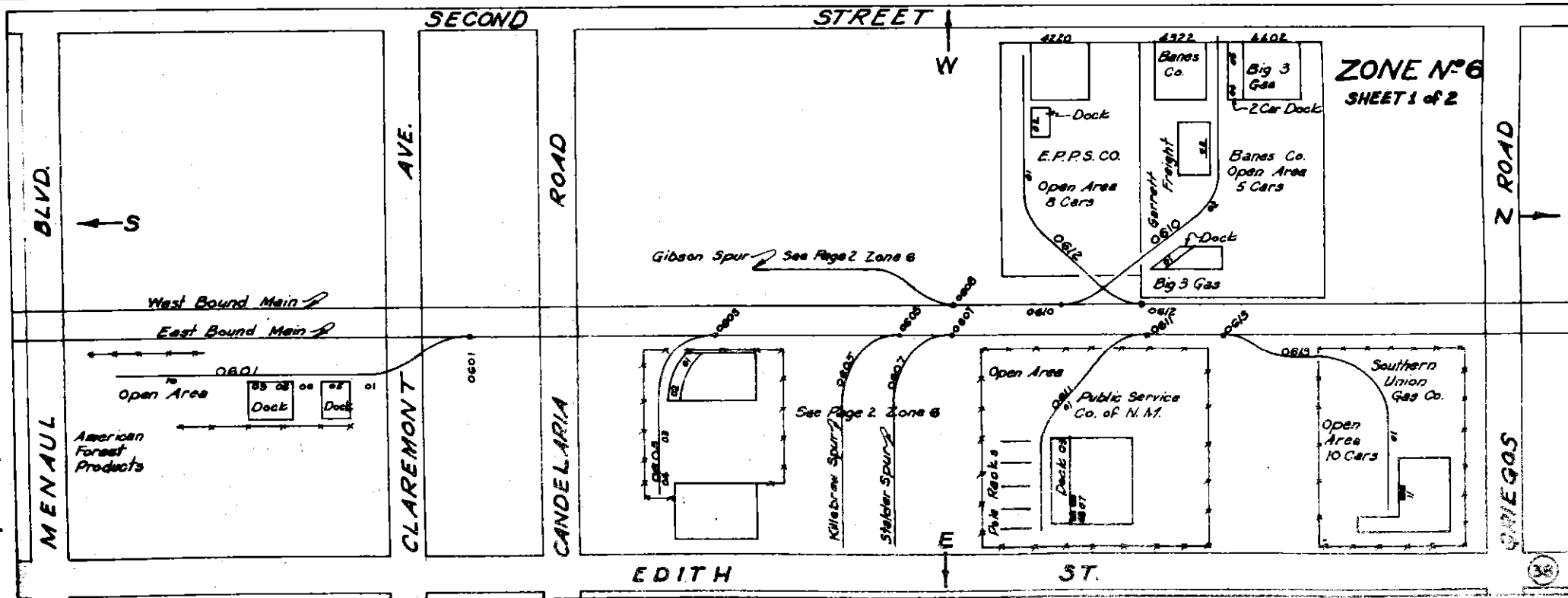

0605 Killebrew Spur
 0605 01 Killebrew Spur Open Area
 0605 02 Vacant New Warehouse
 0605 03 Vacant New Warehouse
 0605 04 Design Interiors
 0605 05 Price Carpets
 0605 06 Open Area Between Bldgs
 0605 07 Western Builders West Door
 0605 08 Western Builders East Door
 0605 09 Rust Sales, Door
 0605 10 Contractors Heating, West Door
 0605 11 Contractors Heating, East Door
 0605 12 U. S. Plywood, Open Dock West Spot
 0605 13 U. S. Plywood, Open Dock East Spot
 0605 14 Vacant
 0605 15 Oil Field Magco Drilling Compound
 0605 16 " " " " "
 0605 17 " " " " "
 0607 Stalder Spur
 0607 01 Quality Import Dock Door 1
 0607 02 Quality Bottling Dock Door 2
 0607 03 Quality Plant Wine Dock Door 3

0607 04 Quality Import, North Door
 0607 05 Quality Import, South Door
 0607 06 Lath & Plaster, Open Dock West Spot
 0607 07 Lath & Plaster, Open Dock East Spot
 0607 08 Quality Import Bottle Plant Plant # 1
 0607 09 Vacant
 0607 10 "
 0607 11 "
 0607 12 Mtn States Chemical West Door
 0607 13 Mtn States Chemical East Door
 0607 14 Mtn States Chemical Open Dock
 0607 15 Markham Co. West Door
 0607 16 Markham Co. East Door
 0608 Gibson Spur
 0608 01 Apache Lbr Gate 1 at Door
 0608 02 Apache Lbr Gate 2 at Door
 0608 03 Apache Lbr, Gate 3 at Door
 0608 04 Apache Lbr, Dock at end of Bldg
 0608 05 Apache Lbr Open Area
 0697 East Bound Main
 0698 West Bound Main

(39)

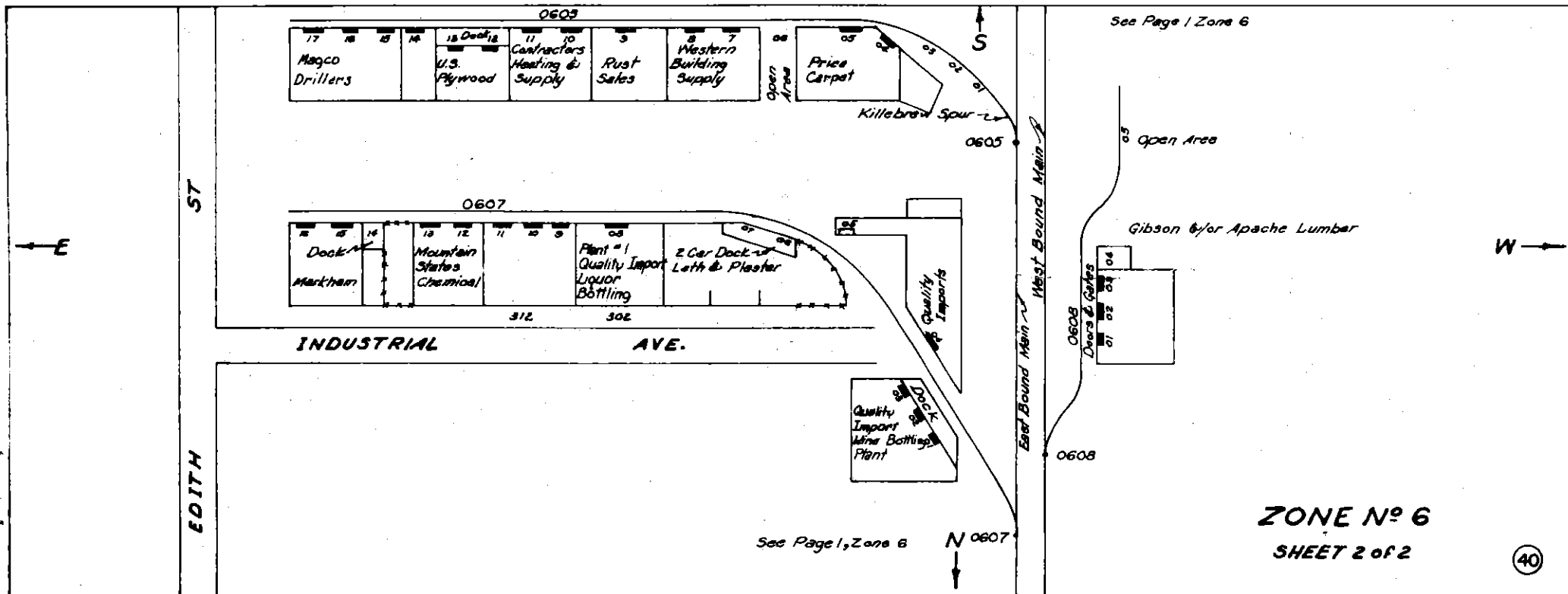

ZONE No 6
 SHEET 2 of 2

0701 01 Albuquerque Gravel, Hahn Open Spot
 0701 02 Albuquerque Gravel, Hahn Ldg Ramp
 0701 03 Albuquerque Gravel, Hahn Open Area
 0704 Hahn Team East Track # 1
 0704 21 Hahn Team East Track Spot South End
 0705 Passing Track, Hahn
 0706 Hahn Team Middle Track # 2
 0708 Hahn Team West Track # 3
 0708 11 Kerr McGee Tank Unldg
 0708 12 Kerr McGee Tank Unldg
 0709 01 National Steel, Open Area
 0709 02 National Steel, Open Area
 0709 03 El Rey Stucco, Unldg Pit
 0709 04 El Rey Stucco, Dock
 0709 05 Southwest Vermiculite, West Door
 0709 06 Southwest Vermiculite, East Door

0710 01 Doxol Tank Unloading
 0710 02 Doxol Tank Unloading
 0712 01 Associated Grocers Zone C Inside
 0712 02 Associated Grocers Zone B Inside
 0712 03 Associated Grocers Zone A Inside
 0713 01 Rainbo Bakery, Door at Dock
 0713 02 Rainbo Bakery, Flour Unldg. Pit
 0714 01 Grego Block Gate
 0714 02 Grego Block Unldg Pit
 0715 01 Kitts Enterprises
 0715 02 Kitts Enterprises
 0716 01 Acme Iron Metal, Open Spot at Derail
 0716 02 Acme Iron Metal, Open Area Spot
 0716 Winter-Weiss Spur, North Track
 0718 Winter-Weiss Spur, South Track

(41)

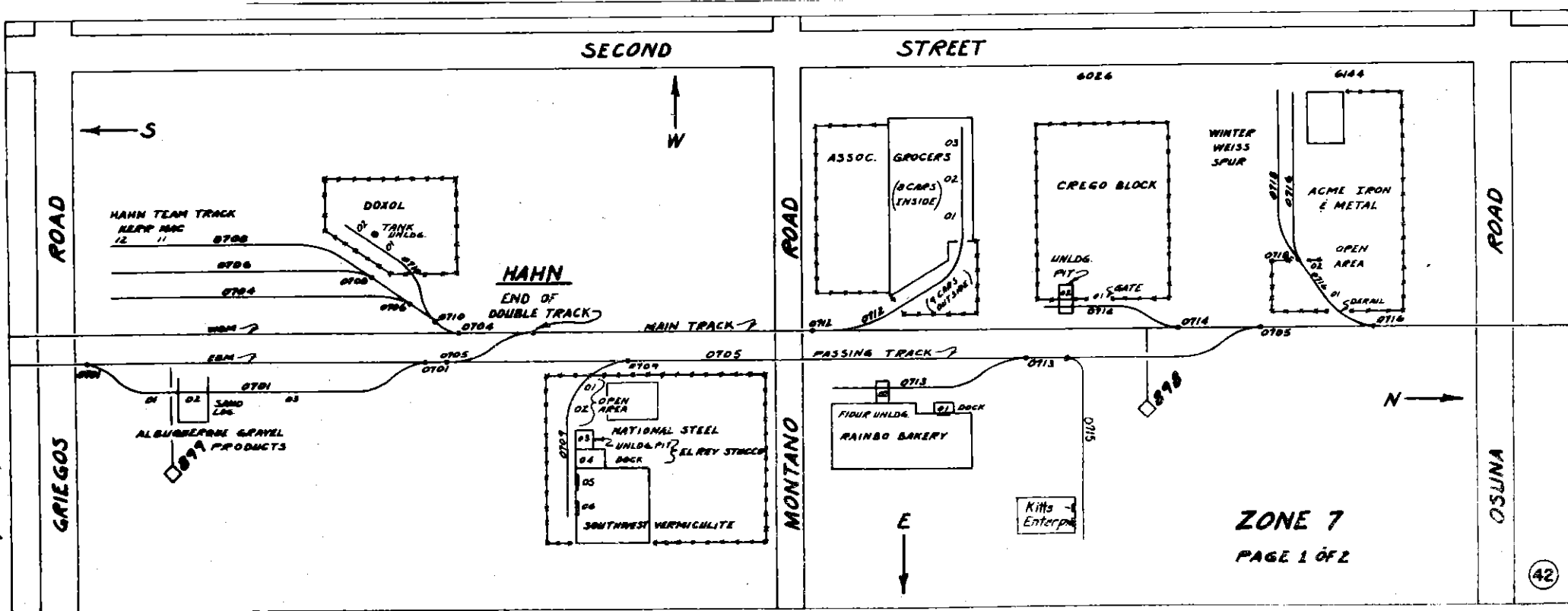

0722 Rio Grande Steel Spur
 0722 01 Hutch Fruit West Door Dock
 0722 02 Hutch Fruit Door - Dock
 0722 03 Hutch Fruit East Door Dock
 0722 10 Station 10 Unldg Crane
 0722 11 Station 11 Unldg Crane
 0722 12 Station 12 Unldg Crane
 0726 01 Tesa Mldg Open Area Spots
 0726 05 Sine Lbr Open Area Spots
 0726 07 Perfection Truss Open
 0735 Lead to American Gyp
 0739 01 Artistic Furn Overmeyer
 0739 02 Artistic Furn Overmeyer
 0739 03 Artistic Furn Overmeyer
 0739 04 Artistic Furn Overmeyer
 0739 05 Artistic Furn Overmeyer
 0739 06 Artistic Furn Overmeyer
 0739 07 Overmeyer
 0739 08 Overmeyer

0739 09 Overmeyer
 0739 10 Valley Pkg Overmeyer
 0739 11 -12-13-14-15 Overmeyer
 0741 PBS of N.M. Reeves 3 spot
 Open Area
 0742 Through
 0743 New Warehouse 12 spots
 0744 New Big 3 Gas Plant 2 spots
 0745 06 American Gyp Open Area
 0745 06 Lumber Inc Open Area
 0747 01 thru 10 spots inside
 0752 01 -02 - 03 - 04 - 05
 Best Moulding Co. Open Area
 0752 01 Sawdust loading spot

(43)

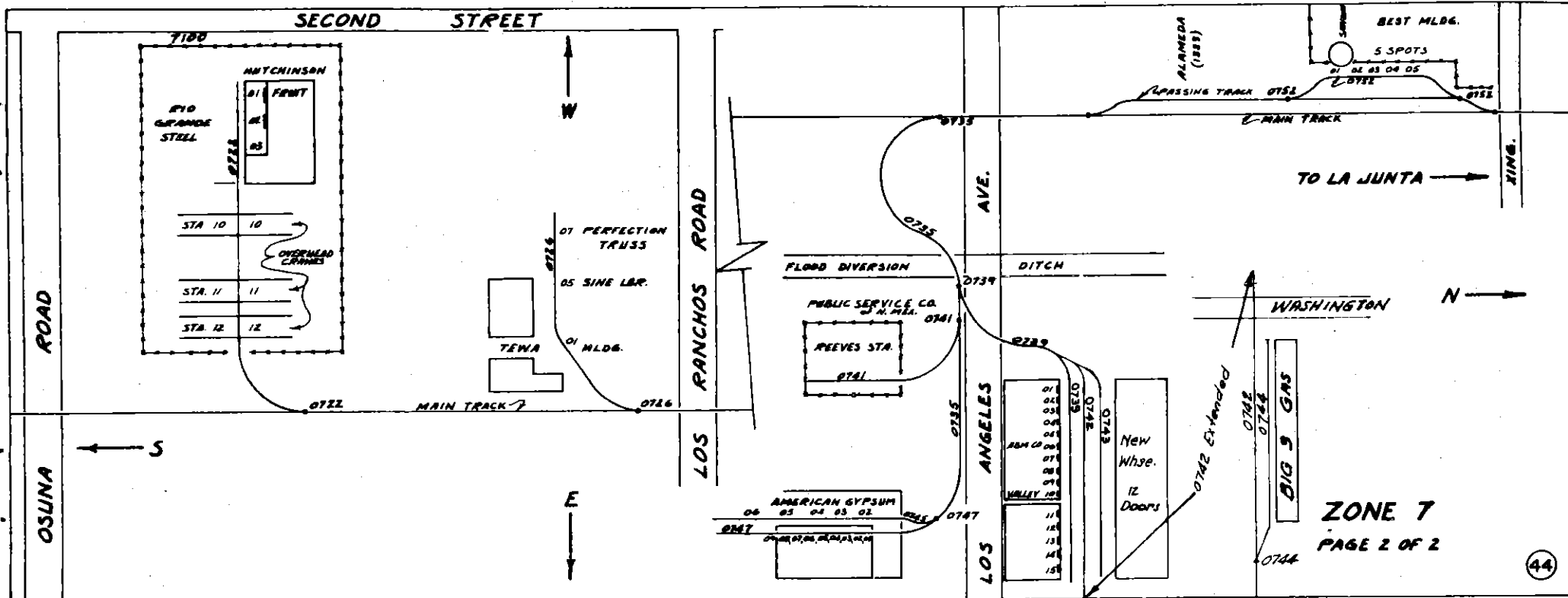

0802 West Pass at Stock Yards
 0804 01 Refinery Spur, Unldg Pit
 0804 02 Refinery Spur Open Area Spot
 0806 Schwartzman Pkg Co. Open Area
 0808 Albuquerque Waste Materials Metals
 0810 Hebenstreit Spur Open Area
 0812 Albuq. Waste Materials North Track
 0812 06 Albuq. Waste Materials Shredder
 0816 02 Chevron Asphalt Gate Open Spot
 0816 04 Vacant
 0816 06 Vacant
 0816 07 Vacant
 0816 10 Wellborn Paint East Door Market X
 0816 11 Wellborn Paint Door # 1
 0816 12 Wellborn Paint Door # 2

 0818 01 Chevron Asphalt Tank Unloading

0816 13 Wellborn Paint Door # 3
 0816 14 Wellborn Paint Door # Tank Unldg Spot
 0822 Barcelona Lumber Spur
 0822 01 Barcelona Lbr Co North Gate Spot at Dock
 0822 02 Barcelona Lbr Co. South Gate Spot at Dock
 0822 03 Barcelona Lbr Co. Gate Spot
 0822 04 Barcelona Lbr Co. Gate Spot South End
 0822 05 Barcelona Lbr Co. Open Spot Extreme So. End

(45)

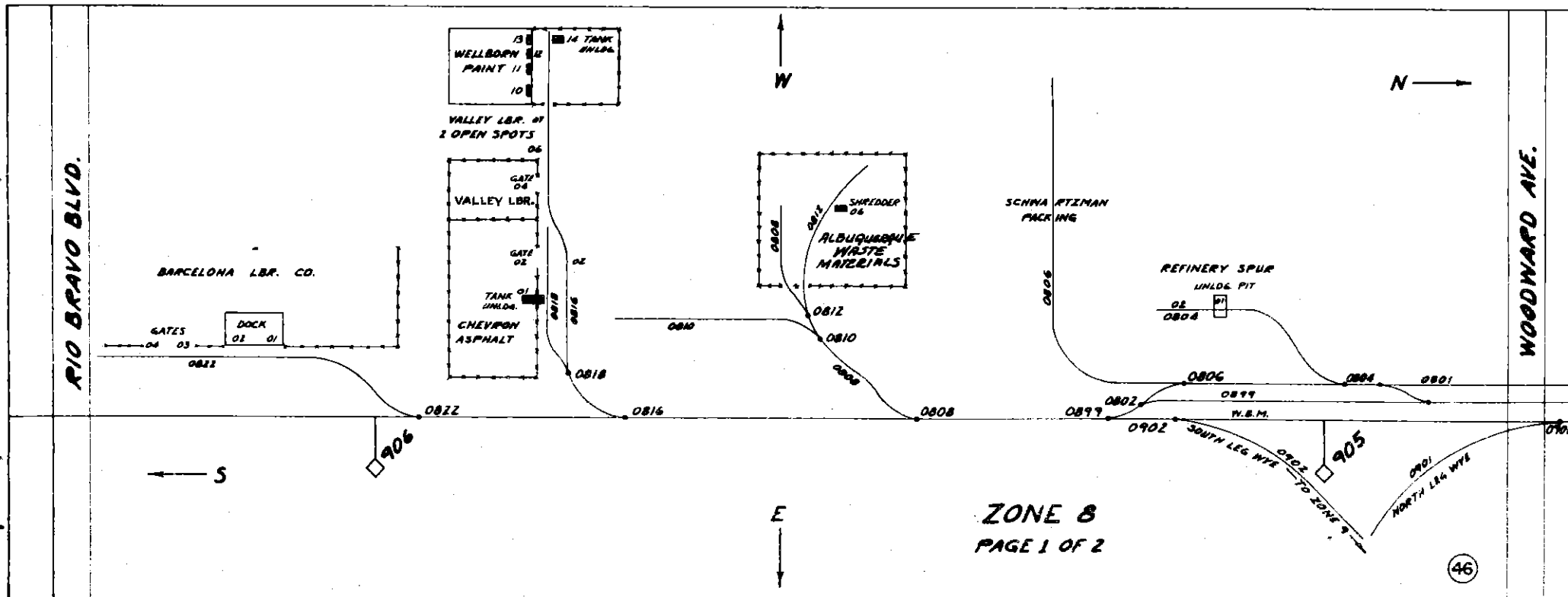

- 0851 01 Kinney Brick Co. Open Dock Spot
- 0851 02 Kinney Brick Co. Open Dock Spot
- 0851 03 Kinney Brick Co. Open Dock Spot
- 0851 04 Kinney Brick Co. Open Dock Spot
- 0851 05 Kinney Brick Co. Open Dock Spot
- 0871 01 American Concrete Pipe Open Spots
- 0873 01 Pucci Dist New Whse East Dock Stalder Industrial Park North Track
- 0873 02 Pucci Dist New Whse Door Dock room for 4 cars
- 0873 01 02 Open Dock Set Keg Beer to Spot # 1 East End of Whse
- 0875 01 Stryco Sales Dock Stalder Industrial Park South Track
- 0877 01 Old American Concrete Pipe Spur
- 0881 01 Briner Rust Proofing Spur Open Spot CEI Enterprises
- 0885 01 Sagebrush Sales Dock at East End
- 0885 02 Sagebrush Sales Open Area Spots
- 0891 Bates Lumber Co. Spur
- 0891 01 Bates Lumber Co. Open Area Spot West End Track
- 0891 02 Bates Lumber Co. Open Area Spot West End Track
- 0891 05 Bates Lumber Co. Wood Chip Loading Pipe

(47)

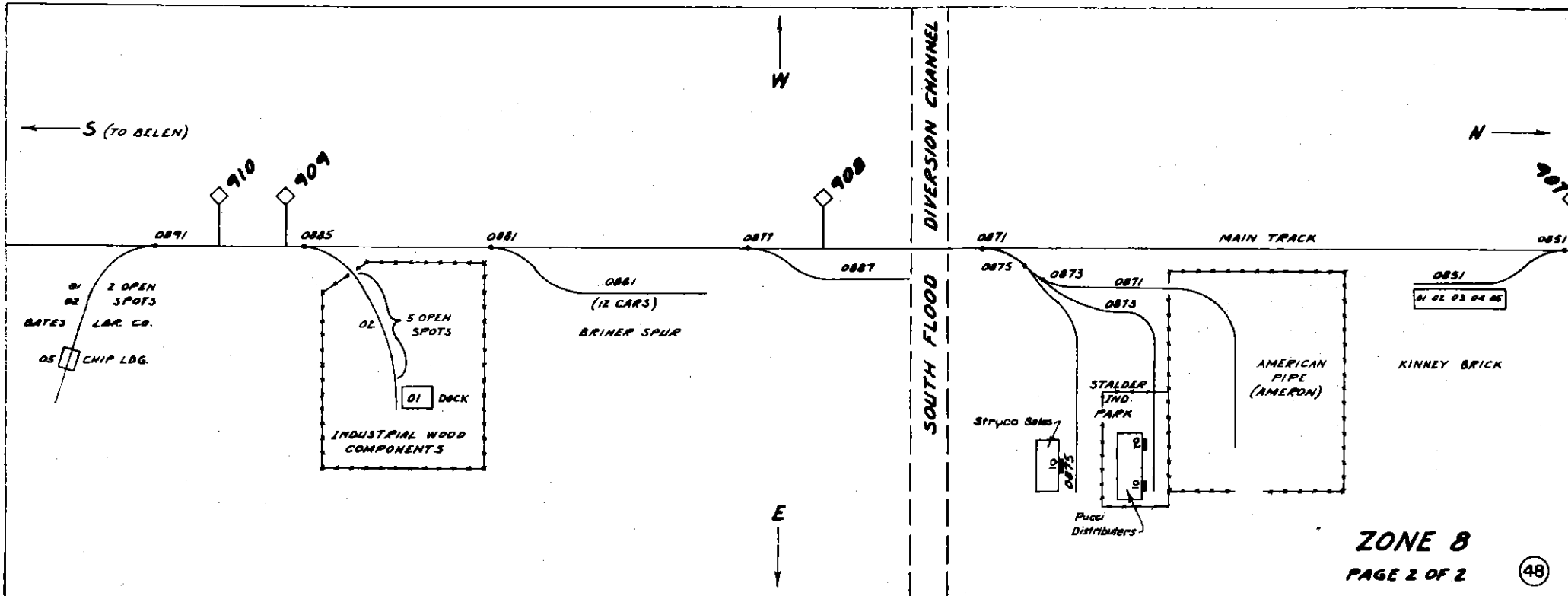

0901 North Leg of Wye
 0902 South Leg of Wye
 0903 TOFC West Track
 0905 TOFC East Track
 0909 Stock Yard Track, Old
 0912 01 Arrow Freight End Dock
 0914 01 Arrow Freight Open Area
 0914 11 Eidal International Open Area So End
 0914 12 Eidal International Inside Bldg.
 0914 13 Eidal Int. Open Spot between Bldgs.
 0914 14 Eidal Int. Inside North Bldg.
 0914 15 Eidal Int. Open Spot North End
 0914 16 Eidal Int. Open Spot North End
 0915 Lead to Tie Plant
 0916 01 Arrow Freight Open Area Spots
 0917 Farr Spur

0918 01 General Electric, West Track
 0940 Lead to Sandia Base
 0942 01 PBS of N.M. Person Sta., Open Spots
 0946 01 Ravel Bros Spur Open Area & Dock
 0946 02 Ravel Bros Spur Open Area & Dock
 0946 03 Fairview Eggs South Door
 0946 04 Fairview Eggs Middle Door
 0946 05 Fairview Eggs North Door
 0948 01 El Rey Stucco Open Area Spot
 0948 02 El Rey Stucco Unldg. Pit
 0951 Tie Plant West Track- Arrow Freight
 0952 Tie Plant - Arrow Freight
 0953 Tie Plant
 0954 Tie Plant - Clinkers Ideal Cmt.
 0955 Tie Plant - Clinkers Ideal Cmt.
 0956 Tie Plant
 0957 Tie Plant
 0958 Tie Plant East Track

(49)

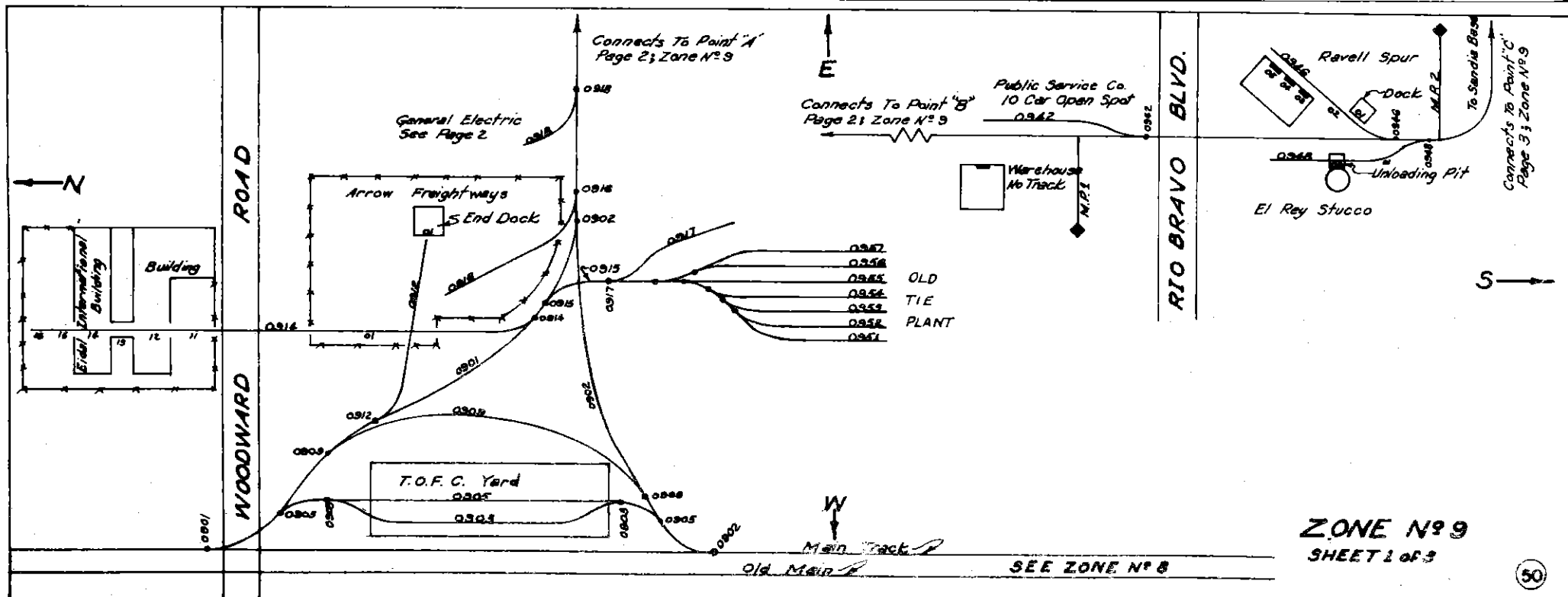

0901 West Kirtland Lead to
 0918 01 General Electric Co. West Track
 0920 01 General Electric Co. East Track
 0922 Lead to Texaco and Duke City Foods
 0922 01 Duke City Foods, Dock
 0924 02 Texaco, North Door
 0924 03 Texaco 4- Car Tank Ldg Rack
 0926 01 Standard Oil Spot 1
 0926 02 Standard Oil Spot 2
 0926 03 Standard Oil Spot 3
 0926 04 Standard Oil Spot 4
 0926 05 Standard Oil Spot 5
 0926 06 Standard Oil Spot 6
 0926 07 Standard Oil Spot 7
 0926 34 Standard Oil Spot 34
 0926 36 Standard Oil Spot 2 Car Tank Ldg Rack

0930 01 Van Waters & Rogers, Dock Spot South End
 0930 02 " " " " Dock Spot
 0930 03 " " " " South Door
 0930 04 " " " " North Door
 0930 99 " " " " Open Area Spot So End
 0932 01 Van Waters & Rogers Tank Unldg Spot
 West Track
 0940 Lead to Sandia Base

(51)

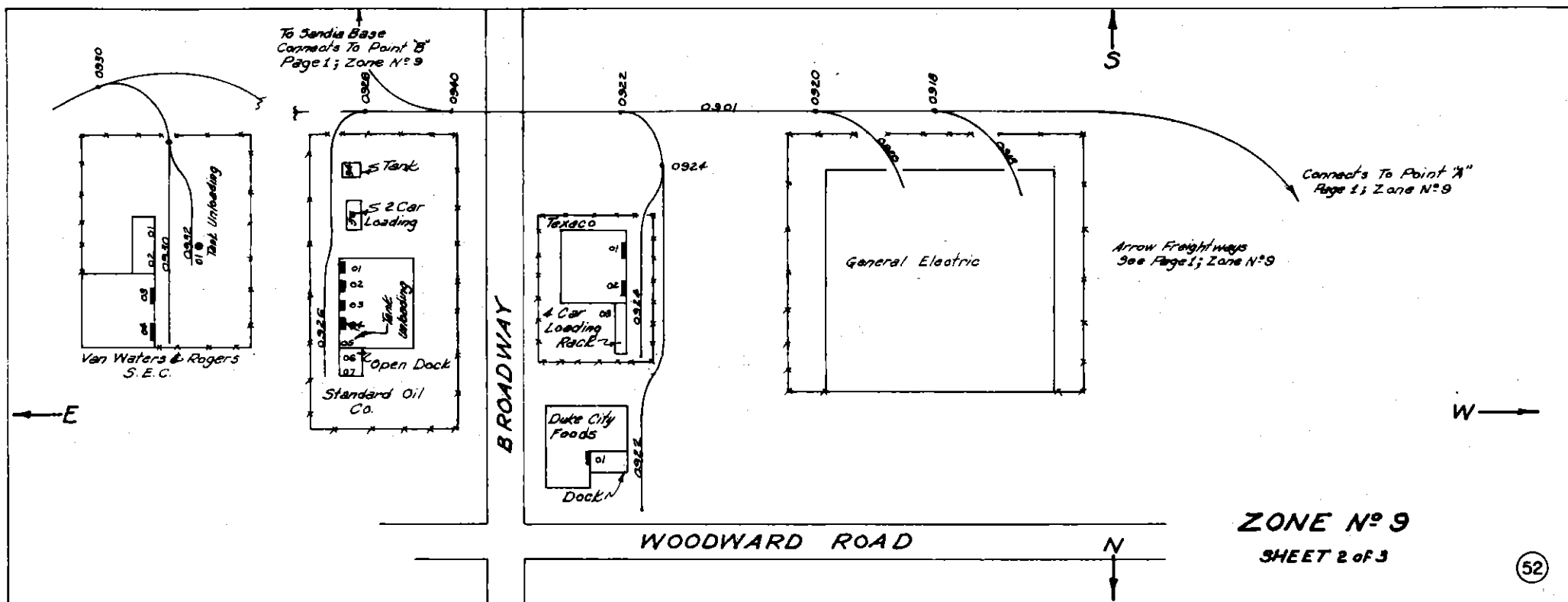

ZONE No 9

SHEET 2 of 3

0940 Lead to Sandia Base
 0961 Sandia Spur 1 Open Area Spots
 0962 Sandia Spur, Passing Track
 0964 Kirtland AFB, Track to
 0964 01 Kirtland AFB, Whse 1015 West Door
 Open Dock
 0964 02 Kirtland AFB Whse 1015 Door
 0964 03 Kirtland AFB Whse 1015 Door
 0964 04 Kirtland AFB Whse 1015 Door
 0964 05 Kirtland AFB Whse 1015 Door
 0964 06 Kirtland AFB Whse 1015 Door
 0964 07 Kirtland AFB Whse 1015 Door
 0964 08 Kirtland AFB Whse 1015 East Door
 Open Dock
 0964 09 Kirtland AFB Whse 1015 Open Area East
 End
 0966 01 Kirtland AFB Acid Spot Salvage Yard
 0966 02 Kirtland AFB Salvage Yd Open Area Spot
 0968 Kirtland AFB Track Number EK 1
 0970 Kirtland AFB North Tank Track at Rack
 0972 Kirtland AFB South Tank Track at Rack
 0974 01 Kirtland AFB Whse 1010 East Door Dock

0974 02 Kirtland AFB, Whse. 1010 Door(Commissary)
 0974 03 Kirtland AFB, Whse. 1010 Door
 0974 04 Kirtland AFB, Whse. 1010 Door
 0974 05 Kirtland AFB, Whse. 1010 Door
 0974 06 Kirtland AFB, Whse. 1010 Door
 0974 07 Kirtland AFB, Whse. 1010 West Door at Dock
 0976 01 Kirtland AFB, End Dock
 0981 01 Sandia Spur 2, Open Area
 0991 Sandia Base, Passing Track
 0992 Sandia Spur 5 South Track
 0992 01 Sandia Spur 5 Open Area Spot
 0992 02 Sandia Spur 5 Open Area Spot
 0992 03 Sandia Spur 5 East Spot at Dock
 0992 04 Sandia Spur 5 Spot at End Dock
 0993 01 Sandia Spur 3 Spot at End Dock
 0993 02 Sandia Spur 3 Open Area Spot
 0994 01 Sandia Spur 5 Fuel Unldg Spot North Track
 0994 02 Sandia Spur 5 Fuel Unldg Spot North Track
 West End
 0995 01 Sandia Spur 4 Spot at Open Dock
 0995 02 Sandia Spur 4 Open Dock Spot
 0995 03 Sandia Spur 4 Open Dock Spot

(53)

