

Eastern Division CLIC Bulletin No. 2

THE ATCHISON, TOPEKA and SANTA FE RAILWAY COMPANY

**-CLIC-**

CAR LOCATION and INVENTORY CONTROL  
EMPORIA, KANSAS

*S-C - Elmdale - C. C. Point*

Reissue Date: NOVEMBER 1981

W. F. KILPATRICK, Supt.  
Emporia, Kansas

EASTERN DIVISION CLIC BULLETIN NO. 2

This booklet contains instructions and maps concerning the Santa Fe CAR LOCATION INVENTORY CONTROL (CLIC) System for the terminal of Emporia and various "Blind Sidings," designated by the following zones:

<u>Station</u>	<u>Zone</u>	<u>Pages</u>
Emporia	01	2-7
	02	8-9
	03	10-14
- First District, Eastern -		
Reading	17	15
- Second District, Eastern -		
Lebo	93	16
Neosho Rapids	53	17
- First District, Middle -		
Saffordville	75	18
Strong City (Cottonwood Falls)	84	19-20
Elmdale	38	21
Clements	45	22
Cedar Point	50	23

Tracks are assigned specific numbers within the zones and spots on the tracks are given individual numbers. By using zone, track and spot numbers, we are able to print switch lists which will reflect the locations to which a car should be spotted.

A CLIC Spot Number will consist of six digits the first two digits designate the zone to which the car is destined; the second two digits indicate the track number within the zone; the last two digits represent the actual spot along the track.

EXAMPLE OF CLIC SPOT NUMBER

03 23 03      Iowa Beef Packers (Open)

\_\_\_\_\_ Spot Number  
\_\_\_\_\_ Track Number  
\_\_\_\_\_ Zone Number

All industries will be referred to by CLIC Spot Number rather than by name. Switches have been painted with zone and track number shown on either target or stand. Spot numbers have been painted on doors, docks, buildings, gates, etc., where possible; otherwise, the proper spot can be determined by noting spot descriptions that are found just opposite zone maps on the following pages of this book.

These maps are not drawn to scale, but merely serve as a guide in locating proper tracks or spots.

The following instructions pertain specifically to the physical switching, spotting and pulling of cars and are called particularly to the attention of all yardmen and trainmen for their compliance.

SWITCHING AT "BLIND SIDINGS":

In order to obtain current and correct information to enable the Santa Fe to maintain correct Demurrage records and facilitate handling loaded and empty cars in a more expedient manner, the following instructions must be adhered to without fail:

- (1) For loads and empties destined to "Blind Sidings", trainmen will be furnished a CLIC Number where each car will be spotted. TRAINMEN WILL ENDEAVOR TO SPOT THESE CARS AS INSTRUCTED AND A WIRE REPORT WILL BE SENT TO THE DESIGNATED CONTROL CLERK, UPON ARRIVAL AT THEIR OUTLYING TIE-UP POINT. Include in this wire all work performed at "Blind Sidings" including initial and number of all cars spotted or pulled. Also indicate time work was accomplished and CLIC number cars were spotted too. (See example)
- (2) A signed copy of Switch List may be left with the Control Clerk in lieu of wire report. (See example)

EXAMPLE OF WIRE REPORT

-----  
November 1, 1981

AGENT - EMPORIA

EXTRA 5501 WEST. SET OUT MP 131413

XCH 53-02-02 TIME 1045. PICK UP ATSF

45696, ATSF 309376 SCH 93-02-01 AND 02 TIME

1330. SET OUT ATSF 302465 LD 93-04-01

TIME 1345.

-----  
CONDR NAME  
-----

SWITCHING IN TRAIN YARD:

(1) All switching in train yard will be performed by use of switch list unless otherwise instructed by Supervisor of Operations, and Supvr. of Ops. must report all exceptions to CLIC Clerk promptly.

(2) Disposition of car will be shown on list by Supvr. of Ops. just opposite car initial. This disposition will be indicated by means of zone, track, and/or spot number.

(3) Supervisor of Operations will indicate on switch list at which end of yards switching is to be performed.

(4) Supervisor of Operations will indicate on switch list where cuts, if any, are to be made, as follows:

1st Cut \_\_\_\_\_.  
2nd Cut \_\_\_\_\_.  
Etc. \_\_\_\_\_.



(5) Engine Foreman will switch cars according to list marked by Supvr. of Ops. Should Engine Foreman switch or place car to some location other than that marked on list, or makes a cut different than marked by Supvr. of Ops., he must so indicate on switch list and advise Supvr. of Ops. of this promptly. Supervisor of Operations will correct his copy of list accordingly and notify CLIC Clerk of this change promptly.

(6) Engine Foreman must notify Supvr. of Ops., making notation on switch list, of any exceptions taken to list; such as no car, car not on list, car out of line, car is dangerous, excess dimension or hazardous (when this information is not so indicated on list), car is carded rear end movement only, or any other exceptions noted. Supervisor of Operations will make notation of this information on his copy of list and notify CLIC Clerk promptly.

(7) Supervisor of Operations should be aware of all switching moves made in the yard and Engine Foreman must indicate on list and advise Supvr. of Ops. of any extra moves. When so advised, Supvr. of Ops. will inform CLIC Clerk.

SWITCHING AT INDUSTRIES:

(1) All switching at industries will be performed by use of switch list unless otherwise instructed by Supvr. of Ops.

(2) Disposition to be made of car will be shown on list by Supvr. of Ops. just opposite car initial. This disposition will be indicated by zone, track and/or spot number.

(3) Engine Foreman will switch cars according to list marked by Supvr. of Ops. Should Engine Foreman switch or place car to some location other than that marked on list, he must so indicate on list and advise Supvr. of Ops of change. Supervisor of Operations will notify CLIC Clerk of this change promptly.

(4) If car is not actually spotted, but left on that industry's track, Foreman will indicate "On Track Not Placed" in the following manner - O T N P. If car is placed on some other track, Foreman will indicate on list "Not Placed Left On (Track No.)" in the following manner - N P (Track Number).

Example: (NP 311 ATSF 620510A6L)

(5) Engine Foreman must indicate on list and notify Supvr. of Ops. of any exceptions taken to list, such as no car, car not on list, car out of line, or car is dangerous, excess dimension or hazardous (when this information is not so indicated on list), car is carded rear end movement only, or any other exceptions noted. Supervisor of Operations will make notation on his copy of list and notify CLIC Clerk of this information promptly.

(6) If an industry requests service not shown on Foreman's list. Foreman should obtain such request in writing and deliver to Supvr. of Ops. after switching is completed. If unable to obtain written request from industry, Foreman should record name of person requesting service on switch list showing service requested and performed.

(7) If a car other than one ordered into industry by the Supvr. of Ops is spotted, Engine Foreman must indicate on switch list car number spotted and notify Supvr. of Ops. of substitution. Supervisor of Operations must notify CLIC Clerk of this substitution.

(8) Engine Foreman must show on switch list actual time cars are placed or pulled at an industry.

(9) Supervisor of Operations should be aware of all switching moves made at industries and Foreman must note on switch list and advise Supvr. of Ops. of all extra moves.

(10) After switching is completed, Engine Foreman will indicate on switch list any work not completed, show time all switching on that list is completed, sign his name and return switch list to specified location for processing.

(See example)

For observation and guidance, the following codes may be shown on switch list preceeding car initial or in special instruction column:

- BI - Bad Order
- CD - Condemned
- CB - Combustible
- CL - Chlorine
- CM - Corrosive
- \*CT - Crosstown Switch
- DG - Dangerous
- DH - Do Not Hump
- DU - Do Not Uncouple
- EX - Explosive
- FG - Flam. Compr. Gas (Shove to Rest)
- FH - Flammable Gas
- FL - Flammable
- FS - Flammable Solid
- FW - Flam. Solid W(Dangerous When Wet)
- \*HB - Hold for Billing
- \*HC - Hold for Charges
- \*HD - Hold for Disposition
- HE - Head End Only
- \*HI - Hold for Inspection
- HL - High Wide Load
- \*HS - Hold for Shippers Order
- HV - High Value
- IP - Interchange Prohibited
- \*IS - Intra-plant Switch
- \*LL - Leased Car on Leased Track
- NG - Non-Flammable Gas
- OM - Oxidizer
- OP - Organic Peroxide
- OX - Oxygen
- PA - Poison Gas (Shove to Rest)
- PB - Poison
- \*PU - Part Unloaded
- RA - Radioactive
- RE - Rear End Only
- RF - Refuel
- RM - Radioactive Material
- \*RS - Respot

- \*SD - Special Demurrage Rate
- \*SF - Special Rule on Free Time
- SR - Speed Restriction
- \*TT - Team Track Loading or Unloading
- \*TU - Turn Car & Respot
- WH - Weight Heavy
- WI - Waive Inspection-Set Direct
- WL - Weigh Light
- XA - Explosive "A"(Shove to Rest)
- XB - Explosive "B"
- XX - DO NOT MOVE THIS CAR

\* Denotes Demurrage Codes

\*\*\*\*\*

GOOD COMMUNICATION IS ESSENTIAL BETWEEN  
ENGINE FOREMAN, CONDUCTOR, SUPERVISOR OF  
OPERATIONS, AGENT AND CLIC CLERK FOR A  
SUCCESSFUL CLIC OPERATION. THE COMPLETE  
COOPERATION OF EVERY EMPLOYEE IS  
SOLICITED. THIS TEAM EFFORT WILL ASSIST  
EACH PERSON IN PERFORMING THEIR JOB.

\*\*\*\*\*

0001(0)



855 N-S MAY 23, 1977 1519 JACOBSONIRONMT SANTA FE 875

FORM 818 E 510

TRK NO. DIRECTION MO. DY. YR. TIME FOREMAN ENG. OR TRAIN NO. IND. LIST NO. SHEET NO.

SWITCH TO TRX.	DEM INST.	INITIAL	NUMBER	KIND/L/E	CONTENTS	STATION TO	CLIC NO. (ROUTE)	ARR. DATE	GROSS TONS	BLK. NO.	SPL. INST.	SET OR PULL	REMARKS
1 1501	1	ATSF	73798	GM L	SCEPTIN	6	IHB	113	PULL		WH	INDU	1030 5-24-77
2 1501	2	ATSF	70307	GM L	SCEPTIN	1578		139	PULL		WH	INDU	1040 5-24-77
3 152601		AT	70387	GM E		0	FROM		TO	855	SET	SET	104 5-24-77
4 152602		AT	74678	GM E		0	FROM		TO	855	SET	SET	104 5-24-77
5 152603		AT	774675	GM E							SET		104 5-24-77 Per Mr. Morrison
6													
7													W.C. Cox
8													
9													

THIS IS AN EXAMPLE OF A PROPERLY COMPLETED SWITCHLIST

NUMERICAL INDEX  
ZONE 01

<u>CLIC NO.</u>	<u>NAME</u>
01 01 00	Eastbound Yard 1
01 02 00	Eastbound Yard 2
01 03 00	Eastbound Yard 3
01 04 00	Eastbound Yard 4
01 05 00	Eastbound Yard 5
01 06 00	Eastbound Yard 6
01 07 00	Eastbound Yard 7
01 08 00	Eastbound Yard 8
01 09 00	Eastbound Yard 9
01 10 00	Eastbound Yard 10
01 11 00	Eastbound Yard 11
01 12 00	Eastbound Yard 12
01 13 00	Eastbound Yard 13
01 14 00	Eastbound Yard 14
01 15 00	Eastbound Yard 15
01 16 00	Waycar Track
01 17 00	Drover Track
01 18 00	North Engine Lead
01 19 00	South Engine Lead
01 20 00	Transfer
01 21 00	Scale Track
01 22 00	Bad Order Track
01 23 00	House Track
01 24 00	Connection
01 25 00	C & D Track
01 26 00	North Middle Track
01 27 00	North Stockyard Track
01 28 00	West Stockyard Lead
01 29 00	East Stockyard Lead
01 31 00	North Bluestem Elevator
01 31 01	North Bluestem Elevator (Pit)
01 32 00	South Bluestem Elevator
01 32 01	South Bluestem Elvator (Spout)
01 33 00	South Stockyard Track
01 34 00	South Middle Track
01 36 00	Treating Plant No. 2
01 37 00	Conditioning Track
01 38 00	Rip No. 2
01 39 00	Rip No. 3
01 40 00	rip No. 4
01 41 00	Wheel Garden Track
01 42 00	Lower 13 Track
01 43 00	Upper 13 Track
01 45 00	Bunk Car Track
	Old Power House Spur

(ZONE 01 Cont'd)

01 46 00	Treating Plant No. 1
01 47 00	North Coach
01 48 00	South Coach
01 49 00	North Storehouse Track
01 49 01	North Storehouse Trk.(E. Door)
01 50 00	South Storehouse Track
01 51 00	Track 23-RH
01 52 00	Track 24-RH
01 53 00	R.H. Stall No. 2
01 54 00	R.H. Stall No. 7
01 56 00	New "1"
01 62 00	Sand Pit Track
01 63 00	South RH Track
01 64 00	RH No. 1
01 65 00	RH No. 2
01 66 00	RH No. 3
01 67 00	RH No. 4
01 68 00	RH No. 5
01 69 00	Howard Branch

ZONE 02

02 03 00	Westbound Yard 3
02 04 00	Westbound Yard 4
02 05 00	Westbound Yard 5
02 06 00	Westbound Yard 6
02 07 00	Westbound Yard 7
02 08 00	Westbound Yard 8
02 09 00	Westbound Yard 9
02 10 00	Westbound Yard 10
02 11 00	Westbound Yard 11
02 12 00	Westbound Yard 12
02 13 00	Westbound Yard 13
02 14 00	Westbound Yard 14
02 15 00	Westbound Yard 15
02 16 00	Westbound Yard 16
02 17 00	Westbound Yard 17
02 18 00	Westbound Yard 18
02 19 00	Westbound Yard 19
02 20 00	West Spur
02 21 00	North House
02 22 00	South House
02 23 00	Pocket Track
02 50 00	Storage 5
02 60 00	Storage 6
02 70 00	Storage 7
02 80 00	Storage 8

02 98 00 South Main Line  
02 99 00 North Main Line

ZONE 03

03 01 00 Emporia Ready Mix Spur  
03 01 01 Emporia Ready Mix (Pit)  
03 02 00 Modine Spur  
03 02 01 Modine (Doors)  
thru 03  
03 02 04 Modine (Dock)  
03 03 00 Fleetwood Spur  
03 03 01 Fleetwood (Dock)  
03 04 00  
03 04 01 DeBauge (Door)  
03 04 02 DeBauge (Dock)  
03 05 00 Interstate Spur  
03 06 00 Industry Lead Track  
03 06 01 Interstate Bakery (Dock)  
03 06 02 Interstate Bakery (Hoses)  
thru 04  
03 07 00 Bunge Corp. West Track  
03 07 01 Bunge Corp. West Elev. (Spout)  
03 08 00 Tail Track  
03 08 01 Peak & Hatcher (Dock)  
03 09 00 Anderson Track  
03 10 00 I.B.P. T.O.F.C. Trk. "A"  
03 11 00 I.B.P. T.O.F.C. Trk. "B"  
03 12 00 I.B.P. T.O.F.C. Trk. "C"  
03 13 00 I.B.P. T.O.F.C. Trk. "D"  
03 14 00  
03 14 01 Safeway Pet Food (Doors)  
thru 04  
03 15 00  
03 15 01 Safeway Pet Food (Pit)  
03 21 00 I.B.P. Trk. No. 1  
03 21 01 I.B.P. Trk. No. 1 (Racks)  
thru 03  
03 21 04 I.B.P. Trk. No. 1 (Open)  
03 22 00 I.B.P. Trk. No. 2  
03 22 01 I.B.P. Trk. No. 2 (Racks)  
thru 03  
03 23 00 I.B.P. Trk. No. 3  
03 23 01 I.B.P. Trk. No. 3 (Doors)  
thru 02  
03 23 03 I.B.P. Trk. No. 3 (Open)  
03 24 00 I.B.P. Trk. No. 4  
03 24 01 I.B.P. Trk. No. 4 (Open)  
thru 02  
03 24 03 I.B.P. Trk. No. 4 (Spout)  
03 24 04 I.B.P. Trk. No. 4 (Open)  
thru 05



(ZONE 03 Cont'd)

03 25 00	I.B.P. Trk. No. 5	
03 30 00	Elm Street Elev. Trk.	
03 30 01	Teichgraeber Mlg. Co.	(Door)
03 30 02	Teichgraeber Mlg. Co.	(Hose)
03 30 03	Teichgraeber Mlg. Co.	(Open)
03 30 04	Teichgraeber Mlg. Co.	(Door)
03 30 05	Teichgraeber Mlg. Co.	(Pit)
03 30 06	Teichgraeber Mlg. Co.	(Spout)
03 40 00	Penny Track	
03 40 01	Penny Ready Mix	(Pit)
thru 02		
03 51 00	Freight House No. 1	
03 52 00	Freight House No. 2	
03 53 00	Freight House No. 3	
03 53 01	Freight House No. 3	(Dock)
thru 02		
03 56 00	Freight House No. 6	
03 56 01	Freight House No. 6	(Dock)
03 57 00	Freight House No. 7	
03 57 01	Lyon County REA	(Open)
03 57 10	Teichgraeber Fertz.	(Hose)
03 57 11	Teichgraeber Fertz.	(Open)
03 57 12	Teichgraeber Fertz.	(Auger)
03 57 20	Penny's Warehouse	(Doors)
thru 21		
03 61 00	Bumper Track	
03 61 01	Industrial Foods	(Door)
03 61 10	Emporia Whsl. Coffee Co.	(Door)
03 70 00	City Roller Mill Track	
03 70 01	Teichgraeber Fertz. E.	(Dock)
thru 02		
03 71 00	B & B Spur Track	
03 80 00	Bunge Corp. West Track	
03 82 00	Mark II Spur Track	
03 82 01	Mark II Lumber	(Open)
thru 02		
03 83 00	Bunge Corp. Middle Track	
03 83 01	Bunge Corp.	(Doors)
thru 02		
03 83 03	Bunge Corp.	(Pit)
03 84 00	Bunge Corp. Scale Track	
03 85 00	Bunge Corp. Oil Spur	
03 85 01	Bunge Corp.	(Rack)

(ZONE 03 Cont'd)

03 90 00 Sauder Ind. Spur Track  
03 90 01 Sauder Industries (Pit)  
03 99 00 First District Main Line

ZONE 17  
READING

17 01 00 Passing Track  
17 02 00 House Track  
17 02 01 House (Open)  
17 03 00 Track No. 5  
17 03 01 Reading Elevator (Spout)  
17 99 00 Main Line

ZONE 93  
LEBO

93 01 00 Elevator Track  
93 01 01 Grangers Co-op Assn. (Auger)  
thru 02  
93 02 00 Stock track  
93 02 01 Grangers Co-op Assn. (Auger)  
93 02 02 Grangers Co-op Assn. (Spout)  
93 02 03 Grangers Co-op Assn. (Doors)  
thru 04  
93 02 05 Grangers Co-op Assn. (Hose)  
93 03 00 House Track  
93 03 01 House (Open)  
93 03 02 House (Dock)  
93 04 00 Elevator Track  
93 04 01 Grangers No. Elev. (Spout)  
93 98 00 South Main Line  
93 99 00 North Main Line

ZONE 53  
NEOSHO RAPIDS

53 01 00 Track No. 12  
53 02 00 Track No. 2  
53 02 01 Neosho Rapids Elev. (Hose)  
53 02 02 Neosho Rapids Elev. (Spout)  
53 98 00 South Main Line  
53 99 00 North Main Line

- N -

ZONE 75  
SAFFORDVILLE

75 01 00	Elevator Track	
75 01 01	North Grain	(Spout)
75 01 02	North Grain	(Hose)
75 02 00	Storage Track	
75 98 00	Middle Main Line	
75 99 00	North Main Line	

ZONE 84  
STRONG CITY - COTTONWOOD FALLS

84 01 00	Elevator Spur Track	
84 01 00	Strong City Elev. Co.	(Spout)
84 02 00	Yard Track	
84 03 00	Yard Track	
84 04 00	Yard Track	
84 05 00	East Leg Wye	
84 06 00	West Leg Wye	
84 07 00	Wye Spur Track	
84 08 00	Yard Spur Track	
84 09 00	Yard Spur Track	
84 10 00	House Track	
84 10 01	House	(Dock)
84 11 00	Cottonwood Elevator Spur Track	
84 11 01	Blue Stem Elevator	(Spout)
84 97 00	Cottonwood Falls Spur Track	
84 98 00	Siding	
84 99 00	First District Main Line	

ZONE 38  
ELMDALE

38 01 00	Elevator Track	
38 01 01	Elmdale Elevator	(Spout)
thru 02		
38 02 00	Spur Track	
38 99 00	Main Line	

ZONE 45  
CLEMENTS

45 01 00	Spur Track	
45 98 00	Siding	
45 99 00	Main Line	

ZONE 50  
CEDAR POINT

50 01 00	House Track	
50 02 00	Elevator Track	
50 02 01	Cedar Point Elev.	(Spout)
50 02 02	Team	(Open)
50 99 00	Main Line	

0001(0)



ALPHABETICAL INDEX

Anderson Track		03 09 00
Bad Order Track		01 22 00
B & B Spur Track		03 71 00
Bluestem Elev.-North Track		01 31 00
Bluestem Elev.-North	(Pit)	01 31 01
Bluestem Elev.-South Track		01 32 00
Bluestem Elev.-South	(Spout)	01 32 01
Bluestem Elev.-Strong City	(Spout)	84 11 01
Bumper Track		03 61 00
Bunge Corp. West Track		03 07 00
Bunge Corp. West Elev.	(Spout)	03 07 01
Bunge Corp. West Track		03 80 00
Bunge Corp. Middle Track		03 83 00
Bunge Corp.	(Doors)	03 83 01 thru 02
Bunge Corp.	(Pit)	03 83 03
Bunge Corp. Scale Track		03 84 00
Bunge Corp. Oil Spur		03 85 00
Bunge Corp.	(Rack)	03 85 01
Bunk Car Trk. Old Pwr. Hse. Spur		01 45 00
C & D Track		01 25 00
Cedar Point Elev.	(Spout)	50 02 01
City Roller Mill Track		03 70 00
Coach - North		01 47 00
Coach - South		01 48 00
Conditioning Track		01 37 00
Connection		01 24 00
Cottonwood Falls Elev. Spur Trk.		84 11 00
Cottonwood Falls Spur Track		84 97 00
DeBauge	(Door)	03 04 01
DeBauge	(Dock)	03 04 02
Drover Track		01 17 00
Eastbound Yard 1		01 01 00
Eastbound Yard 2		01 02 00
Eastbound Yard 3		01 03 00
Eastbound Yard 4		01 04 00
Eastbound Yard 5		01 05 00
Eastbound Yard 6		01 06 00
Eastbound Yard 7		01 07 00
Eastbound Yard 8		01 08 00
Eastbound Yard 9		01 09 00
Eastbound Yard 10		01 10 00
Eastbound Yard 11		01 11 00
Eastbound Yard 12		01 12 00
Eastbound Yard 13		01 13 00
Eastbound Yard 14		01 14 00
Eastbound Yard 15		01 15 00

East Leg Wye - Strong City		84 05 00
East Stock yard Lead		01 29 00
Elevator Track-Cedar Point		50 02 00
Elevator Track - Lebo		93 04 00
Elev. Spur Trk. - Strong City		84 01 00
Elev. Track - Elmdale		38 01 00
Elmdale Elevator	(Spout)	38 01 01 thru 02
Elm Street Elevator Track		03 30 00
Emporia Ready Mix Spur		03 01 00
Emporia Ready Mix	(Pit)	03 01 01
Emporia Whsl. Coffee Co.(Door)		03 61 10
Engine Lead - North		01 18 00
Engine Lead - South		01 19 00
First District Main Line Eastern Division		03 99 00
First District Main Line Middle Division		84 99 00
Fleetwood Spur Track		03 03 00
Fleetwood	(Dock)	03 03 01
Freight House No. 1		03 51 00
Freight House No. 2		03 52 00
Freight House No. 3		03 53 00
Freight House No. 3	(Dock)	03 53 01 thru 02
Freight House No. 6		03 56 00
Freight House No. 6	(Dock)	03 56 01
Freight House No. 7		03 57 00
Grangers Co-op Assn.	(Auger)	93 01 01 thru 02
Grangers Co-op Assn.	(Auger)	93 02 01
Grangers Co-op Assn.	(Spout)	93 02 02
Grangers Co-op Assn.	(Doors)	93 02 03 thru 04
Grangers Co-op Assn.	(Hose)	93 02 05
Grangers North Elev.	(Spout)	93 04 01
House Track		01 23 00
House Track-Cedar Point		50 01 00
House Track-North		02 21 00
House Track-South		02 22 00
House Track-Lebo		93 03 00
House Track-Lebo	(Open)	93 03 01
House Track-Lebo	(Dock)	93 03 02
House Track-Strong City		84 10 00
House Track-Strong City	(Dock)	84 10 01
House Track-Reading		17 02 00
House Track-Reading	(Open)	17 02 01
Howard Branch		01 69 00
I.B.P. T.O.F.C. Track "A"		03 10 00
I.B.P. T.O.F.C. Track "B"		03 11 00
I.B.P. T.O.F.C. Track "C"		03 12 00

I.B.P. T.O.F.C. Track "D"		03 13 00
I.B.P. Track No. 1		03 21 00
I.B.P. Track No. 1	(Racks)	03 21 01 thru 03
I.B.P. Track No. 1	(Open)	03 21 04
I.B.P. Track No. 2		03 22 00
I.B.P. Track No. 2	(Racks)	03 22 01 thru 03
I.B.P. Track No. 3		03 23 00
I.B.P. Track No. 3	(Doors)	03 23 01 thru 02
I.B.P. Track No. 3	(Open)	03 23 03
I.B.P. Track No. 4		03 24 00
I.B.P. Track No. 4	(Open)	03 24 01 thru 02
I.B.P. Track No. 4	(Spout)	03 24 03
I.B.P. Track No. 4	(Open)	03 24 04 thru 05
I.B.P. Track No. 5		03 25 00
Industrial Foods	(Door)	03 61 01
Industry Lead Track		03 06 00
Interstate Spur		03 05 00
Interstate Bakery	(Dock)	03 06 01
Interstate Bakery	(Hoses)	03 06 02 thru 04
Lower 13 Track		01 42 00
Lyon County REA	(Open)	03 57 01
Main Line, Cedar Point		50 99 00
Main Line, Clements		45 99 00
Main Line, Elmdale		38 99 00
Main Line, North-Emporia		02 99 00
Main Line, South-Emporia		02 98 00
Main Line, First Dist-Emporia		03 99 00
Main Line, Strong City		84 99 00
Main Line, Middle-Saffordville		75 98 00
Main Line, North-Saffordville		75 99 00
Main Line, Reading		17 99 00
Main Line, North-Neosho Rapids		53 99 00
Main Line, South-Neosho Rapids		53 98 00
Main Line, North-Lebo		93 99 00
Main Line, South-Lebo		93 98 00
Mark II Spur Track		03 82 00
Mark II Lumber	(Open)	03 82 01 thru 02
Middle Track, North		01 26 00
Middle Track, South		01 34 00
Modine Spur Track		03 02 00
Modine	(Doors)	03 02 01 thru 03
Modine	(Dock)	03 02 04

Neosho Rapids Elev.	(Hose)	53	02	01
Neosho Rapids Elev.	(Spout)	53	02	02
New "1" Track		01	56	00
North Bluestem Elev. Track		01	31	00
North Bluestem Elev.	(Pit)	01	31	01
North Coach Track		01	47	00
North Engine Lead		01	18	00
North Grain-Saffordville	(Spout)	75	01	01
North Grain-Saffordville	(Hose)	75	01	02
North House Track		02	21	00
North Middle Track		01	26	00
North Stockyard Track		01	27	00
North Storehouse Track		01	49	00
North Storehouse Track	(Door)	01	49	01
Old Power House Spur		01	45	00
Passing Track-Reading		17	01	00
Peak & Hatcher	(Dock)	03	08	01
Penny Track		03	40	00
Penny Ready Mix	(Pit)	03	40	01
			thru	02
Penny's Warehouse	(Doors)	03	57	20
			thru	21
Pocket Track		02	23	00
Reading Elevator	(Spout)	17	03	01
R.H. South Track		01	63	00
R.H. Stall No. 2		01	53	00
R.H. Stall No. 7		01	54	00
R.H. Track No. 1		01	64	00
R.H. Track No. 2		01	65	00
R.H. Track No. 3		01	66	00
R.H. Track No. 4		01	67	00
R.H. Track No. 5		01	68	00
R.H. Track No. 23		01	51	00
R.H. Track No. 24		01	52	00
Rip Track No. 2		01	38	00
Rip Track No. 3		01	39	00
Rip Track No. 4		01	40	00
Safeway Pet Food Track		03	14	00
Safeway Pet Food	(Doors)	03	14	01
			thru	04
Safeway Pet Food	(Pit)	03	15	01
Sand Pit Track		01	62	00
Sauder Ind. Spur Track		03	90	00
Sauder Industries	(Pit)	03	90	01
Scale Track		01	21	00
Siding-Clements		45	98	00
Siding-Strong City		84	98	00



South Coach		01 48 00
South Engine Lead		01 19 00
South House Track		02 22 00
South Middle Track		01 34 00
South Stockyard Track		01 33 00
South Storehouse Track		01 50 00
Spur Track-Elmdale		38 02 00
Spur Track-Clements		45 01 00
Stock Track		93 02 00
Stockyard Lead Track, East		01 29 00
Stockyard Lead Track, West		01 28 00
Stockyard Track, North		01 27 00
Stockyard Track, South		01 33 00
Storage Track No. 5		02 50 00
Storage Track No. 6		02 60 00
Storage Track No. 7		02 70 00
Storage Track No. 8		02 80 00
Storage Track-Saffordville		75 02 00
Storehouse Track, North		01 49 00
Storehouse Track, North	(Door)	01 49 01
Storehouse Track, South		01 50 00
Strong City Elev. Co.	(Spout)	84 01 01
Tail Track		03 08 00
Team-Cedar Point	(Open)	50 02 02
Teichgraeber Milling Co.	(Door)	03 30 01
Teichgraeber Milling Co.	(Hose)	03 30 02
Teichgraeber Milling Co.	(Open)	03 30 03
Teichgraeber Milling Co.	(Door)	03 30 04
Teichgraeber Milling Co.	(Pit)	03 30 05
Teichgraeber Milling Co.	(Spout)	03 30 06
Teichgraeber Fertilizer	(Hose)	03 57 10
Teichgraeber Fertilizer	(Open)	03 57 11
Teichgraeber Fertilizer	(Auger)	03 57 12
Teichgraeber Fertilizer East		03 70 01
	(Dock)	thru 02
Track No. 12		53 01 00
Track No. 2		53 02 00
Track No. 5		17 03 00
Transfer Track		01 20 00
Treating Plant No. 1		01 46 00
Treating Plant No. 2		01 36 00
Upper 13 Track		01 43 00
Waycar Track		01 16 00
Westbound Yard 3		02 03 00
Westbound Yard 4		02 04 00
Westbound Yard 5		02 05 00
Westbound Yard 6		02 06 00
Westbound Yard 7		02 07 00

Westbound Yard 8	02 08 00
Westbound Yard 9	02 09 00
Westbound Yard 10	02 10 00
Westbound Yard 11	02 11 00
Westbound Yard 12	02 12 00
Westbound Yard 13	02 13 00
Westbound Yard 14	02 14 00
Westbound Yard 15	02 15 00
Westbound Yard 16	02 16 00
Westbound Yard 17	02 17 00
Westbound Yard 18	02 18 00
Westbound Yard 19	02 19 00
West Leg Wye - Strong City	84 06 00
West Spur	02 20 00
Wheel Garden Track	01 41 00
Wye, East Leg-Strong City	84 05 00
Wye Spur Track - Strong City	84 07 00
Wye, West Leg - Strong City	84 06 00
Yard Track - Strong City	84 02 00
Yard Track - Strong City	84 03 00
Yard Track - Strong City	84 04 00
Yard Spur Track - Strong City	84 08 00
Yard Spur Track - Strong City	84 09 00

0001(0)

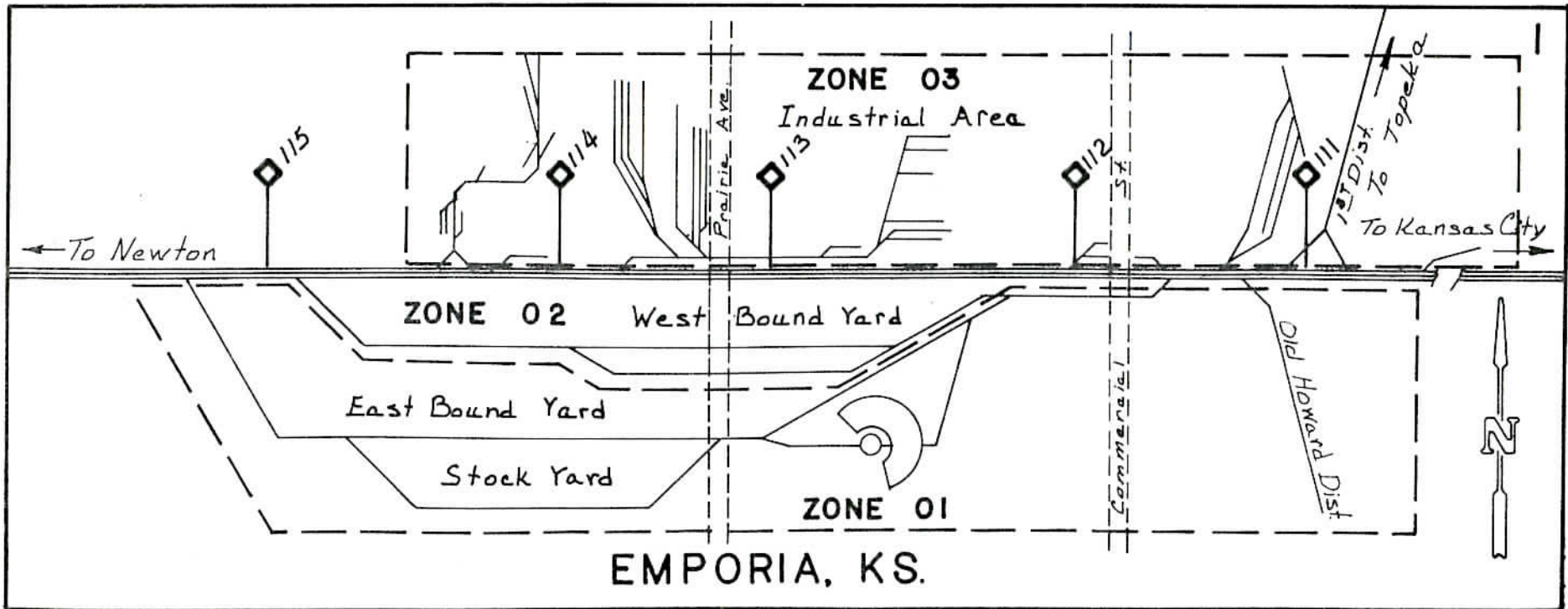

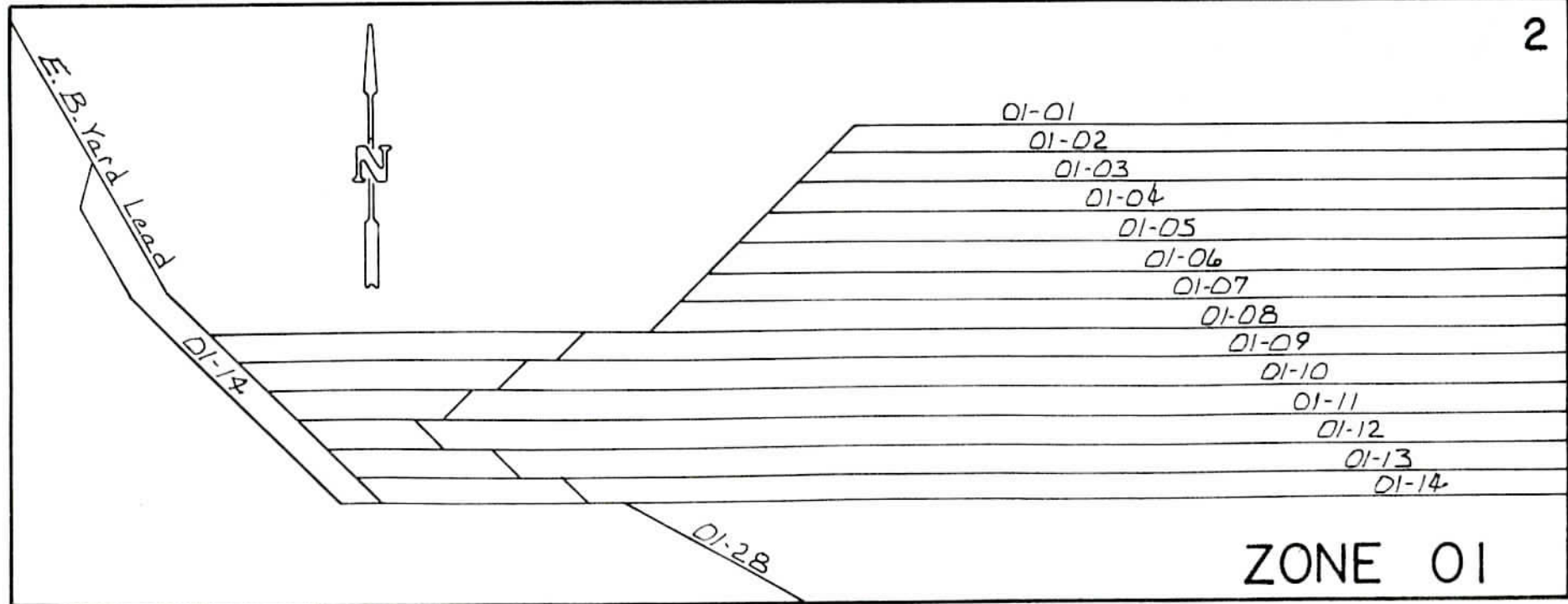



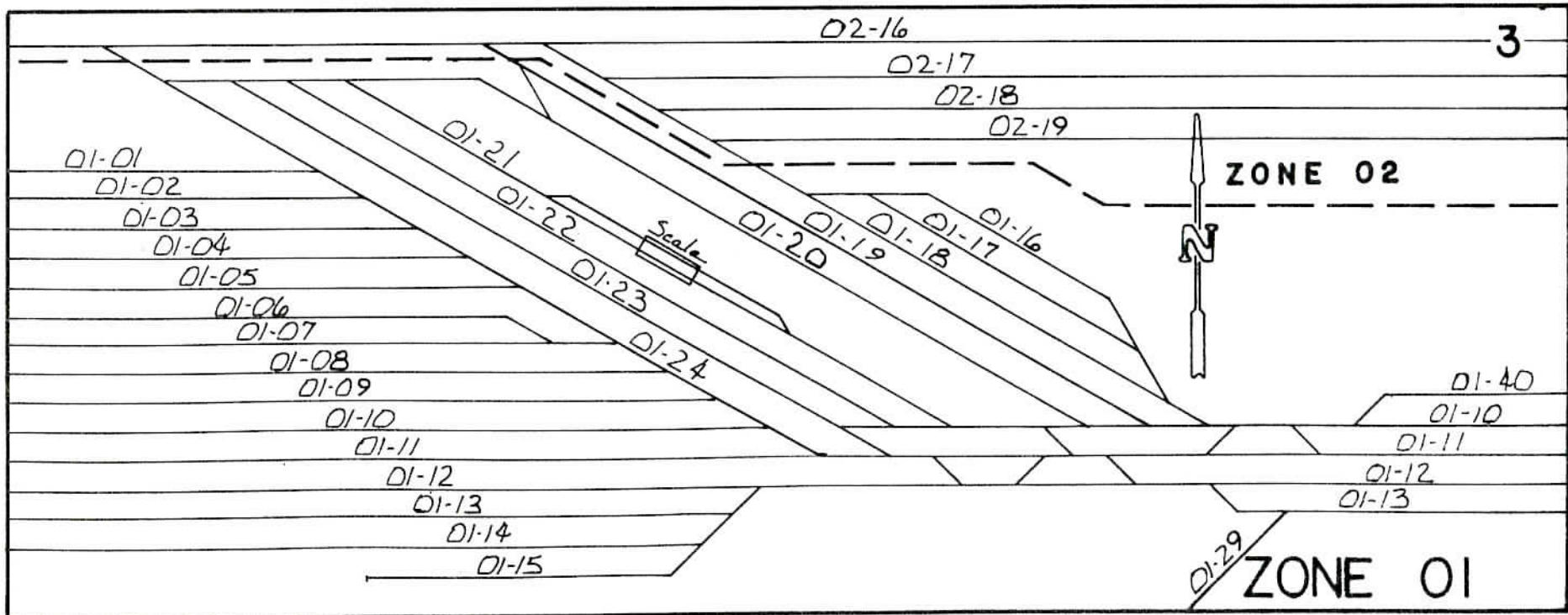

4

# STOCKYARDS



01-25

01-26

01-27

01-27

01-29

01-28

Pit  
01-31 [01]

Bluestem Elev.

01-32 [01]  
Spout

01-33

01-34

ZONE 01

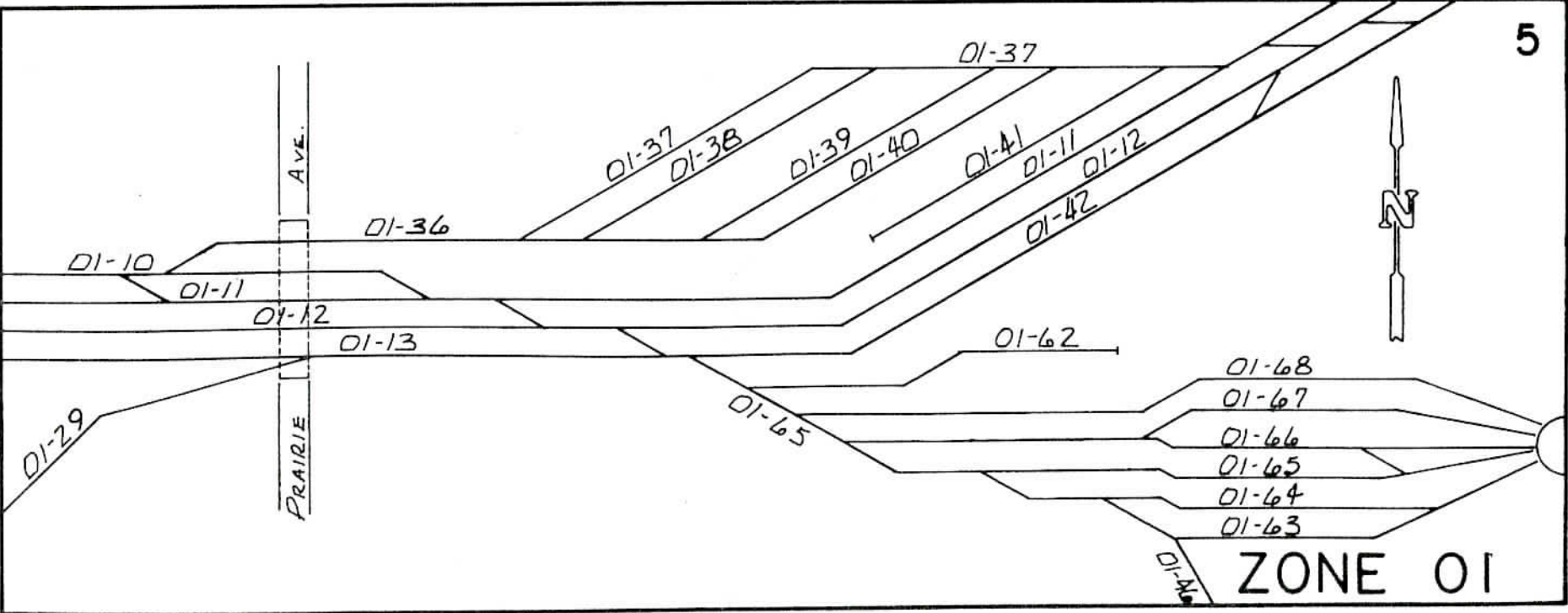

ZONE 01

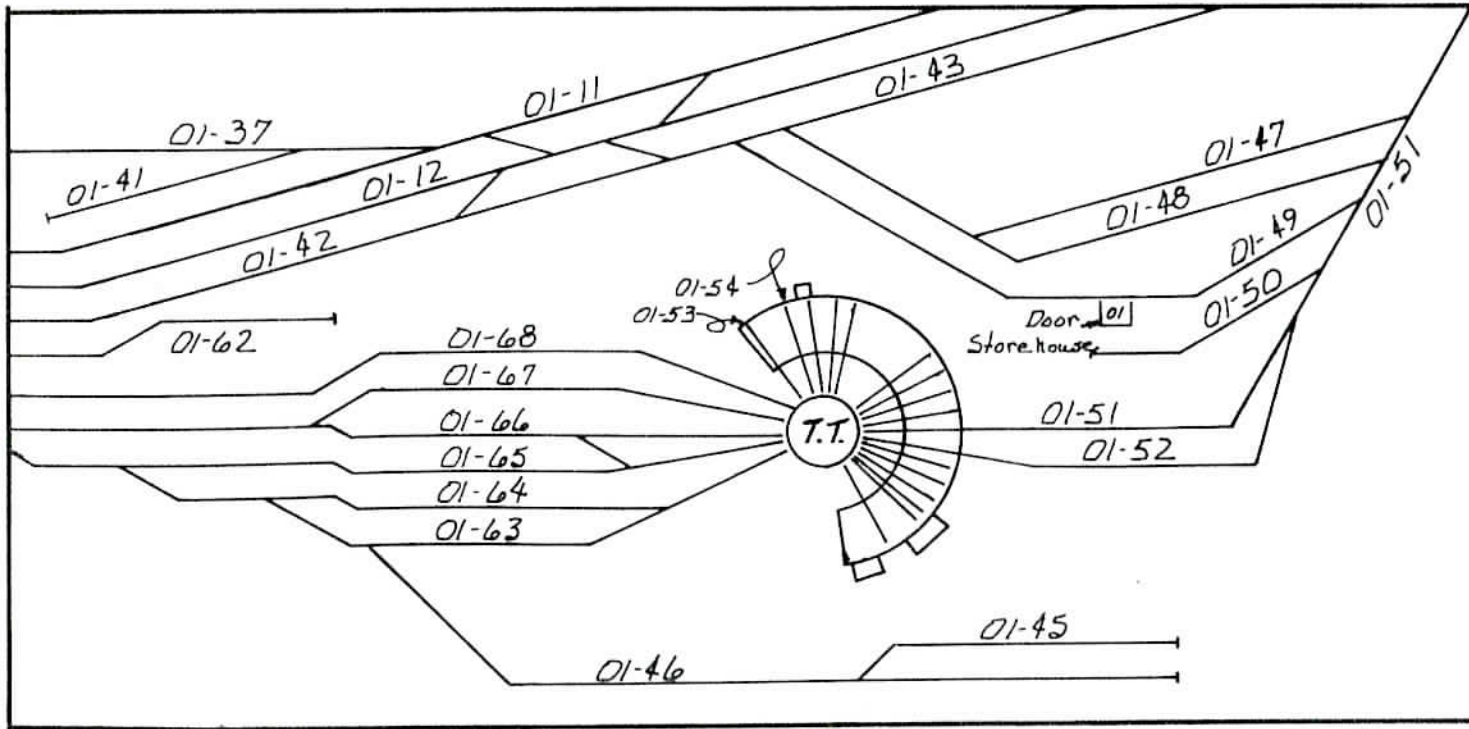

ZONE 01

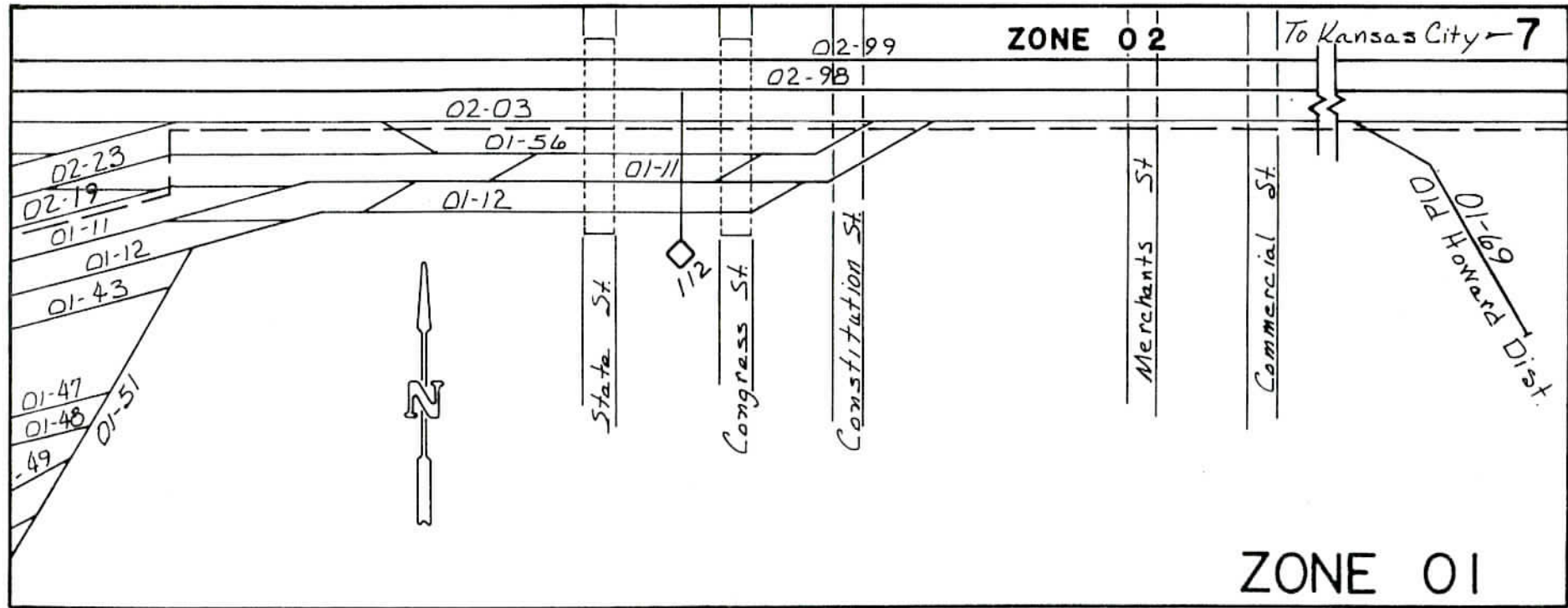



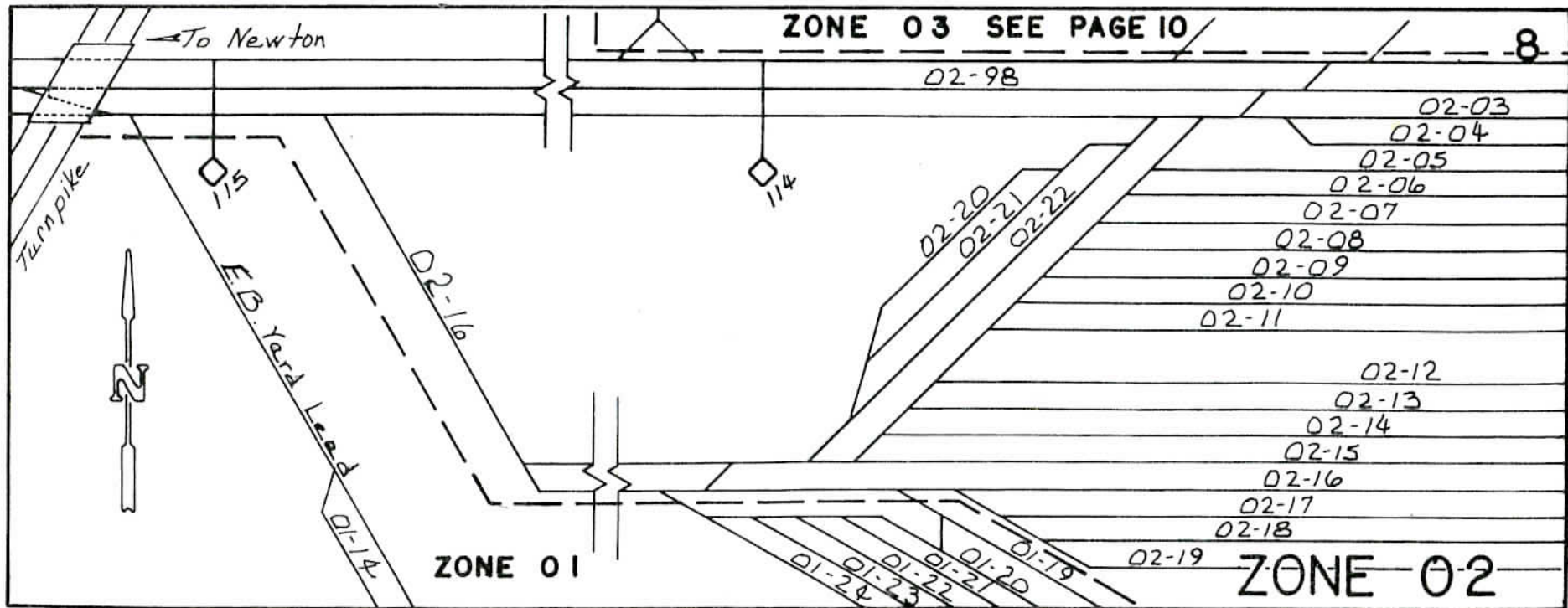

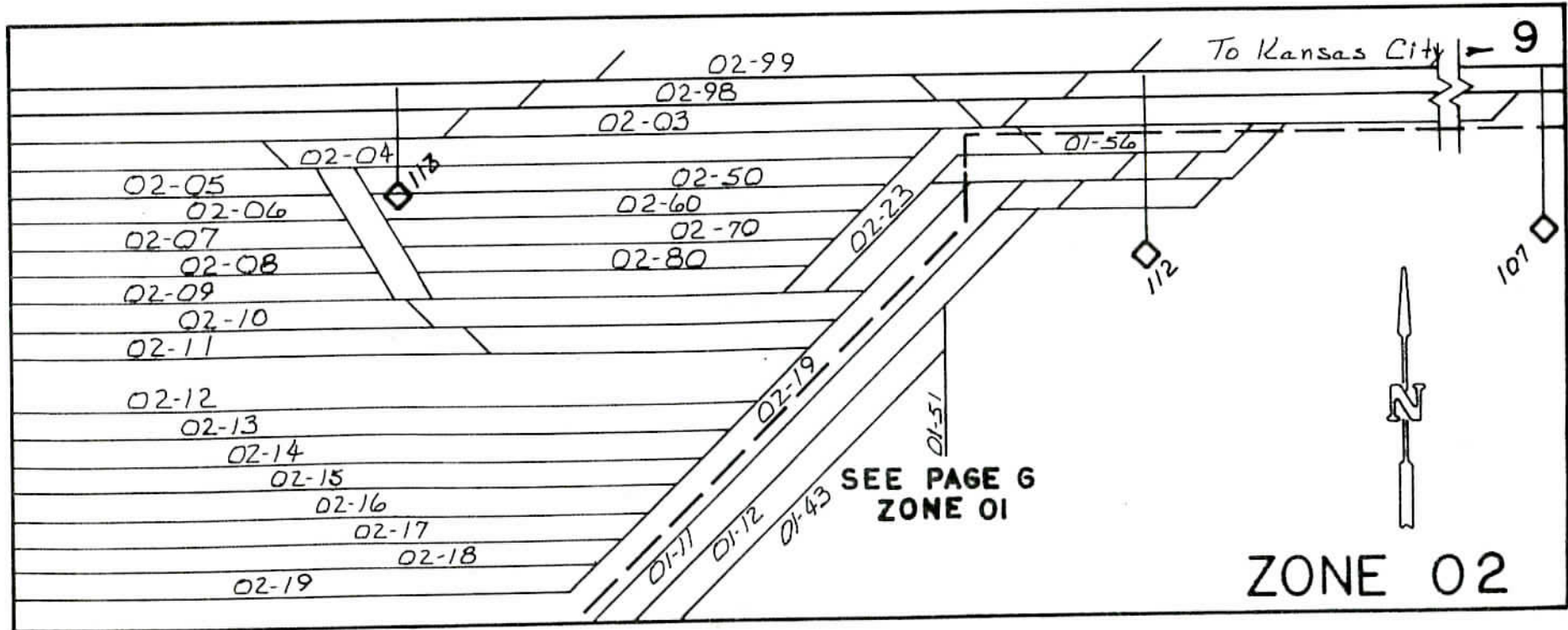

02-99

To Kansas City → 9

02-98

02-03

01-56

02-04



02-50

02-05

02-60

02-06

02-70

02-07

02-80

02-08

02-09

02-10

02-11

02-12

02-13

02-14

02-15

02-16

02-17

02-18

02-19

SEE PAGE 6  
ZONE 01

ZONE 02





SAFeway  
Pet Food Plant

Doors  
01 02 03 04

03-14

03-15

01 Pit

03-06

03-01

01 Pit

Emporia  
Ready  
Mix

Graphic Arts

Switch  
Spiked

U.S. 50

HIGHWAY

03-06

12th St.

Match  
Point

03-06

Debaunge  
Dock Door

Fleetwood  
Dock

03-05

03-02

01 03-03

04 03 02 01

Dock Doors  
Modine

04 03 02 01

Bunge Corp.  
West Elev.

03-07

Spout  
11

114

03-06

04 03 02 01

03-06

04 03 02 01

03-05

04 03 02 01

03-02

04 03 02 01

Hases Dock

Interstate

Bakery

02-99

To Newton

ZONE 03

Iowa Beef Packers  
T.O.F.C. Tracks

03-13  
03-12  
03-11  
03-10

Iowa Beef Packers Tracks  
03-25

Open 03 04 | Spout & Open 7 03 02 | 03-23 02 01 | Doors 03 02 | 03-22 Racks 03 02 | 03-21 03 02 | 04 01 | Open Racks

To Newton 03-09

03-10

03-08

02-99

Prarie St.

Peak & Hatcher  
Dock 01

113

To Kansas City

ZONE 03



11



Penny  
READY  
MIX

Pits  
03-40

Cement  
Sand

Penny  
Whse.

Doors  
21 20

TEICHGRAEBER  
Fertilizer

Auger Open Hose  
12 11 10 03-57

LYON  
County  
REA

Open  
01

TEICHGRAEBER  
Milling Co.

Spout Pit Door Open

06 05 04 03 03-30 02 01

Hose Door

03-08

03-56 01 11 Dock

Dock  
02 01 03-53

03-52

03-51

02-99

To Kansas City →

← To Newton

ZONE 03



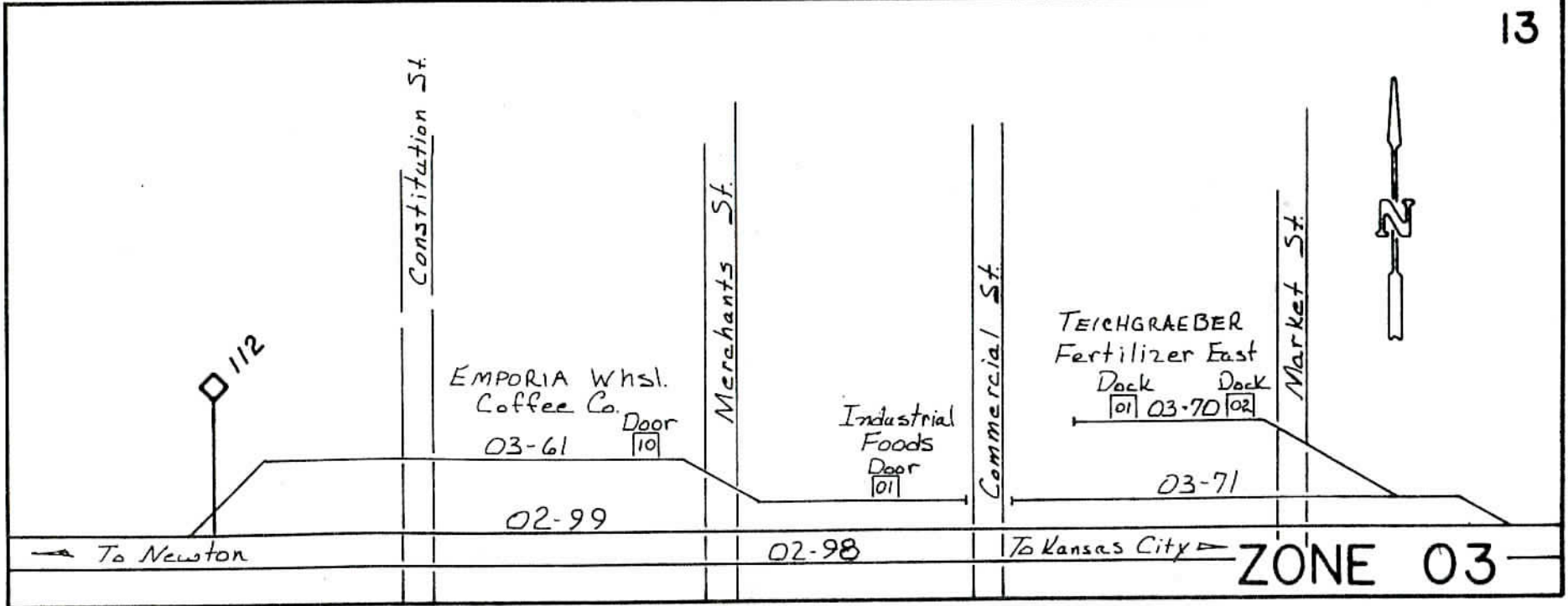

ZONE 03

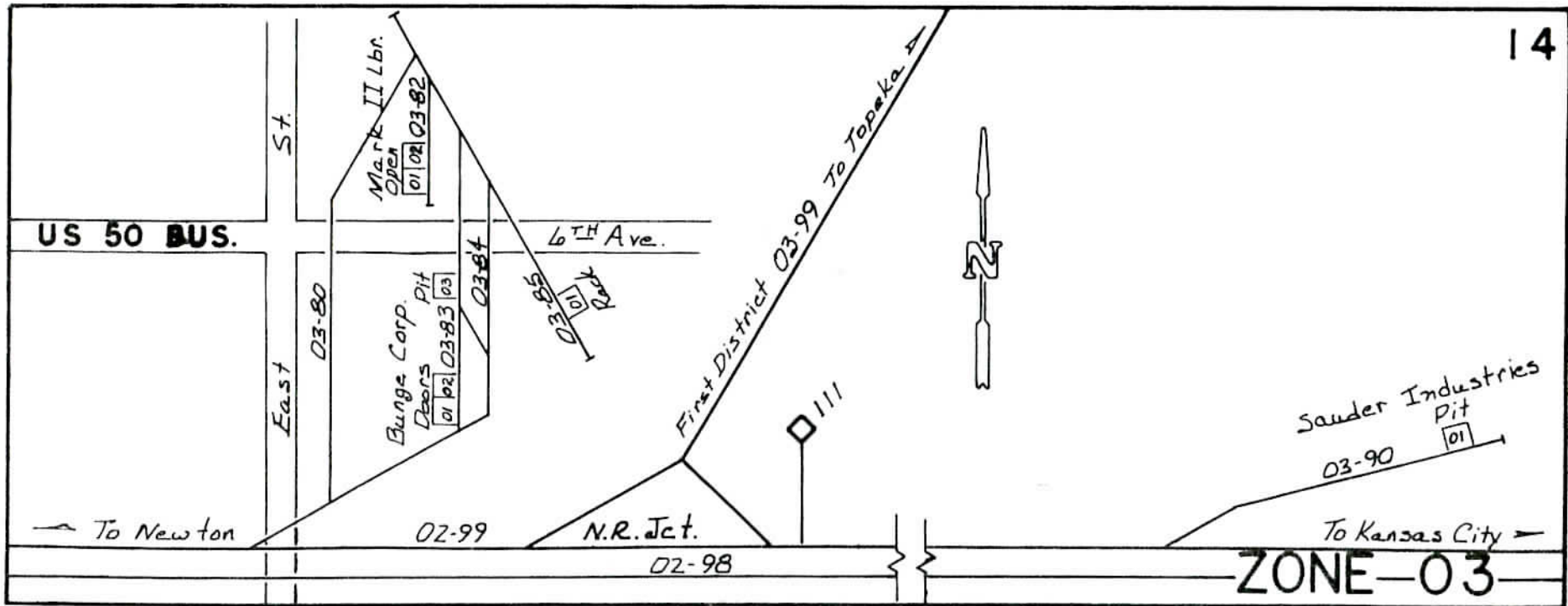

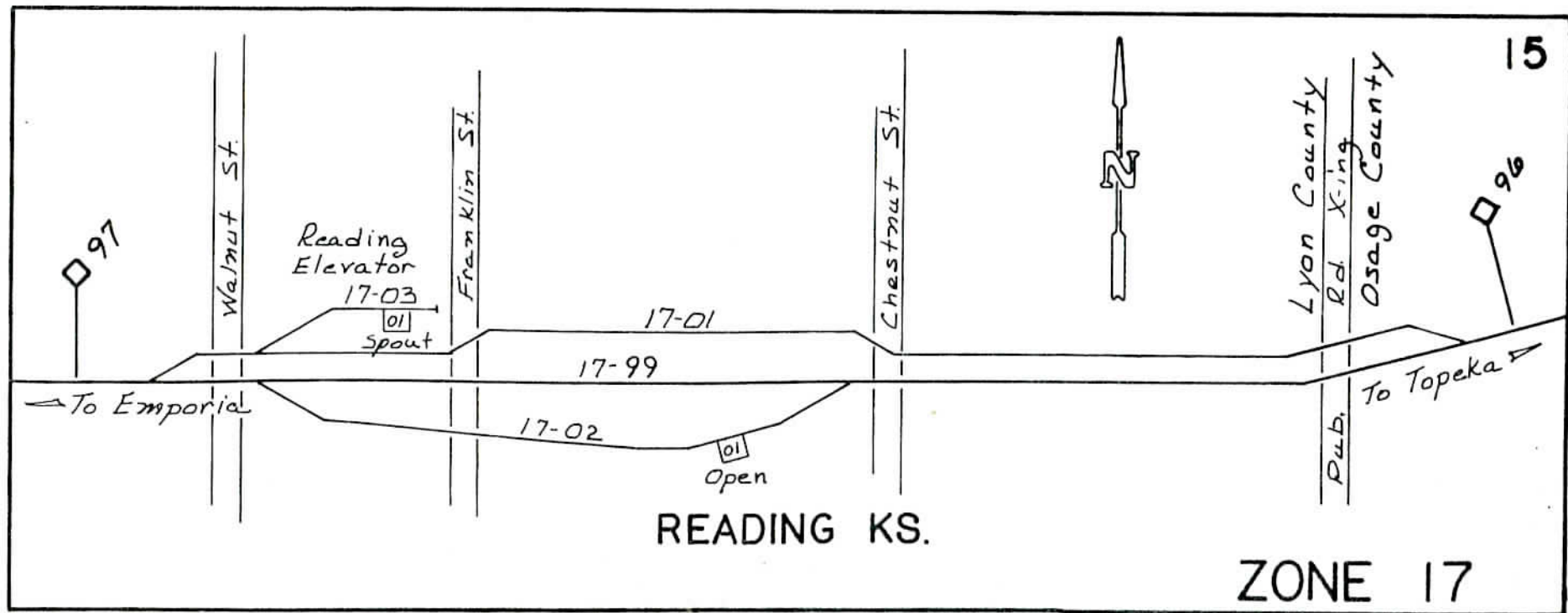

97

Walnut St.

Reading Elevator  
17-03  
Spout  
01

Franklin St.

17-01

17-99

Chestnut St.



Lyon County  
Rd. X-ing  
Osage County

Pub.

To Topeka

96

15

To Emporia

READING KS.

ZONE 17

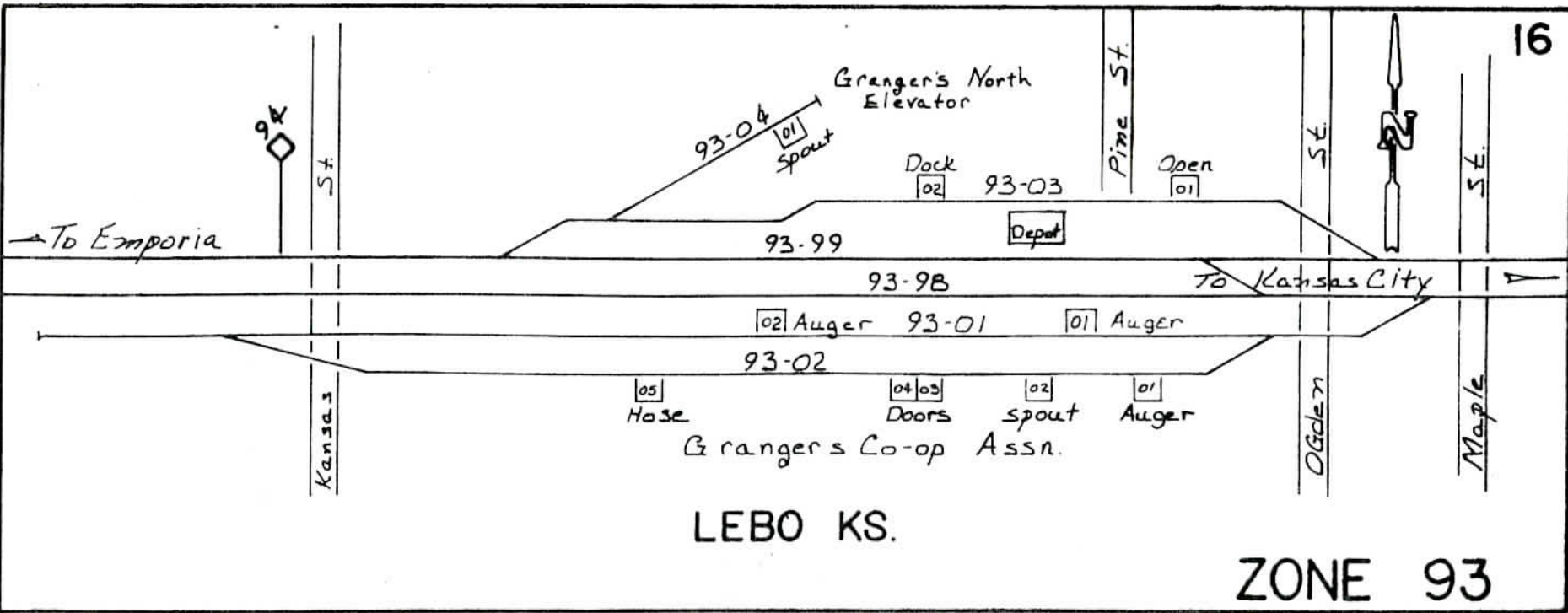

17

102

Neosho St.

Main St.

53-99

Hwy



101

53-98

← To Emporia

To Kansas City →

53-01

53-02

02

01

Spout

Hose

Neosho Rapids Elev.

K-130

NEOSHO RAPIDS KS.

ZONE 53



North Grain

Hose 02 75-01 Spout 01

75-02

75-99

Rd. Xing

75-02

75-98

123

← To Newton

To Emporia →

Pub.

SAFFORDVILLE KS.



ZONE 75

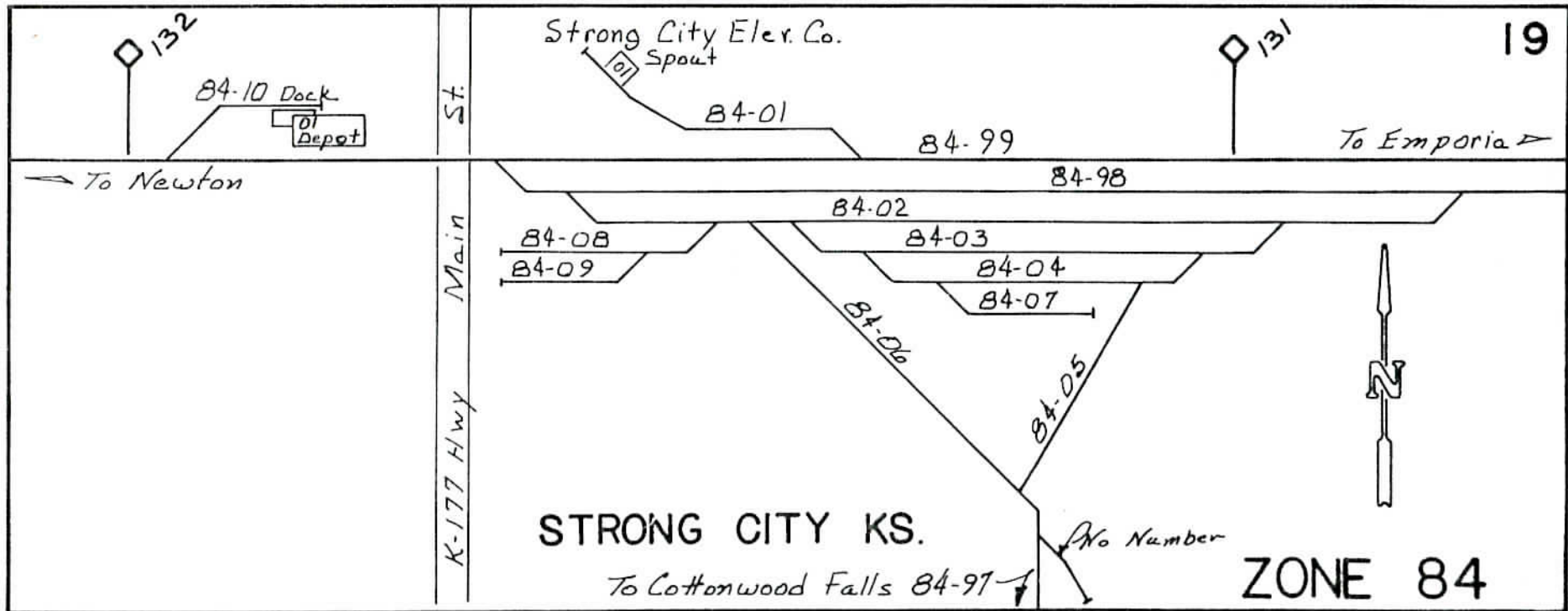

20

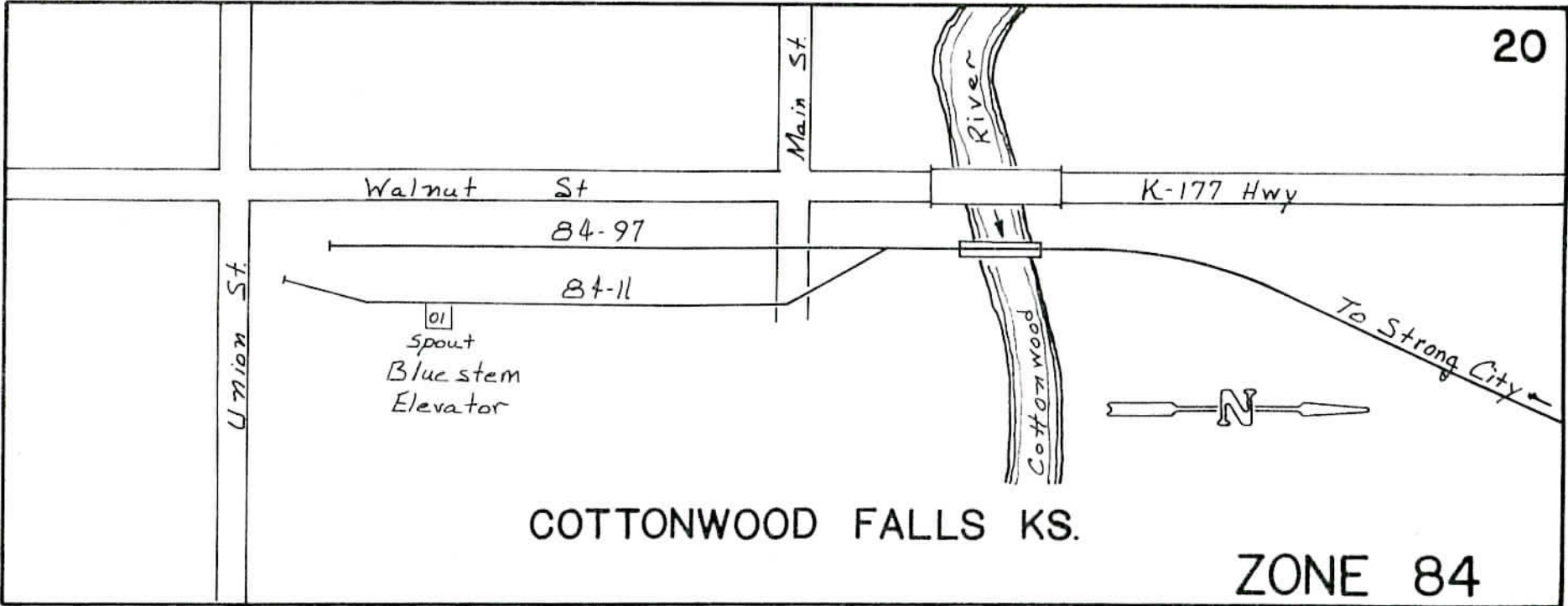

Walnut St

84-97

84-11

01

Spout  
Blue stem  
Elevator

Main St

River

K-177 Hwy

Cottonwood



To Strong City

COTTONWOOD FALLS KS.

ZONE 84

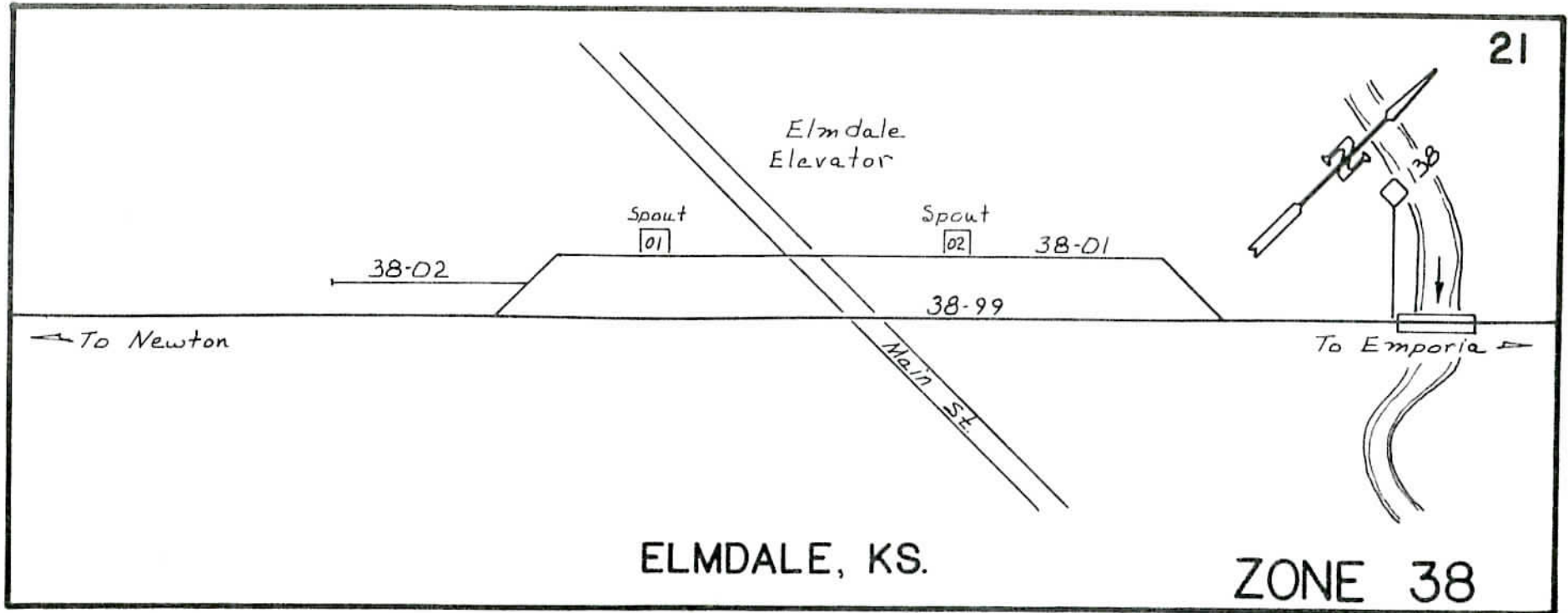

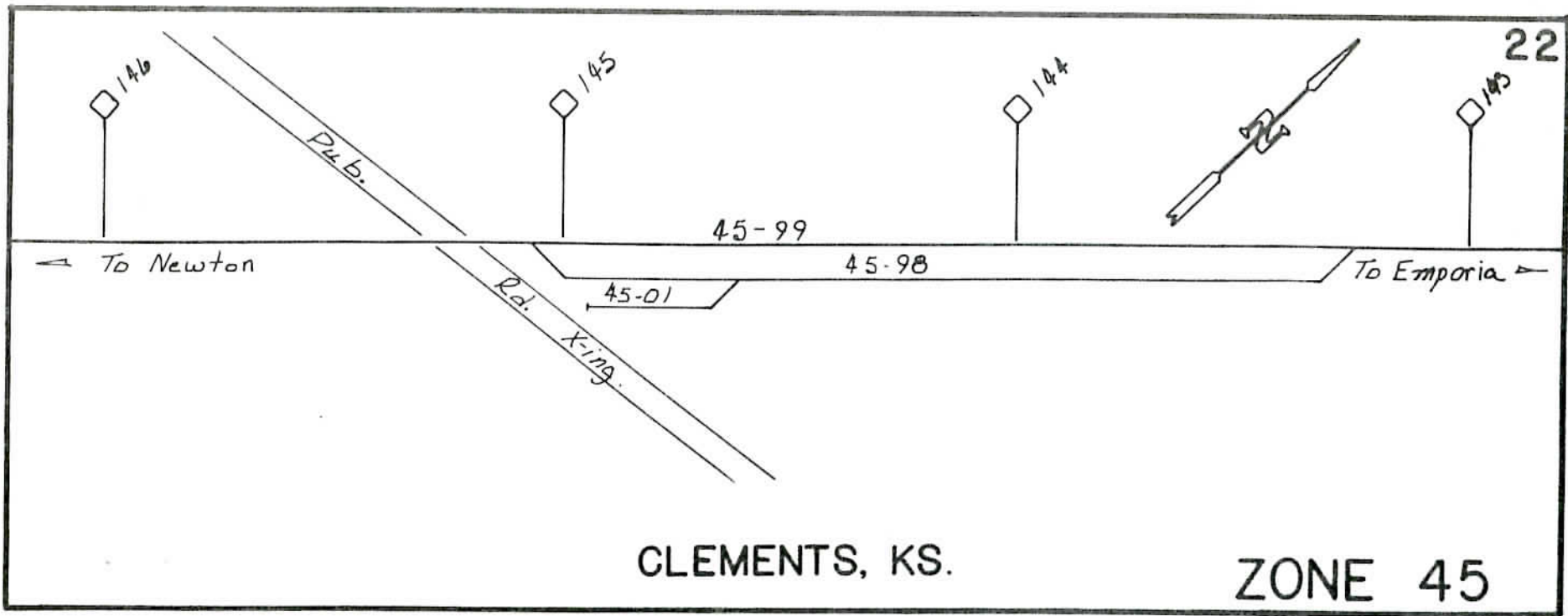

22

146

145

144

143

Pub.

Rd.

X-ing.

45-99

45-98

45-01

To Newton

To Emporia

CLEMENTS, KS.

ZONE 45



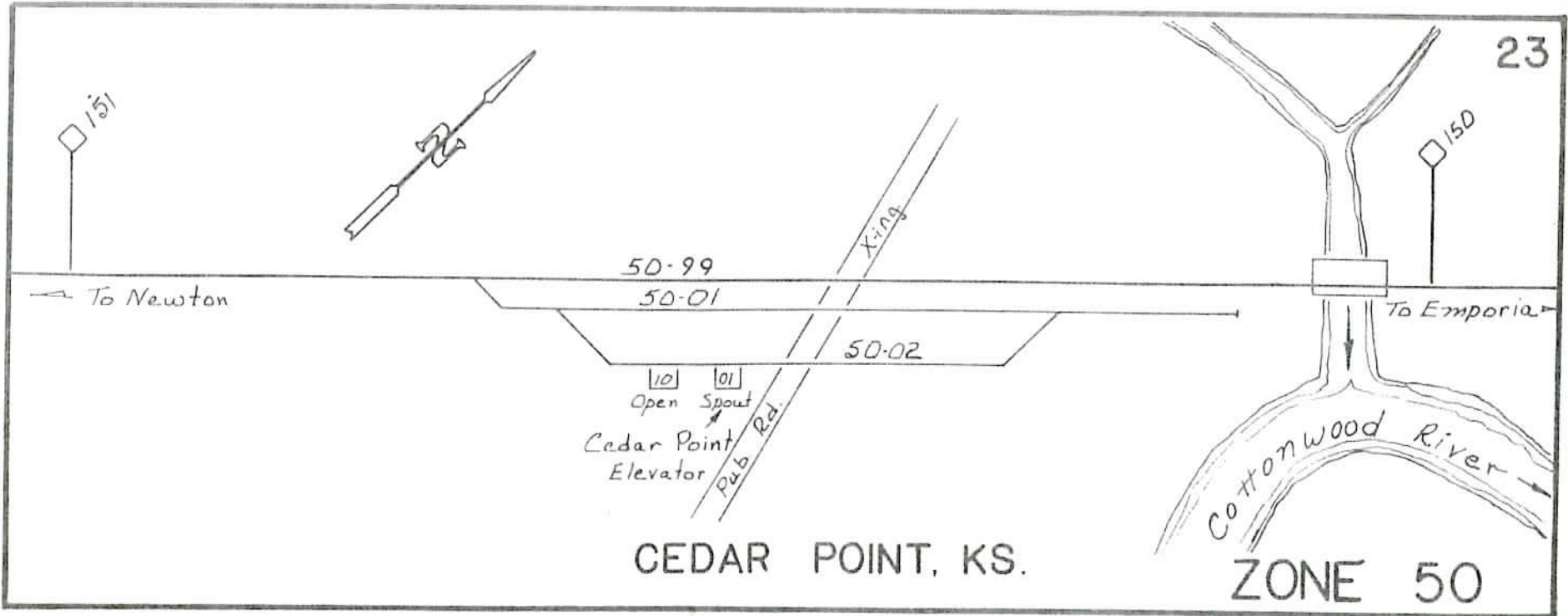

CEDAR POINT, KS.

ZONE 50