

**Middle Division CLIC Bulletin No. 2**

**THE ATCHISON, TOPEKA and SANTA FE RAILWAY COMPANY**

**- CLIC -**

**CAR LOCATION and INVENTORY CONTROL  
ARKANSAS CITY, KANSAS**

**Issue Date: August 24, 1972**

**E. Gillmore, Supt.  
Newton, Kansas**



(1) All switching in the yard and at industries will be performed by use of switch lists furnished by Control Clerk unless otherwise instructed by yardmaster.

(2) Disposition to be made of car will be shown on list opposite car number. This disposition will be indicated by means of CLIC number.

(3) Yardmaster will indicate on switch list where cuts, if any, are to be made, as follows:

1st Cut-----  
2nd Cut-----  
etc.

(4) Engine Foreman will switch cars according to list marked by yardmaster. Should Engine Foreman switch or place a car to some location other than that marked on list, he must promptly advise yardmaster as to change.

(5) Engine Foreman will promptly advise yardmaster of disposition made of car or cars not shown on list.

(6) Engine Foreman must notify yardmaster immediately of any

exceptions taken to list, such as no car, car not on list or car out of line.

(7) If any industry requests service not shown on foreman's list, before doing so, engine foreman must secure permission from yardmaster.

(8) If a car other than one ordered to industry by yardmaster is spotted, Engine Foreman must notify yardmaster of this substitution, informing him which car was furnished.

(9) Yardmaster should be aware of all switching moves made in the yard or at industries, and Engine Foremen must advise yardmaster of any extra moves.

(10) Engine Foremen will show on switch list the time switching is completed at an industry.

(11) After switching is completed Engine Foreman will return his copy of switch list to yardmaster. He will show time completed as well as his name.

(12) For observation and pre-caution, the following codes may be shown on switch list preceding car initial:

- Bl - Bad Order
- XX - Do Not move this car
- EX - Explosive
- DN - Dangerous
- HE - Head End Movement Only
- RE - Rear End Movement Only
- EP - Empty placed for loading
- CU - Car completely unloads
- PU - Car Partially Unloads
- RS - ReSpot or reloading
- TU - Turn car and respot
- WH - Weigh
- HB - Hold for billing
- HD - Hold for disposition

(13) Whenever Bad Order cars are switched out, Yardmaster will advise Control Clerk immediately car initial and number and track car was switched to.

The function of the Control Clerk in the yard office is to keep track of the location of every car in the Arkansas City area. In order to accomplish this, Yardmasters must advise Control Clerk of every move made by every engine. Consequently, the engine foremen must advise the yardmaster of all exceptions.

<u>NAME</u>	<u>CLIC NO.</u>
Allied Impl. Co. (Impl.)	01 43 01
Allied Impl. Co. (Tractors)	01 44 10
Apco Oil Co.	03 11 00
Ark Valley Dist.	04 06 10
Benson Lumber Co.	01 43 01
B & W Television	01 43 01
Blatchford Impl. Co. (Impl.)	01 43 01
Blatchford Impl. Co. (Tractors)	01 44 10
Bryant Hardware Co.	01 43 01
Burro Crane Trk	01 19 00
Business Car Spur	01 40 00
Chilocco Indian School	05 01 01
Derrick Spur	02 29 00
Dixie Portland Flr. Mill Lead	03 06 00
Dixie Portland Flr. Mill Trestle	03 05 01
Dixie Portland Flr. Mill Trk 1	03 01 01
Dixie Portland Flr. Mill Trk 1	03 01 02
Dixie Portland Flr. Mill Trk 1	03 01 03
Dixie Portland Flr. Mill Trk 1	03 01 04
Dixie Portland Flr. Mill Trk 1	03 01 05
Dixie Portland Flr. Mill Trk 1	03 01 06
Dixie Portland Flr. Mill Trk 1	03 01 07
Dixie Portland Flr. Mill Trk 1	03 01 08
Dixie Portland Flr. Mill Trk 1	03 01 09
Dixie Portland Flr. Mill Trk 2	03 02 01
Dixie Portland Flr. Mill Trk 2	03 02 02
Dixie Portland Flr. Mill Trk 2	03 02 03
Dixie Portland Flr. Mill Trk 2	03 02 04
Dixie Portland Flr. Mill Trk 2	03 02 05
Dixie Portland Flr. Mill Trk 2	03 02 06
Dixie Portland Flr. Mill Trk 2	03 02 07
Dixie Portland Flr. Mill Trk 2	03 02 08
Dixie Portland Flr. Mill Trk 2	03 02 09
Dixie Portland Flr. Mill Trk 3	03 03 01
Dixie Portland Flr. Mill Trk 3	03 03 02
Dixie Portland Flr. Mill Trk 3	03 03 03
Dixie Portland Flr. Mill Trk 3	03 03 04
Dixie Portland Flr. Mill Trk 3	03 03 05
Dixie Portland Flr. Mill Trk 3	03 03 06
Dixie Portland Flr. Mill Trk 3	03 03 07
Dixie Portland Flr. Mill Trk 3	03 03 08
Dixie Portland Flr. Mill Trk 3	03 03 09
Dixie Portland Flr. Mill Trk 4 (Elevator)	03 04 01
Dixie Portland Flr. Mill Trk 4 (Elevator)	03 04 02
DSK Dock	02 31 00
East Ice House	01 39 00
East Lead	02 40 00
East Rip	02 21 00
East Waycar Trk	01 17 00
Fuel Trk (Tank Cars)	02 43 00

<u>NAME</u>	<u>CLIC NO.</u>
Gordon-Piatt	06 04 10
Grant Lumber Co.	01 43 01
Gravel Spur	01 30 00
Greif Bros.	06 05 01
Greif Bros. Concrete Dock	06 04 06
Greif Bros. Door 1	06 04 01
Greif Bros. Door 2	06 04 02
Greif Bros. Door 3	06 04 03
Greif Bros. Door 4	06 04 04
Greif Bros. Door 5	06 04 05
Hackney Farmers Union Coop (Bag Fertz)	06 01 03
Hackney Farmers Union Coop (Elevator)	06 01 01
Hackney Farmers Union Coop (Liquid Fertz)	06 01 02
Interchange	01 34 00
Kansas Gas & Electric	03 11 00
Lav Trk	02 30 00
Ledger Wood Spur	02 22 00
Line House	02 42 00
Lye Bye	01 32 00
Madison Maytag Co.	01 43 01
Main Line	01 99 00
Material Yard Dock	01 18 00
Mauer Neuer Dock	04 03 01
Mauer Neuer Dock	04 03 02
Mauer Neuer Frozen Meat	04 02 01
Mauer Neuer Hide Loading	04 03 03
Mauer Neuer Lard & Tallow	04 02 02
Mauer Neuer Tankage	04 02 03
Mauk Feed & Seed	04 07 01
Mercer Impl. Co. (Impl.)	01 43 01
Mercer Impl. Co. (Tractors)	01 44 10
Middle	01 35 00
Middle Lead	02 39 00
Midland Valley Trk 1	03 09 00
Midland Valley Trk 2	03 08 00
MP ICD	03 11 00
MP ICD	03 12 00
Mtl. Yard A	01 25 00
Mtl. Yard B	01 24 00
Mtl. Yard C	01 23 00
Mtl. Yard D	01 22 00
Mtl. Yard E	01 21 00
Mtl. Yard F	01 20 00
Mtl. Yard 1	01 26 00
Mtl. Yard 2	01 27 00
Mtl. Yard 3	01 28 00
Mtl. Yard Lead	01 29 00
Myers Materials Co.	04 04 01
New Auto Dock	01 42 01
New Era Mill	03 10 00

<u>NAME</u>	<u>CLIC NO.</u>
North Spur	01 31 00
OK Feed & Grain	03 11 00
Old Auto Dock	01 44 10
Old Main Line	02 12 00
Old Pass Trk	01 90 00
Old Yard 10	02 13 00
Old Yard 11	02 14 00
Old Yard 12	02 15 00
Old Yard 13	02 16 00
Old Yard 14	02 17 00
Old Yard 15	02 18 00
Old Yard 16 (Coach)	02 19 00
Pile Driver Spur	02 28 00
Powers Roofing	01 43 01
Public Whse. Trk	01 45 01
Ranney Davis Merc. Co.	01 43 01
Roundhouse Lead	02 46 00
Roundhouse Trk 1	02 24 00
Roundhouse Trk 2	02 25 00
Roundhouse Trk 3	02 26 00
Roundhouse Trk 4	02 27 00
Runaround	01 14 00
Runaround Trk	06 02 00
Sand Spur	02 38 00
Scale Trk	01 36 00
Shell Lead	02 51 00
Short Pass	02 45 00
Short Pass	01 46 00
Short Spur	06 07 00
Siding	01 98 00
Sixth Street Lead	04 01 00
Skyline Homes	04 05 01
SLSF ICD	03 10 00
Smith-Moon Steel	06 06 01
South Lead	02 50 00
South Spur	01 33 00
Storage Lead	03 07 00
Storehouse Lead	02 44 00
Strother Field Lead	06 03 00
SW Bell Telephone Co. (Poles)	03 11 00
Tank Shop Trk 1	02 36 00
Tank Shop Trk 2	02 35 00
Tank Shop Trk 3	02 34 00
Tank Shop Trk 4	02 33 00
Tank Shop Trk 5	02 32 00
Team Trk	01 43 00
TOFC Trk	01 42 00
Traveler Publishing Co.	01 44 10
Trk 51	01 41 00
Two Rivers Coop (Fertz)	01 44 07
Two Rivers Coop (N. Whse. Feed)	01 44 05
Two Rivers Coop (N. Whse. Feed)	01 44 06
Two Rivers Coop (Open Area Salt)	01 44 03



<u>NAME</u>	<u>CLIC NO.</u>
Two Rivers Coop (Open Area SB Meal)	01 44 04
Two Rivers Coop (S. Whse. Feed and Bag Fertz)	01 44 01
Two Rivers Coop (S. Whse. Feed and Bag Fertz)	01 44 02
Waldeck Argico Fertz. Svc.	04 06 01
Water Spur	01 15 00
Waycar Trk	01 37 00
Western Mfg. Co.	06 05 10
West Ice House	01 38 00
West Lead	02 37 00
West Rip	02 20 00
West Waycar Trk	01 16 00
West 2	02 11 00
West 3	02 10 00
West 4	02 09 00
West 5	02 08 00
West 6	02 07 00
West 7	02 06 00
West 8	02 05 00
West 9	02 04 00
West 9½	02 03 00
West 10	02 02 00
West 11	02 01 00
Wheel Hoist	02 23 00
White Coffee Co.	01 43 01
Wright Burton Hardware	01 43 01
Woods Lumber Co. (Other)	01 43 01
Woods Lumber Co. (Paneling)	01 44 10
Yard Trk 1	01 01 00
Yard Trk 2	01 02 00
Yard Trk 3	01 03 00
Yard Trk 4	01 04 00
Yard Trk 5	01 05 00
Yard Trk 6	01 06 00
Yard Trk 7	01 07 00
Yard Trk 8	01 08 00
Yard Trk 9	01 09 00
Yard Trk 10	01 10 00
Yard Trk 11	01 11 00
Yard Trk 12	01 12 00
Yard Trk 13	01 13 00

ZONE 1

<u>CLIC NO.</u>	<u>NAME</u>
01 01 00	Yard Trk 1
01 02 00	Yard Trk 2
01 03 00	Yard Trk 3
01 04 00	Yard Trk 4
01 05 00	Yard Trk 5
01 06 00	Yard Trk 6
01 07 00	Yard Trk 7
01 08 00	Yard Trk 8
01 09 00	Yard Trk 9
01 10 00	Yard Trk 10
01 11 00	Yard Trk 11
01 12 00	Yard Trk 12
01 13 00	Yard Trk 13
01 14 00	Runaround
01 15 00	Water Spur
01 16 00	West Waycar Trk
01 17 00	East Waycar Trk
01 18 00	Mtl. Yard Dock
01 19 00	Burro Crane Trk
01 20 00	Mtl. Yard F
01 21 00	Mtl. Yard E
01 22 00	Mtl. Yard D
01 23 00	Mtl. Yard C
01 24 00	Mtl. Yard B
01 25 00	Mtl. Yard A
01 26 00	Mtl. Yard 1
01 27 00	Mtl. Yard 2
01 28 00	Mtl. Yard 3
01 29 00	Mtl. Yard Lead
01 30 00	Gravel Spur
01 31 00	North Spur
01 32 00	Lye Bye
01 33 00	South Spur
01 33 01	Haynes Concrete
01 34 00	Interchange
01 35 00	Middle
01 36 00	Scale Trk
01 37 00	Waycar Trk
01 38 00	West Ice House
01 39 00	East Ice House
01 40 00	Business Car Spur
01 41 00	# 51 Trk
01 42 00	TOFC Trk
01 42 01	New Auto Dock
01 43 01	Team Trk
01 44 01	Two Rivers Coop (S. Whse. Feed & Bag Fertz)
01 44 02	Two Rivers Coop (S. Whse. Feed & Bag Fertz)
01 44 03	Two Rivers Coop (Open Area Salt)

ZONE 1 (Cont'd)

<u>CLIC NO.</u>	<u>NAME</u>
01 44 04	Two Rivers Coop (Open Area SB Meal)
01 44 05	Two Rivers Coop (N. Whse. Feed)
01 44 06	Two Rivers Coop (N. Whse. Feed)
01 44 07	Two Rivers Coop (Fertz)
01 44 10	Old Auto Dock
01 45 01	Public Whse. Trk
01 46 00	Short Pass

MISC.

01 90 00	Old Pass Trk
01 99 00	Main Line
01 98 00	Siding

ZONE 2

<u>CLIC NO.</u>	<u>NAME</u>
02 01 00	West 11
02 02 00	West 10
02 03 00	West 9½
02 04 00	West 9
02 05 00	West 8
02 06 00	West 7
02 07 00	West 6
02 08 00	West 5
02 09 00	West 4
02 10 00	West 3
02 11 00	West 2
02 12 00	Old Main Line
02 13 00	Old Yard 10
02 14 00	Old Yard 11
02 15 00	Old Yard 12
02 16 00	Old Yard 13
02 17 00	Old Yard 14
02 18 00	Old Yard 15
02 19 00	Old Yard 16 (Coach)
02 20 00	West Rip
02 21 00	East Rip
02 22 00	Ledger Wood Spur
02 23 00	Wheel Hoist
02 24 00	Roundhouse Trk 1
02 25 00	Roundhouse Trk 2
02 26 00	Roundhouse Trk 3
02 27 00	Roundhouse Trk 4
02 28 00	Pile Driver Spur
02 29 00	Derrick
02 30 00	Lav Trk
02 31 00	DSK Dock

ZONE 2 (Cont'd)

<u>CLIC NO.</u>	<u>NAME</u>
02 32 00	Tank Shop Trk 5
02 33 00	Tank Shop Trk 4
02 34 00	Tank Shop Trk 3
02 35 00	Tank Shop Trk 2
02 36 00	Tank Shop Trk 1
02 37 00	West Lead
02 38 00	Sand Spur
02 39 00	Middle Lead
02 40 00	East Lead
02 41 00	Fuel Rack
02 42 00	Line House
02 43 00	Fuel Trk (Tank Cars)
02 44 00	Storehouse Lead
02 45 00	Short Pass
02 46 00	Roundhouse Lead
02 50 00	South Lead
02 51 00	Shell Lead

ZONE 3

<u>CLIC NO.</u>	<u>NAME</u>
03 01 01	Dixie Port. Flr. Mill Trk 1
03 01 02	Dixie Port. Flr. Mill Trk 1
03 01 03	Dixie Port. Flr. Mill Trk 1
03 01 04	Dixie Port. Flr. Mill Trk 1
03 01 05	Dixie Port. Flr. Mill Trk 1
03 01 06	Dixie Port. Flr. Mill Trk 1
03 01 07	Dixie Port. Flr. Mill Trk 1
03 01 08	Dixie Port. Flr. Mill Trk 1
03 01 09	Dixie Port. Flr. Mill Trk 1
03 02 01	Dixie Port. Flr. Mill Trk 2
03 02 02	Dixie Port. Flr. Mill Trk 2
03 02 03	Dixie Port. Flr. Mill Trk 2
03 02 04	Dixie Port. Flr. Mill Trk 2
03 02 05	Dixie Port. Flr. Mill Trk 2
03 02 06	Dixie Port. Flr. Mill Trk 2
03 02 07	Dixie Port. Flr. Mill Trk 2
03 02 08	Dixie Port. Flr. Mill Trk 2
03 02 09	Dixie Port. Flr. Mill Trk 2
03 03 01	Dixie Port. Flr. Mill Trk 3
03 03 02	Dixie Port. Flr. Mill Trk 3
03 03 03	Dixie Port. Flr. Mill Trk 3
03 03 04	Dixie Port. Flr. Mill Trk 3
03 03 05	Dixie Port. Flr. Mill Trk 3
03 03 06	Dixie Port. Flr. Mill Trk 3
03 03 07	Dixie Port. Flr. Mill Trk 3
03 03 08	Dixie Port. Flr. Mill Trk 3
03 03 09	Dixie Port. Flr. Mill Trk 3
03 04 01	Dixie Port. Flr. Mill Trk 4 Elv
03 04 02	Dixie Port. Flr. Mill Trk 4 Elv
03 05 01	Dixie Port. Flr. Mill Trestle

ZONE 3 (Cont'd)

<u>CLIC NO.</u>	<u>NAME</u>
03 06 00	Dixie Port. Flr. Mill Lead
03 07 00	Storage Lead
03 08 00	Midland Valley Trk 2
03 09 00	Midland Valley Trk 1
03 10 00	SLSF I.C.D.
03 11 00	MP I.C.D.
03 12 00	MP I.C.D.

ZONE 4

<u>CLIC NO.</u>	<u>NAME</u>
04 01 00	Sixth Street Lead
04 02 01	Mauer Neuer F. Meat
04 02 02	Mauer Neuer Lard Tallow
04 02 03	Mauer Neuer Tankage
04 03 01	Mauer Neuer Dock
04 03 02	Mauer Neuer Dock
04 03 03	Mauer Neuer Hide Ldg.
04 04 01	Myers Materials Co.
04 05 01	Skyline Homes
04 06 01	Waldeck Agrico Fertz Svc.
04 06 10	Ark Valley Distr.
04 07 01	Mauk Feed & Seed

ZONE 5

<u>CLIC NO.</u>	<u>NAME</u>
05 01 00	Chilocco Indian School

ZONE 6

<u>CLIC NO.</u>	<u>NAME</u>
06 01 01	Hackney Farmers Union Coop (Elevator)
06 01 02	Hackney Farmers Union Coop (Liquid Fertz)
06 01 03	Hackney Farmers Union Coop (Bag Fertz)
06 02 00	Runaround Trk
06 03 00	Strother Field Lead
06 04 01	Greif Bros. (Door 1)
06 04 02	Greif Bros. (Door 2)
06 04 03	Greif Bros. (Door 3)
06 04 04	Greif Bros. (Door 4)
06 04 05	Greif Bros. (Door 5)
06 04 06	Greif Bros. (Concrete Dock)
06 04 10	Gordon-Piatt

ZONE 6 (Cont'd)

<u>CLIC NO.</u>	<u>NAME</u>
06 05 01	Greif Bros.
06 05 10	Western Mfg. Co.
06 06 01	Smith-Moon Steel Co.
06 07 00	Short Spur

← To Purcell

Main Line	99
Siding	98
Yard Track # 1	01-01
" " 2	01-02
" " 3	01-03
" " 4	01-04
" " 5	01-05
" " 6	01-06
" " 7	01-07
" " 8	01-08
" " 9	01-09
" " 10	01-10
" " 11	01-11
" " 12	01-12
" " 13	01-13
" " 14	01-14

263

Material Yard Lead 01-29

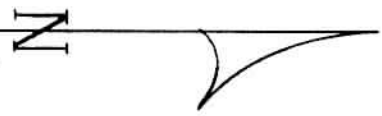

01-29

99  
98  
01-29

Gravel Spur  
01-30

To Newton

01-14

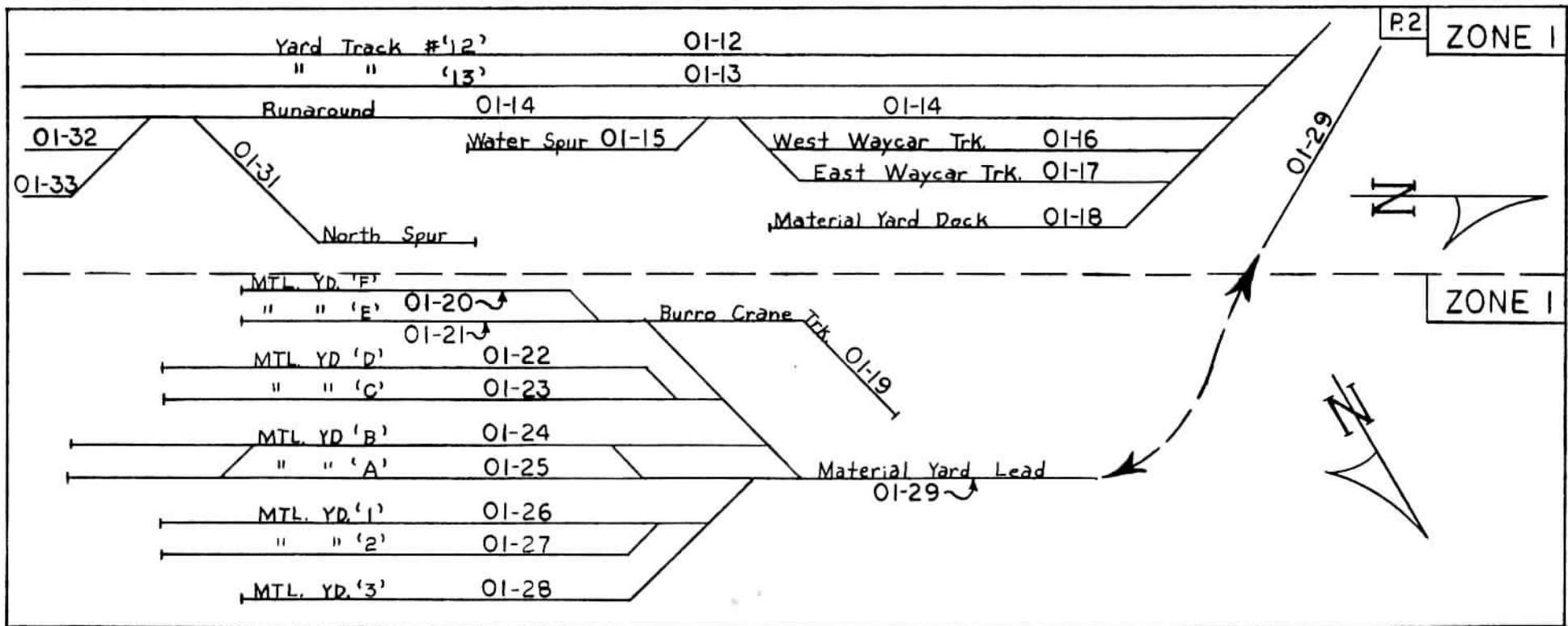



TWO RIVERS CO-OP

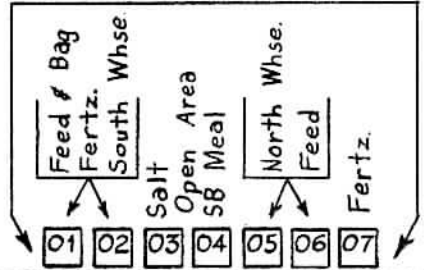

MAUK FEED & SEED

OPEN WHSE.

OLD AUTO DOCK

Team Trk.

NEW AUTO DOCK

TOFC Track

Number '51' Trk.

Main Line

Siding

Old Pass Track

To Newton

To Purcell

01-45 Public Whse. Trk

99

98

01-44

01-43

01-42

01-41

99

98

Business Car Spur

99

98

01-40

01-90

99

98

20

01

02

03

04

05

06

07

10

30

01

01

264

98

Siding

98

P4

ZONE 1

Short Pass 01-46

01-90

Old Pass Track

01-01

Yard Track #1'

01-02

" " '2'

01-03

" " '3'

01-04

" " '4'

01-05

" " '5'

01-06

" " '6'

01-07

" " '7'

01-08

" " '8'

01-09

" " '9'

01-10

" " '10'

01-11

" " '11'

01-12

" " '12'

01-13

" " '13'

01-14

Runaround

Lye Bye

01-32

South Spur

01-33

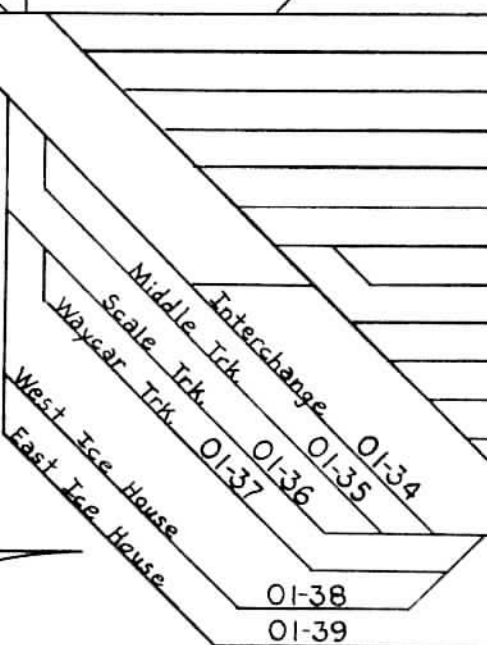

HAYNES CONCRETE & SUPPLY

←To Purcell

P.5 ZONE 2

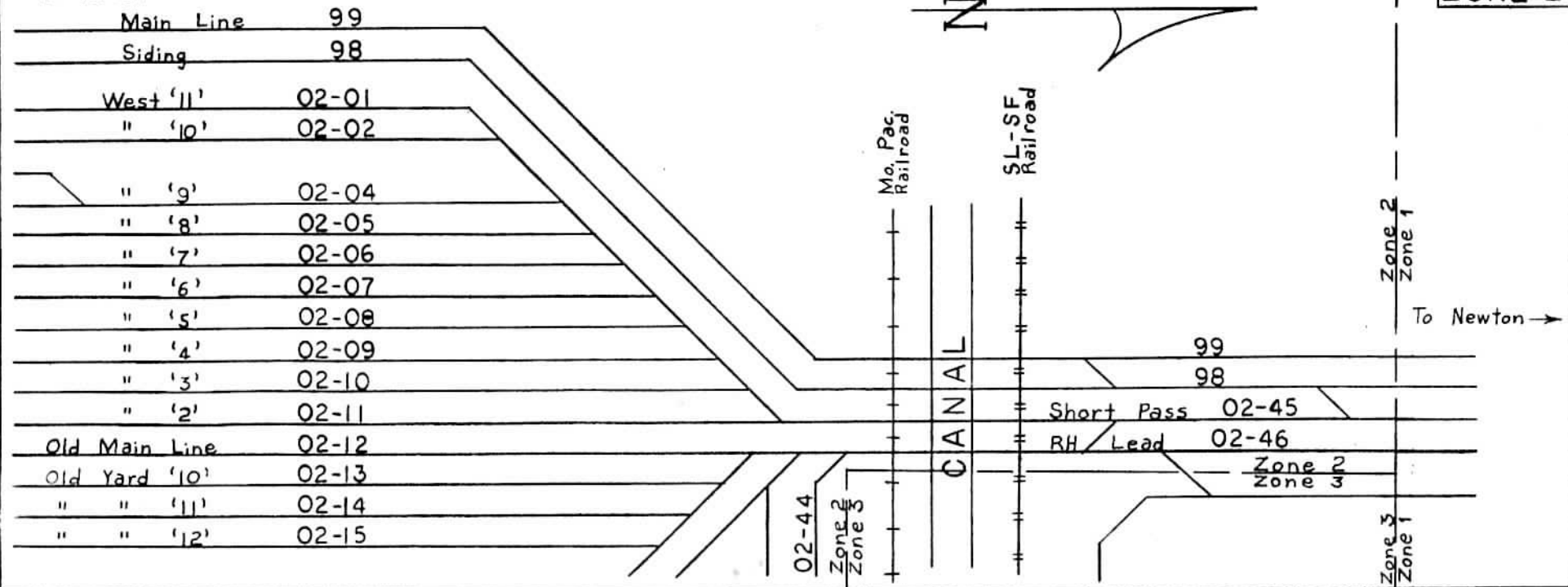

Main Line	99
Siding	98
West '11'	02-01
" '10'	02-02
" '9'	02-04
" '8'	02-05
" '7'	02-06
" '6'	02-07
" '5'	02-08
" '4'	02-09
" '3'	02-10
" '2'	02-11
Old Main Line	02-12
Old Yard '10'	02-13
" " '11'	02-14
" " '12'	02-15

Mo. Pac.  
Railroad

SL-SF  
Railroad

CANAL

99  
98

Short Pass 02-45  
RH Lead 02-46

Zone 2  
Zone 3

Zone 2  
Zone 1

Zone 3  
Zone 1

To Newton →

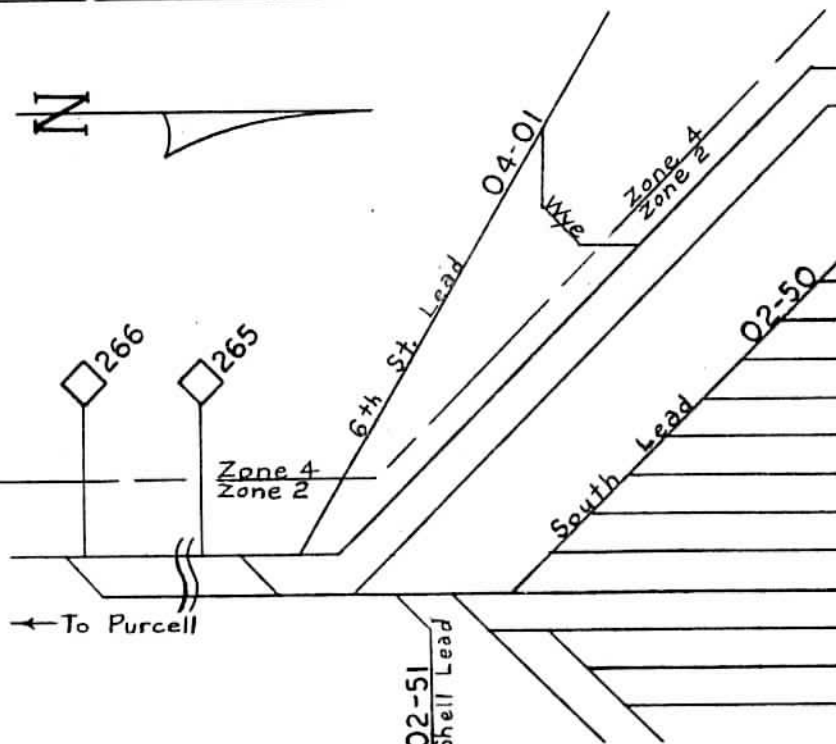

Main Line	99
Siding	98
West '11'	02-01
" '10'	02-02
" '9½'	02-03
" '9'	02-04
" '8'	02-05
" '7'	02-06
" '6'	02-07
" '5'	02-08
" '4'	02-09
" '3'	02-10
" '2'	02-11
Old Main Line	02-12
Old Yard '10'	02-13
" " '11'	02-14
" " '12'	02-15

P7 ZONE 2

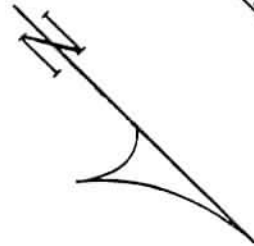
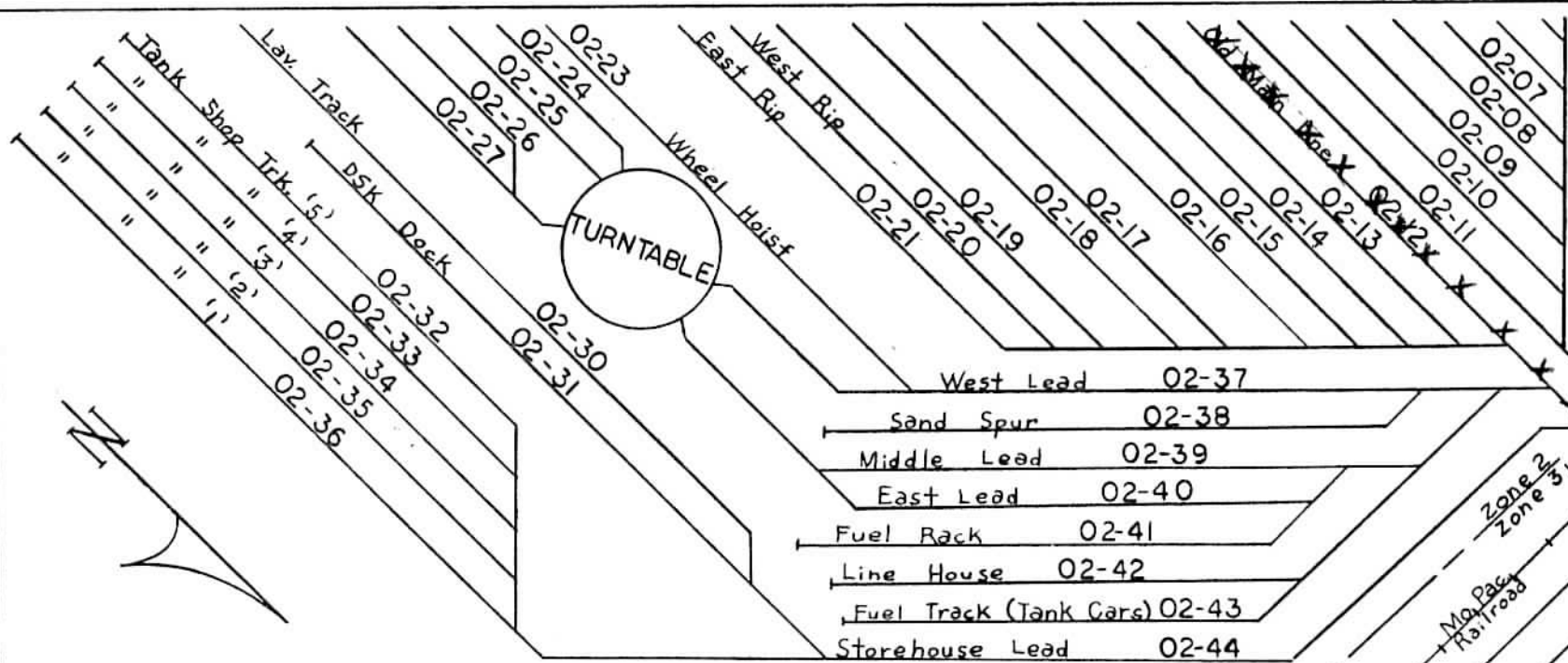

Old Yard '12'	02-15
" " '13'	02-16
" " '14'	02-17
" " '15'	02-18
" " '16'	02-19
West Rip	02-20
East Rip	02-21

Coach

Wheel Hoist 02-23

RH Trk. '1'	02-24
" " '2'	02-25
" " '3'	02-26
" " '4'	02-27

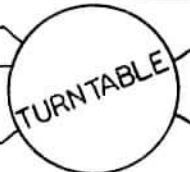

Lav. Track 02-30  
DSK Dock 02-31

West Lead 02-37  
Sand Spur 02-38  
Middle Lead 02-39  
East Lead 02-40  
Fuel Rack 02-41  
Line House 02-42  
Storehouse Lead 02-43  
02-44

Ledger Wood Spur 02-22

Pile Driver Spur 02-28  
Derrick Spur 02-29



DIXIE PORTLAND FLOUR MILL

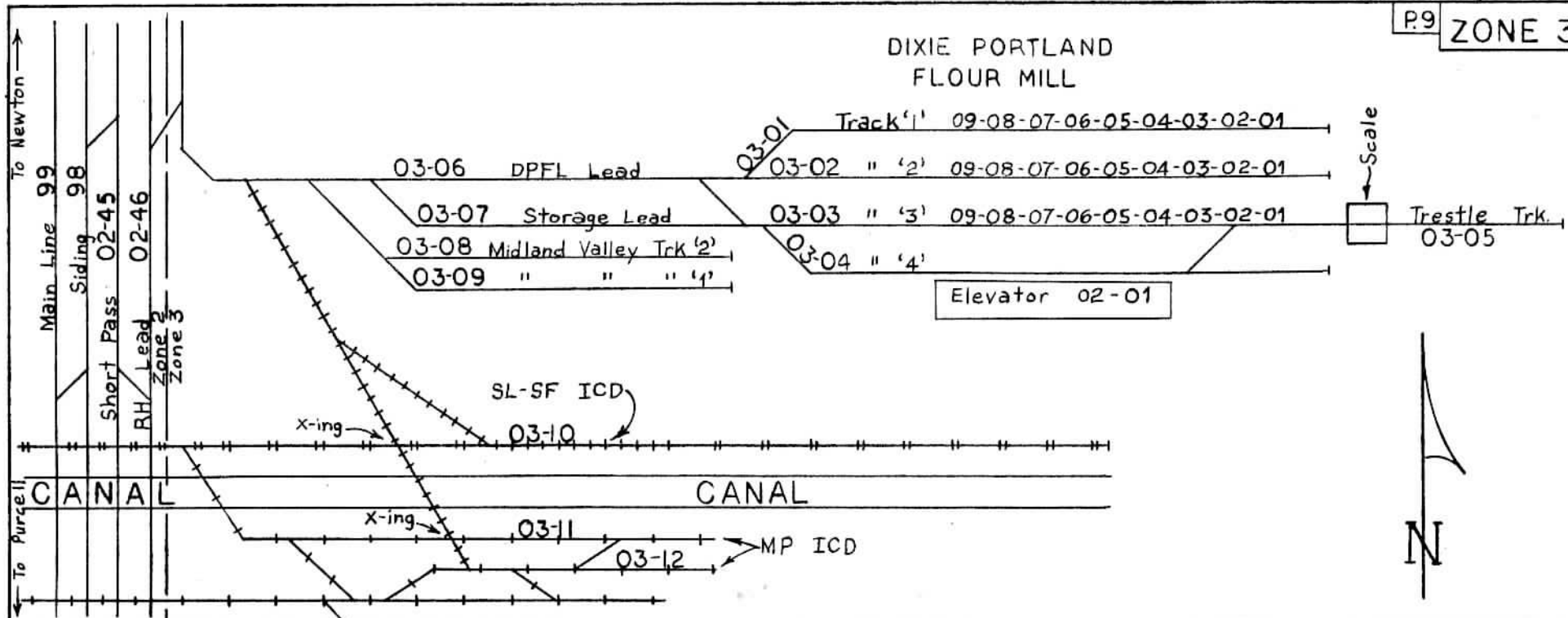

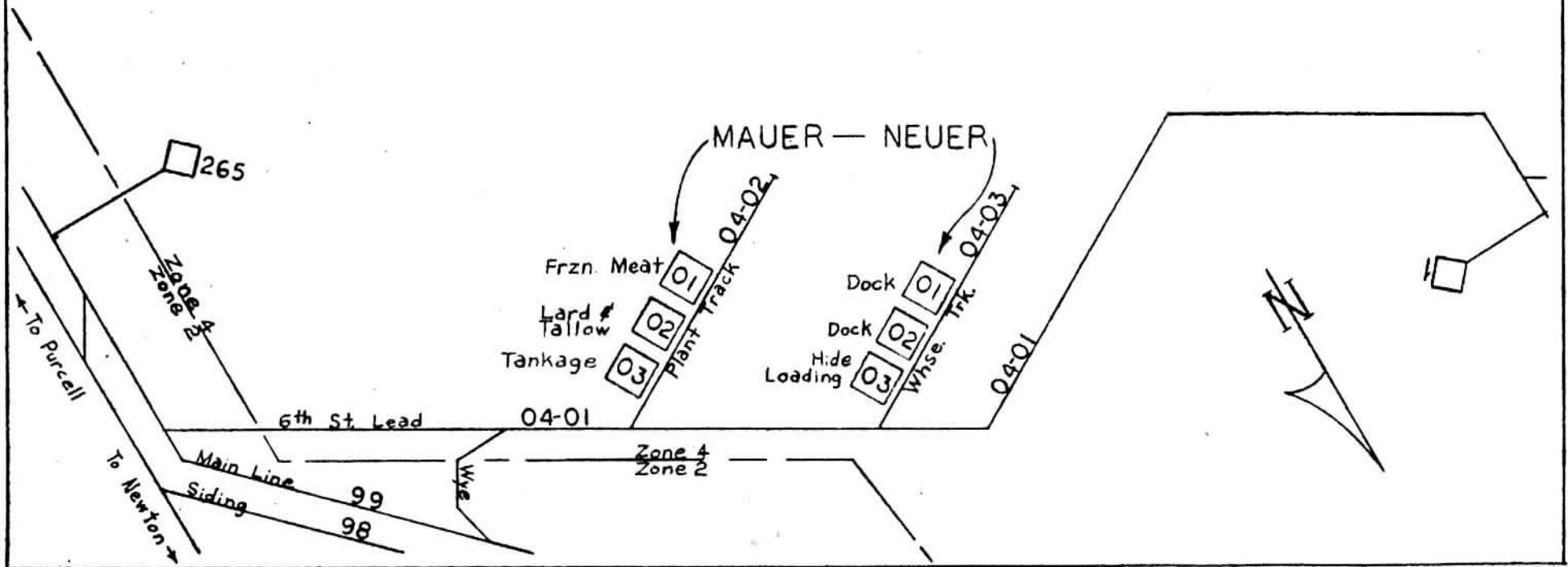



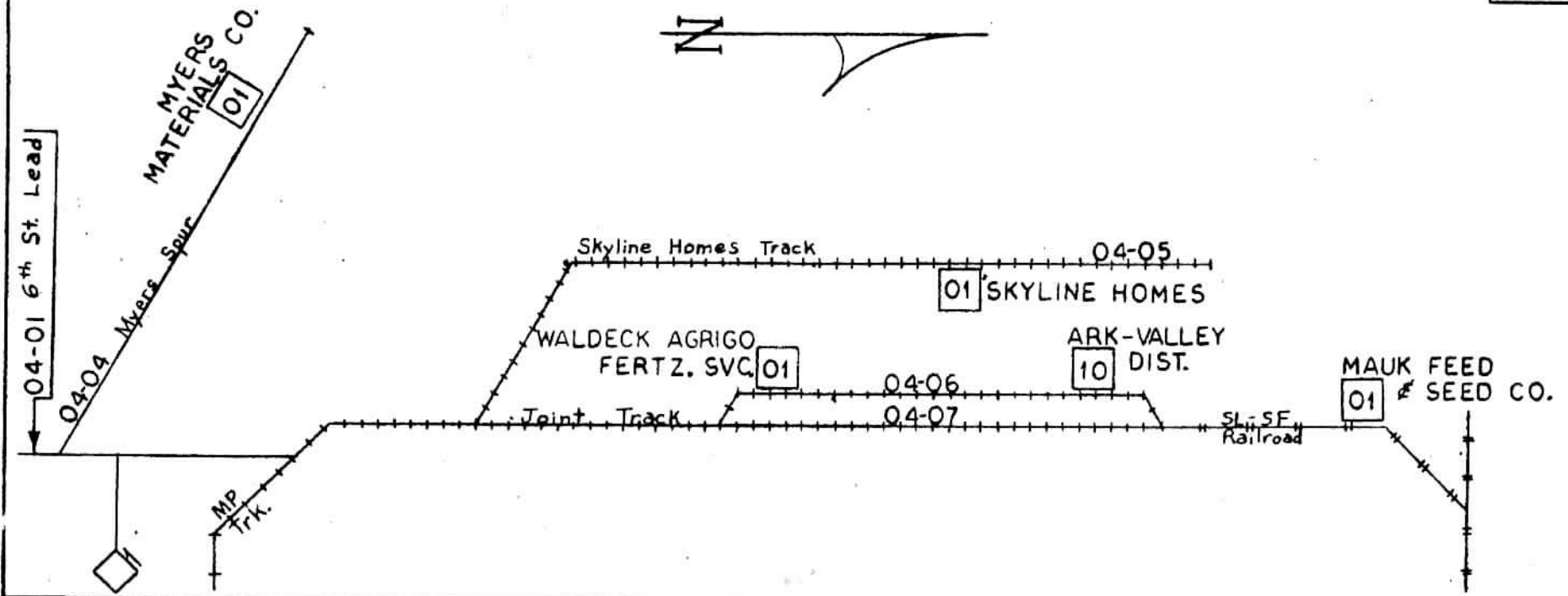

04-01 6th St. Lead

04-04 Myers Spur  
MYERS MATERIALS CO. (01)

MP Trk.

Skyline Homes Track

WALDECK AGRIGO FERTZ. SVC. (01)

Joint Track

04-05  
(01) SKYLINE HOMES

ARK-VALLEY DIST. (10)

04-06

04-07

SL-SF Railroad

MAUK FEED & SEED CO. (01)



CHILOCCO INDIAN  
SCHOOL

01

05-01

MAIN LINE

← To Purcell

To Ark. City →

CHILOCCO, OKLAHOMA

# HACKNEY, KANSAS

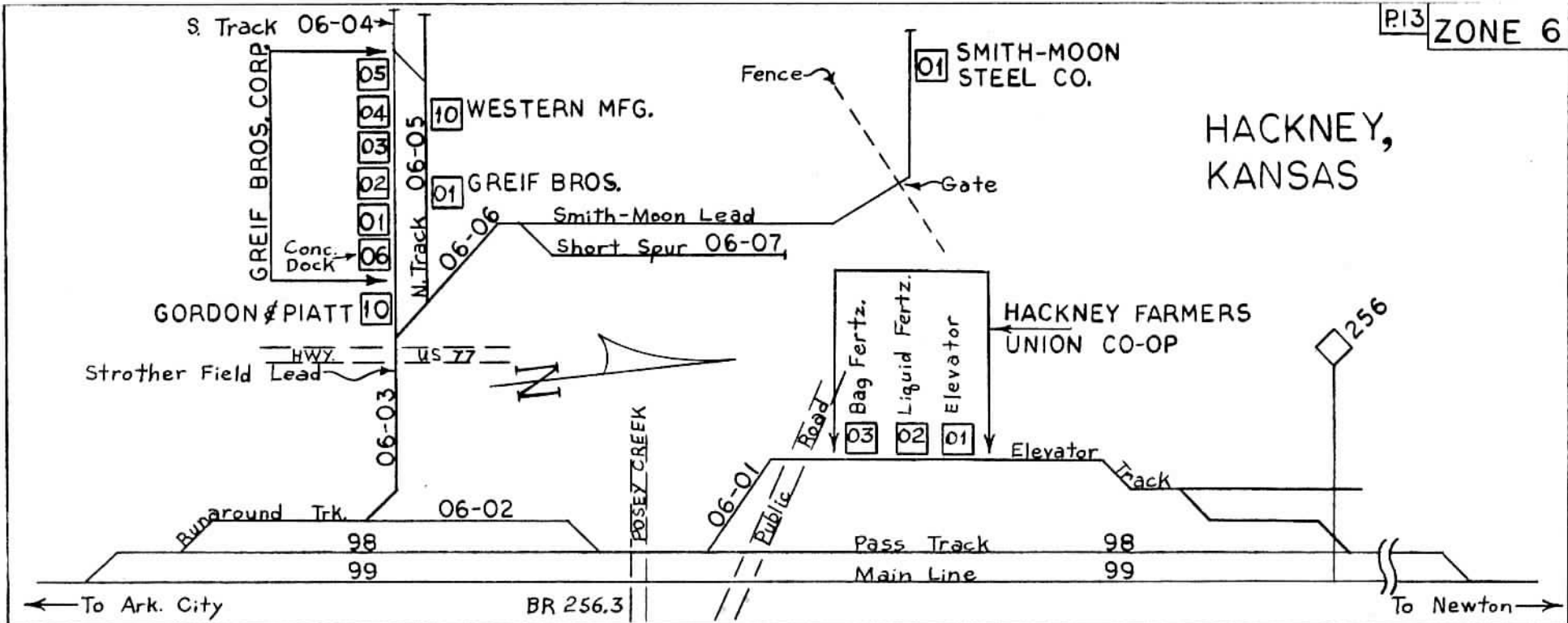

S. Track 06-04

GREIF BROS. CORP.

05  
04  
03  
02  
01  
06

Conc. Dock

GORDON & PIATT

N. Track 06-05

10 WESTERN MFG.

01 GREIF BROS.

Smith-Moon Lead

Short Spur 06-07

Fence

01 SMITH-MOON STEEL CO.

Gate

Strother Field Lead

HWY.

US 77

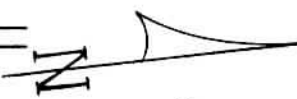

POSEY CREEK

Road

03 Bag Fertz.  
02 Liquid Fertz.  
01 Elevator

HACKNEY FARMERS UNION CO-OP

Elevator

Track

256

Runaround Trk.

98

99

06-02

06-01

Public

Pass Track

98

Main Line

99

To Ark. City

BR 256.3

To Newton